

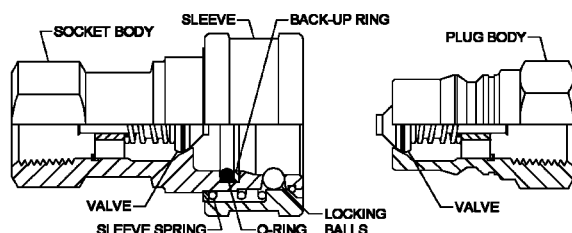

## Series 1-HK to 8-HKP

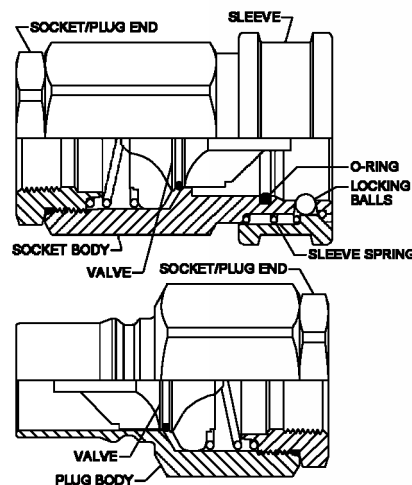

## Series 10-HK, 12-HK & 20-HK



Series HK Couplings are designed for general purpose hydraulic service. Some are suitable for use with various liquids, chemicals, steam, gases and vacuum. Series HK couplings conform to the dimensional requirements of ISO 7241-1 Series B. Body sizes range from 1/8" to 2-1/2".

### Features

- Brass, steel and stainless steel construction available in all sizes; polypropylene available in 1/4" body size
- End connections are female NPTF, BSPP and SAE o-ring boss
- UL listed couplings for use on LP gas fueled lift trucks and tractors available in 1/8", 1/4" and 3/8" body sizes
- Heavy duty steel couplings for use in high impulse service available in most sizes
- Steam coupling available in 3/8" body size

### Standard Materials

- Brass, zinc-plated steel, stainless steel and polypropylene (1/4" only) construction
- Stainless steel springs, balls and retaining rings
- Buna-N (Nitrile) seals
- Teflon back-up rings in 1-HK through 8-HKP steel and stainless steel sockets

### Options

- Non-valved socket and plug
- Valve actuator in socket or plug
- Bleeder-style plug
- Sleeve lock
- Seals: Teflon, Neoprene, Viton, Buna-N, EPDM and Kalrez (See Elastomer Selection Guide, page 69)

### Accessories

- Dust caps and dust plugs (See page 66)
- Release clamp with chain

## Rated Pressure and Flow Capacity

Series	Body Size	Brass		Steel		Stainless Steel	
		PSI	BAR	PSI	BAR	PSI	BAR
1-HK	1/8"	3,000	207	4,000	275	5,000	344
2-HK	1/4"	2,700	186	3,700	255	3,700	255
*P2-HK	1/4"	50	4	(+35°F to 150°F)			
3-HK	3/8"	2,200	152	3,700	255	3,700	255
4-HKP	1/2"	2,250	155	5,000	345	4,250	293
6-HKP	3/4"	2,000	138	4,000	275	3,500	242
8-HKP	1"	1,500	103	4,000	275	2,500	173
10-HK	1-1/4"	1,200	83	1,700	118	1,700	118
12-HK	1-1/2"	1,500	104	2,200	152	2,200	152
20-HK	2-1/2"	700	49	1,500	104	1,500	104

\* Polypropylene Construction

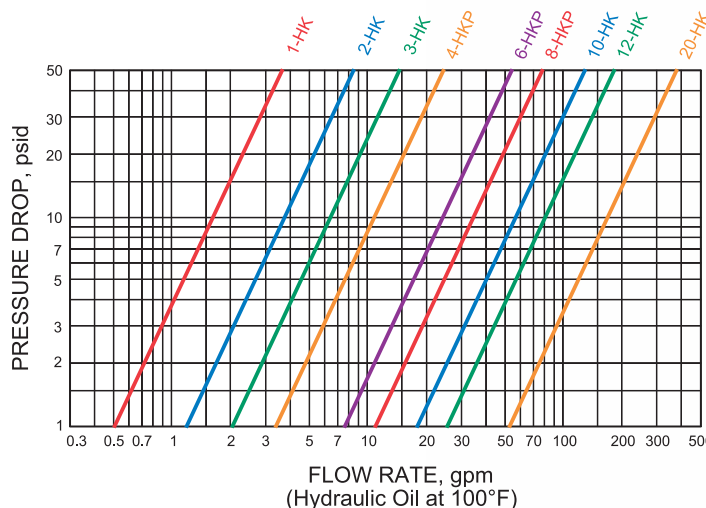

All dimensions in inches.





# Series 1-HK to 8-HK

## ISO 7241-1 Series B

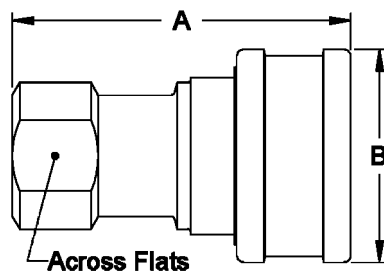

### SOCKETS

Body Size (inch)	Brass		Steel		Stainless Steel		Thread Size (female)			Dimensions (inches)		
	Standard	UL Listed	Standard	High Impulse	303	316	NPTF	BSPP	SAE	A	B	Across Flats
1/8	B1-H11	UL1-H11	1-H11	—	LL1-H11	ML1-H11	1/8-27	—	—	1.91	0.98	0.56
1/8	—	—	1-H4	—	LL1-H4	—	—	—	7/16-20	2.06	0.98	0.69
1/4	B2-H16	UL2-H16	2-H16	2-H16C	LL2-H16	ML2-H16	1/4-18	—	—	2.26	1.17	0.75
1/4	B2-H16BS	—	2-H16BS	—	LL2-H16BS	ML2-H16BS	—	1/4-19	—	2.26	1.17	0.75
1/4	—	—	2-H6	2-H6C	LL2-H6	—	—	—	9/16-18	2.40	1.17	0.88
3/8	B3-H21	UL3-H21	3-H21	3-H21C	LL3-H21	ML3-H21	3/8-18	—	—	2.56	1.42	0.88
3/8	B3-H21BS	—	3-H21BS	—	LL3-H21BS	ML3-H21BS	—	3/8-19	—	2.56	1.42	0.88
3/8	—	—	3-H8	3-H8C	LL3-H8	—	—	—	3/4-16	2.74	1.42	1.00
1/2	B4-HP26	—	4-HP26	4-HP26	LL4-HP26	ML4-HP26	1/2-14	—	—	2.96	1.86	1.13
1/2	B4-HP26BS	—	4-HP26BS	4-HP26BS	LL4-HP26BS	ML4-HP26BS	—	1/2-14	—	2.96	1.86	1.13
1/2	—	—	4-HP10	4-HP10	LL4-HP10	—	—	—	7/8-14	3.05	1.86	1.25
3/4	B6-HP31	—	6-HP31	6-HP31	LL6-HP31	ML6-HP31	3/4-14	—	—	3.48	2.22	1.31
3/4	B6-HP31BS	—	6-HP31BS	6-HP31BS	LL6-HP31BS	ML6-HP31BS	—	3/4-14	—	3.48	2.22	1.31
3/4	—	—	6-HP12	6-HP12	LL6-HP12	—	—	—	1 1/16-12	3.67	2.22	1.38
1	B8-HP36	—	8-HP36	8-HP36	LL8-HP36	ML8-HP36	1-11 1/2	—	—	4.13	2.61	1.75
1	B8-HP36BS	—	8-HP36BS	8-HP36BS	LL8-HP36BS	ML8-HP36BS	—	1-11	—	4.13	2.61	1.75
1	—	—	8-HP16	8-HP16	LL8-HP16	—	—	—	1 5/16-12	4.13	2.61	1.88

A = Overall Length B = Maximum Diameter

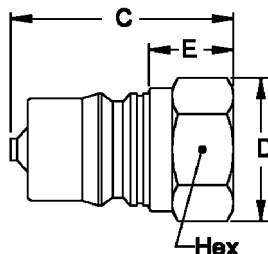

### PLUGS

Body Size (inch)	Brass		Steel		Stainless Steel		Thread Size (female)			Dimensions (inches)			
	Standard	UL Listed	Standard	High Impulse	303	316	NPTF	BSPP	SAE	C	D	E	HEX
1/8	B1-K11	UL1-K11	1-K11	—	LL1-K11	ML1-K11	1/8-27	—	—	1.26	0.65	0.44	0.56
1/8	—	—	1-K4	—	LL1-K4	—	—	—	7/16-20	1.41	0.79	0.59	0.69
1/4	B2-K16	UL2-K16	2-K16	2-K16C	LL2-K16	ML2-K16	1/4-18	—	—	1.52	0.87	0.56	0.75
1/4	B2-K16BS	—	2-K16BS	—	LL2-K16BS	ML2-K16BS	—	1/4-19	—	1.52	0.87	0.56	0.75
1/4	—	—	2-K6	2-K6C	LL2-K6	—	—	—	9/16-18	1.66	1.01	0.70	0.88
3/8	B3-K21	UL3-K21	3-K21	3-K21C	LL3-K21	ML3-K21	3/8-18	—	—	1.76	1.01	0.61	0.88
3/8	B3-K21BS	—	3-K21BS	—	LL3-K21BS	ML3-K21BS	—	3/8-19	—	1.76	1.01	0.61	0.88
3/8	—	—	3-K8	3-K8C	LL3-K8	—	—	—	3/4-16	1.94	1.15	0.79	1.00
1/2	B4-KP26	—	4-KP26	4-KP26	LL4-KP26	ML4-KP26	1/2-14	—	—	2.03	1.30	0.76	1.13
1/2	B4-KP26BS	—	4-KP26BS	4-KP26BS	LL4-KP26BS	ML4-KP26BS	—	1/2-14	—	2.03	1.30	0.76	1.13
1/2	—	—	4-KP10	4-KP10	LL4-KP10	—	—	—	7/8-14	2.11	1.37	0.84	1.19
3/4	B6-KP31	—	6-KP31	6-KP31	LL6-KP31	ML6-KP31	3/4-14	—	—	2.36	1.52	0.71	1.31
3/4	B6-KP31BS	—	6-KP31BS	6-KP31BS	LL6-KP31BS	ML6-KP31BS	—	3/4-14	—	2.36	1.52	0.71	1.31
3/4	—	—	6-KP12	6-KP12	LL6-KP12	—	—	—	1 1/16-12	2.54	1.59	0.89	1.38
1	B8-KP36	—	8-KP36	8-KP36	LL8-KP36	ML8-KP36	1-11 1/2	—	—	2.85	1.88	0.97	1.63
1	B8-KP36BS	—	8-KP36BS	8-KP36BS	LL8-KP36BS	ML8-KP36BS	—	1-11	—	2.85	1.88	0.97	1.63
1	—	—	8-KP16	8-KP16	LL8-KP16	—	—	—	1 5/16-12	2.85	2.17	0.97	1.88

C = Overall Length D = Maximum Diameter E = Exposed Length when Connected

All dimensions in inches.



# Series 1-HK to 8-HK

## ISO 7241-1 Series B



### Series P2-HK Plastic Coupling

The Series P2-HK coupling is intended for use with air, water and various chemicals at low pressure. It is designed for use where an economical, light weight, corrosion resistant coupling is desired. All components, except springs and seals, are molded from natural polypropylene with a UV inhibitor. Valve springs are 316 stainless steel. Viton seals are standard. EPDM (192) seals are optional.

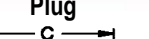
					Socket		Plug							
Part No.	Thread Size	Dimensions			A	B	C	E	Part No.	Thread Size	Dimensions			
		A	B	HEX							C	D	E	HEX
PP2-H25F	1/4-18	2.38	1.45	0.88					PP2-K25F	1/4-18	1.65	1.01	0.67	0.88

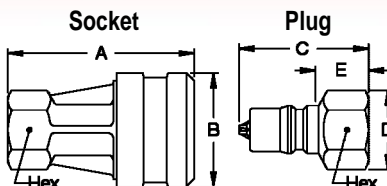

### Series 3-HK Steam Coupling

The Hansen Steam Coupling has a large diameter flange on the sleeve to aid gripping while the user wears heavy gloves. EPDM (192) seals are standard, and can be used with steam at temperatures up to 350°F. Options are BSPP threads, sleeve lock, EPDM (236) seals, for use with steam at temperatures above 350°F, and Viton (143) seals.

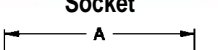
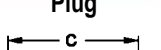
					Socket		Plug							
		Dimensions							Thread Size	Dimensions				
Part No.	NPTF	A	B	Across Flats					Part No.	NPTF	C	D	E	HEX
B3-H21Y	3/8-18	2.56	1.75	0.88					B3-K21-192	3/8-18	1.76	1.01	0.61	0.88

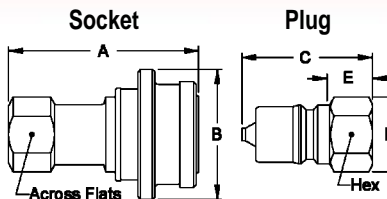

### Release Clamp with Chain

When fluid lines may be subjected to a damaging pull, couplings can be mounted to disconnect automatically, sealing both ends of a line against fluid loss. The socket sleeve can be anchored to a stationary bracket, either directly or with a chain. Excessive pull on the plug end of the line moves the socket body forward relative to the sleeve, and the plug is released without damage to the line. Release Clamp Assembly Kits are available for Series 1-HK through 8-HKP sockets.

Series	Kit Part No.
1-HK	1-HRC-K
2-HK	2-HRC-K
3-HK	3-HRC-K
4-HKP	4-HRC-K
6-HKP	6-HRC-K
8-HKP	8-HRC-K

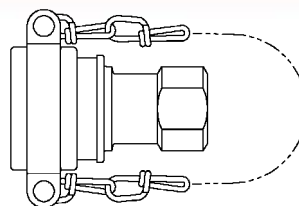

### Bleeder-Style Plugs

Bleeder-style plugs can be used on air lines to prevent hose whip when disconnecting a line by reducing the exhaust velocity of air. Bleeder-style plugs can be used on hydraulic lines to prevent static pressure from building up in disconnected lines. Valves of these plugs are manufactured such that a small leak path exists when the plug is disconnected. Bleeder-style plugs are available in Series 1-HK through 6-HKP.

Series	Plug Part No.
1-HK	B1-K11-VB
2-HK	B2-K16-VB
2-HK	2-K16C-VB
3-HK	B3-K21-VB
3-HK	3-K21-VB
3-HK	3-K21C-VB
4-HKP	4-KP26-VB
6-HKP	B6-KP31-VB
6-HKP	6-KP31-VB

All dimensions in inches.





# Series 10-HK/12-HK/20-HK

## ISO 7241-1 Series B

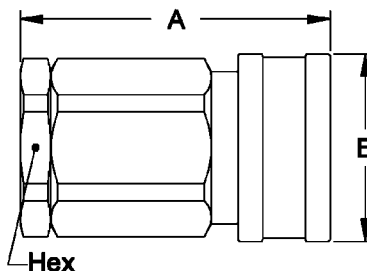

### SOCKETS

Body Size (inch)		Steel		303 Stainless Steel	Thread Size (female)		Dimensions (inches)		
		Standard	High Impulse		NPTF	BSPP	A	B	HEX
1-1/4	B10-H41	10-H41	—	LL10-H41	1 <sup>1</sup> / <sub>4</sub> -11 <sup>1</sup> / <sub>2</sub>	—	4.51	2.73	2.38
1-1/4	—	10-H41BS	—	LL10-H41BS	—	1 <sup>1</sup> / <sub>4</sub> -11	4.51	2.73	2.38
1-1/2	B12-H41	12-H41	12-H41C	LL12-H41	1 <sup>1</sup> / <sub>4</sub> -11 <sup>1</sup> / <sub>2</sub>	—	4.82	3.23	2.38
1-1/2	B12-H41BS	12-H41BS	—	LL12-H41BS	—	1 <sup>1</sup> / <sub>4</sub> -11	4.82	3.23	2.38
1-1/2	B12-H46	12-H46	12-H46C	LL12-H46	1 <sup>1</sup> / <sub>2</sub> -11 <sup>1</sup> / <sub>2</sub>	—	4.82	3.23	2.38
1-1/2	B12-H46BS	12-H46BS	—	LL12-H46BS	—	1 <sup>1</sup> / <sub>2</sub> -11	4.82	3.23	2.38
2-1/2	B20-H51	20-H51	20-H51C	LL20-H51	2-11 <sup>1</sup> / <sub>2</sub>	—	5.55	4.11	3.75
2-1/2	B20-H51BS	20-H51BS	—	LL20-H51BS	—	2-11	5.55	4.11	3.75
2-1/2	B20-H56	20-H56	20-H56C	LL20-H56	2 <sup>1</sup> / <sub>2</sub> -8	—	6.14	4.11	3.75
2-1/2	B20-H56BS	20-H56BS	—	LL20-H56BS	—	2 <sup>1</sup> / <sub>2</sub> -11	6.14	4.11	3.75
2-1/2	B20-H61	20-H61	20-H61C	LL20-H61	3-8	—	7.00	4.11	4.00
2-1/2	B20-H61BS	20-H61BS	—	LL20-H61BS	—	3-11	7.00	4.11	4.00

A = Overall Length B = Maximum Diameter

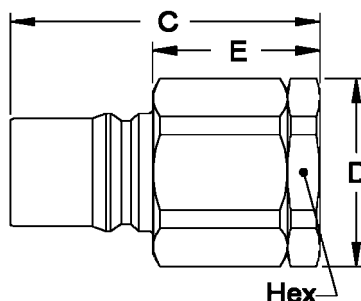

### PLUGS

Body Size (inch)		Steel		303 Stainless Steel	Thread Size (female)		Dimensions (inches)			
		Standard	High Impulse		NPTF	BSPP	C	D	E	HEX
1-1/4	B10-K41	10-K41	—	LL10-K41	1 <sup>1</sup> / <sub>4</sub> -11 <sup>1</sup> / <sub>2</sub>	—	4.25	2.73	2.33	2.38
1-1/4	—	10-K41BS	—	LL10-K41BS	—	1 <sup>1</sup> / <sub>4</sub> -11	4.25	2.73	2.33	2.38
1-1/2	B12-K41	12-K41	12-K41C	LL12-K41	1 <sup>1</sup> / <sub>4</sub> -11 <sup>1</sup> / <sub>2</sub>	—	4.76	3.02	2.67	2.38
1-1/2	B12-K41BS	12-K41BS	—	LL12-K41BS	—	1 <sup>1</sup> / <sub>4</sub> -11	4.76	3.02	2.67	2.38
1-1/2	B12-K46	12-K46	12-K46C	LL12-K46	1 <sup>1</sup> / <sub>2</sub> -11 <sup>1</sup> / <sub>2</sub>	—	4.76	3.02	2.67	2.38
1-1/2	B12-K46BS	12-K46BS	—	LL12-K46BS	—	1 <sup>1</sup> / <sub>2</sub> -11	4.76	3.02	2.67	2.38
2-1/2	B20-K51	20-K51	20-K51C	LL20-K51	2-11 <sup>1</sup> / <sub>2</sub>	—	5.49	4.31	2.97	3.75
2-1/2	B20-K51BS	20-K51BS	—	LL20-K51BS	—	2-11	5.49	4.31	2.97	3.75
2-1/2	B20-K56	20-K56	20-K56C	LL20-K56	2 <sup>1</sup> / <sub>2</sub> -8	—	6.08	4.31	3.56	3.75
2-1/2	B20-K56BS	20-K56BS	—	LL20-K56BS	—	2 <sup>1</sup> / <sub>2</sub> -11	6.08	4.31	3.56	3.75
2-1/2	B20-K61	20-K61	20-K61C	LL20-K61	3-8	—	6.94	4.31	4.42	4.00
2-1/2	B20-K61BS	20-K61BS	—	LL20-K61BS	—	3-11	6.94	4.31	4.42	4.00

C = Overall Length D = Maximum Diameter E = Exposed Length when Connected

*\*\*ISO 7241-1 Series B does not include 1-1/4 inch body size couplings; therefore, Hansen Series 10-HK is not covered by this standard*

# Series HK

## Special Ordering Instructions



How to build a socket or plug part number with options:

**Example: 4-HP26 - VAA - SL - 143**

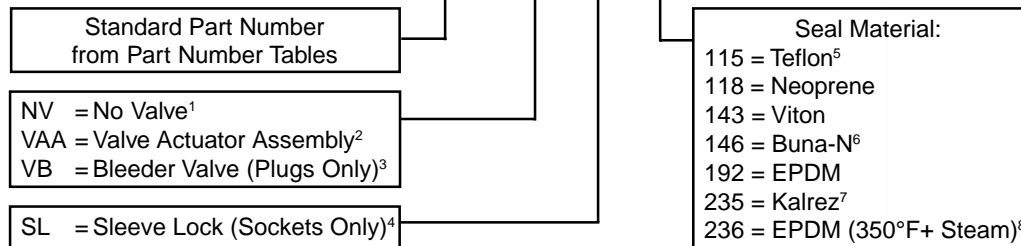

### Notes:

- 1) The NV option should be specified for a socket **and** a plug when a non-valved coupling is desired. Non-valved Series 1-HK through 8-HKP plugs do not contain seals. Do not specify a seal material.
- 2) The VAA option should be specified for a socket **or** a plug when a one-way coupling is desired.
- 3) The VB option can be ordered for Series 1-HK through 6-HKP plugs to prevent pressure build-up in disconnected hydraulic lines or to reduce hose whip when disconnecting pneumatic lines.
- 4) The Sleeve Lock device prevents accidental disconnection. Not available on sockets with prefix UL.
- 5) Series HK couplings are designed for use with elastomer seals. Teflon is not an elastomer. It is rigid and not resilient. Couplings with Teflon seals may leak and/or be difficult to connect. Force to connect may be reduced by heating connected couplings in hot water; then, cooling before disconnecting. Teflon seals are available for Series 1-HK through 8-HKP, except Series P2-HK.
- 6) The 146 seal option may be specified for fuels and hydraulic fluids that are known to cause standard Buna-N seals to swell excessively.
- 7) Couplings with Kalrez seals are available by special quotation.
- 8) The 236 seal option should be ordered for use with steam at or above 350°F. The 192 seal option should be ordered for hot water above 180°F and steam below 350°F.
- 9) Some part numbers may be subject to minimum order quantities.
- 10) Some options may be available only by special quotation. Consult your Hansen distributor.





# Series HA 15000

## ISO 7241-1 Series A

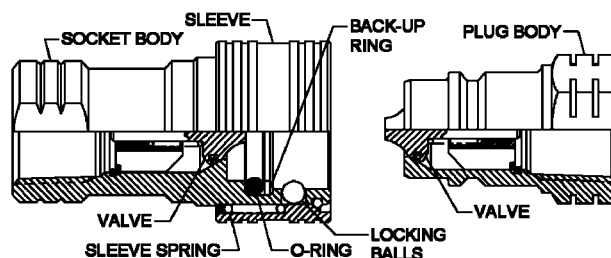

The Series HA 15000 is a general purpose hydraulic and fluid transfer coupling that conforms to the dimensional requirements of ISO 7241-1 Series A. Body sizes are 1/4", 3/8", 1/2", 3/4" and 1".

### Features

- Ball lock
- Manual connect, disconnect
- Poppet valving
- Slim profile
- Zinc plated steel construction
- NPTF and BSPP end connections
- Available push-to-connect socket designed for bulkhead mounting (1/2" body size only)

### Standard Materials

- Zinc-plated steel construction
- Stainless steel springs, balls and retaining rings
- Buna-N (Nitrile) seals

### Accessories

- Dust caps and dust plugs (See page 67)

### Rated Pressure

Body Size	PSI	BAR
1/4"	4,568	315
3/8"	4,568	315
1/2"	3,625	250
3/4"	3,625	250
1"	2,900	200

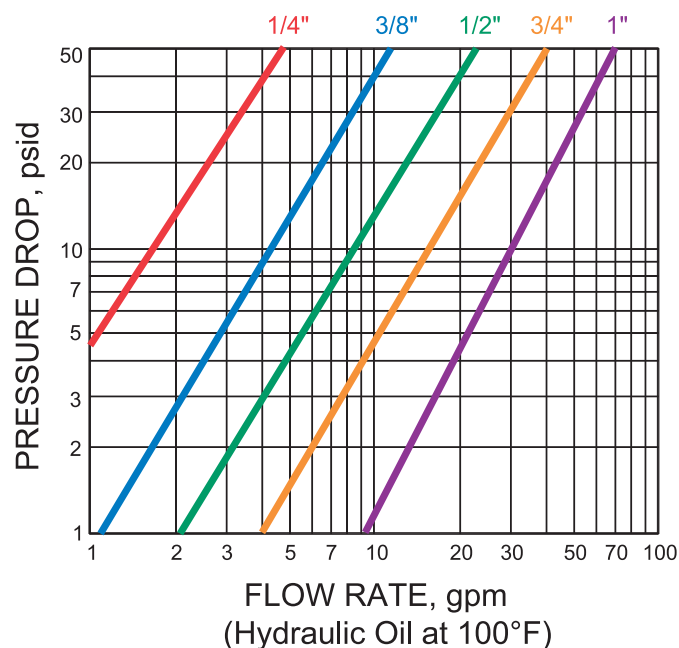



# Series HA 15000

## ISO 7241-1 Series A

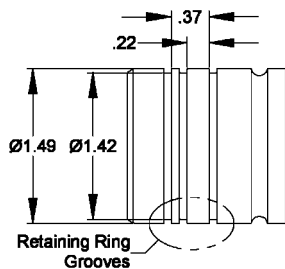
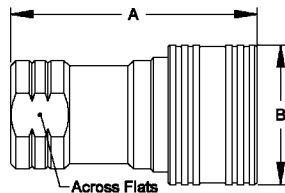

### SOCKETS

Body Size (inch)	Part Number (Steel)	Thread Size (female)		Dimensions (inches)		
		NPTF	BSPP	A	B	Across Flats
1/4	HA 15211 00	1/4-18	—	1.89	0.98	0.75
1/4	HA 15011 00	—	1/4-19	1.89	0.98	0.75
3/8	HA 15221 00	3/8-18	—	2.21	1.18	0.91
3/8	HA 15021 00	—	3/8-19	2.21	1.18	0.91
1/2	HA 15231 00	1/2-14	—	2.64	1.49	1.06
1/2	HA 15031 00	—	1/2-14	2.64	1.49	1.06
1/2	HA 15236 00*	1/2-14	—	2.64	1.49	1.06
1/2	HA 15036 00*	—	1/2-14	2.64	1.49	1.06
3/4	HA 15241 00	3/4-14	—	3.25	1.88	1.38
3/4	HA 15041 00	—	3/4-14	3.25	1.88	1.38
1	HA 15251 00	1-11 1/2	—	3.86	2.08	1.62
1	HA 15051 00	—	1-11	3.86	2.08	1.62

\* Push-to-Connect Socket A = Overall Length B = Maximum Diameter

#### Push-to-Connect Socket - Part Nos. HA 15036 00 & HA 15236 00

This system allows automatic connection and disconnection simply by pushing the plug into or pulling it out of the socket body. Pulling on the hose moves the socket body forward relative to the bulkhead mounted double-acting sleeve, and the plug is released without damage to the hose.

*Sleeve dimensions for bulkhead mounting are shown at left.*

### PLUGS

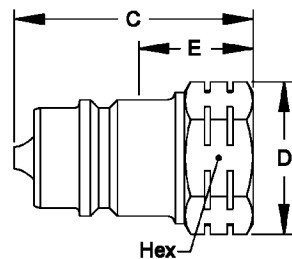

Body Size (inch)	Part Number (Steel)	Thread Size (female)		Dimensions (inches)			
		NPTF	BSPP	C	D	E	Hex
1/4	HA 15212 00	1/4-18	—	1.41	0.86	0.80	0.75
1/4	HA 15012 00	—	1/4-19	1.41	0.86	0.80	0.75
3/8	HA 15222 00	3/8-18	—	1.63	1.04	0.79	0.91
3/8	HA 15022 00	—	3/8-19	1.63	1.04	0.79	0.91
1/2	HA 15232 00	1/2-14	—	1.92	1.22	0.92	1.06
1/2	HA 15032 00	—	1/2-14	1.92	1.22	0.92	1.06
3/4	HA 15242 00	3/4-14	—	2.42	1.58	1.09	1.38
3/4	HA 15042 00	—	3/4-14	2.42	1.58	1.09	1.38
1	HA 15252 00	1-11 1/2	—	2.83	1.85	1.19	1.62
1	HA 15052 00	—	1-11	2.83	1.85	1.19	1.62

C = Overall Length D = Maximum Diameter E = Exposed Length when Connected





# Series QA 29000 Flat Face

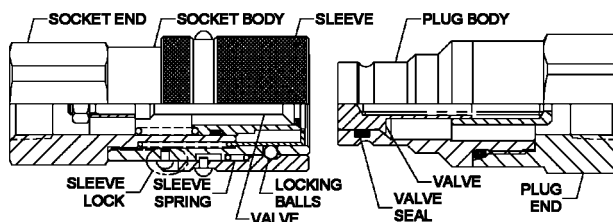
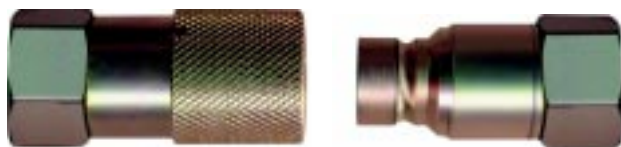

The Series QA 29000 is a flat face dry break or minimum spill hydraulic coupling. Body sizes are 1/4", 3/8", 3/4" and 1".

## Features

- Ball lock
- Push-to-connect
- 3/8 and 1/2 inch couplings meet \*HTMA dimensional standards
- Minimal fluid loss when disconnecting
- Minimal air inclusion when connecting
- NPTF and BSPP threads available
- Standard sleeve lock

\*Hydraulic Tool Manufacturers Association

## Standard Materials

- Zinc plated steel construction
- Stainless steel springs and balls
- Buna-N (Nitrile) seals

## Accessories

- Dust caps  
(See page 67)

## Rated Pressure

Body Size	Socket		Plug		Connected	
	PSI	BAR	PSI	BAR	PSI	BAR
1/4"	2,900	200	5,075	350	5,075	350
3/8"	2,900	200	5,075	350	5,075	350
3/4"	2,175	150	4,350	300	4,350	300
1"	2,030	140	3,625	250	3,625	250

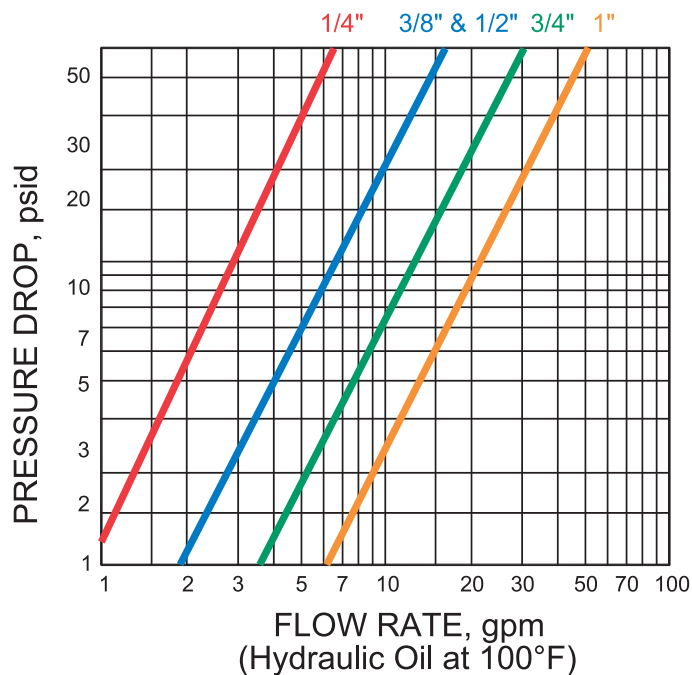

All dimensions in inches.



# Series QA 29000 Flat Face



## SOCKETS

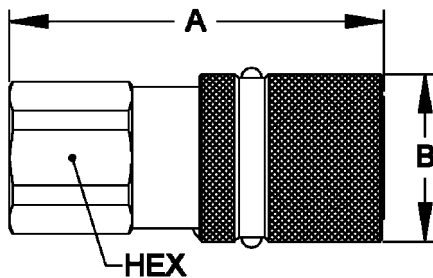
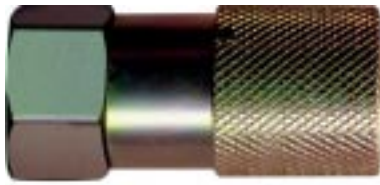

Body Size (inch)	Part Number (Steel)	Thread Size (female)		Dimensions (inches)		
		NPTF	BSPP	A	B	Hex
1/4	QA 29211 00	1/4-18	—	2.07	1.06	0.91
1/4	QA 29011 00	—	1/4-19	2.07	1.06	0.91
3/8	QA 29221 00	3/8-18	—	2.81	1.26	1.06
3/8	QA 29021 00	—	3/8-19	2.81	1.26	1.06
3/8	QA 29231 00	1/2-14	—	2.81	1.26	1.06
3/8	QA 29031 00	—	1/2-14	2.81	1.26	1.06
3/4	QA 29241 00	3/4-14	—	3.11	1.50	1.38
3/4	QA 29041 00	—	3/4-14	3.11	1.50	1.38
1	QA 29251 00	1-11 1/2	—	3.29	1.89	1.81
1	QA 29051 00	—	1-11	3.29	1.89	1.81

A = Overall Length B = Maximum Diameter

## PLUGS

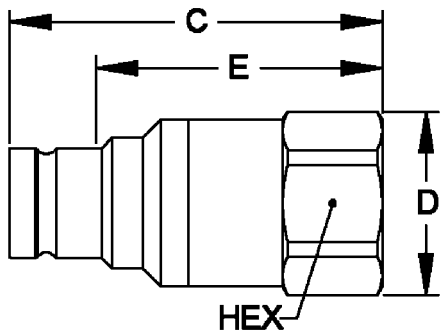

Body Size (inch)	Part Number (Steel)	Thread Size (female)		Dimensions (inches)			
		NPTF	BSPP	C	D	E	Hex
1/4	QA 29212 00	1/4-18	—	2.11	0.98	1.71	0.91
1/4	QA 29012 00	—	1/4-19	2.11	0.98	1.71	0.91
3/8	QA 29222 00	3/8-18	—	2.64	1.30	2.03	1.18
3/8	QA 29022 00	—	3/8-19	2.64	1.30	2.03	1.18
3/8	QA 29232 00	1/2-14	—	2.76	1.30	2.15	1.18
3/8	QA 29032 00	—	1/2-14	2.76	1.30	2.15	1.18
3/4	QA 29242 00	3/4-14	—	2.83	1.56	2.13	1.38
3/4	QA 29042 00	—	3/4-14	2.83	1.56	2.13	1.38
1	QA 29252 00	1-11 1/2	—	3.21	1.97	2.38	1.81
1	QA 29052 00	—	1-11	3.21	1.97	2.38	1.81

C = Overall Length D = Maximum Diameter E = Exposed Length when Connected

All dimensions in inches.





# Series 96 Wing Nut

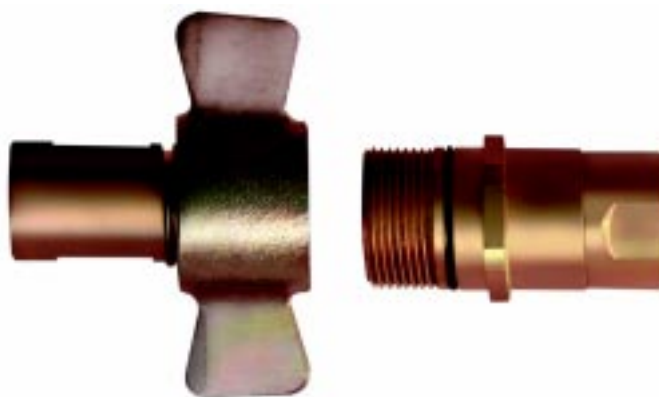

The Series 96 coupling is a heavy-duty wing nut coupling designed for use in hydraulic lines where dry break and minimum air inclusion are required. It is ideal for hydraulic dump trucks, oil field equipment, spreading equipment and applications requiring the ability to connect and/or disconnect under pressure. Body sizes are 3/4", 1" and 1-1/4".

## Features

- Non-spill double shut-off with minimum air inclusion
- Connect/disconnect under pressure
- Corrosion resistant brass body
- Plugs can be bulkhead mounted
- Interchanges with other manufacturers' couplings

## Standard Materials

- Brass body (socket & plug)
- Zinc plated steel wing nut (socket)
- Stainless steel springs
- Buna-N (Nitrile) seals

## Options

- Dust caps and dust plugs (See page 67)
- Bulkhead mounting flanges

## Bulkhead Mounting Flanges

Body Size (inches)	Part No.	Diameters (inches)	
		Bolt Hole A	Bolt Circle B
3/4"	FL96-075	0.201	2.13
1"	FL96-100	0.201	2.38
1-1/4"	FL96-125	0.201	2.63

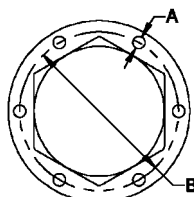

## Rated Pressure

Body Series	PSI	BAR
3/4"	3,000	207
1"	3,000	207
1-1/4"	2,750	190

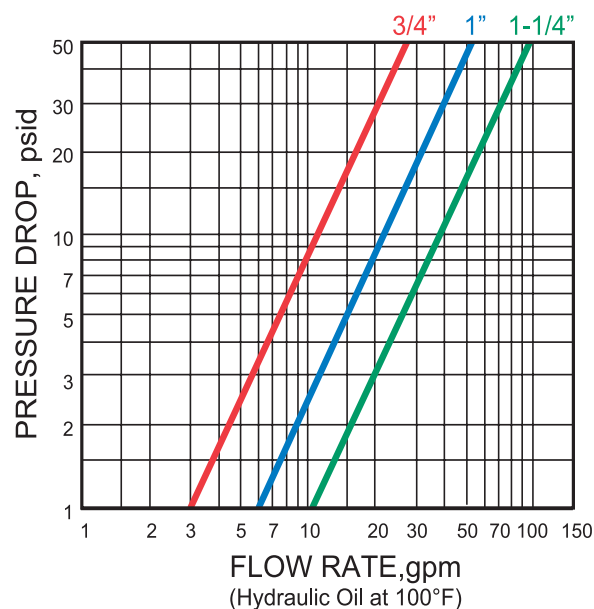

## Sockets

Body Size	Part No.	Thread Size NPTF	Dimensions		
			A	B	Across Flats
3/4"	96-S31	3/4-14	3.09	4.06	1.15
1"	96-S36	1-11 1/2	3.78	4.45	1.44
1-1/4"	96-S41	1 1/4-11 1/2	3.97	5.20	1.78

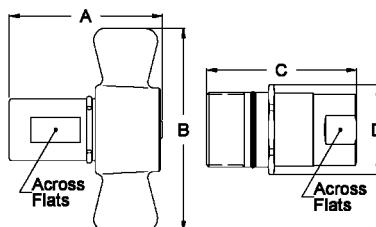

## Plugs

Body Size	Part No.	Thread Size NPTF	Dimensions		
			C	D	Across Flats
3/4"	96-P31	3/4-14	3.10	1.78	1.31
1"	96-P36	1-11 1/2	3.55	2.00	1.56
1-1/4"	96-P41	1 1/4-11 1/2	3.71	2.38	1.88

All dimensions in inches.

# Series UP10 "Ultra Pressure"

10,000 psi

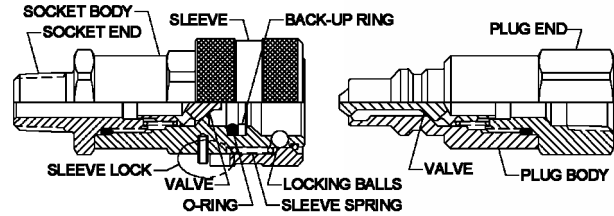

The Series UP10 is a high pressure hydraulic quick connect coupling designed to operate at pressures up to 10,000 psi. Its ball lock mechanism makes it a true quick connect coupling, as opposed to thread-to-connect couplings that are typically used in high pressure hydraulics. Body size is 1/4".

## Features

- Ball lock
- Slim profile compared to threaded couplings
- High strength steel construction
- Poppet valves with metal-to-metal sealing
- 1/4" & 3/8" male & female NPTF end connections
- Standard sleeve lock

## Standard Materials

- High strength steel bodies and valves
- Stainless steel springs & balls
- Buna-N (Nitrile) seals
- Teflon back-up ring (socket)

## Accessories

- Dust caps and dust plugs (See page 66)

## Rated Pressure

Series	PSI	BAR
UP	10,000	700

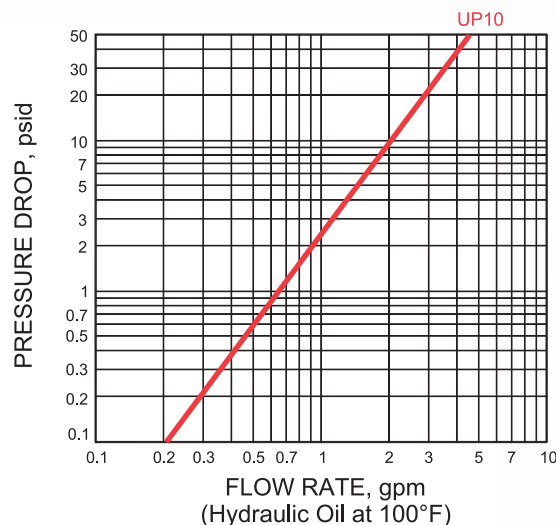

## Sockets

Part No.	Thread Size	Dimensions		
		A	B	HEX
UP10S-25M	1/4-18 NPTF	2.69	1.18	0.88
UP10S-37M	3/8-18 NPTF	2.69	1.18	0.88

## Male End Connections

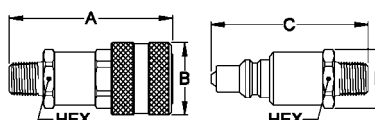

## Plugs

Part No.	Thread Size	Dimensions		
		C	D	HEX
UP10P-25M	1/4-18 NPTF	2.59	0.97	0.88
UP10P-37M	3/8-18 NPTF	2.59	0.97	0.88

## Female End Connections

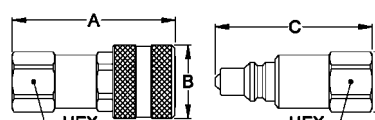

Part No.	Thread Size	Dimensions		
		A	B	HEX
UP10S-25F	1/4-18 NPTF	2.64	1.18	0.88
UP10S-37F	3/8-18 NPTF	2.69	1.18	0.88

Part No.	Thread Size	Dimensions		
		C	D	HEX
UP10P-25F	1/4-18 NPTF	2.54	0.97	0.88
UP10P-37F	3/8-18 NPTF	2.59	0.97	0.88

All dimensions in inches.





# Series WA 56000

Thread-to-Connect 10,000 psi

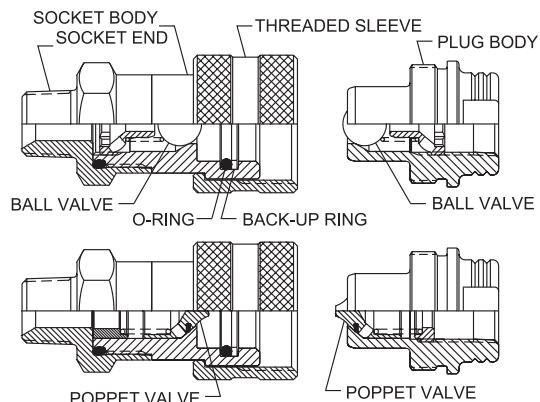
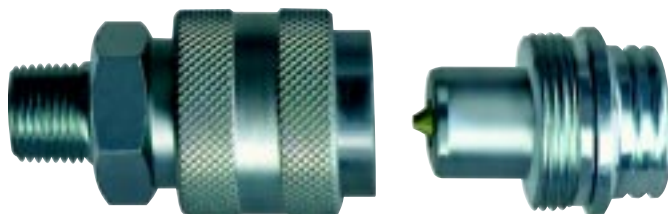

The Series WA 56000 is a high pressure hydraulic screw together coupling designed to operate at pressures up to 10,000 psi. Its rugged design makes it suitable for use in hydraulic ram, pump and high impulse applications. Body sizes are 1/4" and 3/8".

## Features

- Threaded latching
- Rugged steel construction
- Poppet valves with elastomer seal standard in 1/4" coupling
- Poppet valves and ball valves available in 3/8" coupling
- Body size matches thread size. 1/4" and 3/8" body sizes do not interchange.

## Standard Materials

- Zinc plated steel construction
- High strength steel ball valves
- Stainless steel springs
- Buna-N (Nitrile) seals
- Teflon back-up ring (socket)

## Accessories

- Dust caps and dust plugs (See page 67)

## Rated Pressure

Body Size	PSI	BAR
1/4"	10,000	700
3/8"	10,000	700

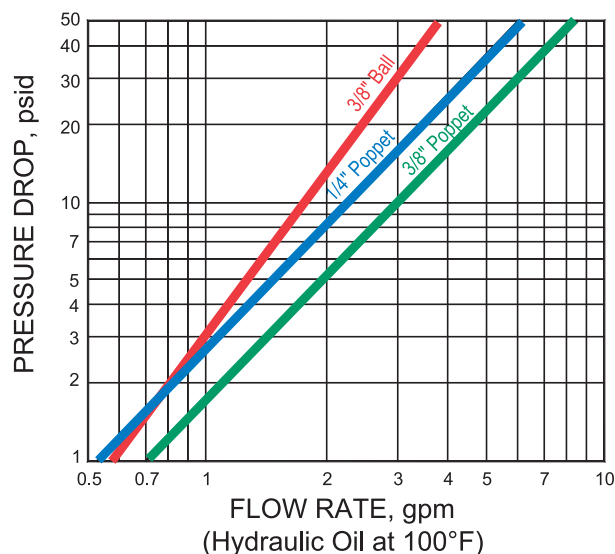

## Sockets – Male End Connections

Part No.	Valve Type	Thread Size NPTF	Dimensions		
			A	B	HEX
WA 56517 00	Poppet	1/4-18	2.36	1.12	0.88
WA 56527 00	Poppet	3/8-18	2.76	1.38	1.06
WA 56227 00	Ball	3/8-18	2.76	1.38	1.06

All dimensions in inches.

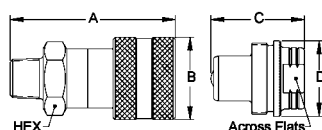

## Plugs – Female End Connections

Part No.	Valve Type	Thread Size NPTF	Dimensions		
			C	D	Across Flats
WA 56514 00	Poppet	1/4-18	1.26	1.10	0.75
WA 56524 00	Poppet	3/8-18	1.52	1.26	0.91
WA 56224 00	Ball	3/8-18	1.52	1.26	0.91

# Series 2-HKIG & 2-HKIL

1/4" Nominal



## 2-HKIG



## 2-HKIL

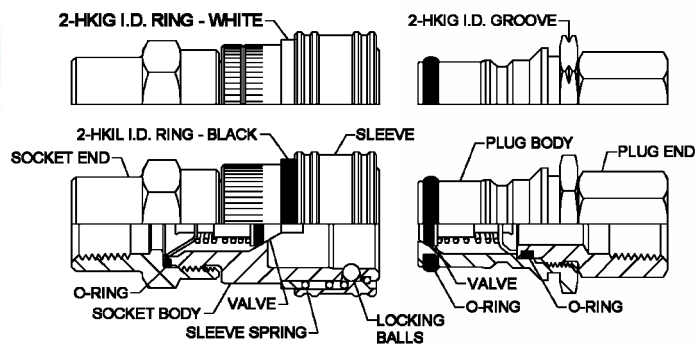

Series 2-HKIG and 2-HKIL Stainless Steel Couplings can be used with various liquids and gases. They are functionally identical, but do not interchange. They can be used where it is necessary to avoid crossing lines.

### Features

- Ball lock
- Manual operation
- Noninterchangeable designs
- 1/4" body size
- All-stainless steel construction
- Sockets available with right-angle connection

### Standard Materials

- Stainless steel bodies, valves and sleeves

- Stainless steel springs, balls and retaining rings
- Buna-N (Nitrile) seals
- Socket identification ring
  - 2-HKIG: White acetal
  - 2-HKIL: Black acetal

### Options

- Seals: Teflon, Viton, EPDM

### Accessories

- Dust caps  
(See page 66)

## Rated Pressure

Series	PSI	BAR
2-HKIG & 2-HKIL	1500	103

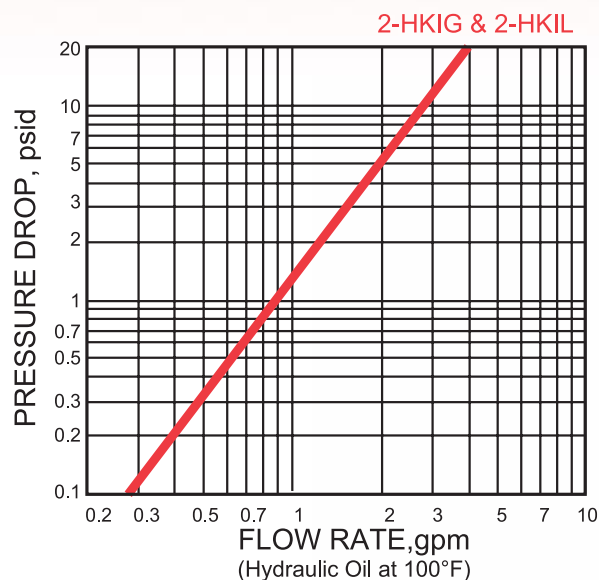



# Series 2-HKIG & 2-HKIL

1/4" Nominal

## SOCKETS

## 2-HKIG

## PLUGS

Part No.	Thread Size	Dimensions		
		A	B	HEX
2-HIG10	1/8-27 NPTF	2.18	1.06	0.81
2-HIG15	1/4-18 NPTF	2.31	1.06	0.81
2-HIG20	3/8-18 NPTF	2.31	1.06	0.81
2-HIG720	7/16-20*	2.27	1.06	0.81
2-HIG-LLRA720†	7/16-20*	2.09	1.06	—

### Male End Connections

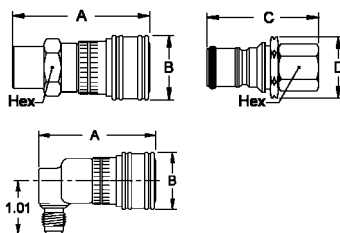

Part No.	Thread Size	Dimensions		
		C	D	HEX
2-KIG-F15	1/4-18 NPTF	1.98	1.01	0.69
2-KIG-F20	3/8-18 NPTF	1.98	1.01	0.69

Part No.	Thread Size	Dimensions		
		A	B	HEX
2-HIG11	1/8-27 NPTF	2.18	1.06	0.81
2-HIG16	1/4-18 NPTF	2.26	1.06	0.81

### Female End Connections

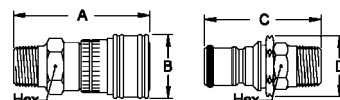

Part No.	Thread Size	Dimensions		
		C	D	HEX
2-KIG-F16	1/4-18 NPTF	1.84	1.01	0.69
2-KIG-F720	7/16-20*	1.61	1.01	0.69
2-KIG-F	9/16-18	1.17	1.01	0.88

## SOCKETS

## 2-HKIL

## PLUGS

Part No.	Thread Size	Dimensions		
		A	B	HEX
2-HIL10	1/8-27 NPTF	2.18	1.06	0.81
2-HIL15	1/4-18 NPTF	2.31	1.06	0.81
2-HIL20	3/8-18 NPTF	2.31	1.06	0.81
2-HIL720	7/16-20*	2.27	1.06	0.81
2-HIL-LLRA720†	7/16-20*	2.09	1.06	—

### Male End Connections

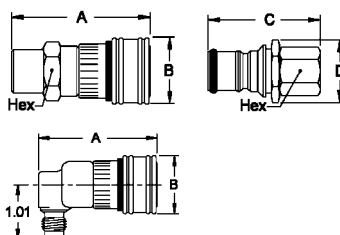

Part No.	Thread Size	Dimensions		
		C	D	HEX
2-KIL-F15	1/4-18 NPTF	1.98	1.01	0.69
2-KIL-F20	3/8-18 NPTF	1.98	1.01	0.69

Part No.	Thread Size	Dimensions		
		A	B	HEX
2-HIL11	1/8-27 NPTF	2.18	1.06	0.81
2-HIL16	1/4-18 NPTF	2.26	1.06	0.81

### Hose Clamp End Connections

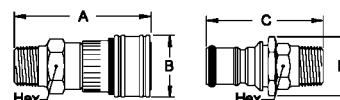

Part No.	Hose Size	Dimensions		
		C	D	HEX
2-KIL-F16	1/4-18 NPTF	1.84	1.01	0.69
2-KIL-F720	7/16-20*	1.61	1.01	0.69
2-KIL-F	5/8-18	1.17	1.01	0.88

\* 1/4" SAE Flare † Right-Angle End Connection

How to build a socket or plug part number with options:

- Notes:
- 1) Some part numbers may be subject to minimum order quantities.
  - 2) Options not shown may be available by special quotation. Consult your Hansen distributor.

Example: 2-HIG15 - 143

Standard Part Number  
from Tables Above

Seal Material:  
115 = Teflon  
143 = Viton  
192 = EPDM

All dimensions in inches.

H A N S E N C O U P L I N G S



# Series DB

## 316 Stainless Steel Flat Face



The Series DB is designed for fluid handling where minimum spillage and minimum air inclusion are required. Couplings in this series are constructed of 316L stainless steel, which makes them suitable for use in chemical, pharmaceutical and food processing industries. Body sizes are 1/2" and 1".

### Features

- Ball lock
- Push-to-connect
- Minimal fluid loss when disconnecting
- Minimal air inclusion when connecting
- High flow capacity
- NPTF and BSPP threads available.

### Standard Materials

- 316L stainless steel construction
- Viton seals

### Options

- Various seal materials available.

### Rated Pressure

Body Size	Socket		Plug		Connected	
	PSI	BAR	PSI	BAR	PSI	BAR
1/2"	1,450	100	2,030	140	2,030	140
1"	1,450	100	2,030	140	2,030	140

### Spillage & Air Inclusion

Body Size	Spillage Max. per Disconnect	Air Inclusion Max. per Connect
1/2"	.02 ml	.02 ml
1"	.04 ml	.13 ml

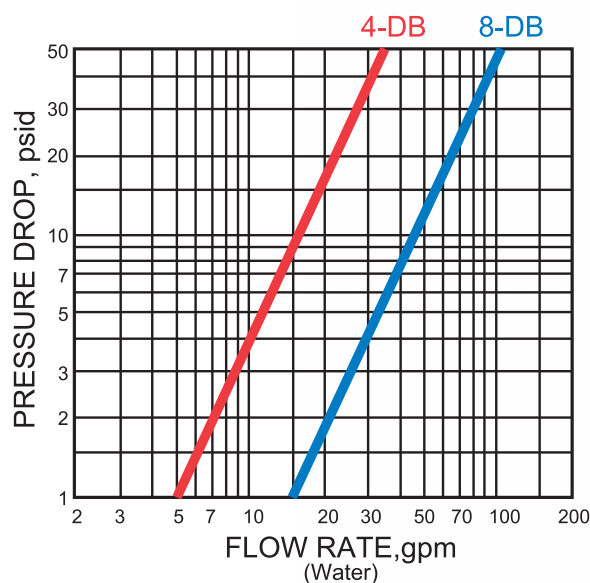

### Sockets

Body Size (inch)	Part No.	Thread Size (Female)	Dimensions		
			A	B	HEX
1/2	4DBS-50F	1/2-14 NPTF	2.52	1.59	1.38
1/2	4DBS-50FBS	1/2-14 BSPP	2.52	1.59	1.38
1	8DBS-100F	1-11 1/2 NPTF	3.52	2.25	1.81
1	8DBS-100FBS	1-11 BSPP	3.52	2.25	1.81

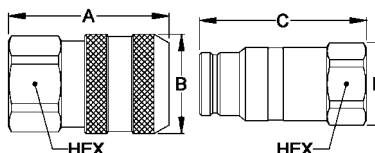

### Plugs

Body Size (inch)	Part No.	Thread Size (Female)	Dimensions		
			C	D	HEX
1/2	4DBP-50F	1/2-14 NPTF	2.63	1.37	1.18
1/2	4DBP-50FBS	1/2-14 BSPP	2.63	1.37	1.18
1	8DBP-100F	1-11 1/2 NPTF	3.52	2.08	1.81
1	8DBP-100FBS	1-11 BSPP	3.52	2.08	1.81

All dimensions in inches.





# Series WA 10000

## Refrigerant and Fluid Transfer



The Series WA 10000 is a thread together, minimum spill/inclusion coupling designed for refrigeration, air conditioning, gas and liquid transfer applications.

### Features

- Dry break design minimizes fluid loss and air inclusion
- Threaded connection permits connecting and disconnecting under pressure
- Brazed or threaded end connections available
- Male half can be bulkhead mounted
- Interchanges with refrigerant couplings existing on the market

### Standard Materials

- Zinc plated steel construction
- HNBR and Neoprene seals

### Accessories

- SAE 37° (JIC) adapters (steel)
- Braze adapters (brass)
- O-rings for adapters
- Dust caps and dust plugs
- Lock washers and jam nuts for bulkhead mounting of male half

### Rated Pressure

Dash Size	Female Half		Male Half		Connected	
	PSI	BAR	PSI	BAR	PSI	BAR
-8	435	30	1,160	80	1,810	125
-12	435	30	1,015	70	1,015	70
-16	360	25	725	50	725	50

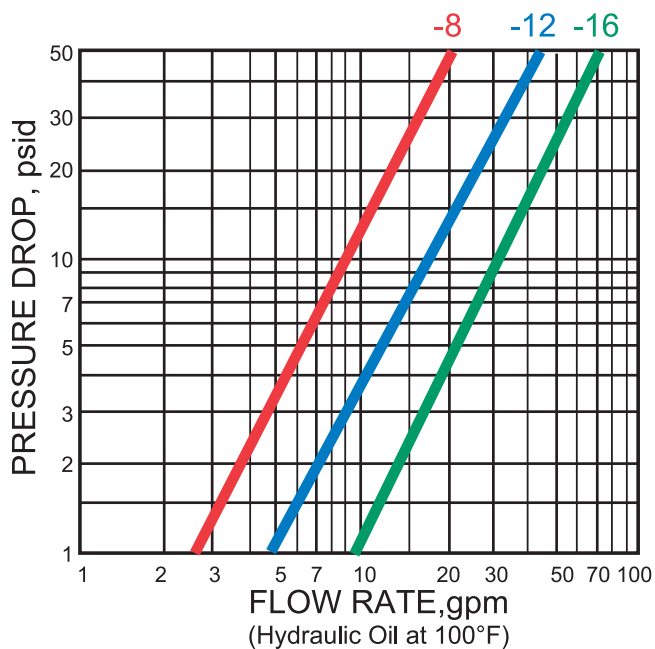

All dimensions in inches.

H A N S E N C O U P L I N G S

# Series WA 10000

## Refrigerant and Fluid Transfer

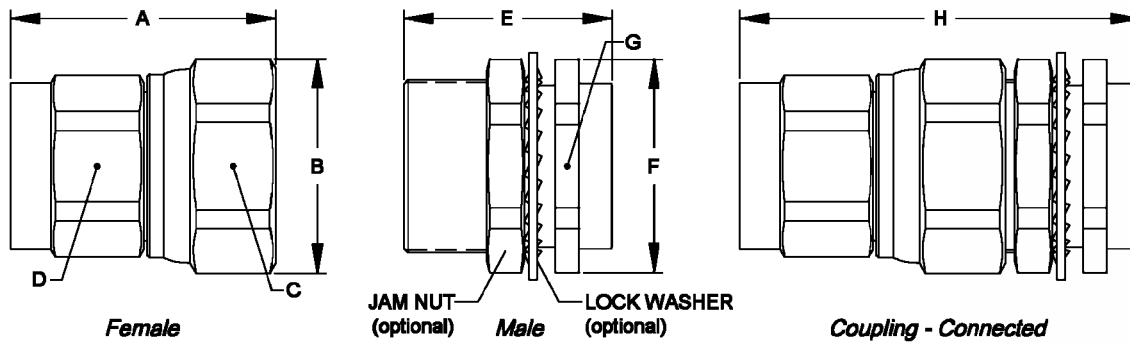

Coupling Dash Size	Seal Material	Dimensions (inches)									
		Female Half					Male Half				* Connected Length (no adapter) H
		Part No.	Overall Length A	Max. Dia. B	Hex Size C	Hex Size D	Part No.	Overall Length E	Max. Dia. F	Hex Size G	
-8	HNBR	WA 10037 IO	1.66	1.30	1.18	1.02	WA 10034 IO	1.38	1.26	1.15	2.67
-8	Neoprene	WA 10037 MO	1.66	1.30	1.18	1.02	WA 10034 MO	1.38	1.26	1.15	2.67
-12	HNBR	WA 10057 IO	2.17	1.77	1.62	1.38	WA 10054 IO	1.73	1.77	1.62	3.33
-12	Neoprene	WA 10057 MO	2.17	1.77	1.62	1.38	WA 10054 MO	1.73	1.77	1.62	3.33
-16	HNBR	WA 10067 IO	2.40	2.21	1.97	1.77	WA 10064 IO	1.98	2.09	1.89	3.75
-16	Neoprene	WA 10067 MO	2.40	2.21	1.97	1.77	WA 10064 MO	1.98	2.09	1.89	3.75

\* To calculate the overall length of a connected coupling with adapters installed, add the exposed lengths of two adapters to the connected length with no adapter (Connected Length with Adapters = H + 2 x K).

Coupling Dash Size	Maximum Bulkhead Thickness (inches)		Assembly Torque, lb-ft	
	With Lock Washer	Without Lock Washer	Adapter/Body	Male/Female
-8	0.16	0.28	25-30	15-20
-12	0.23	0.34	40-45	20-25
-16	0.22	0.28	50-55	25-30

All dimensions in inches.







# Series WA 10000

## Refrigerant and Fluid Transfer

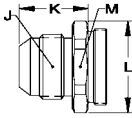
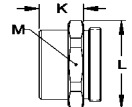
### Accessories

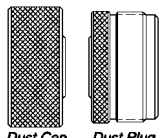
Adapters	Coupling Dash Size	Tube O.D. (inch)	Part Numbers			Dimensions (inches)			
			Adapter	O-Ring		Thread Size J	Exposed Length K	Max. Dia. L	Hex Size M
				HNBR	Neoprene				
 Adapter, SAE 37 (JIC) - Steel	-8	3/8	W54A32N	W11J340	W11M340	9/16-18	0.81	1.10	1.00
	-8	1/2	W54A33N	W11J340	W11M340	3/4-16	0.91	1.10	1.00
	-12	5/8	W54A52N	W11J54041	W11M540	7/8-14	1.07	1.52	1.38
	-12	3/4	W54A53N	W11J54041	W11M540	1 1/16-12	1.24	1.52	1.38
	-16	1	W54A62N	W11J64041	W11M640	1 5/16-12	1.27	1.97	1.75
 Adapter, Braze - Brass	-8	1/2	W60L38012	W11J340	W11M340	—	0.37	1.12	1.00
	-12	5/8	W60L58058	W11J54041	W11M540	—	0.72	1.54	1.38
	-16	7/8	W60L68078	W11J64041	W11M640	—	0.99	1.96	1.75

 Dust Cap    Dust Plug	Coupling Dash Size	Part Numbers				 Lock Washer    Jam Nut
		Dust Cap	Dust Plug	Lock Washer	Jam Nut	
	-8	WA 10134 00	WA 10137 00	W62A34N	W28A34N	
	-12	WA 10154 00	WA 10157 00	W62A54N	W28A54N	
	-16	WA 10164 00	WA 10167 00	W62A64N	W28A64N	

All dimensions in inches.

H A N S E N C O U P L I N G S