

**Service Information System**

Shutdown SIS

[Previous Screen](#)

Product: INDUSTRIAL ENGINE
Model: C2.2 INDUSTRIAL ENGINE C6M
Configuration: C2.2 Industrial Engine C6M00001-UP

Disassembly and Assembly**C0.5, C0.7, C1.1, C1.5, C1.6 and C2.2 Industrial Engines**

Media Number -KENR6229-00

Publication Date -01/ 03/ 2007

Date Updated -29/ 03/ 2007

i02602629

Engine Oil Pan - Remove and Install

SMCS - 1302-010

Removal Procedure

NOTICE

Keep all parts clean from contaminants.

Contaminants may cause rapid wear and shortened component life.

NOTICE

Care must be taken to ensure that fluids are contained during performance of inspection, maintenance, testing, adjusting and repair of the product. Be prepared to collect the fluid with suitable containers before opening any compartment or disassembling any component containing fluids.

Dispose of all fluids according to local regulations and mandates.

Note: The two cylinder, the three cylinder and the four cylinder engines have different engine oil pans. The removal procedure is similar for all models.

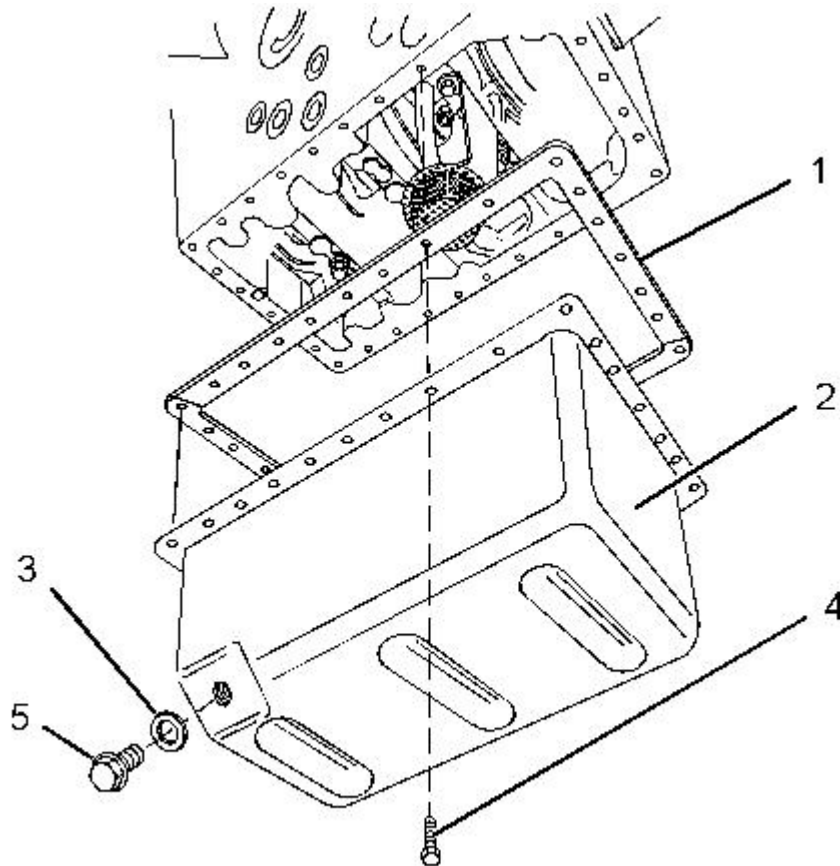

Illustration 1

g01326659

Typical example

1. Remove drain plugs (5) from engine oil pan (2). Drain the engine oil into a suitable container for storage or disposal. Refer to Operation and Maintenance Manual, "Oil Filter Change" for the correct procedure.
2. Remove sealing washers (3) from drain plugs (5) .
3. Remove bolts (4) from engine oil pan (2) .
4. Remove engine oil pan (2) from the engine.
5. Remove joint (1) .

Installation Procedure

NOTICE

Keep all parts clean from contaminants.

Contaminants may cause rapid wear and shortened component life.

Note: The two cylinder, the three cylinder and the four cylinder engines have different engine oil pans. The installation procedure is similar for all models.

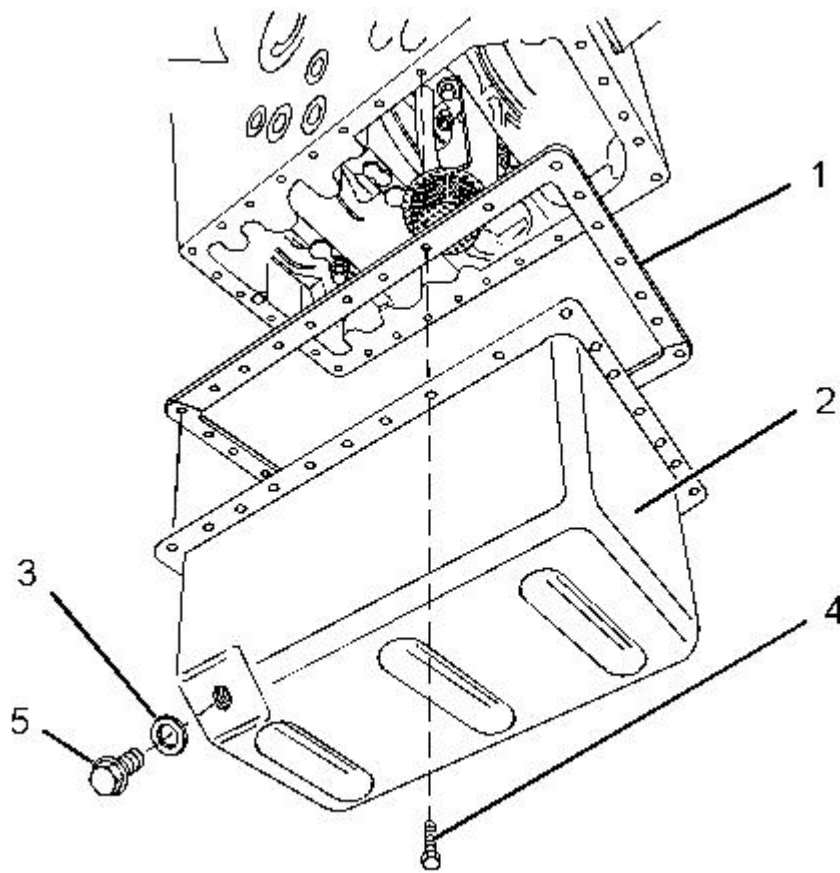

Illustration 2

g01326659

1. Ensure that the engine oil pan is clean and free from damage. Clean the mating surface of the cylinder block.
2. Install a new joint (1) and engine oil pan (2) to the engine.
3. Install bolts (4) and tighten to a torque of 11 N·m (97 lb in).
4. Install drain plugs (5) and sealing washers (3) to oil pan (2) .

For C0.5 and C0.7, tighten the drain plugs to a torque of 34 N·m (25 lb ft).

For C1.1, C1.5, C1.6 and C2.2 engines, tighten the drain plugs to a torque of 34 N·m (25 lb ft).

5. Fill the engine oil pan to the correct level. Refer to Operation and Maintenance Manual, "Engine Oil Filter Change" for the correct procedure.

[Copyright 1993 - 2012 Caterpillar Inc.](#)

Sat Sep 29 17:33:13 CDT 2012

[All Rights Reserved.](#)

[Private Network For SIS Licensees.](#)