

Serial Number:

T Series > T1510 - 3 Cyl Compact Tractor (11/07 - 12/12) > 03 - Transmission > 03.18 - Hst Controls

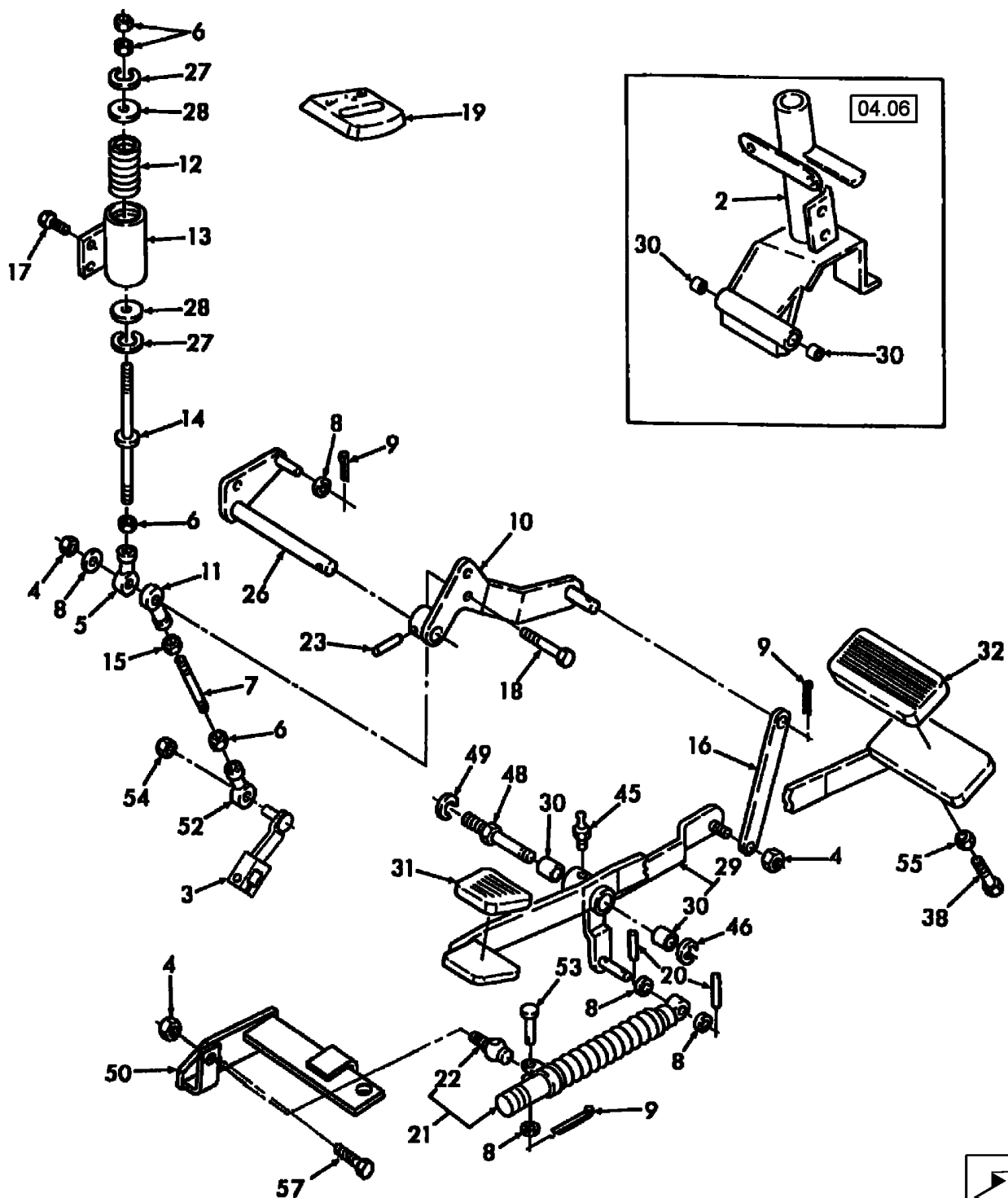

Serial Number:

T Series > T1510 - 3 Cyl Compact Tractor (11/07 - 12/12) > 03 - Transmission > 03.18 - Hst Controls

Indicators	Ref	Qty	PN	Description	Usage
⇒	2	1	SBA334450 372	STEERING COLUMN	STEERING COLUMN
⇒	3	1	SBA340103 583	LEVER	LEVER
⇐	3	1	SBA340107 280	CONTROL LEVER	CONTROL LEVER; USED ON & ABOVE PIN Z7NGL1498-T1520
⇒	4	3	SBA022600 008	NUT U, M8	NUT - U, M8
⇐	5	1	SBA334800 360	ROD	ROD; End
⇒ 	6	4	89706690	NUT M8 x 1.25, CI 8	NUT - M8 x 1.25, CI 8
⇐	7	1	SBA358511 130	ROD	ROD
⇔ 	8	5	86511315	WASHER 8.4mm ID x 16mm OD x 1.8mm Thk	WASHER - 8.4mm ID x 16mm OD x 1.8mm Thk
⇔	9	4	SBA030102 016	COTTER PIN	COTTER PIN
⇐	10	1	SBA324350 171	CONNECTING LINK	CONNECTING LINK; Shift
⇐	11	1	SBA334800 420	TRACK ROD END ASSY	TRACK ROD END ASSY
	12	1	SBA398216 160	SPRING	SPRING; Uses (2) SBA026109105 Washers
⇐	13	1	SBA358350 451	HOLDER	HOLDER; Spring
⇐	14	1	SBA399430 990	ROD	ROD
⇐	15	1	SBA020109 125	NUT M8, LH Thd	NUT - M8, LH Thd
⇐	16	1	SBA324540 460	LINK	LINK; Link, Shift
⇔	17	2	SBA011510 820	CAPTIVE WASHER SCREW Hex, M8 x 20, G5	CAPTIVE WASHER SCREW - Hex, M8 x 20, G5
⇐ 	18	1	120061	BOLT Hex, M8 x 60mm L, CI 8.8	BOLT - Hex, M8 x 60mm L, CI 8.8
	19	1	SBA398121 400	PLUG	PLUG
⇔	20	2	SBA030102 016	COTTER PIN	COTTER PIN
⇐	21	1	SBA378910 020	DAMPER	DAMPER; Includes: Ref. 22
⇐	22	1	SBA334800 370	SILENTBLOC	SILENTBLOC; End
⇐	23	1	SBA030300 625	PIN	PIN; Spring, 6 x 25
⇐	26	1	SBA324201 080	ARM	ARM; Shift

Indicators	Ref	Qty	PN	Description	Usage
← 	27	2	301642	SNAP RING M28, Int	SNAP RING - M28, Int
←	28	2	SBA026109 105	WASHER	WASHER
⇒	29	1	SBA358011 440	PEDAL	PEDAL; Includes: Ref. 30
←	30	4	SBA398511 310	DRIVE BUSHING	DRIVE BUSHING
←	31	1	SBA398122 031	RUBBER PAD	RUBBER PAD; Step
←	32	1	SBA398122 151	RUBBER PAD	RUBBER PAD; Step
⇒	38	1	86977786	BOLT Hex, M6 x 1 x 25mm, Cl 8.8	BOLT - Hex, M6 x 1 x 25mm, Cl 8.8
←	45	1	SBA060610 000	LUBE NIPPLE M6 x .075	LUBE NIPPLE - M6 x .075
←	46	1	SBA036800 012	SNAP RING	SNAP RING; E-Type
←	48	1	SBA358210 390	SHAFT	SHAFT; Pedal
←  	49	1	86729275	LOCK WASHER 5/8" ID x 0.634" OD x .156" Thk CST ZND	LOCK WASHER - 5/8" ID x 0.634" OD x .156" Thk CST ZND
←	50	1	SBA358350 411	HOLDER	HOLDER; Spring
⇒	51	2	SBA011510 820	CAPTIVE WASHER SCREW Hex, M8 x 20, G5	CAPTIVE WASHER SCREW - Hex, M8 x 20, G5
←	52	1	SBA334800 360	ROD	ROD; End
←	53	1	SBA031310 820	PIN	PIN; M8 x 20
⇒	54	1	SBA022600 008	NUT U, M8	NUT - U, M8
⇒  	55	1	15896221	NUT Hex, M6, 5.20mm High, Cl 10	NUT - Hex, M6, 5.20mm High, Cl 10