

9. CLUTCH HOUSING

DISASSEMBLY, MAINTENANCE

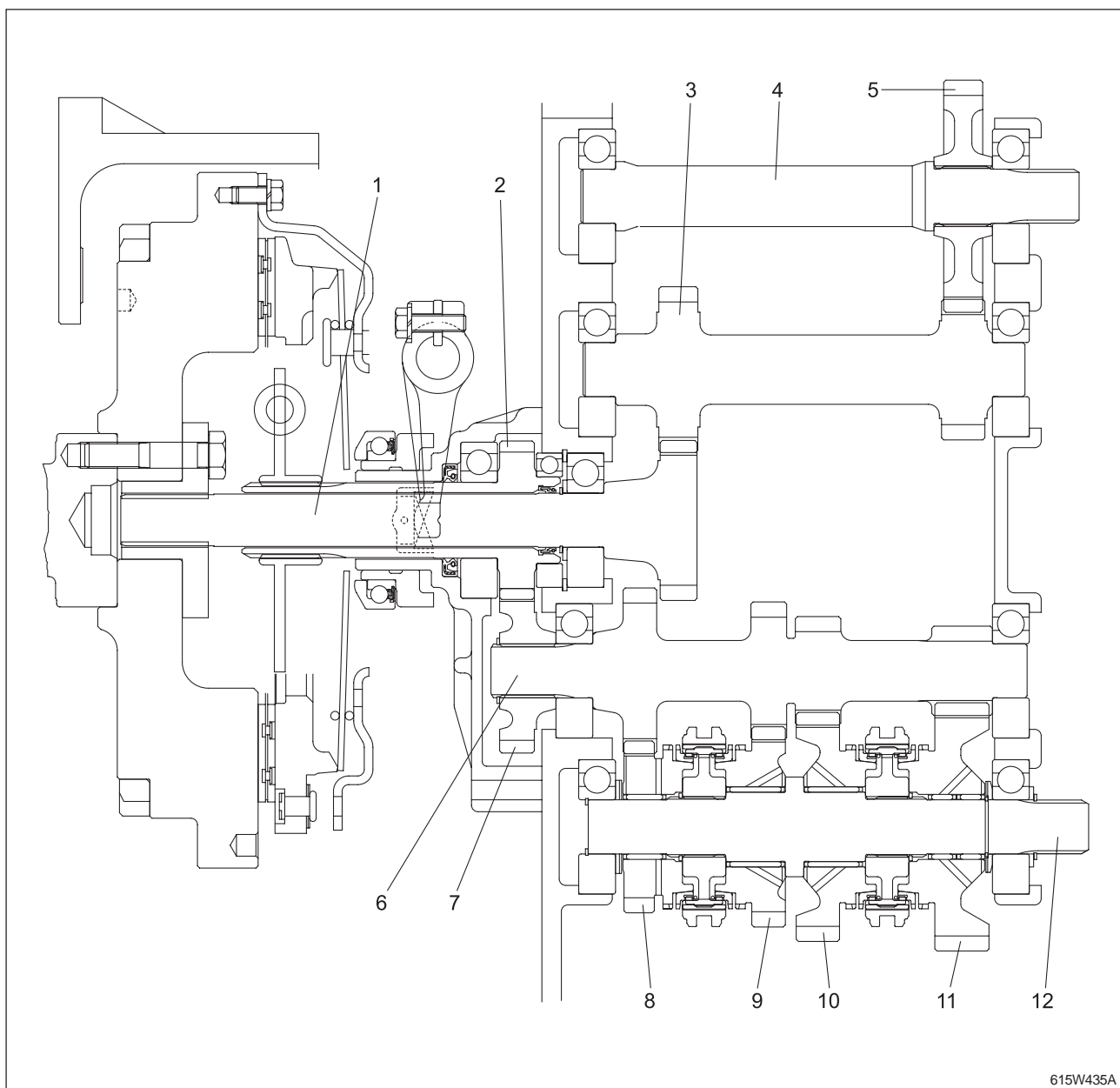

615W435A

(1) 22 Gear Shaft (PTO)

(2) 25 Gear Shaft

(3) 23-19 Gear Shaft (PTO)

(4) Counter Shaft (PTO)

(5) 33 Gear (PTO)

(6) 26 Gear

(7) Main Shaft Gear

(8) 24 Gear

(9) 29 Gear

(10) 33 Gear

(11) 36 Gear

(12) Counter Shaft