

## HYDRAULIC PIPES - (114)

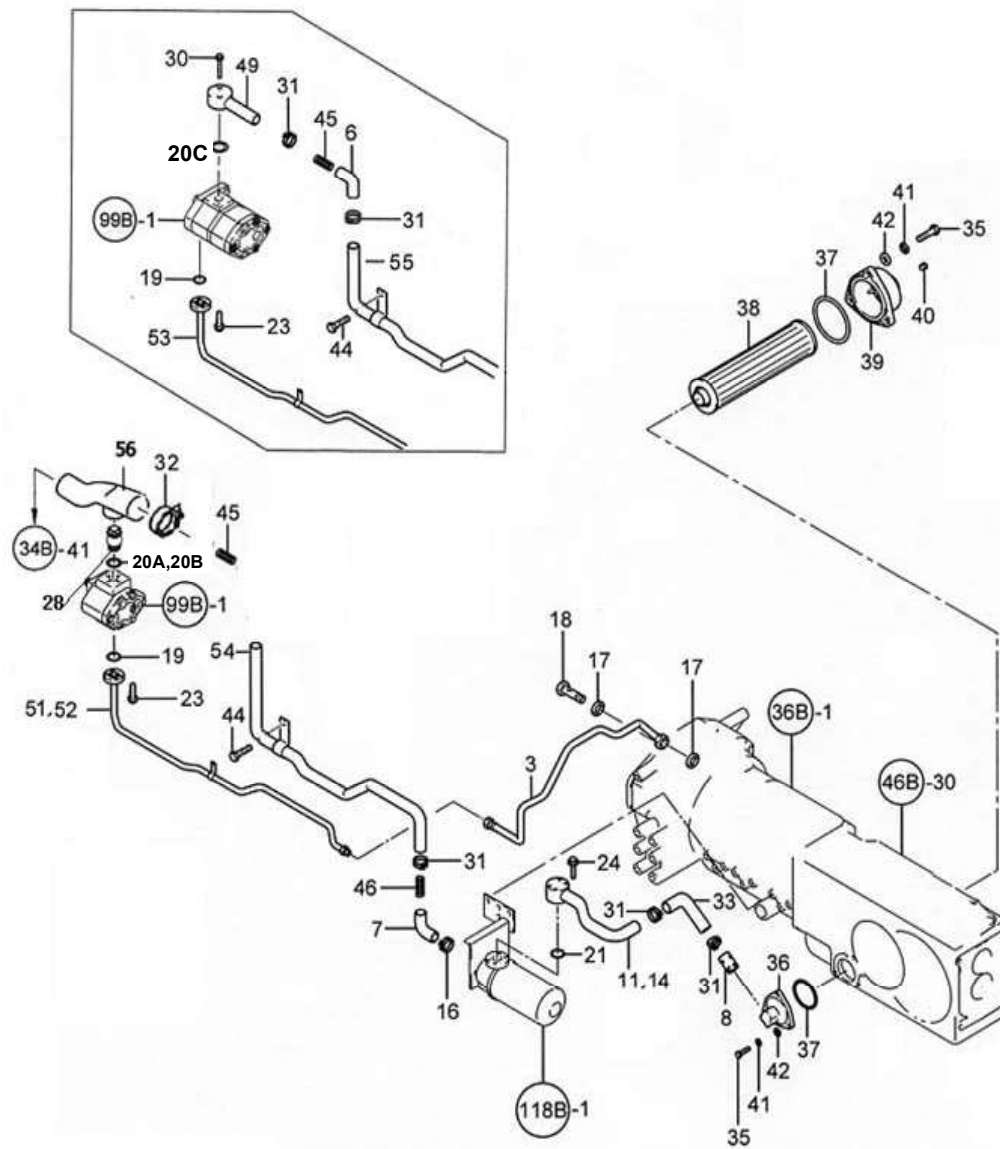

## (CHASSIS)

## HYD PIPING-(114)

A:2910 B:3510 C:3820 D:4220 E:4720  
F: 2910i G:3110i H:3510i I:3820i J:4220i K:4720i

			(Qt'y)											Remark
Key	Part No	Part description	A	B	C	D	E	F	G	H	I	J	K	
3	NTB4030000C1	REAR PIPE ASS'Y HI-PRESS	1	1	1	1	1	1	1	1	1	1	1	
6	TTB4060000B4	HOSE, LO-PRESS-A	1	1	1	1	1	1	1	1				
6	TNB4330000A4	HOSE, LO-PRESS-A									1	1	1	
7	NTB4070000A4	RUBBER HOSE, LO-PRESS	1	1	1	1	1	1	1	1	1	1	1	
8	NTB4080000A4	CONNECTING PIPE	1	1				1	1	1				
8	TNB4080000A4	CONNECTING PIPE			1	1	1				1	1	1	
11	NTB411H000A2	PIPE FLANGE, LO-PRESS			1	1	1				1	1	1	
14	NTB4140000A2	PIPE FLANGE, LO-PRESS	1	1				1	1	1				
16	23010-044000	BAND, HOSE	1	1	1	1	1	1	1	1	1	1	1	
17	23414-200026	COPPER PACKING	2	2	2	2	2	2	2	2	2	2	2	
18	TTB4180000A4	BOLT	1	1	1	1	1	1	1	1	1	1	1	
19	24311-000200	O-RING(P)	1	1	1	1	1	1	1	1	1	1	1	
20A	24311-000240	O-RING(P)	1	1										
20B	24311-000180	O-RING(P)						1	1	1				
20C	24341-000260	O-RING(S)			1	1	1				1	1	1	
21	24321-000260	O-RING	1	1	1	1	1							
23	26106-060252	FLANGE BOLT	4	4	4	4	4	4	4	4	4	4	4	
24	26106-060602	FLANGE BOLT						4	4	4				
24	26106-060502	FLANGE BOLT	4	4	4	4	4				4	4	4	
28	TCC9040000A4	JOINT	1	1				1	1	1				
30	26013-080502	BOLT W/WASHER			2	2	2				2	2	2	
31	NTB4310000A4	BAND, HOSE	3	3	5	5	5	3	3	3	5	5	5	
32	23000-041000	CLAMP, HOSE	3	3				3	3	3				
33	TNB4330000A4	HOSE, LO-PRESS	2	2	2	2	2	2	2	2	2	2	2	
35	26116-080262	BOLT	6	6	6	6	6	6	6	6	6	6	6	
36	TNB4360000A3	SCREEN COVER(RH)	1	1	1	1	1	1	1	1	1	1	1	
37	24321-000860	O-RING(G)	2	2	2	2	2	2	2	2	2	2	2	
38	TNB4380000A4	STRAINER	1	1	1	1	1	1	1	1	1	1	1	
39	TB38300000A3	SCREEN COVER(LH)	1	1	1	1	1	1	1	1	1	1	1	
40	TB38330000A4	TAPER PLUG	1	1	1	1	1	1	1	1	1	1	1	
41	22217-080000	SPRING WASHER	6	6	6	6	6	6	6	6	6	6	6	
42	22137-080000	PLAN WASHER	6	6	6	6	6	6	6	6	6	6	6	
44	26106-080162	HEX FLANGE BOLT			1	1	1				1	1	1	
45	TTB4360000A4	SPRING-A	1	1	1	1	1	2	2	2	1	1	1	
46	TTB4370000A4	SPRING-B	1	1	1	1	1	1	1	1	1	1	1	
49	NTB4490000A4	FLANGE, LO-PRESS			1	1	1				1	1	1	
51	NTB4510000C2	FRONT PIPE ASS'Y HI-PRESS	1	1				1	1	1				
52	NTB4520000C2	FRONT PIPE ASS'Y HI-PRESS	1	1				1	1	1				
53	NTB4530000B2	FRONT PIPE ASS'Y HI-PRESS			1	1	1				1	1	1	
54	NTB4540000B2	PIPE ASS'Y LO-PRESS	1	1				1	1	1				
55	NTB4550000A2	PIPE ASS'Y LO-PRESS			1	1	1				1	1	1	
56	NTB4560000A3	RUBBER PIPE, LO-PRESS	1	1				1	1	1				

## HYDRAULIC FILTER - (118)

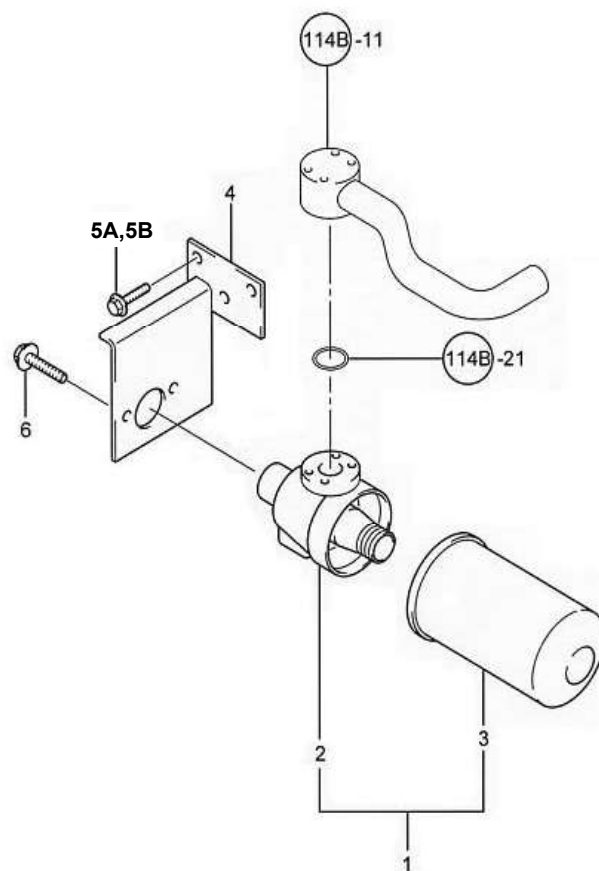

(CHASSIS)

(HYD FILTER)-(118)

A:2910 B:3510 C:3820 D:4220 E:4720  
F: 2910i G:3110i H:3510i I:3820i J:4220i K:4720i

(Qt'y)													Remark
Key	Part No	Part description	A	B	C	D	E	F	G	H	I	J	
1	NTB8010000A3	HYD FILTER ASS'Y	1	1	1	1	1	1	1	1	1	1	
2	TTB8020000A3	COVER, FILTER ASS'Y	1	1	1	1	1	1	1	1	1	1	
3	NTB8030000A3	FILTER ASS'Y	1	1	1	1	1	1	1	1	1	1	
4	NTB8040000A3	BRACKET FILTER	1	1	1	1	1	1	1	1	1	1	
5A	26106-080162	HEX FLANGE BOLT	3	3	3	3	3						
5B	26106-100202	HEX FLANGE BOLT						3	3	3	3	3	
6	26106-080162	HEX FLANGE BOLT	2	2	2	2	2	2	2	2	2	2	