

---

## SECTION 90 - PLATFORM

### Chapter 1 - Platform

#### CONTENTS

| Section | Description                 | Page  |
|---------|-----------------------------|-------|
| 90 105  | Hood .....                  | 90-2  |
| 90 100  | Rear Hood Side Panels ..... | 90-4  |
| 90 110  | Dash Console .....          | 90-6  |
| 90 120  | Seat .....                  | 90-11 |
| 90 114  | ROPS .....                  | 90-30 |
|         | Fuel Tank .....             | 90-34 |
| 90 116  | Fenders .....               | 90-36 |
| 90 115  | Deck .....                  | 90-40 |

**Op. 90 105****HOOD****Removal**

1. Release the hood latch, 1, and open the hood.

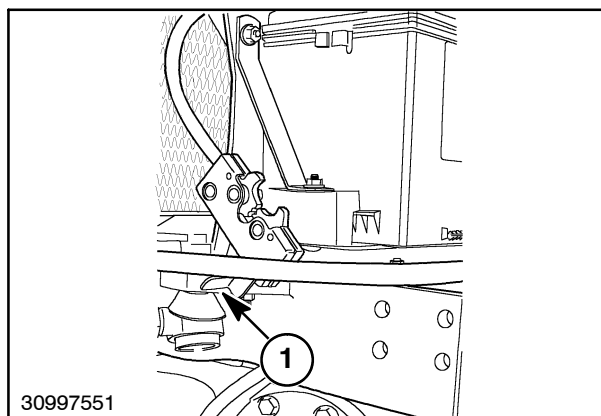

1

2. Disconnect the headlight wire harness connector, 1, from the headlight wire, 2.

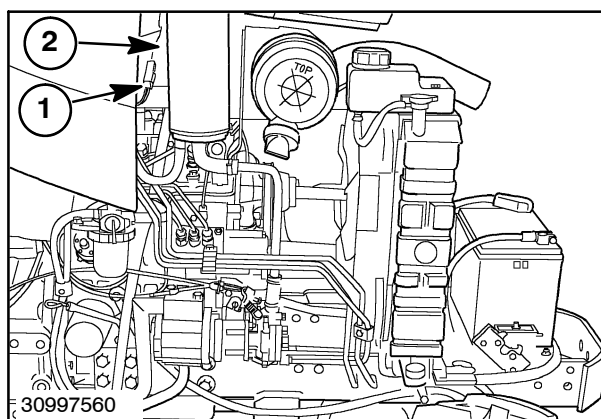

2

3. Loosen and remove the four hood mounting bolts, 1.
4. Remove the hood from the tractor.

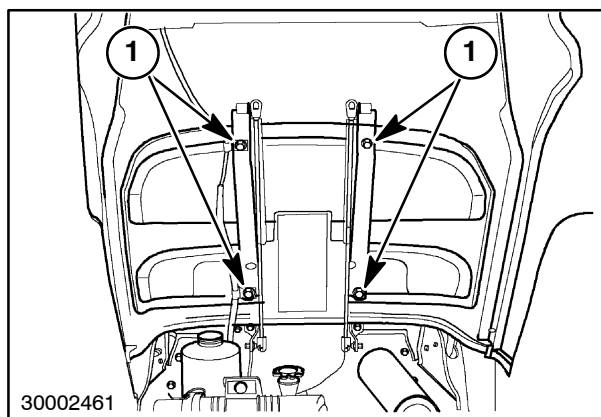

3

### Installation

1. Position the hood so that the four mounting holes in the hood align with the holes in the hood mounting bracket.
2. Install and tighten the four hood mounting bolts, 1.

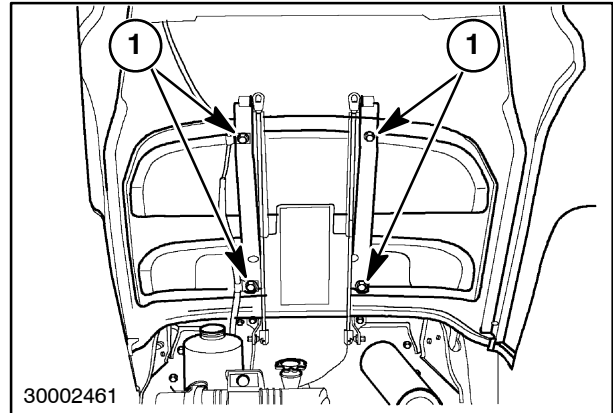

4

3. Connect the headlight wire harness connector, 1, to the headlight wire, 2.
4. Close and latch the hood.

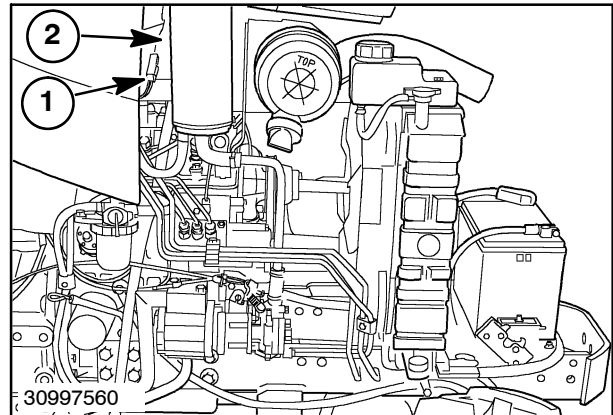

5

**Op. 90 100****REAR HOOD SIDE PANELS****Removal**

1. Loosen and remove the two retaining bolts, 1, that secure the left and right panels together.
2. Open the hood.

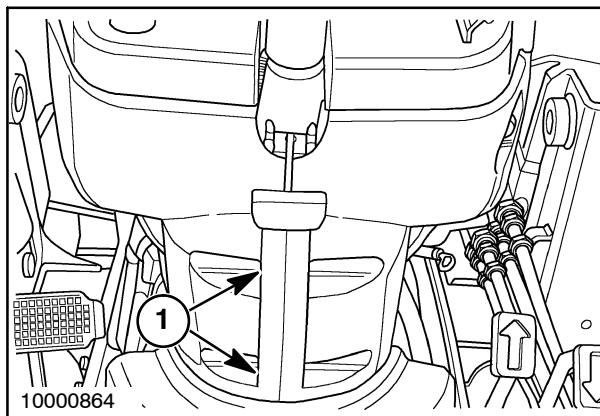

6

3. Loosen the two retaining bolts, 1, on each side of the firewall, that secure the rear hood side panels, 2.
4. Remove the rear hood side panels.

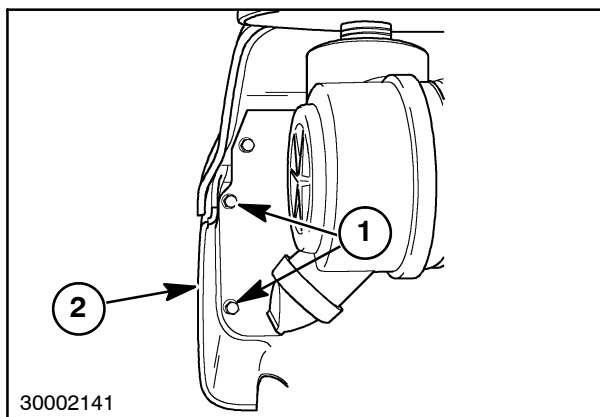

7

**Installation**

1. Position the rear hood side panels on the tractor, aligning the mounting holes with the holes in the firewall.
2. Install the two retaining bolts, 1, through the firewall and into the rear hood side panels, 2. Tighten the bolts.

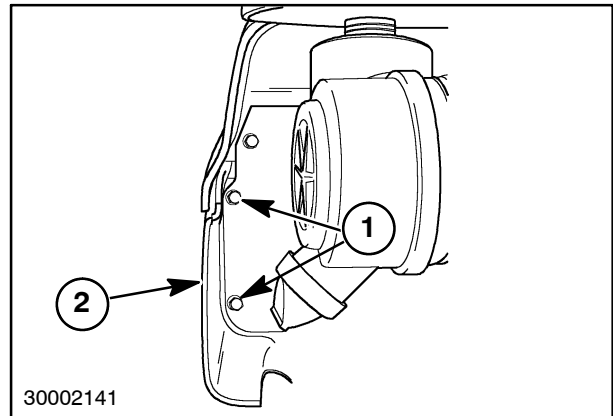

8

3. Install and tighten the two retaining bolts, 1, that secure the left and right panels together.

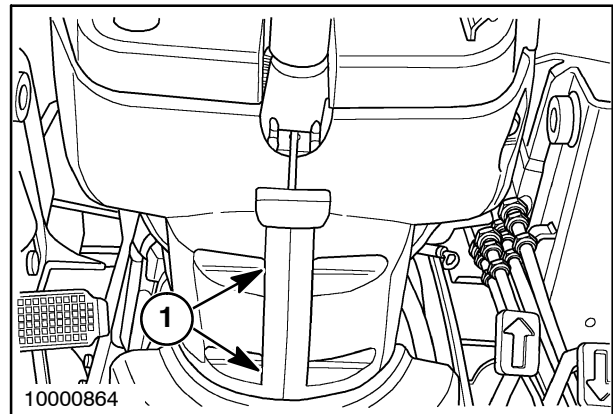

9

**Op. 90 110****DASH CONSOLE****Removal**

1. Loosen and remove the two instrument panel retaining screws, 1.
2. Remove the instrument panel, 2, from the dash console, 3.
3. Disconnect the instrument panel wire harness connector from the instrument panel.

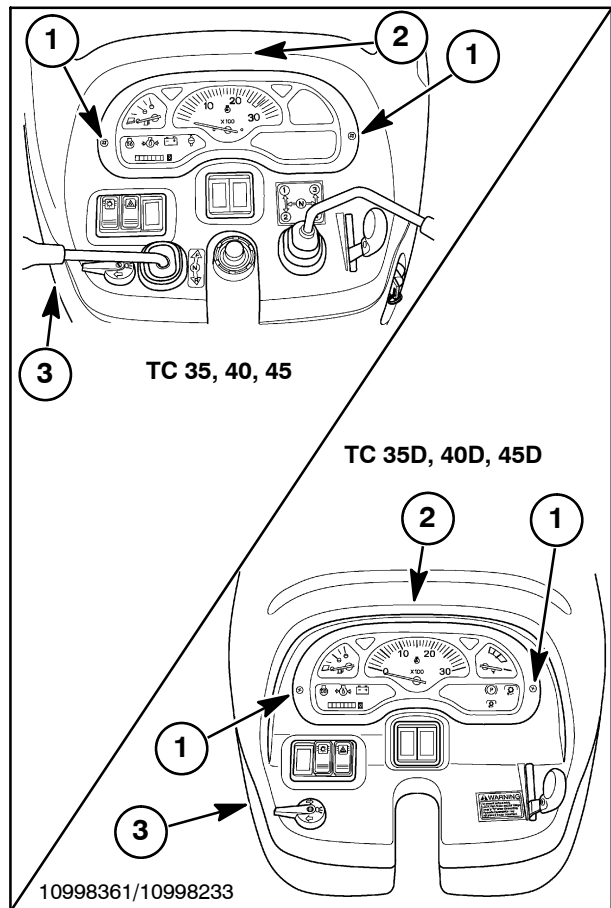

10

4. Remove the two rear hood side panels, 1 and 2.

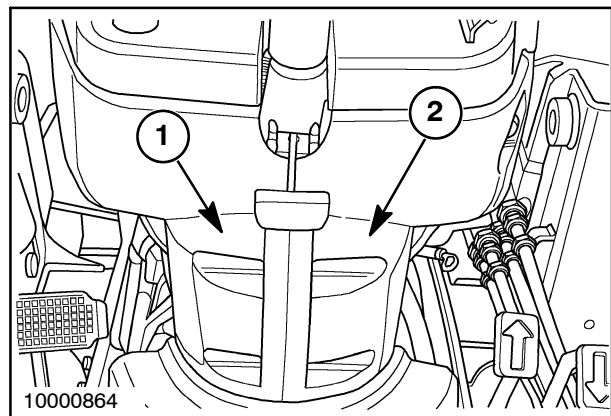

11

5. Disconnect the wire connector plug from the headlight switch, 1, the hazard flasher switch, 2, and the turn indicator switch, 3.

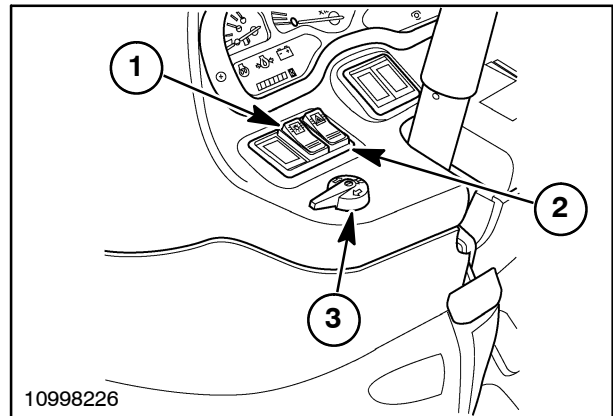

12

6. Remove the cotter pin, 1, and the rivet, 2, from the throttle lever, 3, and disconnect the throttle cable, 4, from the throttle lever, 3.

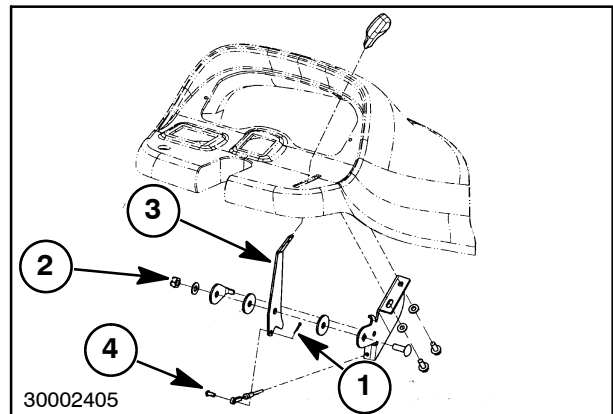

13

**NOTE:** Step 7 applies to the TC35, TC40, and TC45 tractors equipped with the 12x12 transmission only.

7. Remove the E-clip, 1, from the shuttle gear lever, 2. Remove the retaining ring, 3, from the knuckle, 4. Drive the pin, 5, from the knuckle, 4. Remove the shuttle gear lever, 2, from the dash console, 6. Remove the E-clips, 7, from the clevis pin, 8, on the main gear lever, 9. Remove the clevis pin, 8, and pull the main gear lever, 9, out of the dash console, 6.
8. Loosen and remove the six retaining bolts securing the dash console to the firewall.
9. Remove the dash console.

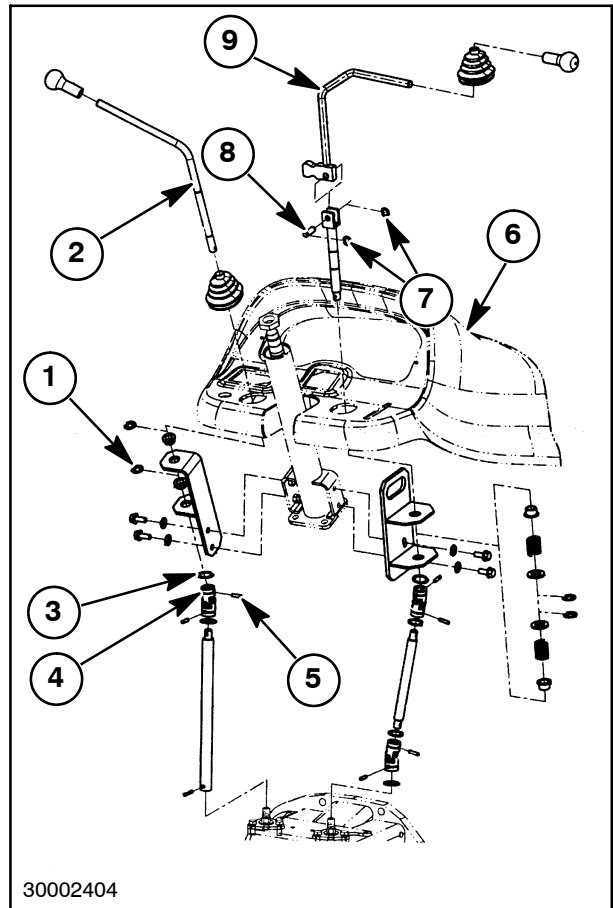

14

### Installation

1. Position the dash console on the firewall, aligning the mounting holes.
2. Install the six retaining bolts through the firewall and into the dash console. Install the fuse panel and secure with two nuts.
3. Tighten the six retaining bolts.

**NOTE:** Step 4 applies to the TC35, TC40, and TC45 tractors equipped with the 12x12 transmission only.

4. Install the main gear lever, 9, through the dash console, 6, and connect to the main shift shaft. Secure the main gear lever to the main shift shaft with the clevis pin, 8, and the E-clips, 7. Install the shuttle gear lever, 2, through the dash console, 6, and connect to the knuckle, 4, on the shuttle shift shaft. Drive the pin, 5, through the knuckle, 4, and the shuttle gear lever, 2.



5. Install the throttle cable, 4, on the throttle lever, 3. Secure with the rivet, 2, and the cotter pin, 1.

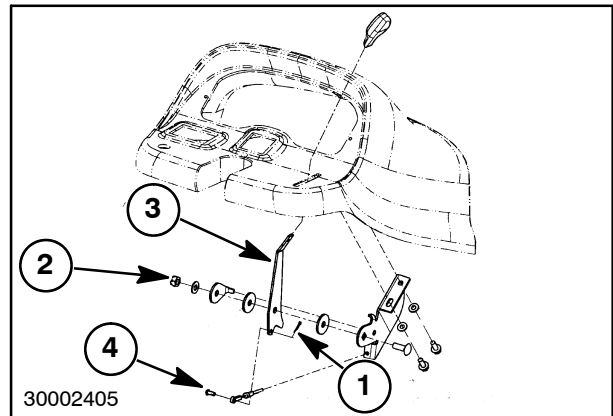

15

6. Connect the wire connector plugs to the headlight switch, 1, the hazard flasher switch, 2, and the turn indicator switch, 3.

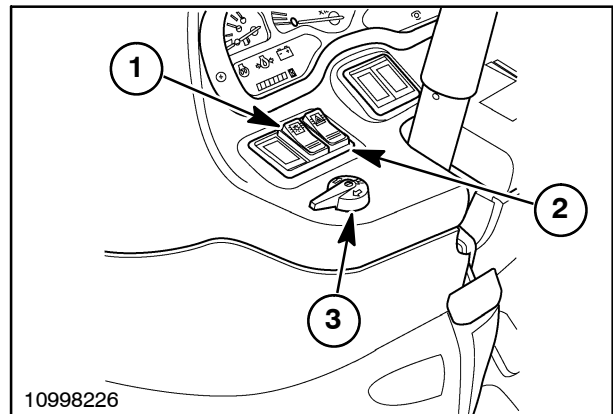

16

7. Install the rear hood side panels, 1 and 2.
8. Connect the instrument panel wire harness connector to the instrument panel.

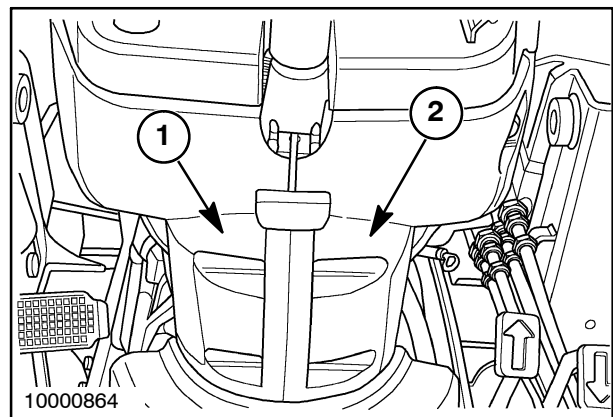

17

9. Install the instrument panel, 2, into the dash console, 3, and secure with the two retaining screws, 1.

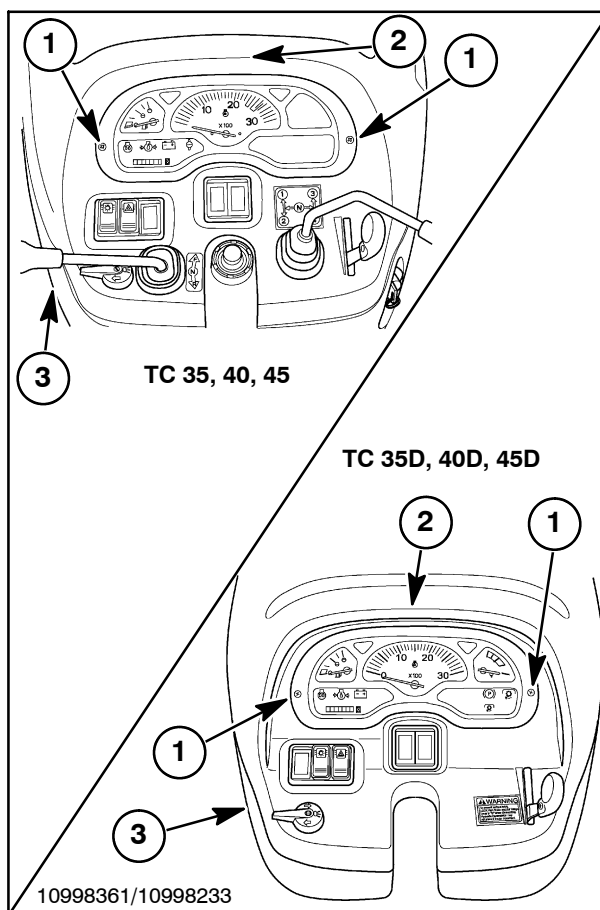

**Op. 90 120**

**SEAT**

**Removal - TC35D, TC40D, TC45D**

1. Disconnect the seat safety start switch wire connector, 1, from the seat start safety switch, 2.

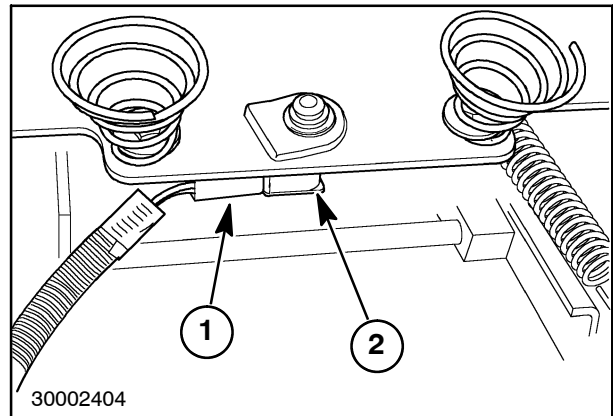

## SECTION 90 - PLATFORM

2. Remove the two springs, 1, from the seat base, 2.
3. Loosen and remove the four nuts, 3, and the four washers, 4.
4. Remove the spring brackets, 5.
5. Lift and remove the seat, 6, and the seat base, 2, from the platform, 7.

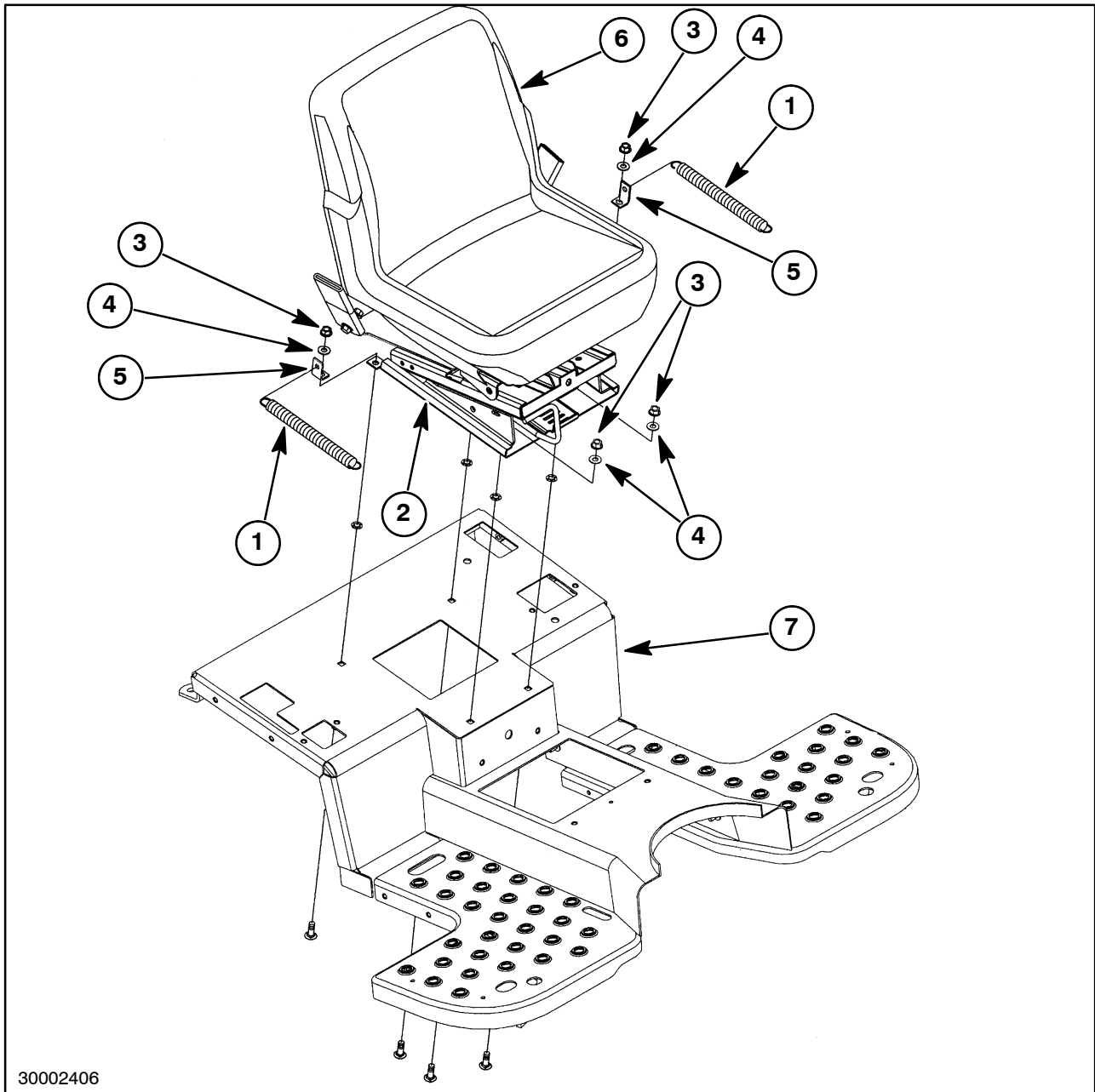

30002406

**Disassembly**

**NOTE:** Use rebuild kit #86530936 to rebuild the seat on the TC35D, TC40D, and TC45D.

1. Remove the seat from the tractor.

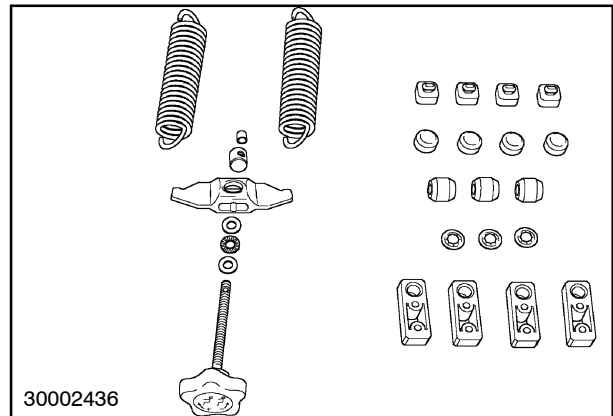

21

2. Place the seat assembly on a bench. Fold the seat front, and loosen the bolt, 1, in the center of the swivel base.
3. Remove the seat and the swivel base from the seat pedestal.

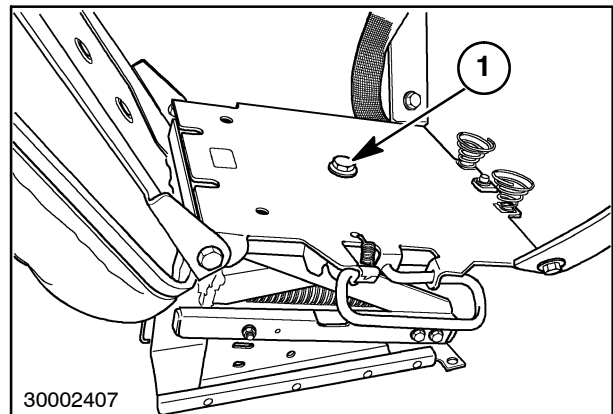

22

4. Lift the fore and aft slide lever, 1, and slide the seat pedestal, 2, off of the slide base, 3.

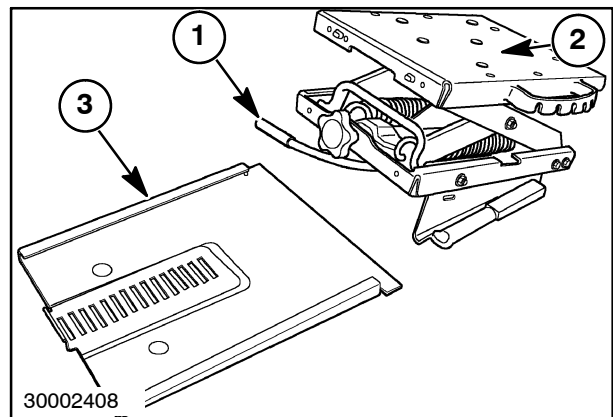

23

5. Remove the four nuts, 1, from the carriage bolts.

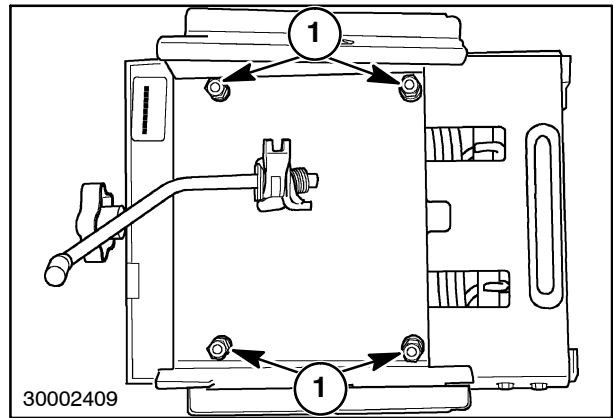

24

6. Remove the slide plate, 1, from the seat pedestal, 2.
7. Turn the weight adjustment knob, 3, clockwise, until it is all the way in, to reduce the spring tension on the extension springs, 4.

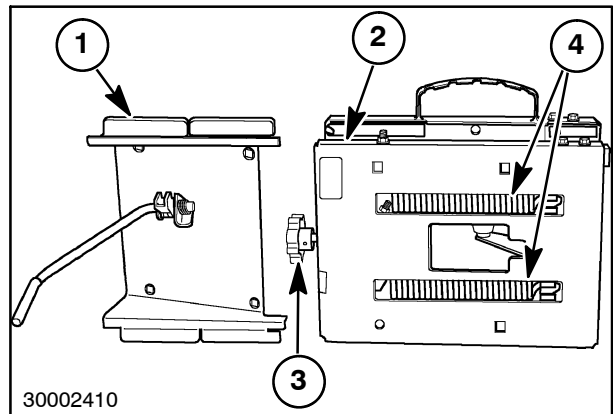

25

**⚠ WARNING ⚠**

**The seat pedestal is under spring tension. The pedestal must be compressed while removing the nuts and carriage bolts in step 8.**

8. Place the seat pedestal, 1, on the bench with the bottom side facing up. Remove the nut, 2, from the carriage bolt, on both sides of the seat base.

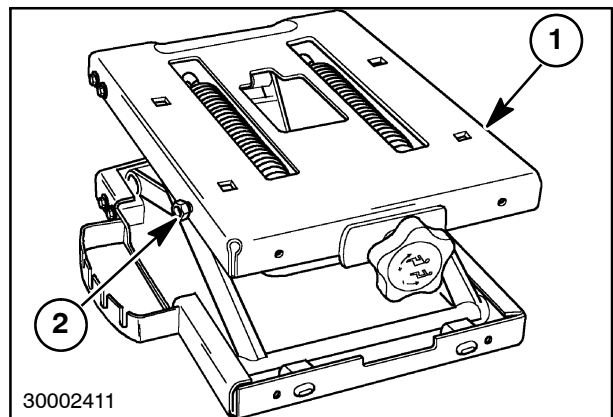

26

9. Remove the slider stop brackets, 1, and the carriage bolts, 2, from the seat pedestal assembly.

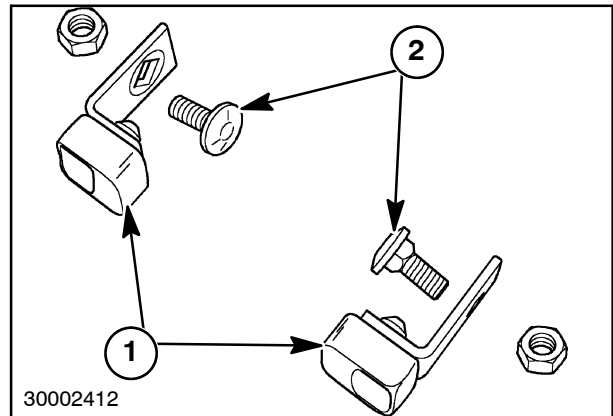

27

**⚠ WARNING ⚠**

Keep hands and fingers away from the scissors linkage when removing from the slide base. Serious personal injury could result if extremities are caught in the scissors linkage.

10. Remove the four bolts, 1, securing the top slide base, 2. Remove the slide base, 2.

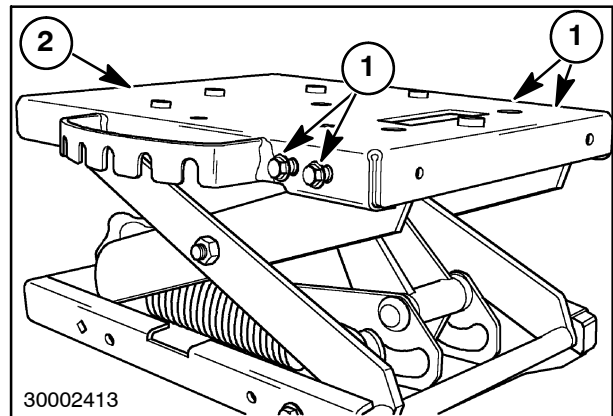

28

11. Remove the four bolts, 1, from the shaft blocks.
12. Remove the shaft blocks, 2, from the scissors linkage, 3.

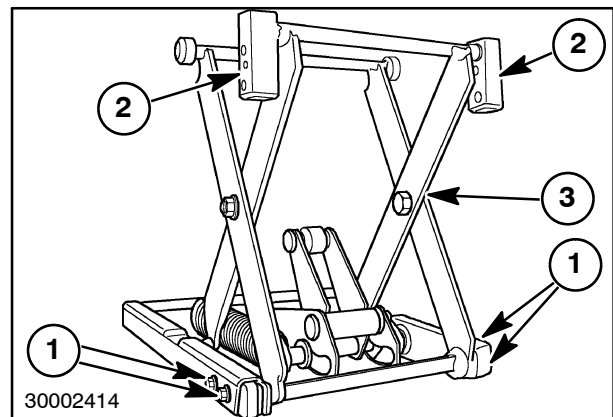

29

13. Remove the scissors linkage, 1, from the slide base, 2. Remove the shaft blocks, 3.

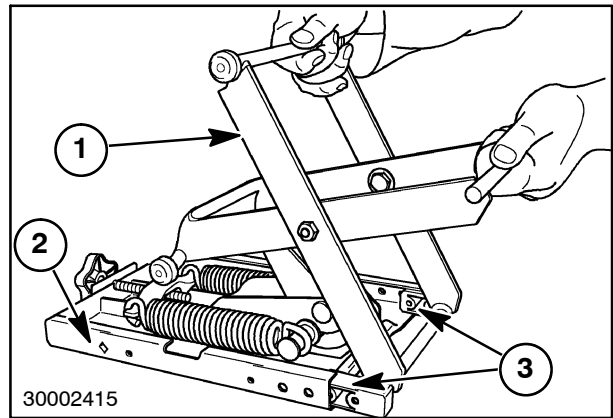

30

14. Remove the four rollers, 1, from the scissors linkage, 2.

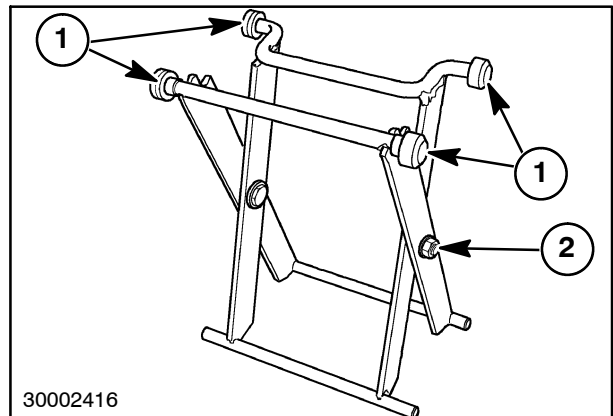

31

15. Drive the roll pin, 1, out of the weight adjustment knob and shaft assembly, 2.
16. Turn the adjustment knob, 3, counter clockwise to relieve any tension on the extension springs, 4.
17. Disconnect the extension springs, 4, from the weight adjust bar, 5.

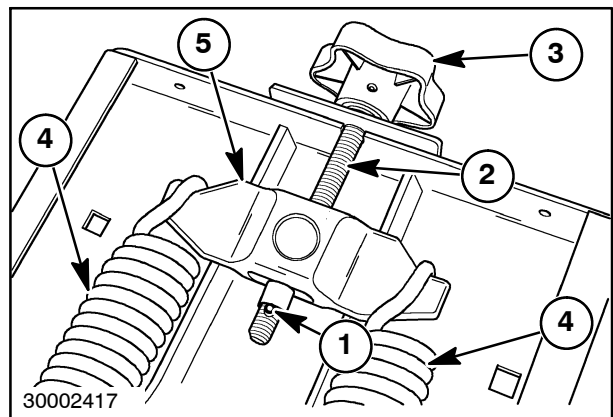

32



18. Turn the weight adjustment knob and shaft assembly, 1, counter clockwise and remove from the weight adjust bar, 2, and the slide base, 3.
19. Remove the two thrust races, 4, and the thrust bearing, 5, from the weight adjust shaft.

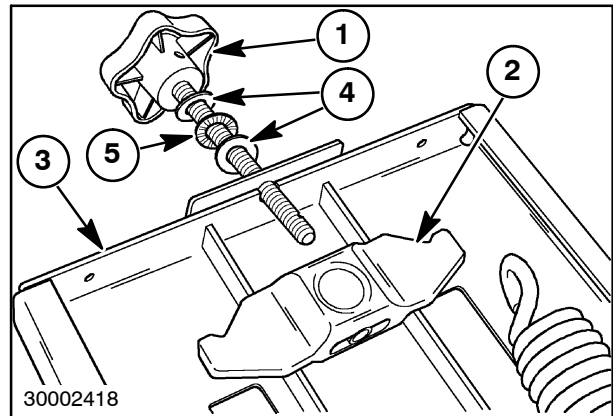

33

20. Remove the weight adjust nut, 1, and the weight adjust spacer, 2, from the weight adjust bar, 3.

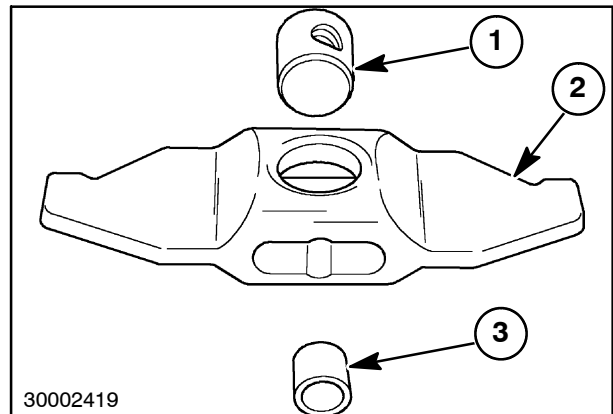

34

21. Remove the three pushnuts, 1, from the linkage pins.
22. Remove the top linkage pin, 2, and roller, 3.

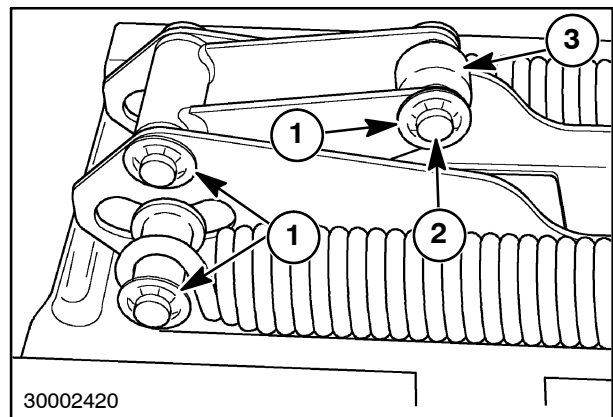

35

23. Remove the linkage pivot pin, 1, from the pivot linkage, 2.

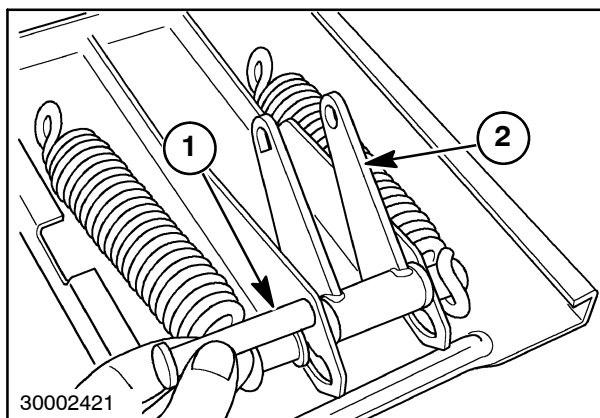

36

24. Remove the extension spring, 1, and the collar, 2, from the spring pin, 3.

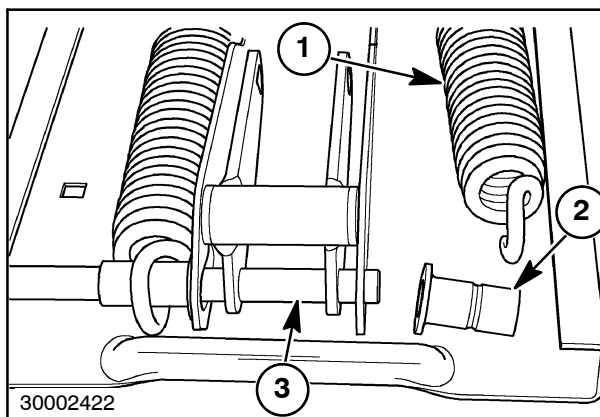

37

25. Remove the pivot linkage, 1, from the spring pin, 2.

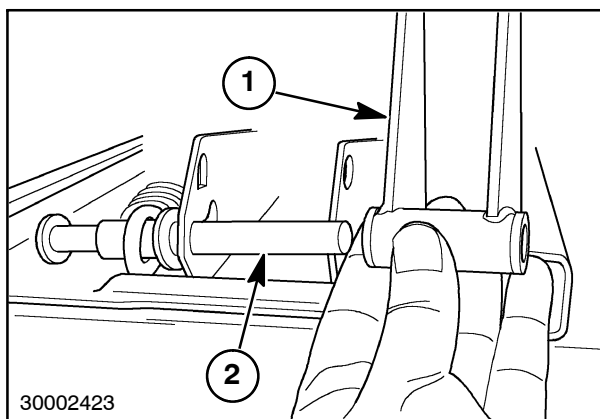

38

26. Remove the remaining extension spring, 1, collar, 2, and spring pin, 3.

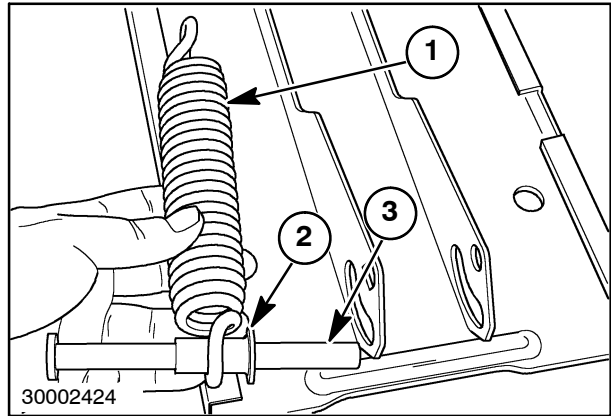

39

**Inspection**

1. Clean all parts in a suitable solvent and allow to air dry.
2. Check all parts for damage or excess wear. Repair or replace as necessary.

**Assembly**

1. Lightly lubricate the spring pin, 3, and the collar, 2, with Loctite Anti Seize 767, and install a new extension spring, 1.

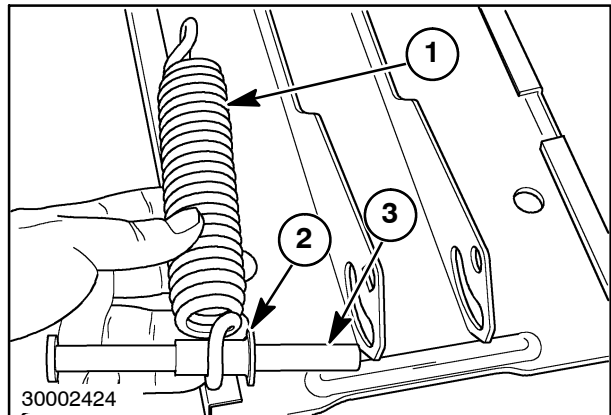

40

2. Install the pivot linkage, 1, onto the spring pin, 2, and slide the spring pin, 2, through the holes in the slide base, 3.

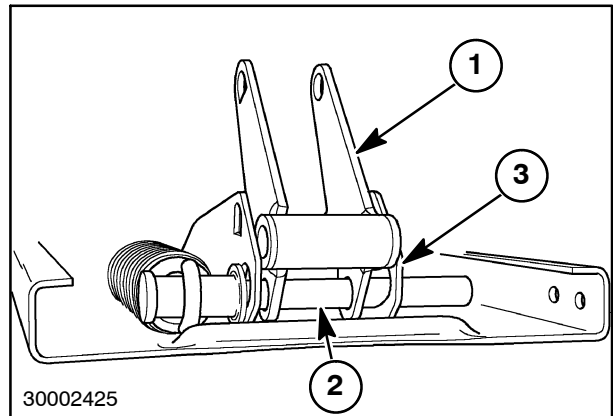

41

3. Install the remaining collar, 1, and a new extension spring, 2, onto the spring pin, 3. Install a new pushnut, 4, onto the spring pin, 3.

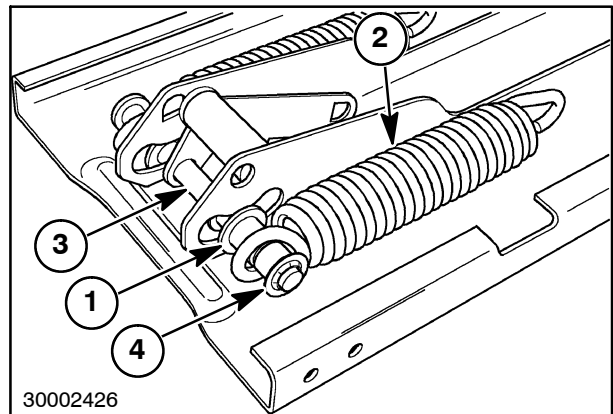

42

4. Lightly lubricate the linkage pivot pin, 1, with Anti Seize 767, and install through the slide base, 2, and the linkage pivot, 3. Secure with a new push-nut, 4.

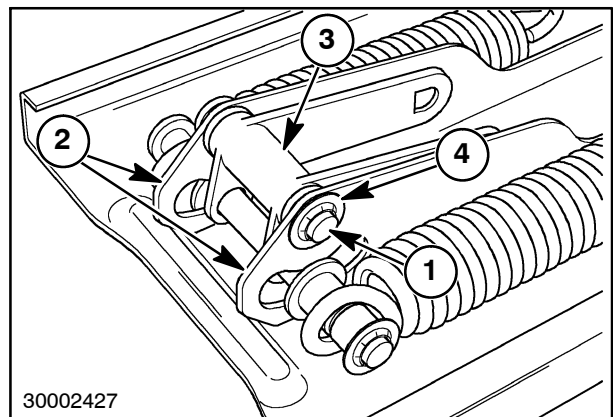

43

5. Lightly lubricate the top linkage pin, 1, and install through the top of the pivot linkage, 2, while installing a new roller, 3, on the linkage pin, 1. Secure with a new pushnut, 4.

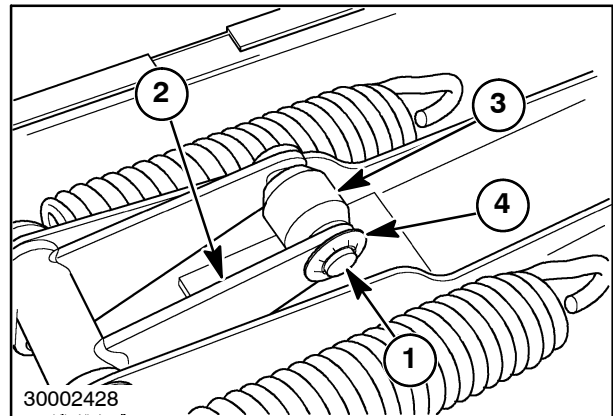

44

6. Lightly lubricate the new thrust bearing, 1, with Anti Seize 767, and install along with the two new thrust races, 2, onto the new adjustment knob and shaft assembly, 3. Insert the assembly through the hole in the slide base, 4.

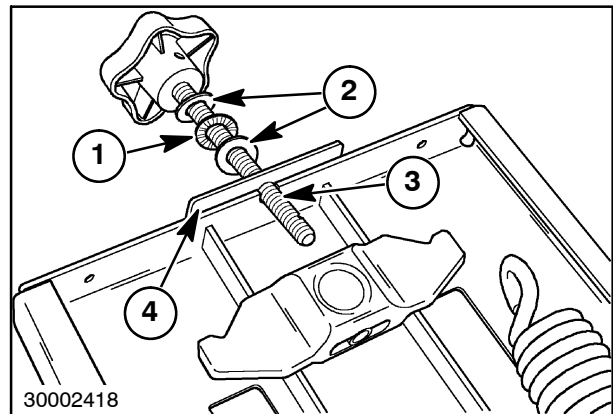

45

7. Install a new weight adjust nut, 1, into the new weight adjust bar, 2, and thread the adjustment knob and shaft assembly, 3, into the weight adjust nut, 1.
8. Install a new weight adjust spacer, 4, and drive a new roll pin, 5, through the weight adjust shaft. Connect the extension springs, 7, to the weight adjust bar, 2.

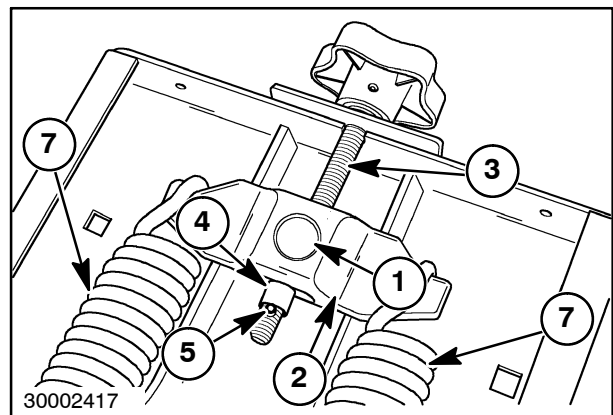

46

9. Lightly lubricate the four new rollers, 1, and install onto the scissors linkage, 2.

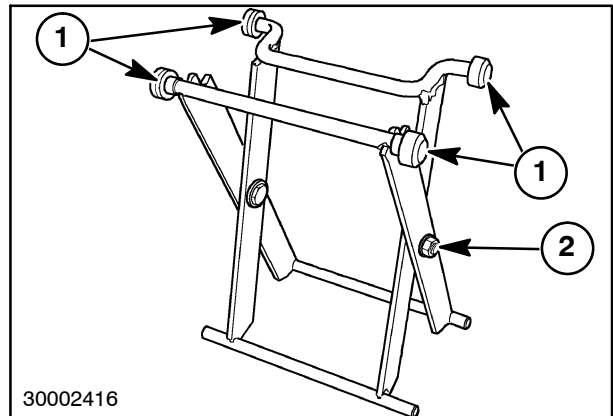

47

10. Lightly lubricate two new shaft blocks, 1, and install on the scissors linkage, 2.
11. Install the scissors linkage, 2, onto the slide base, 3.
12. Secure the shaft blocks to the slide base, 3, with two screws, 4, in each side.

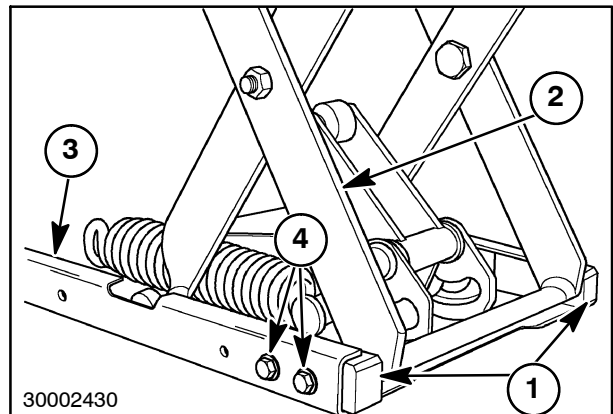

48

13. Lightly lubricate two new shaft blocks, 1, and install onto the scissors linkage, 2.

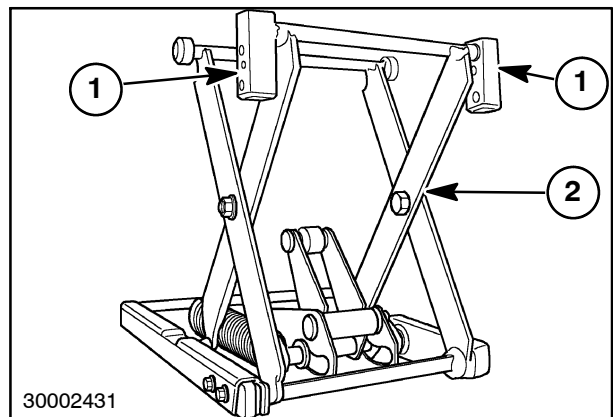

49

14. Install new bumpers, 1, in the top slide base, 2.

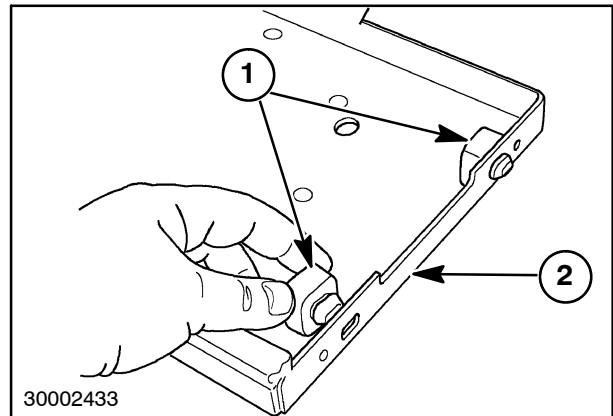

50

15. Install the top slide base, 2, onto the scissors linkage, and secure with two bolts, 1, on each side.

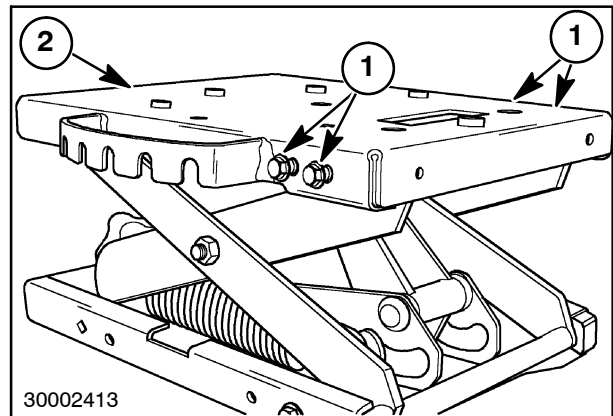

51

16. Install new bumpers, 1, in the slide stop brackets, 2.

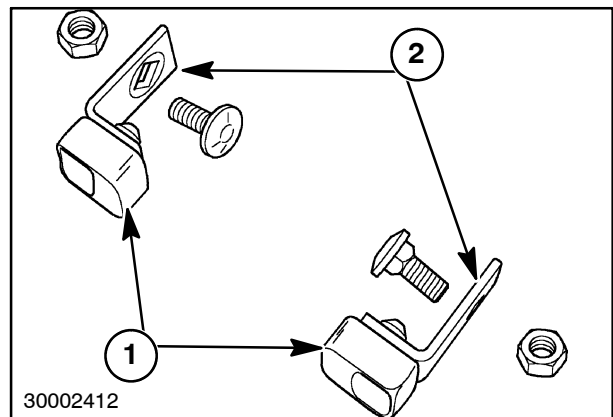

52

17. Compress the seat pedestal assembly, 1, and install the slide stop brackets, 2. Secure with the carriage bolts, and nuts.

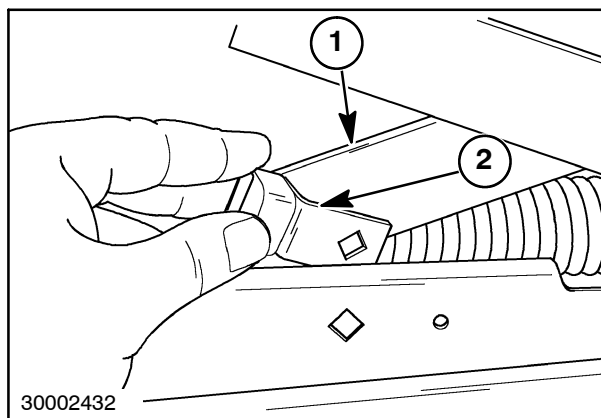

53

18. Position the seat pedestal assembly, 1, on the bench with the bottom side facing up.

19. Install the slide plate, 2, onto the seat pedestal assembly, 1. Secure with four carriage bolts and nuts, 3.

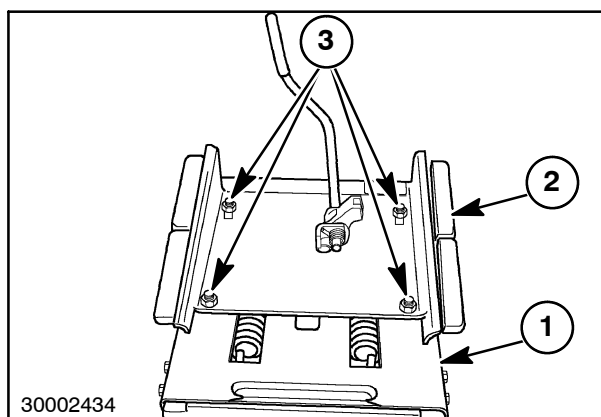

54

20. Push down on the fore and aft slide lever, 1, and slide the slide base, 2, onto the slide plate, 3.

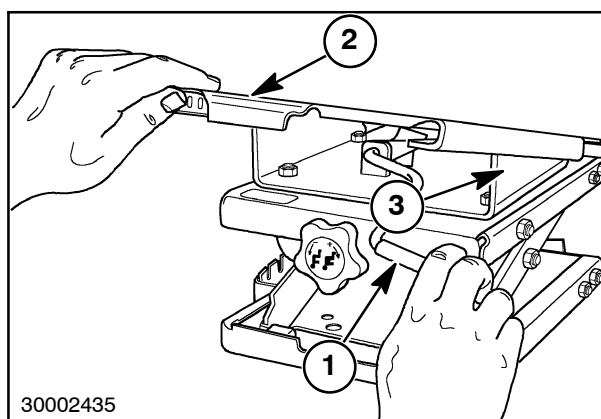

55



21. Install the seat swivel base, onto the seat pedestal assembly. Install and tighten the retaining bolt, 1.
22. Install the seat assembly onto the tractor.

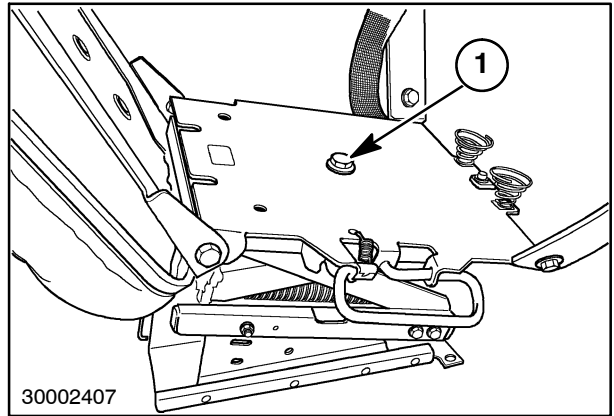

**Installation**

1. Place the seat, 6, and the seat base, 2, on the platform, 7, aligning the mounting holes in the seat base with the mounting bolts in the platform.
2. Install the spring brackets, 5, onto the two rear mounting bolts.
3. Install the four washers, 4, and the four nuts, 3, onto the mounting bolts.
4. Tighten and torque the nuts, 3, to 32.5-41.2 ft.-lbs. (44.1-55.9 N·m).
5. Attach the two springs, 1, to the spring brackets, 5, and the seat base, 2.

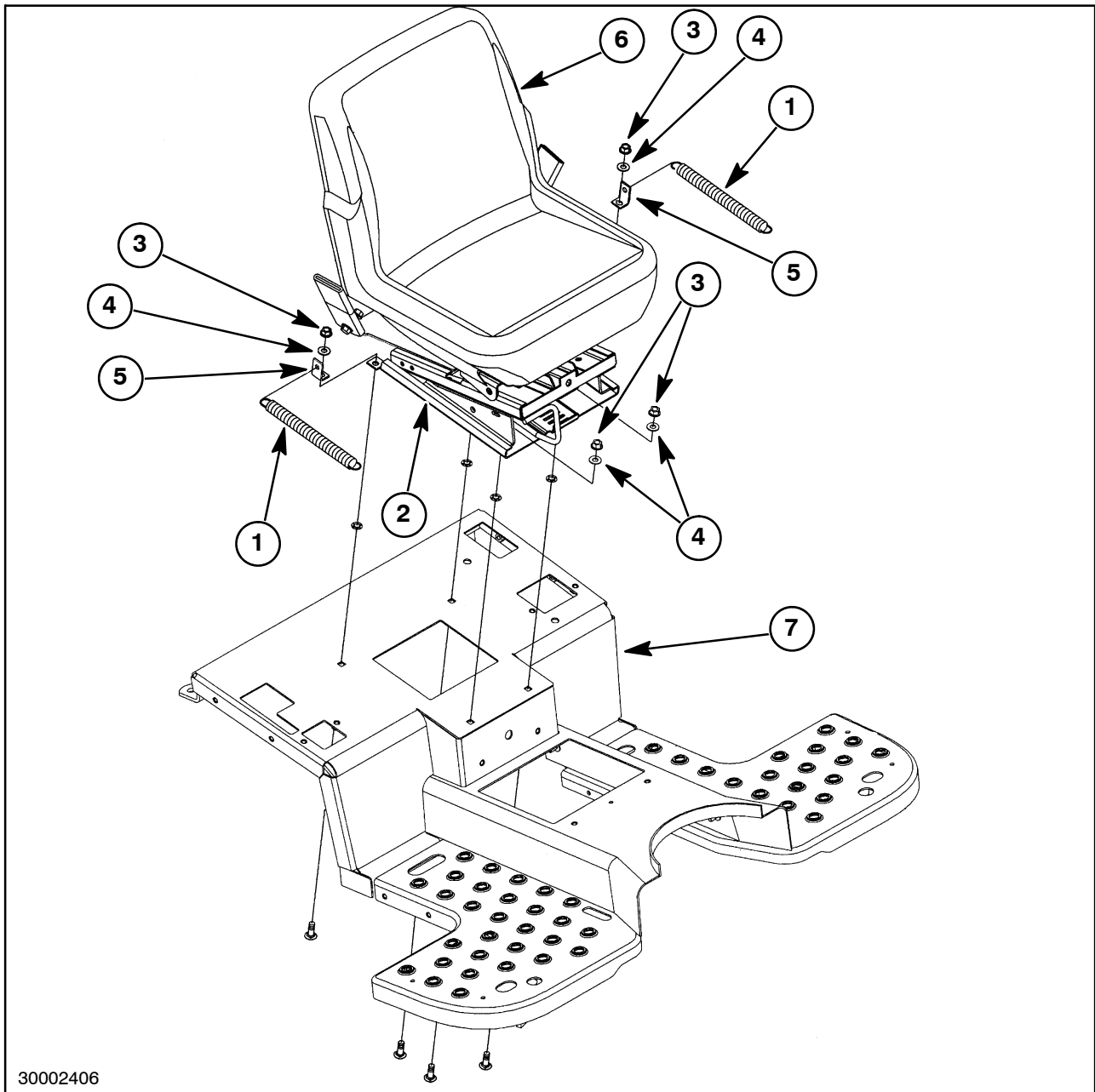

30002406

6. Connect the seat safety start wire connector, 1, to the seat safety start switch, 2.

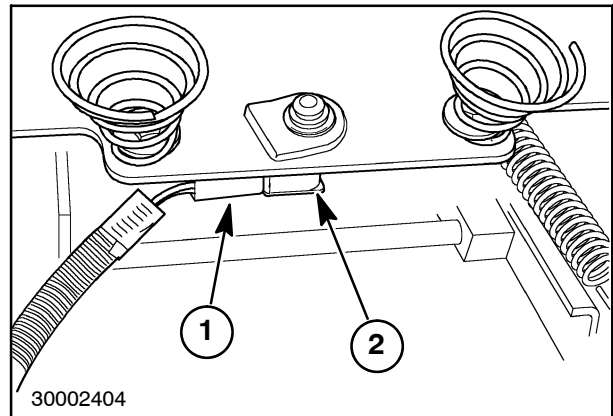

58

#### Removal - TC35, TC40, TC45

1. Disconnect the seat safety start switch wire connector, 1, from the seat start safety switch, 2.

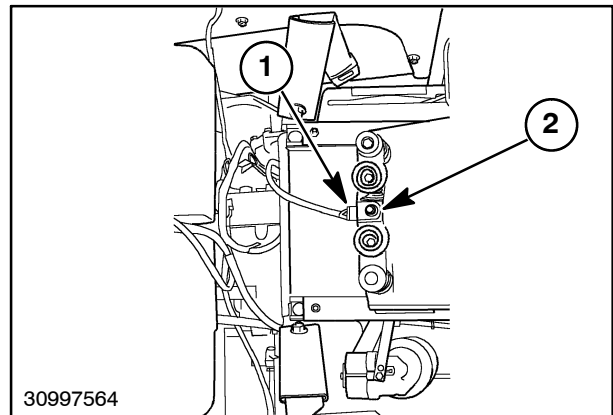

59

2. Loosen and remove the four nuts, 1, from the mounting bolts, 2.
3. Remove the seat, 3, and the safety belts, 4, from the seat mounting plate, 5.

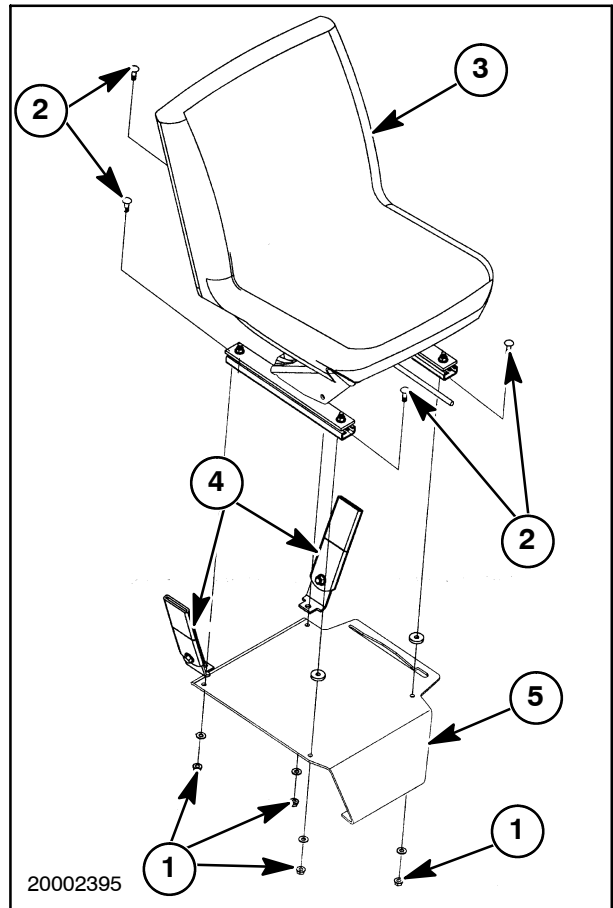

60

4. Loosen and remove the three mounting bolts, 1, and the nut, 2, that secure the seat mounting plate, 3, to the lift cover and the transmission cover.

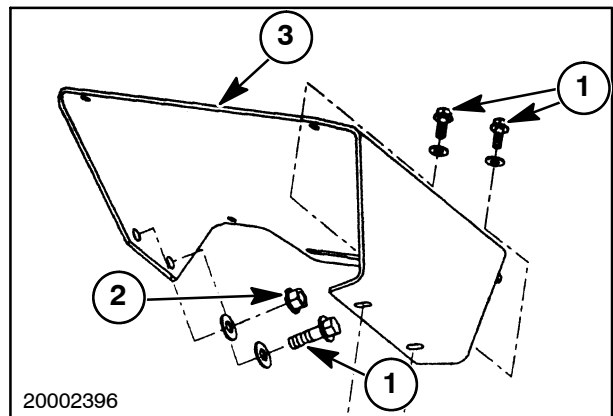

61

**Installation**

1. Install the seat mounting plate, 3, to the transmission cover, 5, and the lift cover, 4, with the three mounting bolts, 1, and the nut, 2. Tighten the nut and bolts.

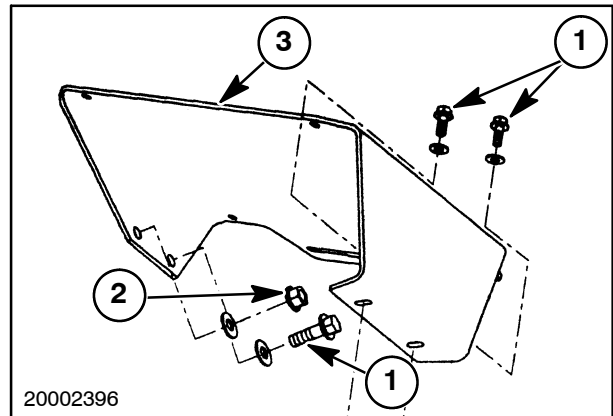

62

**NOTE:** Be sure to install the two spacers, 6, on the front two mounting bolts, between the seat, 3, and the seat mounting plate, 5.

2. Install the seat, 3, and the safety belts, 4, onto the seat mounting plate, 5. Secure with the mounting bolts, 2, and nuts, 1.
3. Tighten and torque the nuts, 1, to 16.6-21 ft.-lbs. (22.6-28.4 N·m).

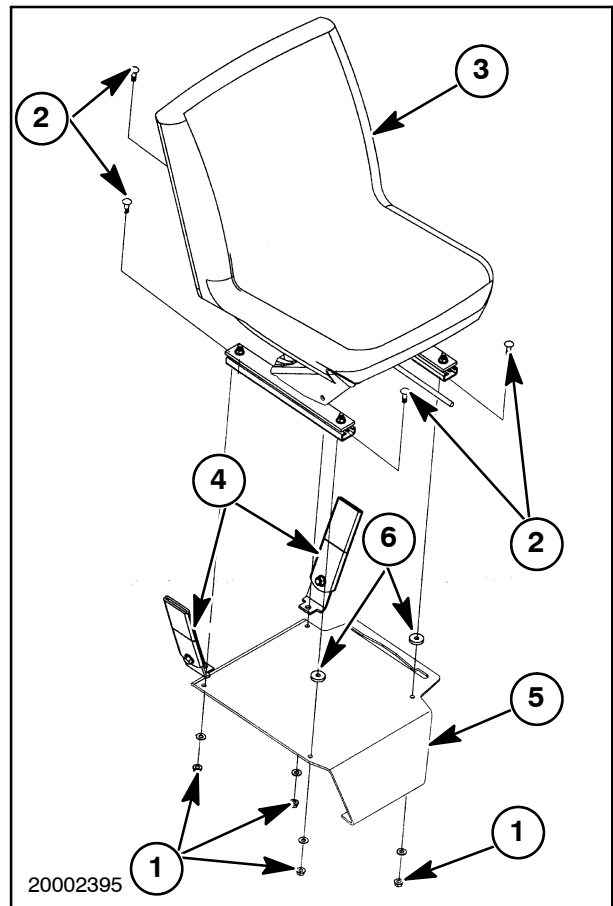

63

4. Connect the seat safety start wire connector, 1, to the seat safety start switch, 2.

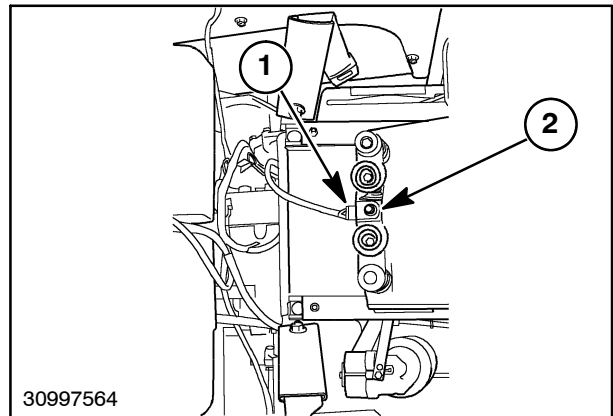

64

### Op. 90 114

### ROPS

**NOTE:** The fuel tank must be removed prior to Fixed ROPS removal.

### Removal

**NOTE:** Removal procedure is the same for the fixed ROPS, and the foldable ROPS.

1. Drain the fuel tank into a suitable container.
2. Loosen and remove the retaining bolts and nuts, 1, securing the fuel tank to the ROPS. Flip the seat front, and lift the fuel tank onto the seat base, temporarily.
3. Loosen and remove the retaining bolt, 1, from the stabilizer bar, 2. REMOVE the stabilizer bar, 2, from the stabilizer bracket. Repeat for the opposite side.

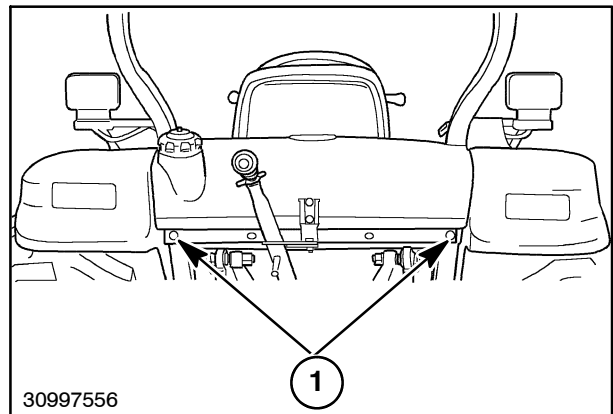

65

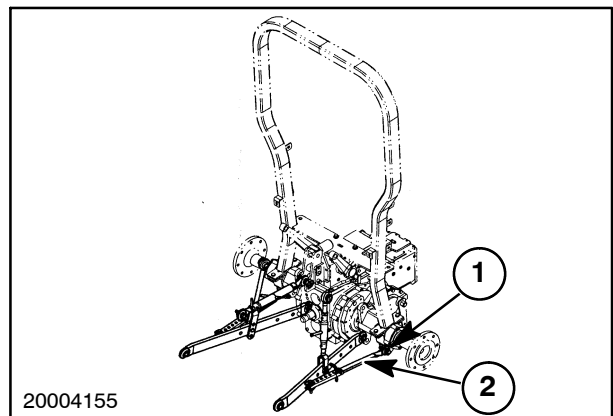

66

**NOTE:** Illustration shows location only of attaching hardware, 1, 2, and 3.

4. Loosen and remove the light bar retaining bolt, 1, and the fender mounting bolts, 2 and 3. Repeat for the opposite side.
5. Loosen and remove the stabilizer bracket retaining bolts, 4, and the stabilizer bracket, 5. Repeat for the opposite side.
6. Attach a suitable lifting device to a hoist, and to the ROPS for support when removing the remaining bolts.
7. Loosen and remove the retaining bolts, 6, from the ROPS and the lift cover. Remove the ROPS.

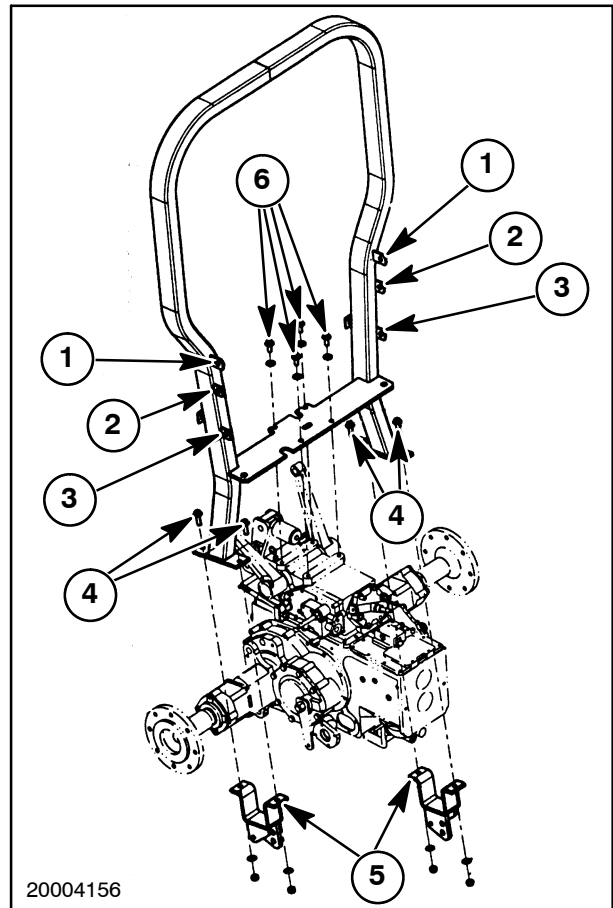

67

### Installation

**NOTE:** Installation procedure is the same for the fixed ROPS, and the foldable ROPS.

1. Attach a suitable lifting device to a host, and to the ROPS. Position the ROPS on the tractor aligning the mounting holes, 1, with the lift cover holes, 2. Install the mounting bolts, 3. Do not tighten the bolts at this time.
2. Attach the stabilizer brackets, 4, to the ROPS using the mounting bolts, 5. Repeat for the opposite side. Do not tighten the bolts at this time.

**NOTE:** Illustration shows location only of attaching hardware, 6 and 7.

3. Install the fender mounting bolts, 6, and the light bar retaining bolts, 7. Repeat for the opposite side. Do not tighten the bolts at this time.
4. Tighten and torque the stabilizer bracket bolts, 5, to 105 N·m (77 ft.-lb.).
5. Tighten and torque the ROPS to lift cover bolts, 3, to 74 N·m (54 ft.-lb.).
6. Tighten and torque the fender mounting bolts, 6, and the light bar retaining bolt, 7, to 25 N·m (19 ft.-lb.).

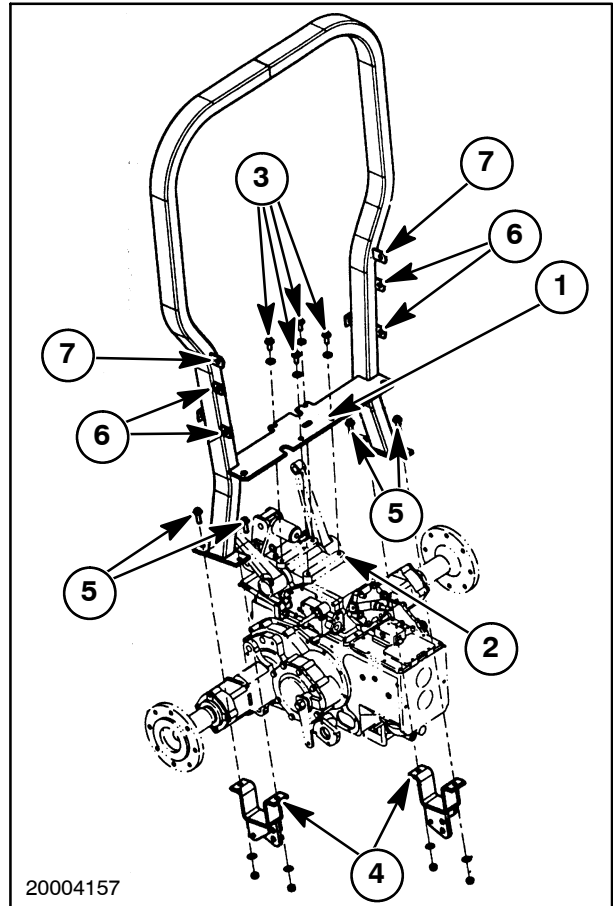

68

7. Install the stabilizer, 1, on the stabilizer bracket, 2, and secure with the mounting bolt, 3, and nut. Tighten and torque the stabilizer bolts to 105 N·m (77 ft.-lb.).

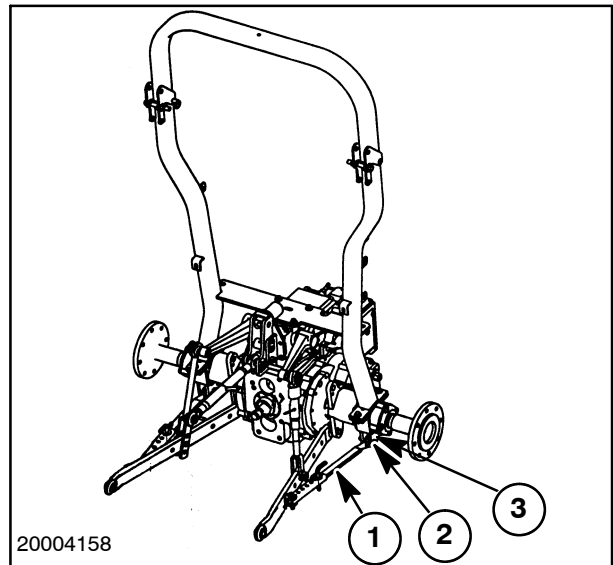

69



8. Position the fuel tank, aligning the mounting holes with the mounting holes on the ROPS. Install the two mounting bolts, 1, and secure with nuts. Tighten and torque the fuel tank mounting bolts to 17 ft.-lb. maximum.

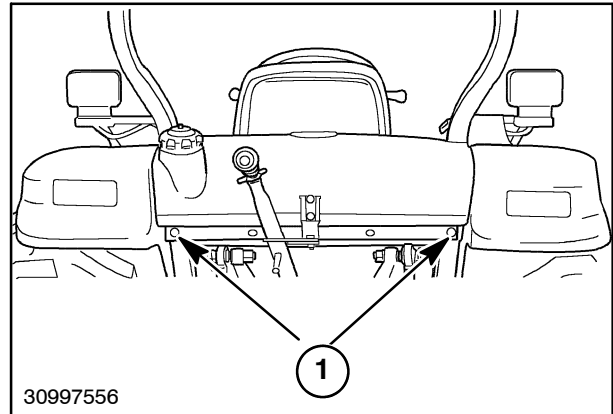

70

---

**! WARNING !**

---

Do not operate the tractor with the rollover protective structure folded as a standard operating mode. A folded ROPS does not provide rollover protection.

---

---

**! WARNING !**

---

Always wear the seat belt when the tractor is equipped with a ROPS. However, if the ROPS has been removed from the tractor, or if the ROPS is in the folded position, the seat belt should not be used.

---

**FUEL TANK****Removal**

1. Drain the fuel tank, 8, into a suitable container.
2. Remove the fuel line, 1, from the fuel tank fitting, 2.
3. Remove the fuel return line from the tank fitting, 3.
4. Disconnect the wiring plug, 4, from the fuel sending unit wire, 5.
5. Loosen and remove the two mounting nuts, 6, and bolts, 7, from the fuel tank, 8.
6. Remove the fuel tank, 8, from the tractor.
7. Loosen and remove the mounting screws, 9, from the sending unit cover, 10. Remove the cover, 10.
8. Loosen and remove the mounting screws, 11, from the fuel sending unit, 12, and remove the unit from the fuel tank, 8. Remove and discard the fuel sending unit gasket, 13.

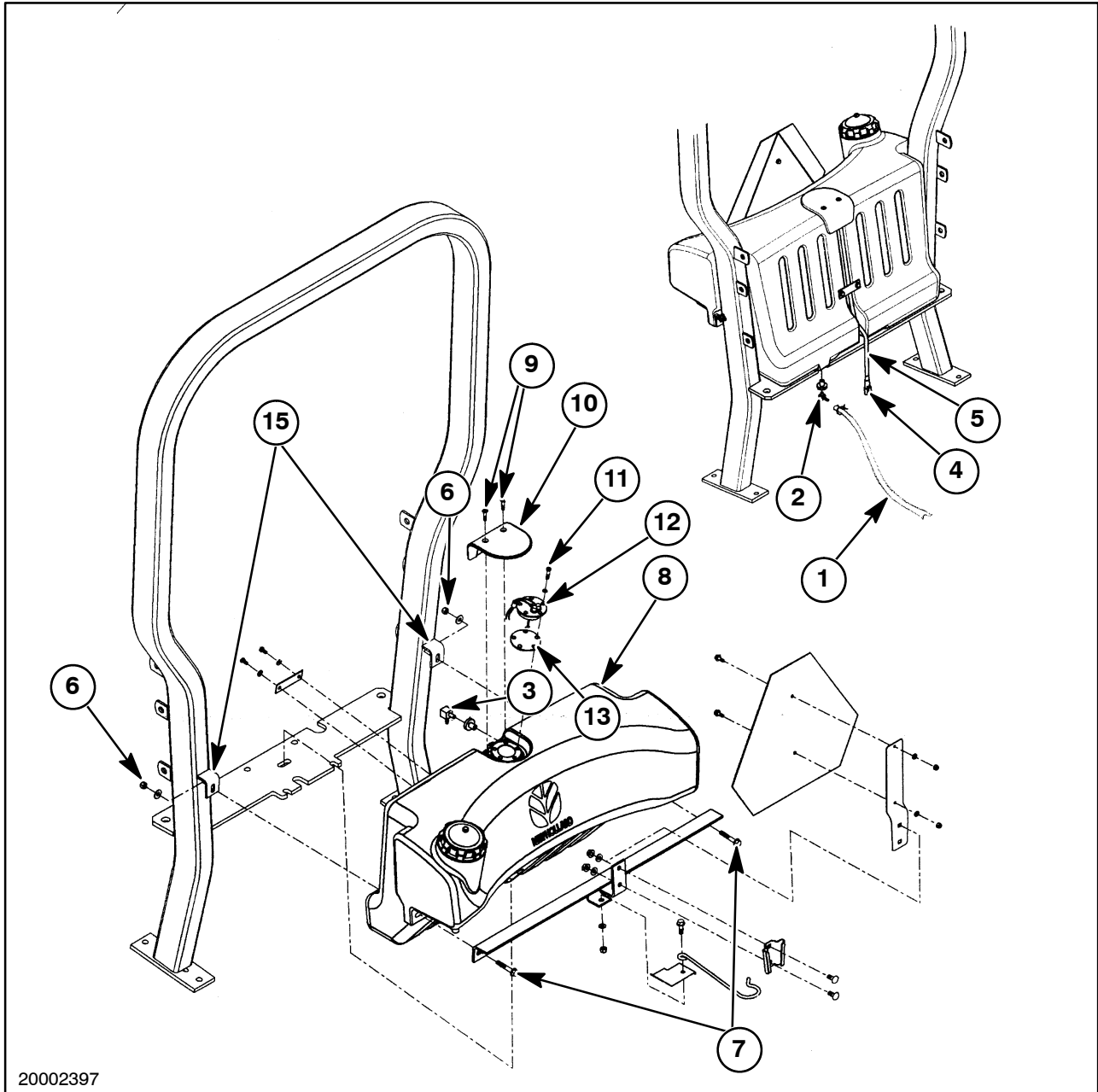

20002397

**Installation**

1. Install a new fuel sending unit gasket, 13, and the fuel sending unit, 12, to the fuel tank, 8. Secure with the mounting screws, 11.
  2. Install the fuel sending unit cover, 10, and secure with the mounting screws, 9.
  3. Position the fuel tank, 8, on the tractor, aligning the mounting holes.
  4. Install the two mounting bolts, 7, through the support bar, 14, the fuel tank, 8, and the mounting tabs, 15 on the ROPS.
  5. Install the nuts, 6, onto the mounting bolts, 7.
- IMPORTANT:** *Do not over tighten the fuel tank mounting bolts.*
6. Tighten and torque the mounting nuts, 6, to 17 ft.-lbs. MAXIMUM.
  7. Connect the wiring plug, 4, to the fuel sending unit wire, 5.
  8. Connect the fuel return line to the tank fitting, 3.
  9. Connect the fuel supply line, 1, to the tank fitting, 2.

**Op. 90 116****FENDERS****Removal - TC35, TC40, TC45**

1. Loosen and remove the light bar retaining bolts, 1.
2. Loosen and remove the nuts, 2, and the bolts, 3, that secure the light bars, 4, to the fenders, 5.
3. Disconnect the tail light wires, 6, and remove the light bars, 4, from the tractor.
4. If equipped, remove the loader control valve from the right fender.
5. Loosen and remove the nuts, 7, the washers, 8, the spacers, 9, and the bolts, 10, from the fenders, 5.
6. Loosen and remove the retaining bolts, 11, from the fenders, 5.
7. Remove the fenders, 5, from the tractor.

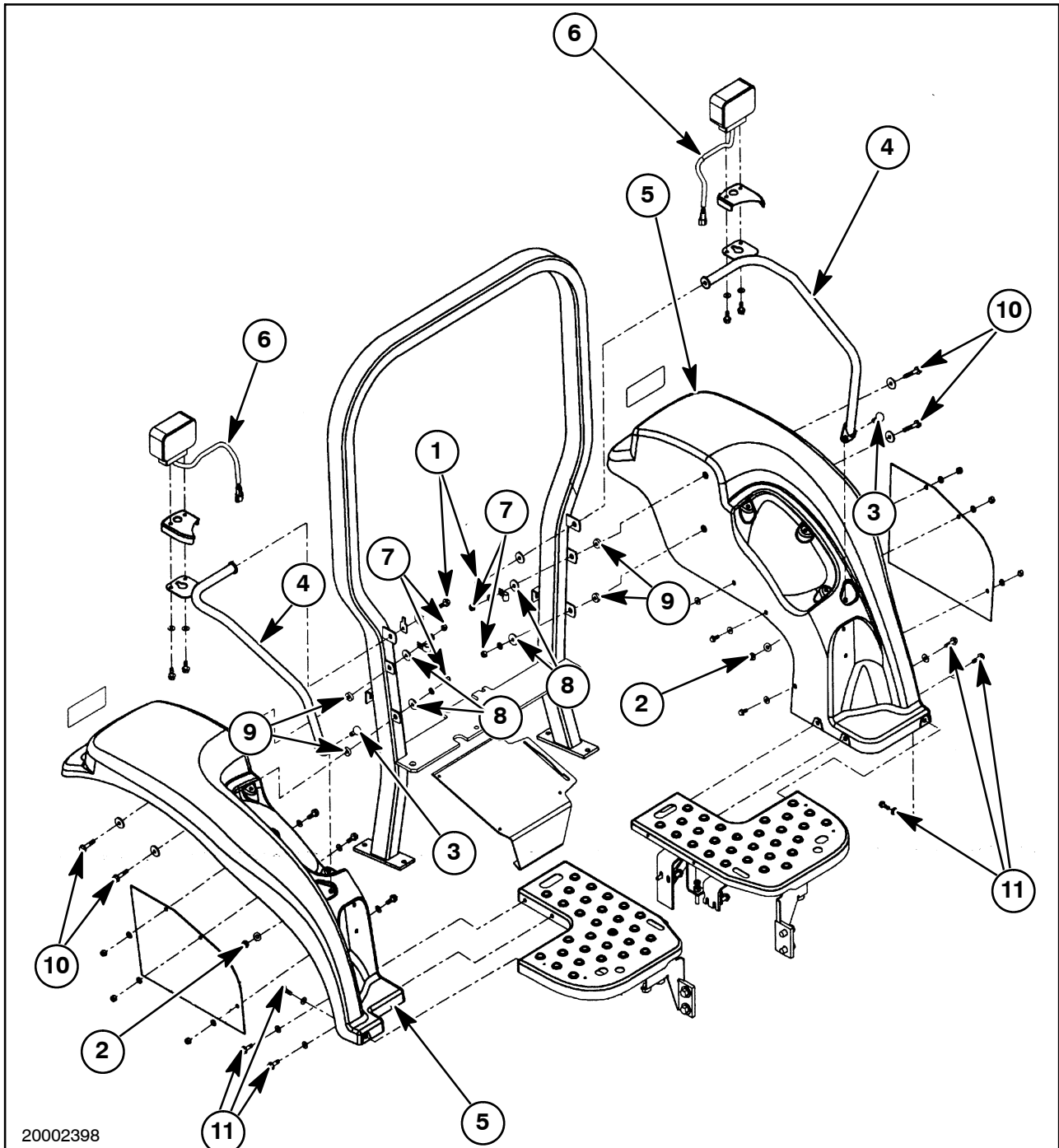

20002398

**Removal - TC35D, TC40D, TC45D**

1. Remove the control lever knobs from the left and right control levers.
2. Loosen and remove the three bolts, 1, that secure the left control pod, 2, to the left fender, 3, and the right control pod, 15, to the right fender, 8.
3. Loosen and remove the light bar retaining bolts, 4.
4. Loosen and remove the nuts, 5, and the bolts, 6, that secure the light bars, 7, to the fenders, 3 and 8.
5. Disconnect the tail light wires, 9, and remove the light bars, 7.
6. If equipped, remove the loader control valve from the right fender, 8.
7. Loosen and remove the nuts, 10, the washers, 11, the spacers, 12, and the bolts, 13, from the fenders, 3 and 8.
8. Loosen and remove the retaining bolts, 14, from the left and right fenders, 3 and 8.
9. Remove the fenders, 3 and 8.

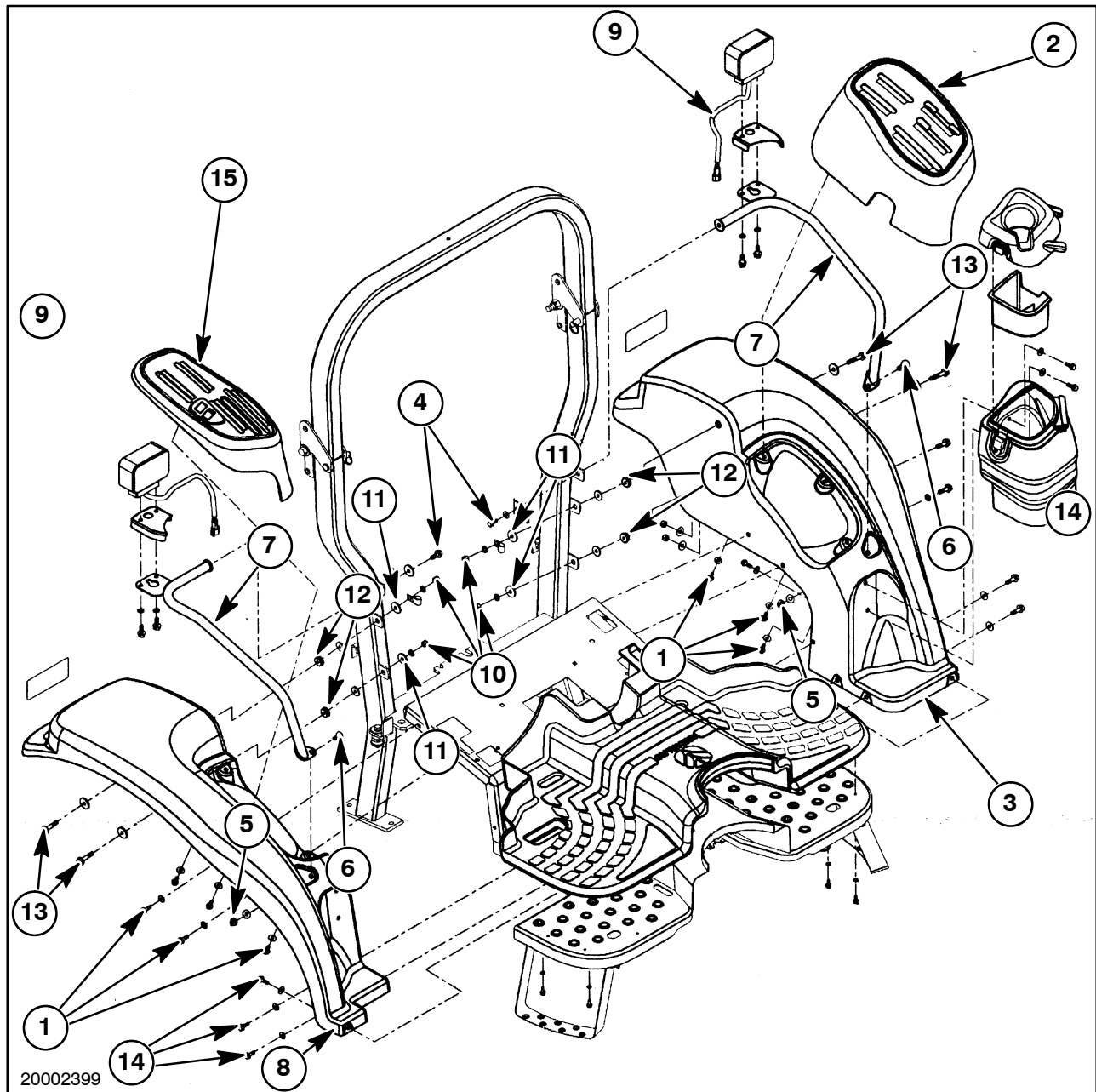

**Installation - TC35, TC40, TC45**

1. Position the fenders, 5, onto the deck and the ROPS, aligning the mounting holes.
2. Install the mounting bolts, 11. Tighten and torque the bolts to 17-21 ft.-lbs. (23-28 N·m)
3. Install the bolts, 10, the spacers, 9, the washers, 8, and secure to the ROPS with the nuts, 7. Tighten and torque the nuts to 17-21 ft.-lbs. (23-28 N·m)
4. If equipped, install the loader control valve on the right fender.
5. Install the light bars, 4, to the fenders, 5. Secure with the bolts, 3, and the nuts, 2.
6. Install the light bars, 4, to the ROPS with the bolts, 1. Tighten the attaching hardware for the light bars.
7. Connect the wiring plug, 6, on the left and right tail lights, to the tail light wiring harness.

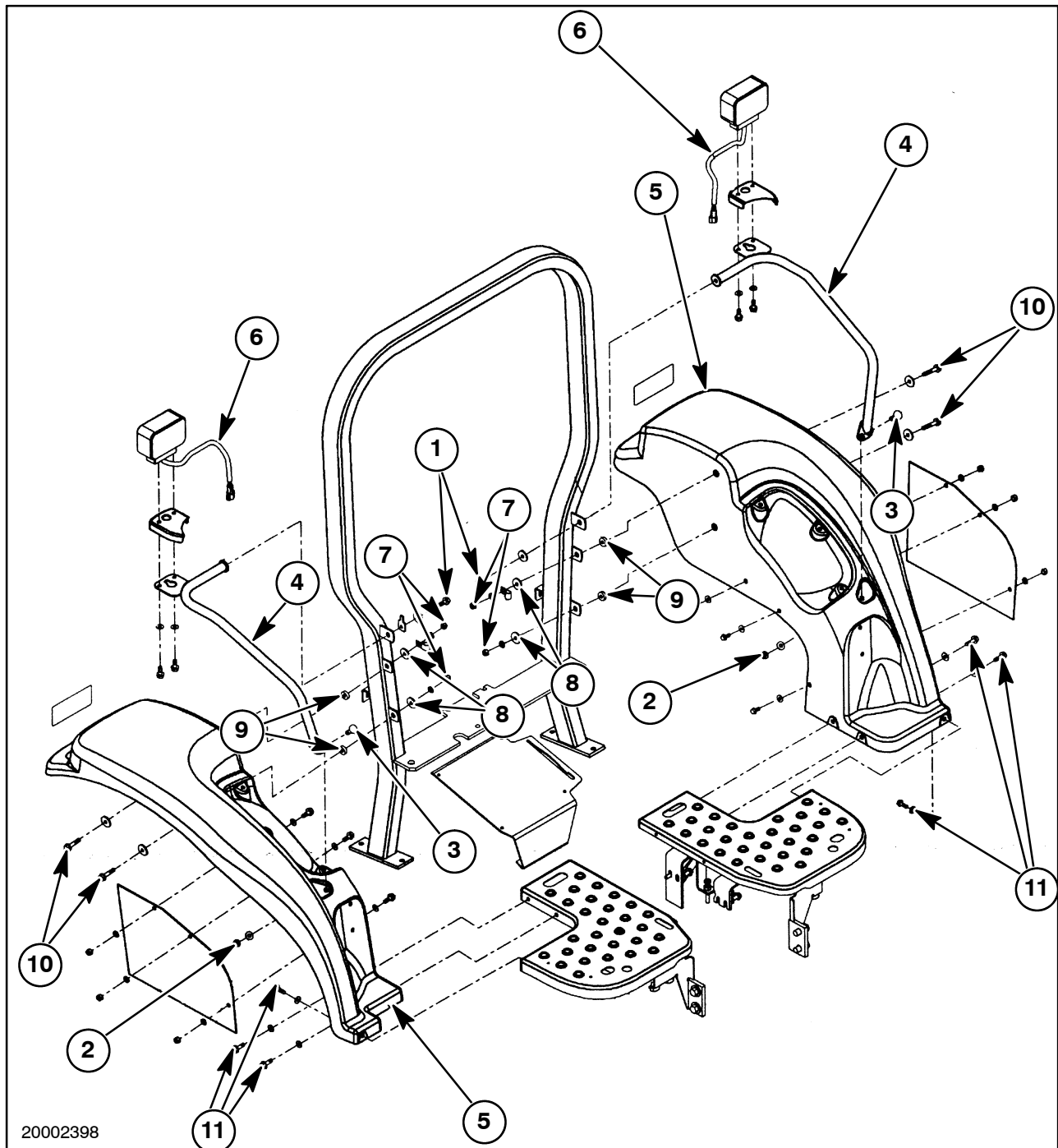

**Installation - TC35D, TC40D, TC45D**

1. Position the fenders, 3 and 8, onto the deck and the ROPS, aligning the mounting holes.
2. Install the retaining bolts, 14, to the left and right fenders, 3 and 8. Tighten and torque the bolts, 14 to 17-21 ft.-lbs. (23-28 N·m)
3. Install the bolts, 13, the spacers, 12, the washers, 11, and secure to the ROPS with the nuts, 10. Tighten and torque the bolts, 14 to 17-21 ft.-lbs. (23-28 N·m)
4. If equipped, install the loader control valve on the right fender.
5. Install the light bars, 7, to the fenders, 3 and 8. Secure with the bolts, 6, and the nuts, 5.
6. Install the light bars, 7, to the ROPS with the bolts, 4. Tighten the attaching hardware for the light bars.
7. Install the left control pod, 2, onto the left fender, 3. Secure with the bolts, 1.
8. Install the right control pod, 15, onto the right fender, 8. Secure with the bolts, 1.
9. Connect the wiring plugs, 9, on the left and right tail lights to the tail light wiring harness.

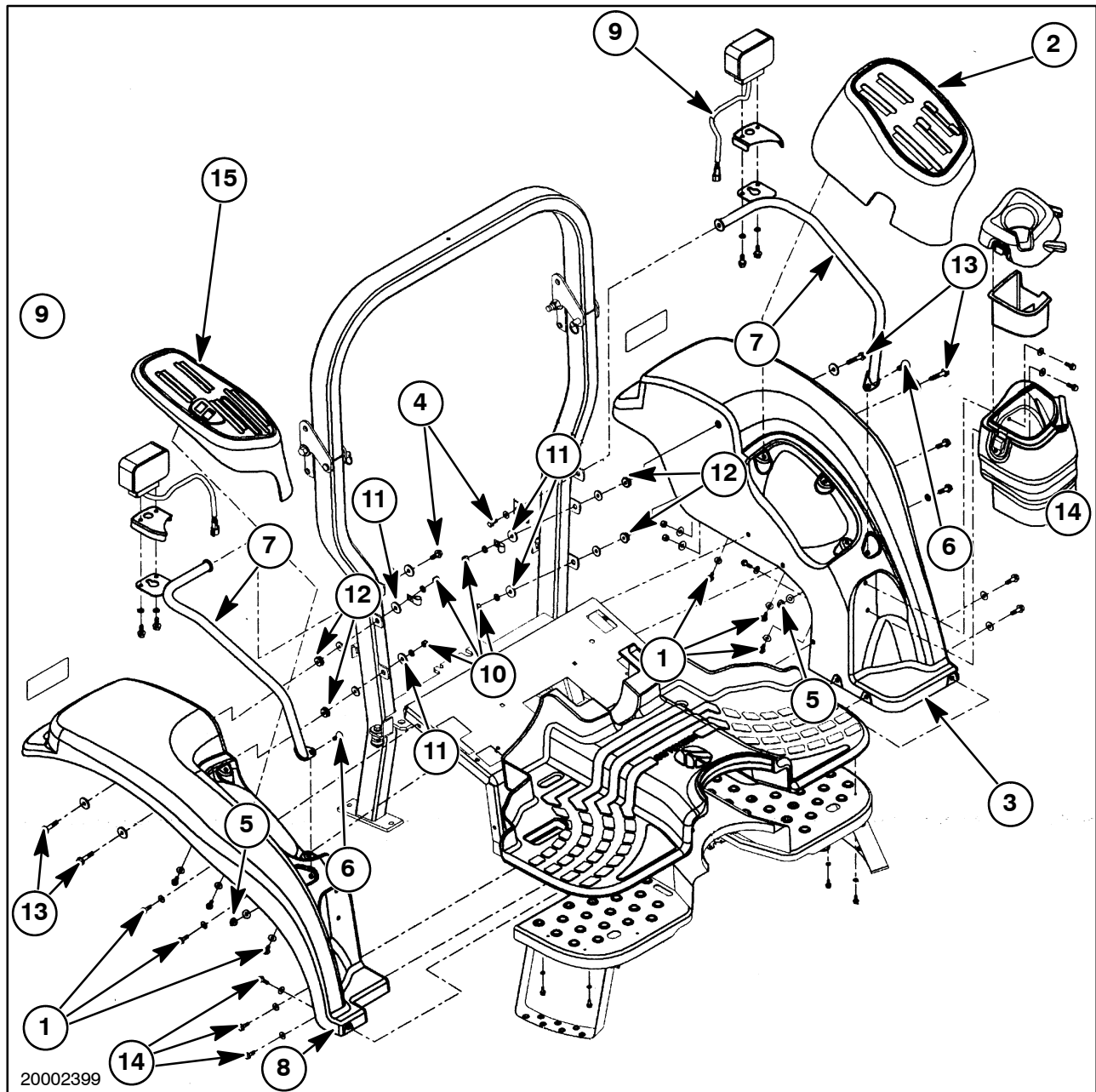

**Op. 90 115****DECK****Removal - TC35, TC40, TC45****LEFT SIDE**

1. Disconnect the clutch return spring from the deck, 7.
2. Loosen and remove the bolts, 1, and the washers, 2.
3. Loosen and remove the bolts, 3, and the washers, 4.
4. Loosen and remove the bolts, 5, and the washers, 6.
5. Loosen and remove the bolts, and the washers, securing the fender to the deck, 7.
6. Remove the wire harness from the underside of the deck, 7.
7. Remove the deck, 7.

**RIGHT SIDE**

1. Disconnect the brake return spring from the deck, 8.
2. Disconnect the foot throttle return spring, 9, from the linkage, 11.
3. Remove the throttle cable, 10, from the linkage, 11.
4. Disconnect the wire harness plug from the parking brake safety switch, 12.
5. Loosen and remove the bolts, 13, and the washers, 14.
6. Loosen and remove the bolts, 15, and the washers, 16.
7. Loosen and remove the bolts, and the washers, securing the fender to the deck, 8.
8. Remove the wire harness from the underside of the deck, 8.
9. Remove the deck, 8.



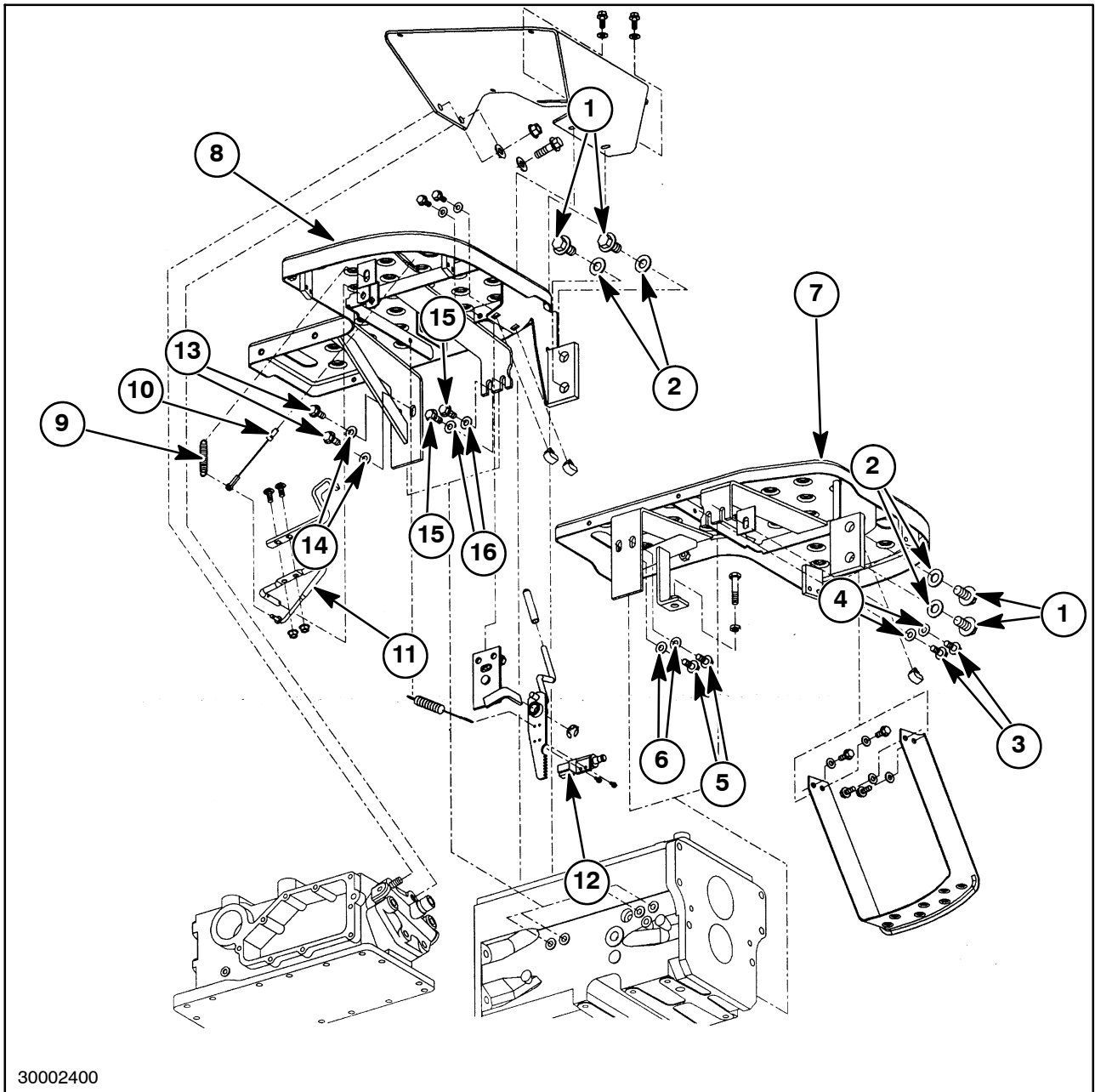

30002400

**Removal - TC35D, TC40D, TC45D**

1. Remove the seat from the tractor.
2. Remove the tool box from the left fender.
3. Loosen and remove the retaining bolts, 1, and remove the floor mat, 2, from the deck, 3.
4. Remove the control pods, 4 and 5, from the fenders.

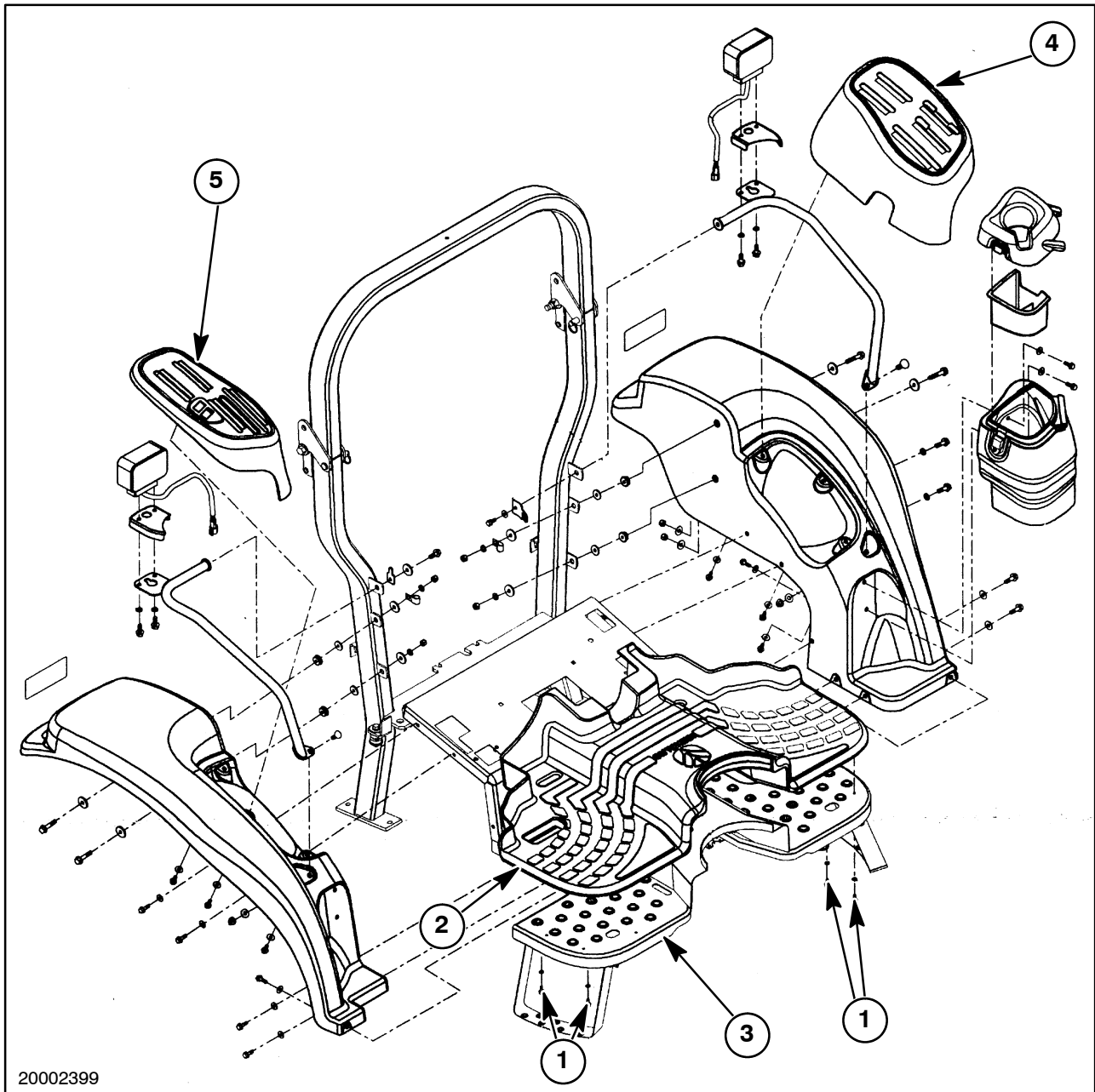

20002399

5. Remove the cotter pins, 1, and the retaining pins, 2, from the left side control lever linkage, 3.
6. Remove the control lever shaft bolts, 4, and remove the levers, 5. Repeat for the right side control levers.
7. Disconnect the wiring harness plug from the Cruise Control switch

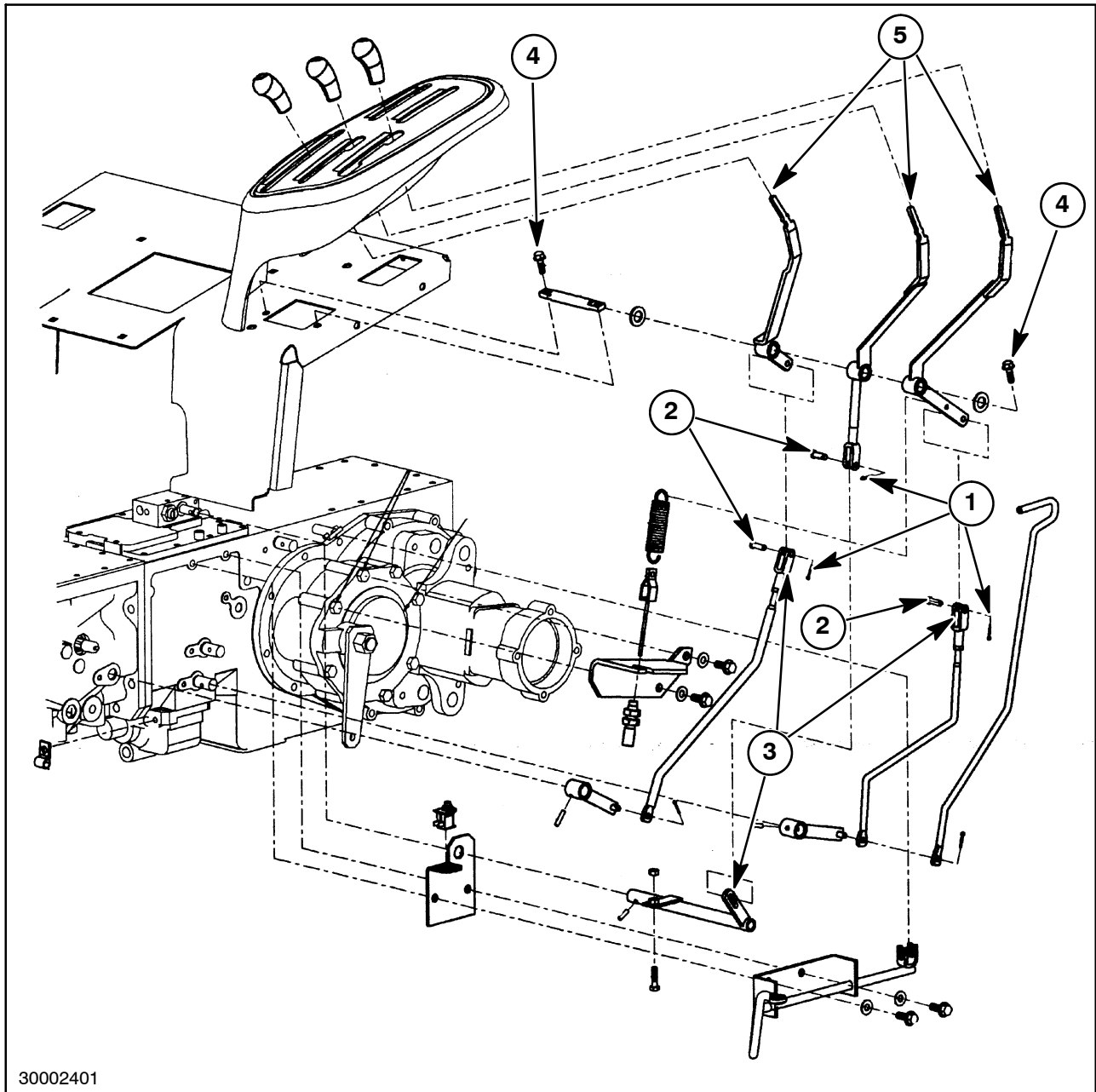

30002401

8. Remove the cotter pin, 1, and the washer, 2, from the parking brake lever, 3. Remove the parking brake lever, 3, up through the deck.
9. Remove the cotter pin, 5, and the washer, 6, from the park brake rod, 7. Remove the return spring, 4, and the park brake rod, 7, from the park brake linkage.
10. Disconnect the wiring plug from the park brake switch, 8.
11. Disconnect the two brake pedal return springs, 9, from the deck.

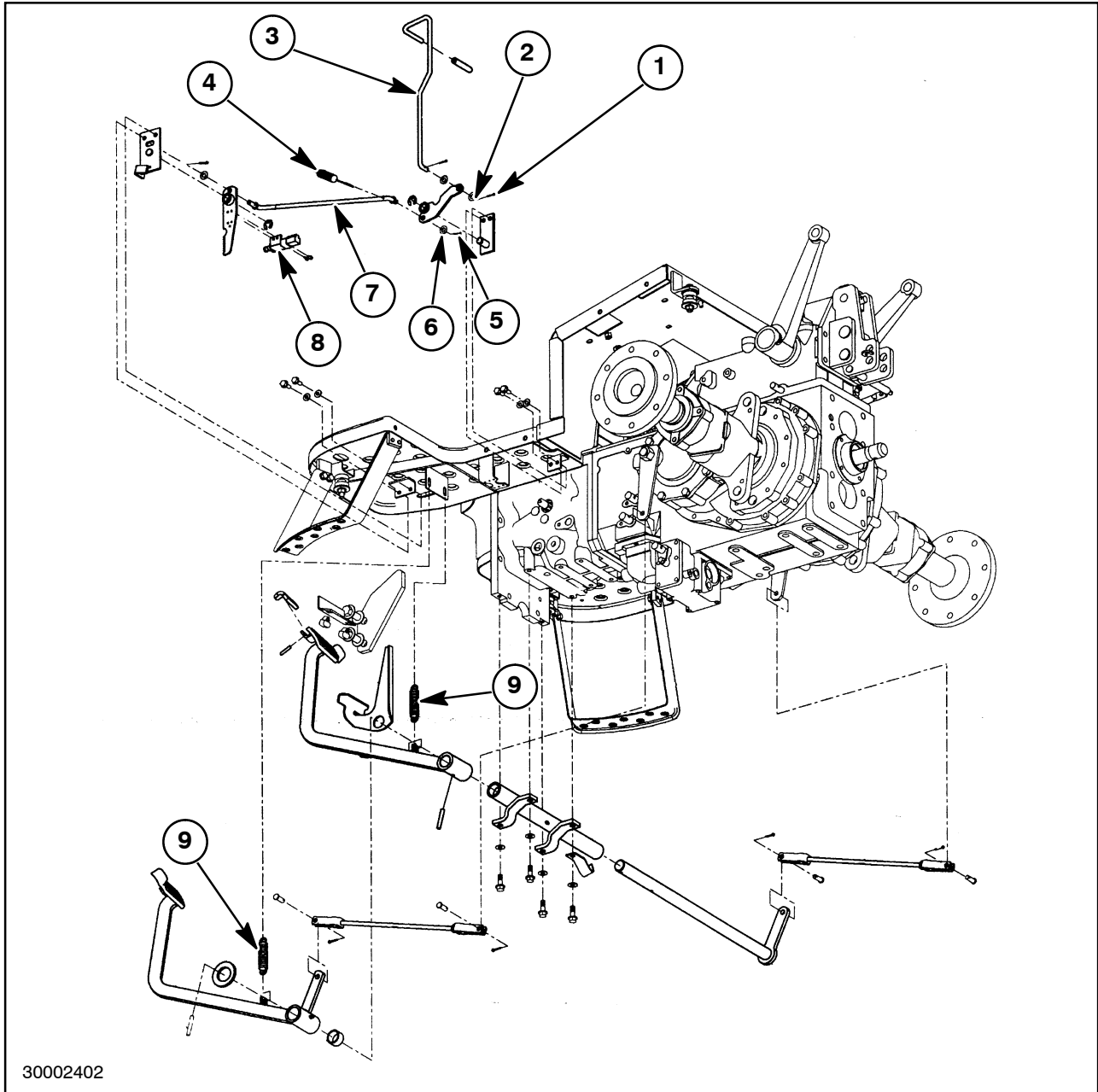

12. Remove the bolts, 1, from the access cover, 2, and remove the cover, 2, from the deck, 3.
13. Remove the hitch pin, 4, from the HPL control rod, 5. Remove the HPL control rod, 5, from the deck, 3.
14. Loosen and remove the four nuts, 6, washers, 7, dampers, 8, bushings, 9, and washers, 10.
15. Remove the four mounting bolts, 11, and the four washers, 12, from the deck, 3.
16. Disconnect the wiring harness at any attachment points on the underside of the deck, 3.
17. Loosen and remove the bolts that secure the fenders to the deck, on both sides if the tractor.
18. Remove the deck, 3, from the tractor.

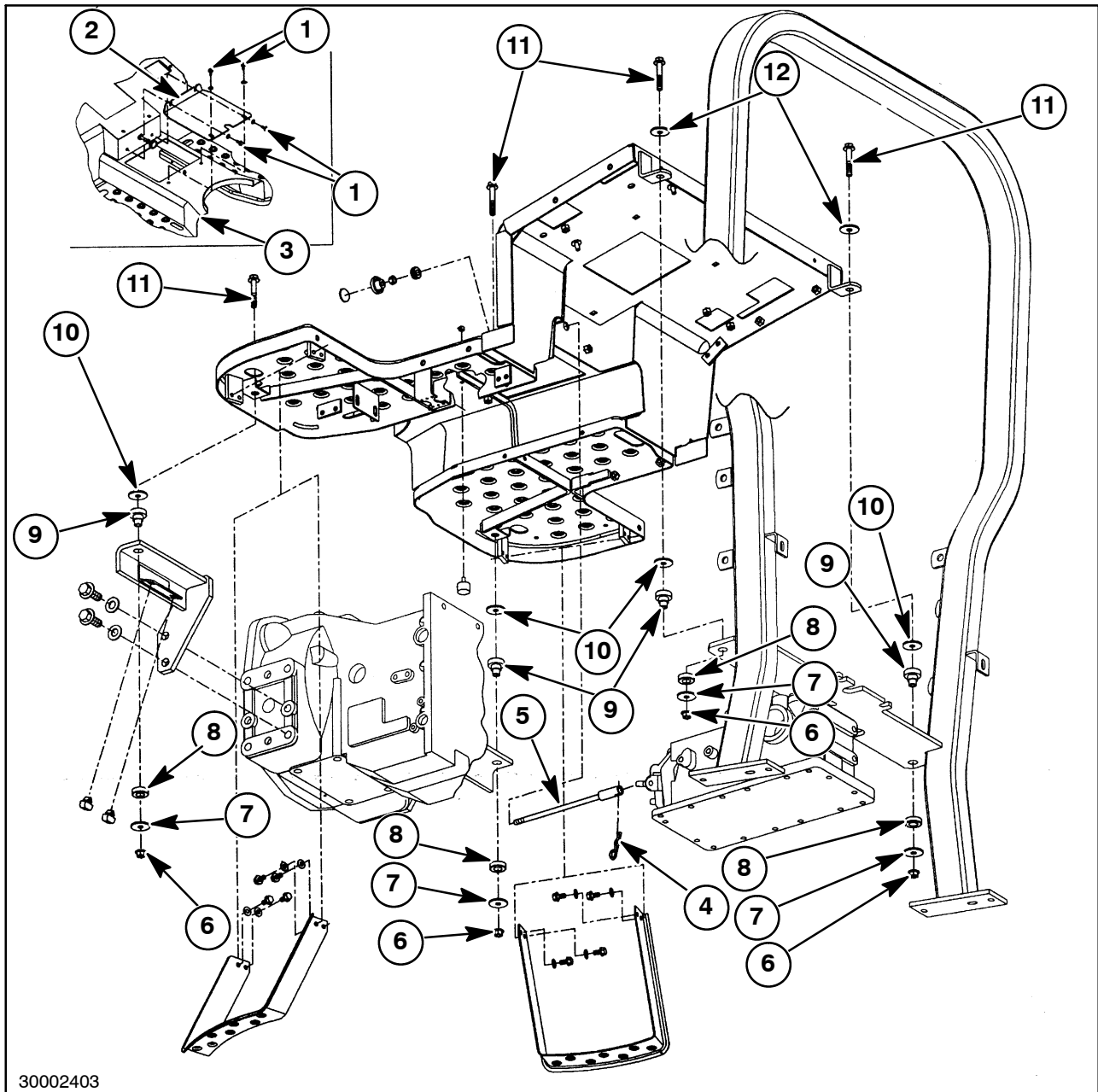

30002403

**Installation - TC35, TC40, TC45**

**LEFT SIDE**

1. Position the deck, 7, on the tractor.
2. Attach the wire harness holders to the underside of the deck.
3. Install the bolts and washers, through the fenders and into the deck, 7.
4. Install the bolts, 1, and the washers, 2.
5. Install the bolts, 3, and the washers, 4.
6. Install the bolts, 5, and the washers, 6.
7. Tighten all of the mounting bolts.
8. Connect the clutch return spring to the deck, 7.

**RIGHT SIDE**

1. Position the deck, 8, on the tractor.
2. Attach the wire harness holders to the underside of the deck.
3. Install the bolts and washers, through the fenders and into the deck, 8.
4. Install the bolts, 13, and the washers, 14.
5. Install the bolts, 15, and the washers, 16.
6. Connect the wire harness plug to the parking brake safety switch, 12.
7. Connect the throttle cable, 10, to the foot throttle linkage, 11.
8. Connect the foot throttle return spring, 9, to the linkage, 11.
9. Connect the brake return spring to the deck, 8.

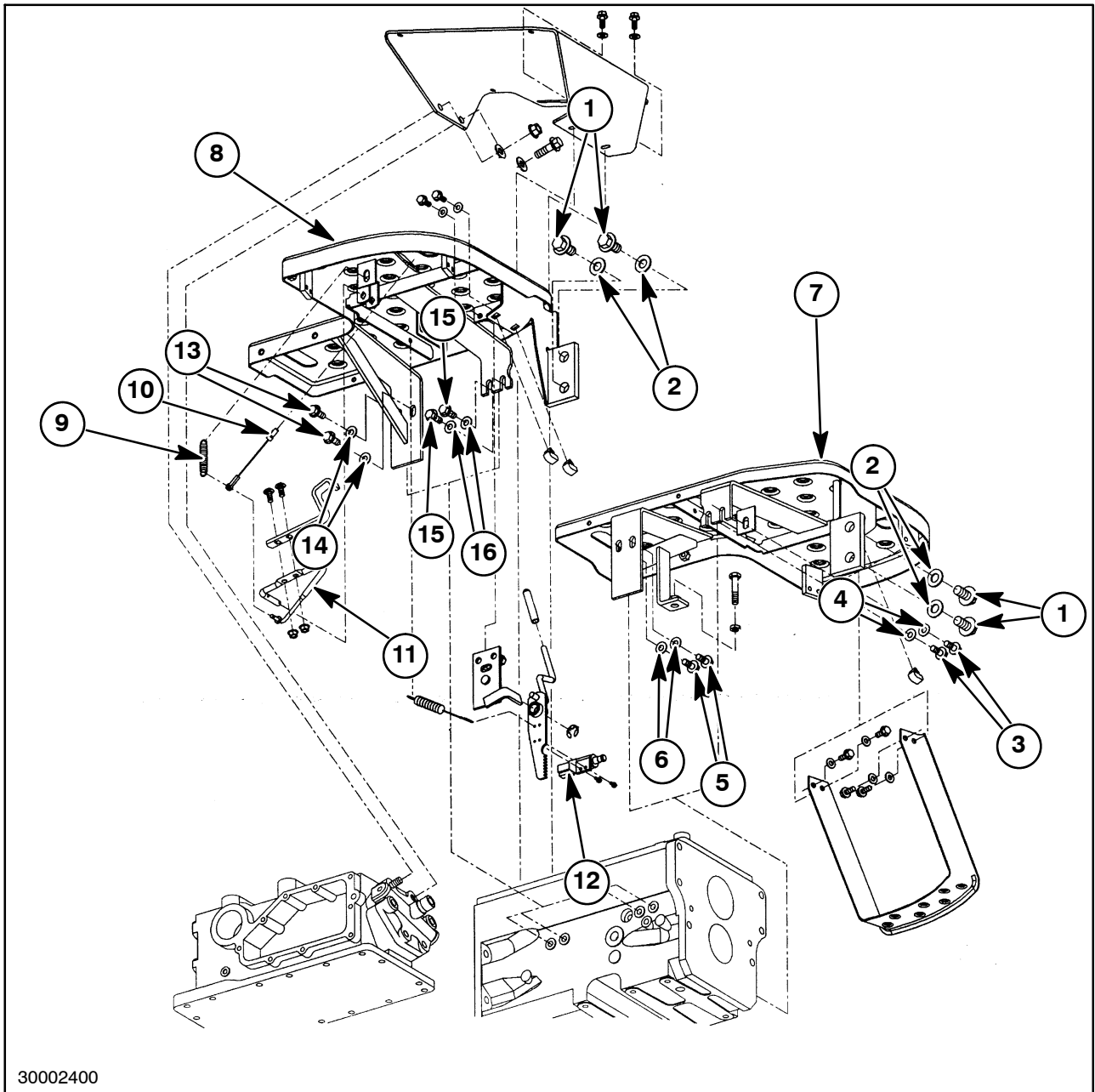

30002400

**Installation - TC35D, TC40D, TC45D**

1. Position the deck, 3, on the tractor.
2. Install the bolts and washers, through the fenders and into the deck, 3.
3. Attach the wire harness holders to the underside of the deck.
4. Install the four bolts, 11, and the four washers, 12, into the deck, 3.
5. Install the washers, 10, the bushings, 9, the dampers, 8, the washers, 7, and the nuts, 6. Tighten the mounting bolts and nuts.
6. Install the HPL control rod, 5, through the deck, 3, and connect to the HPL shaft. Secure the HPL control rod, 5, to the HPL shaft with the hitch pin, 4.
7. Install the access cover, 2, onto the deck, 3, and secure with the bolts, 1.

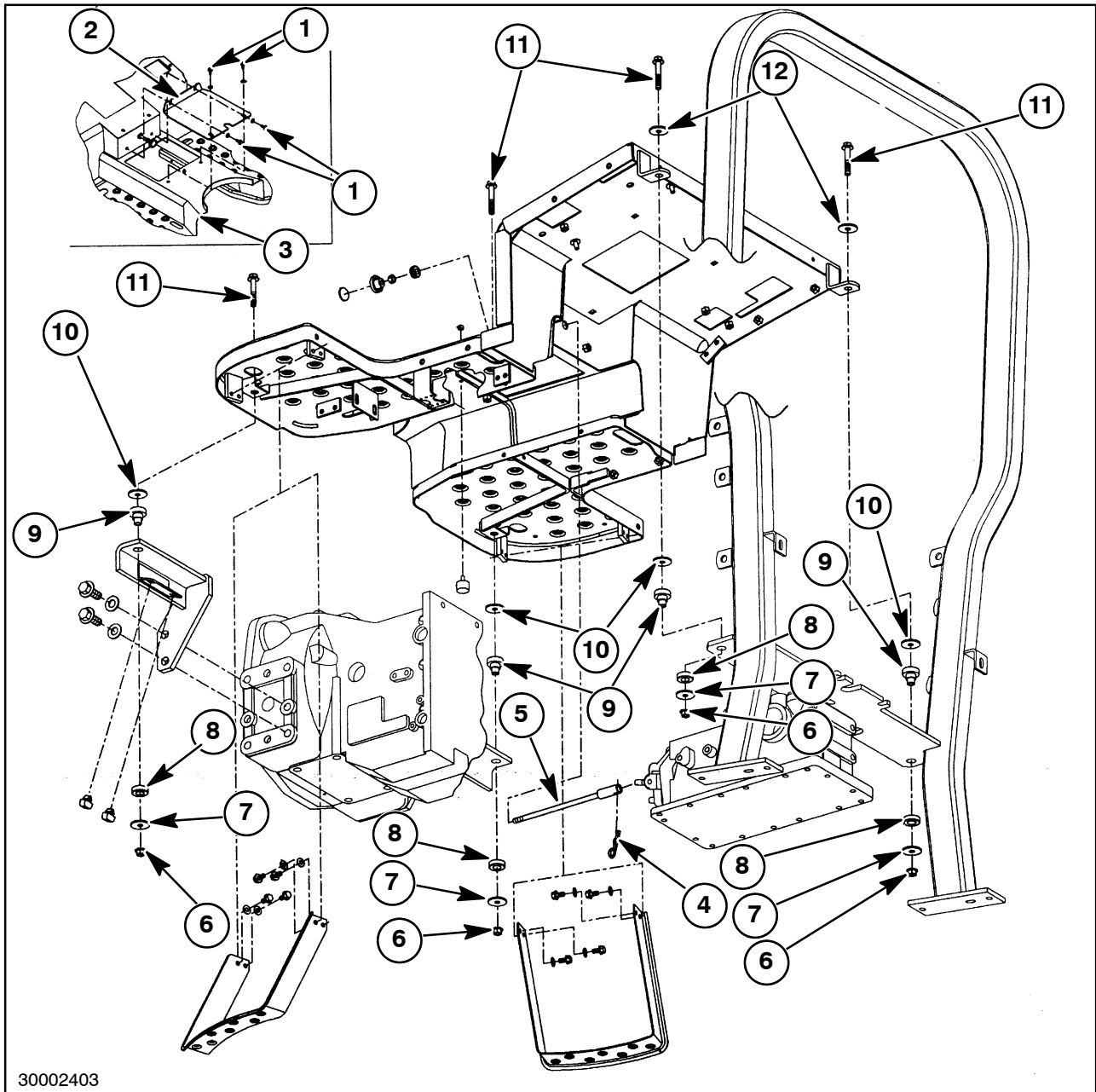

30002403



8. Connect the two brake pedal return springs, 9, to the deck.
9. Connect the wiring plug to the park brake safety switch.
10. Connect the park brake rod, 7, to the park brake linkage. Secure with a washer, 6, and a cotter pin,
5. Attach the return spring, 4, to the park brake rod, 7.
11. Install the parking brake lever, 3, down through the deck, and attach to the park brake linkage. Secure with a washer, 2, and a cotter pin, 1.

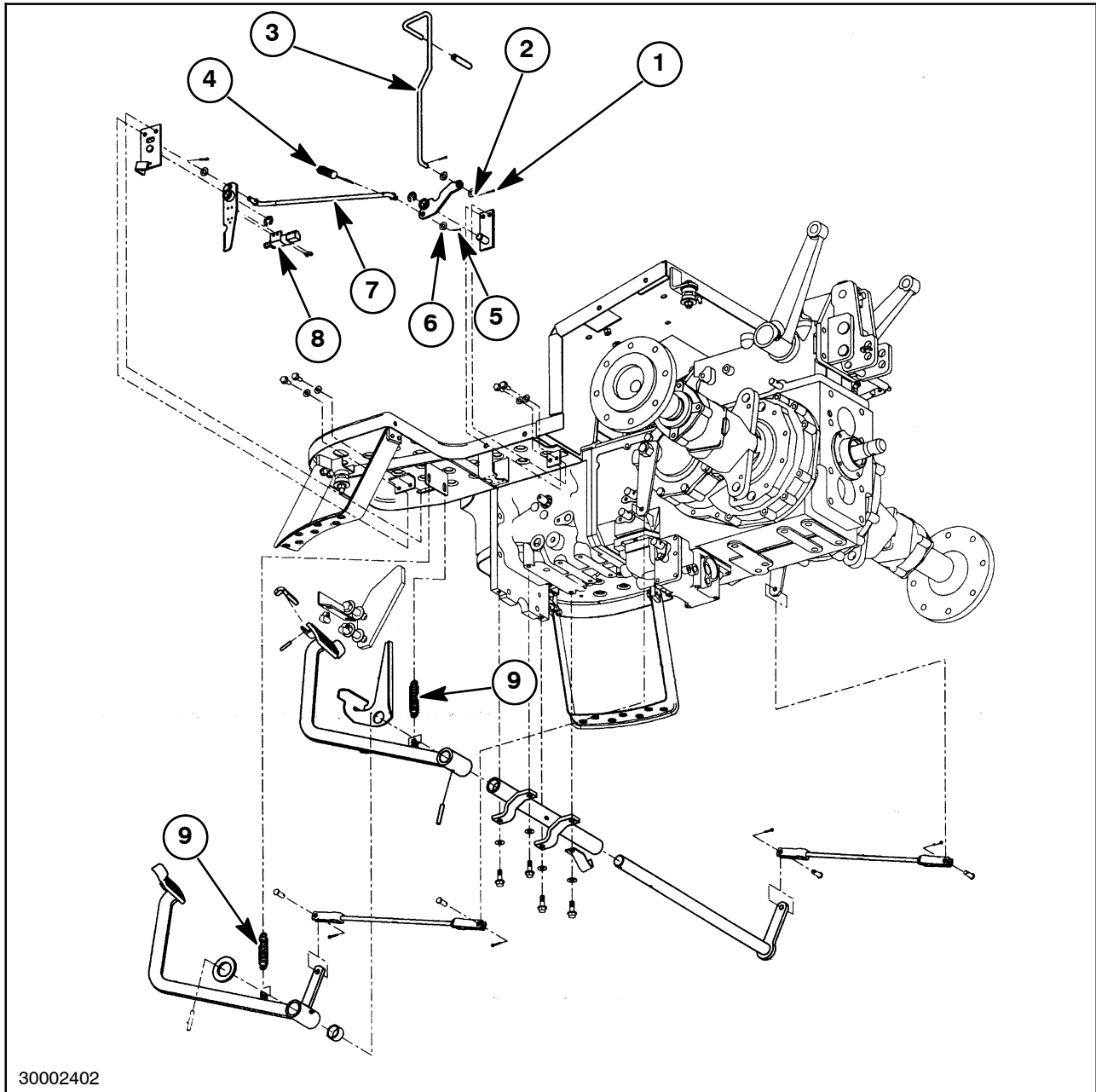

30002402

12. Connect the wiring harness plug to the cruise control switch.
13. Install the control levers, 5, on the deck, and secure with the control lever shaft retaining bolts, 4. Repeat for the opposite side.

14. Attach the linkage to the levers, 5, and secure with the retaining pins, 2, and the cotter pins, 1. Repeat for the opposite side.

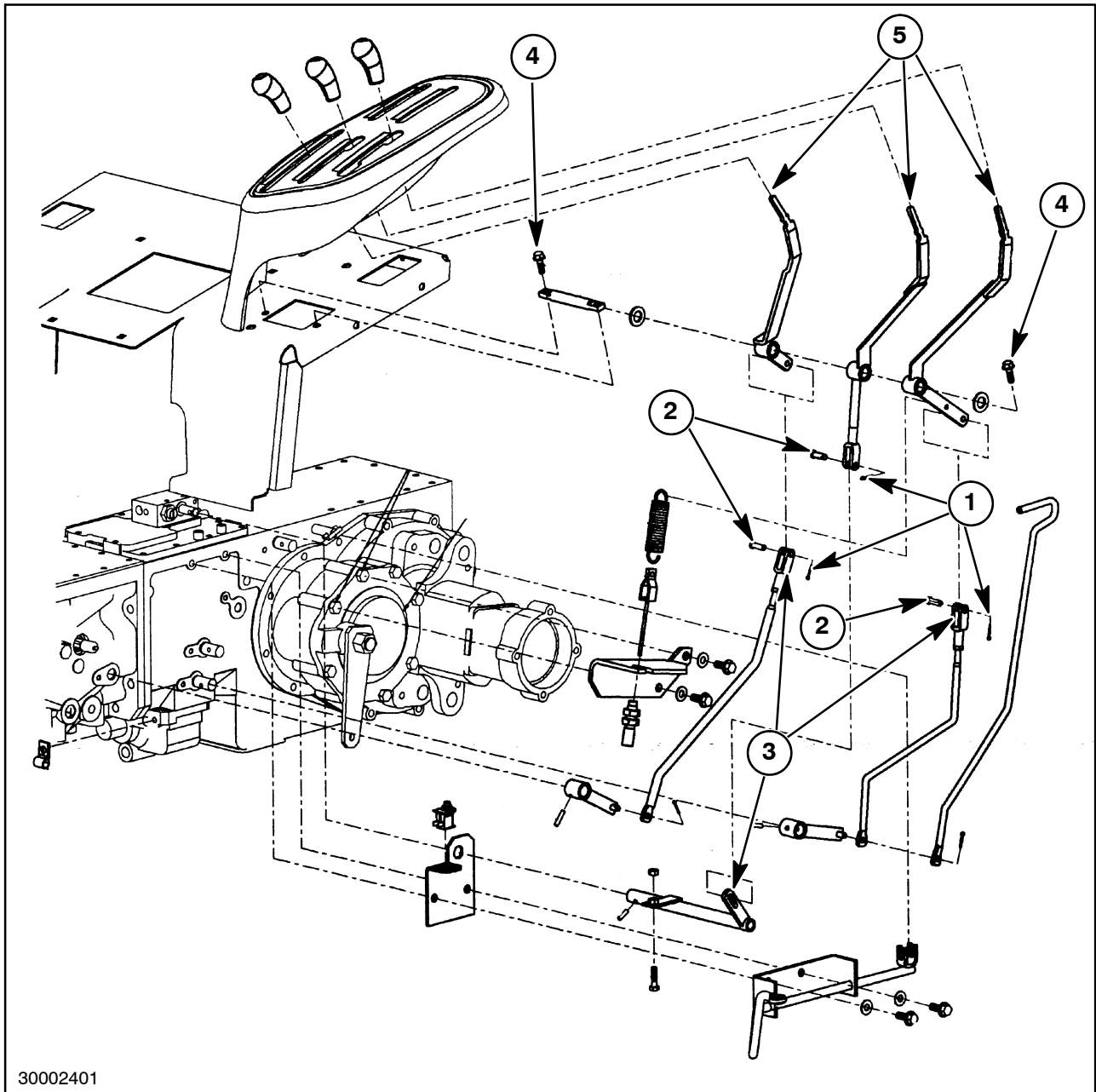

## SECTION 90 - PLATFORM

15. Install the control pods, 4 and 5, onto the fenders.
16. Install the floor mat, 2, onto the deck, 3, and secure with the retaining bolts, 1.

17. Install the tool box onto the left fender.
18. Install the seat onto the tractor.

