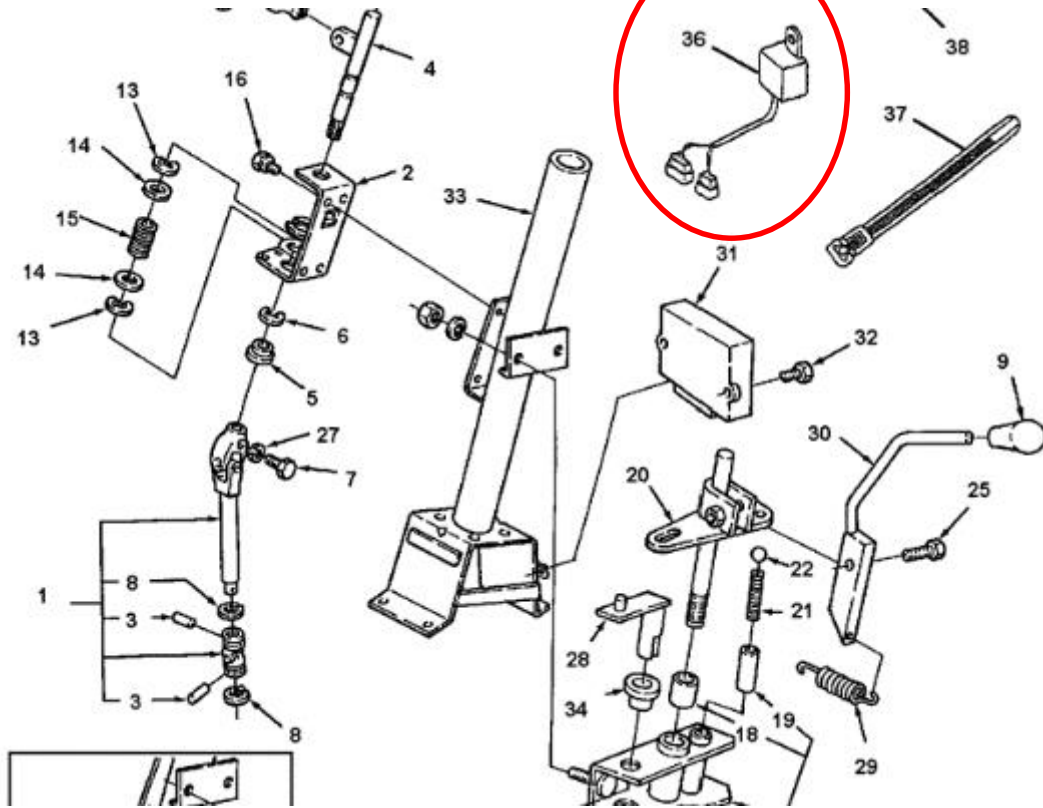
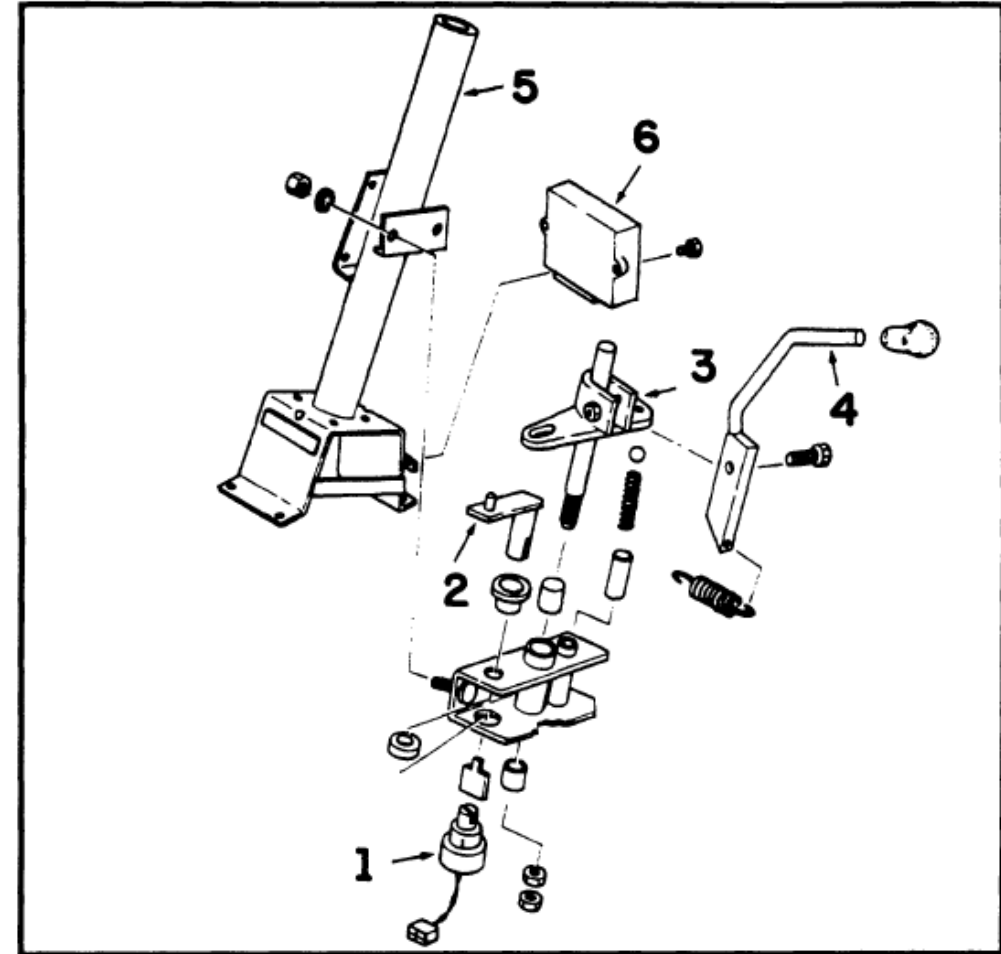

Image from Messick's website



This part does not appear in any of the repair manual sections

Image from Repair Manual



The new part number is 47837495 and the original part number is SBA385870820

FIGURE 20

Schematic from Repair Manual

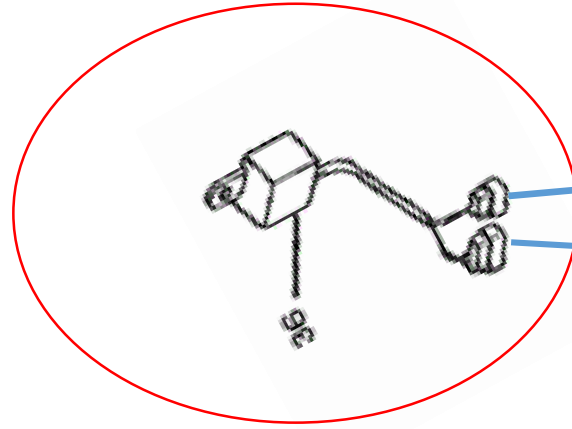

This part is not shown on the schematic but it is inserted between the Shuttle Switch and the Controller box

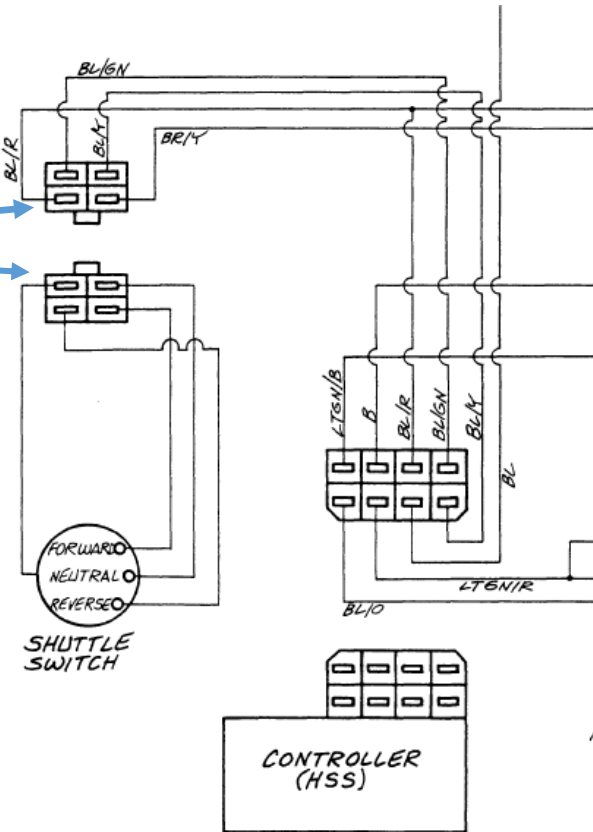

2120 EHSS WIRING DIAGRAM

Pictures of the part.



Connector to Shuttle Switch

Connector to EHSS Controller Box



Part has 5 wires:
2 Blue
2 Green
1 Black (goes to ground)

EHSS Controller box

Test from CNH Tech Manual

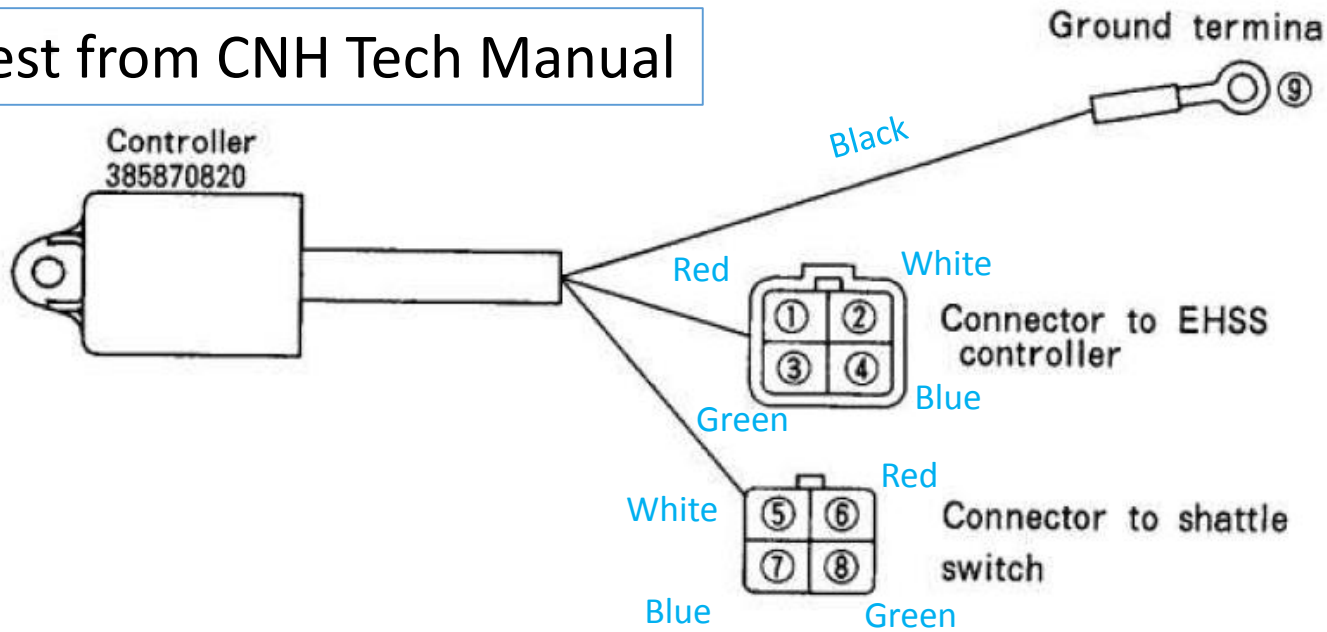

The new part number is 47837495 and the original part number is SBA385870820

The Amperage Controller appears to be a pair of 240Ω resistors that shunt off some current to ground from the Forward and Reverse signal wires

Using an ohmmeter, touch test leads A and B to each terminal 1 to 9 and read resistance.

Test lead		Resistance (Ω)	
A	B		
Red	1	6	Red
White	2	5	White
Green	3	8	Green
Green	3	9	Black
Blue	4	7	Blue
Blue	4	9	Black
Blue	7	9	Black
Green	8	9	Black
Green	3	7	Blue
Green	3	4	Blue
Blue	7	8	Green
Blue	4	8	Green

Schematic for Amperage Controller

