

REPAIR PARTS

"MF" & "26" LOG SPLITTER MODEL NO'S. 30101 & 31101

NOTE: Circled items are used on auto control valves only.

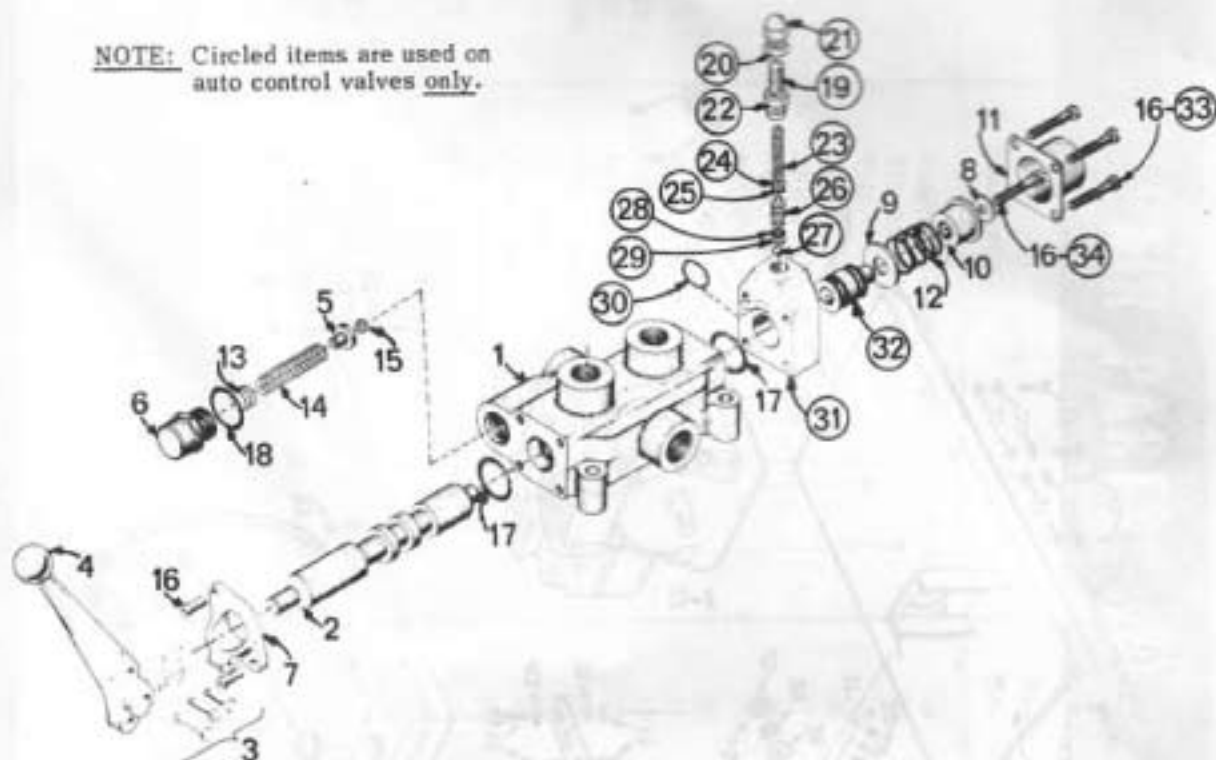

Italicized items are used on ACV valves only.

Key No.	Part No.	Description	Key No.	Part No.	Description
1	CR1V0278	*Valve Housing (1 Spool w/relief)	19	CR1V0069	<i>Adjustment Screw</i>
2	CR1V0003	*4-Way Spool (Open Center)	20	CR1A0569	<i>Nut</i>
3	CR1V1702	Pin Kit	21	CR1A0570	<i>Acorn Nut</i>
4	CR1V1703	Handle	22	CR1V0072	<i>Piston Stop</i>
5	CR1R0014	Relief Spring Plug	23	CR1A0610	<i>Detent Spring</i>
6	CR1R0028	Relief O-Ring Guide	24	CR2A0012-008	<i>Upper O-Ring Back-Up</i>
7	CR4Z4306	Handle Bracket	25	CR2A0283-7008	<i>Upper Piston O-Ring</i>
8	CR1A0290	Centering Spring Washer	26	CR1V0068	<i>Pressure Detent System</i>
9	CR1A0291	Stop Washer	27	CR2A0017-8	<i>Ball (1/4 Steel)</i>
10	CR1A0292	Stop Collar	28	CR2A0283-7007	<i>Lower Piston O-Ring</i>
11	CR1A0294	End Cap	29	CR2A0012-007	<i>Lower O-Ring Back-UP</i>
12	CR1A0332	Light Centering Spring	30	CR2A0283-9017	<i>Housing O-Ring</i>
13	CR1A0682	Shim	31	CR1V0264	<i>Detent Housing Assembly</i>
14	CR1A0684	Relief Spring (1250 - 1750 psi)	32	CR1V0067	<i>2 Pos. Detent Sleeve</i>
15	CR2A0017-14	Ball (7/16 Steel)		CR1V0070	<i>1 Pos. Detent Sleeve "In" (Optional)</i>
16	CR2A0079-404	Machine Screw		CR1V0071	<i>1 Pos. Detent Sleeve "Out" (Optional)</i>
17	CR2A0283-7214	Spool Seal	33	CR2A0079-416	<i>Machine Screw</i>
18	CR2A0283-9910	Relief Plug O-Ring	34	CR2A0079-414	<i>Machine Screw</i>
	2033	Owner's Manual			

*The Select-Fit Honing Process at the factory, which fits a spool to an individual valve body eliminates the possibility of ordering the valve body or spool as separate items.