

# CROSS-SECTION VIEW—HYDROSTATIC TRANSMISSION

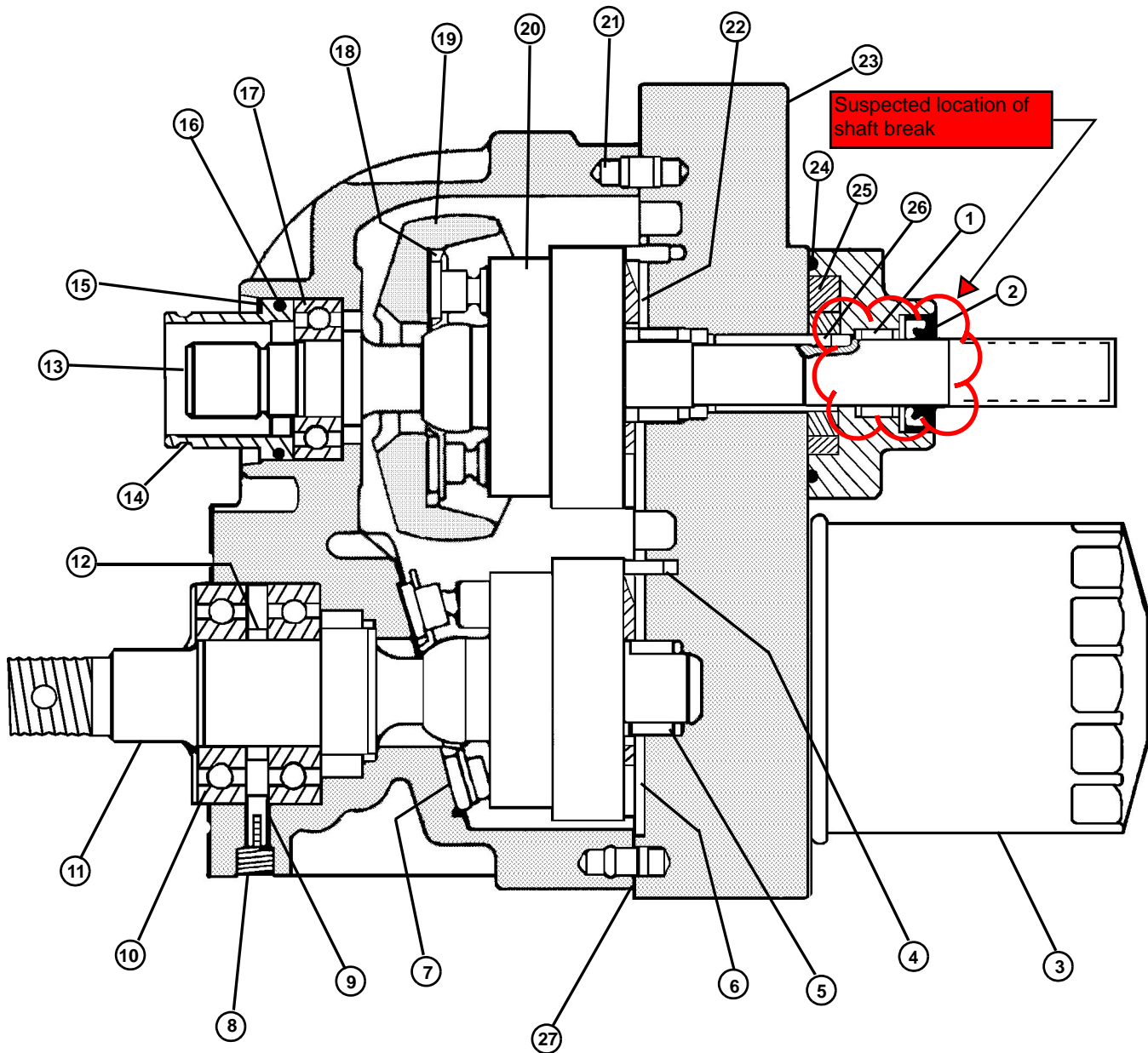

M85125

- |   |  |  |                        |
|---|--|--|------------------------|
| 1—Needle Bearing  | 8—Drain Plug   | 14—Seal Guide                            | 21—Pin (2 Used)        |
| 2—Seal  | 9—Bearing Retaining Pin                                      | 15—Snap Ring                             | 22—Pump Valve Plate    |
| 3—Filter  | 10—Ball Bearing (2 Used)                                     | 16—O-Ring                                | 23—Center Section      |
| 4—Pin (2 used)  | 11—Late Model Motor Shaft<br>(Early Models Are Not Threaded) | 17—Ball Bearing                          | 24—O-Ring              |
| 5—Needle Bearing (2 Used)                               |  | 18—Thrust Plate                          | 25—Gerotor Charge Pump |
| 6—Motor Valve Plate                                     |  | 19—Variable Swash Plate                  | 26—Gerotor Drive Pin   |
| 7—Motor Cylinder Block Assembly With Fixed Thrust Plate | 12—Collar  | 20—Pump Cylinder Block Assembly (2 Used) | 27—Gasket              |
|   | 13—Pump Shaft  |  |                        |