

R75593 (Juillet 81)  
Groupe Fonctionnel: 2104  
Produit affecté: Tracteur 1050

R75593 (July 81)  
Functional Group: 2104  
Products Affected: 1050 Tractor



R75593

INSTRUCTIONS FOR INSTALLATION OF SELECTIVE CONTROL VALVE  
ON TRACTORS NOT EQUIPPED WITH POWER STEERING

INSTRUCTIONS POUR L'INSTALLATION DE LA VALVE DE COMMANDE SELECTIVE  
SUR LES TRACTEURS QUI NE SONT PAS EQUIPES D'UNE DIRECTION ASSISTEE

This Instruction is divided into six subsections:

- A. Parts Diagram and Parts List
- B. Subassemble Selective Control Valve
- C. Subassemble SCV Bracket
- D. Adjust the Selective Control Valve
- E. Install Transmission Case and Junction Block Fittings
- F. Install Valve and Hydraulic Lines

Cette instruction se divise en sept parties:

- A. Schémas des pièces et liste des pièces détachées
- B. Pièces enlevées (si le tracteur était précédemment équipé d'une direction assistée)
- C. Montage partiel de la valve de commande sélective (VCS)
- D. Montage partiel du support de la valve de commande sélective
- E. Installation des raccords sur le carter de la boîte de vitesse et sur le distributeur hydraulique
- F. Installation de la valve et des conduites hydrauliques

A. Parts Diagrams and Parts List:

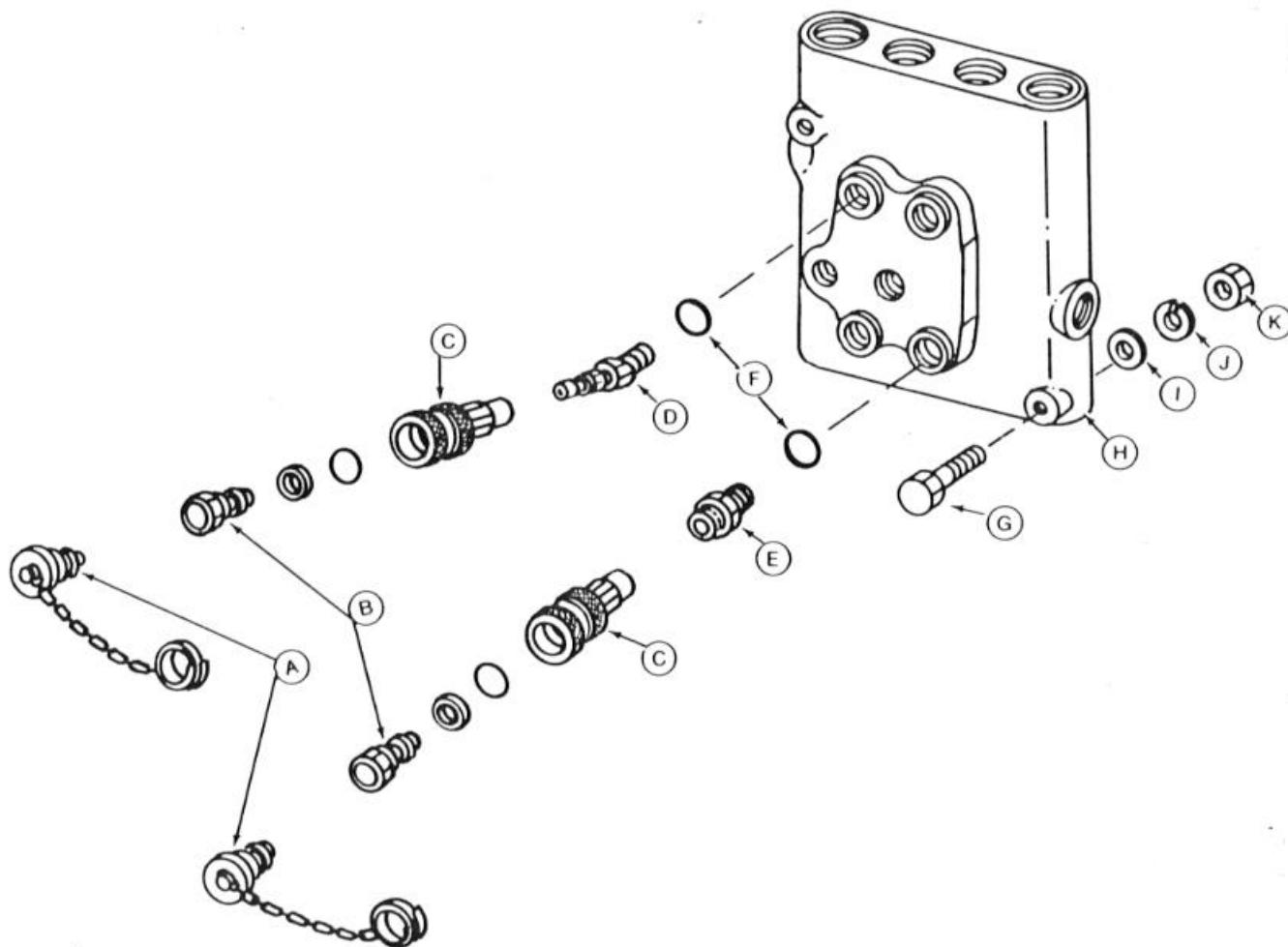

- A - AM31275 Dust Plug (4 used)
- B - AM37983 Plug Coupler (4 used)
- C - AM37982 Receptacle (4 used)
- D - AR92069 Connector (2 used)
- E - T42285 Adapter (2 used)
- F - R26448 O-Ring (4 used)
- G - 19H1738 Cap Screw, 1/4 x 2.0"  
(2 used)
- H - AR92178 Selective Control Valve
- I - 24H1287 Washer 21/64 x 5/8 x .048"  
(2 used)
- J - 12H302 Lock Washer, 1/4" (2 used)
- K - 14H786 Nut, 1/4" (2 used)

SCV Valve and Couplers

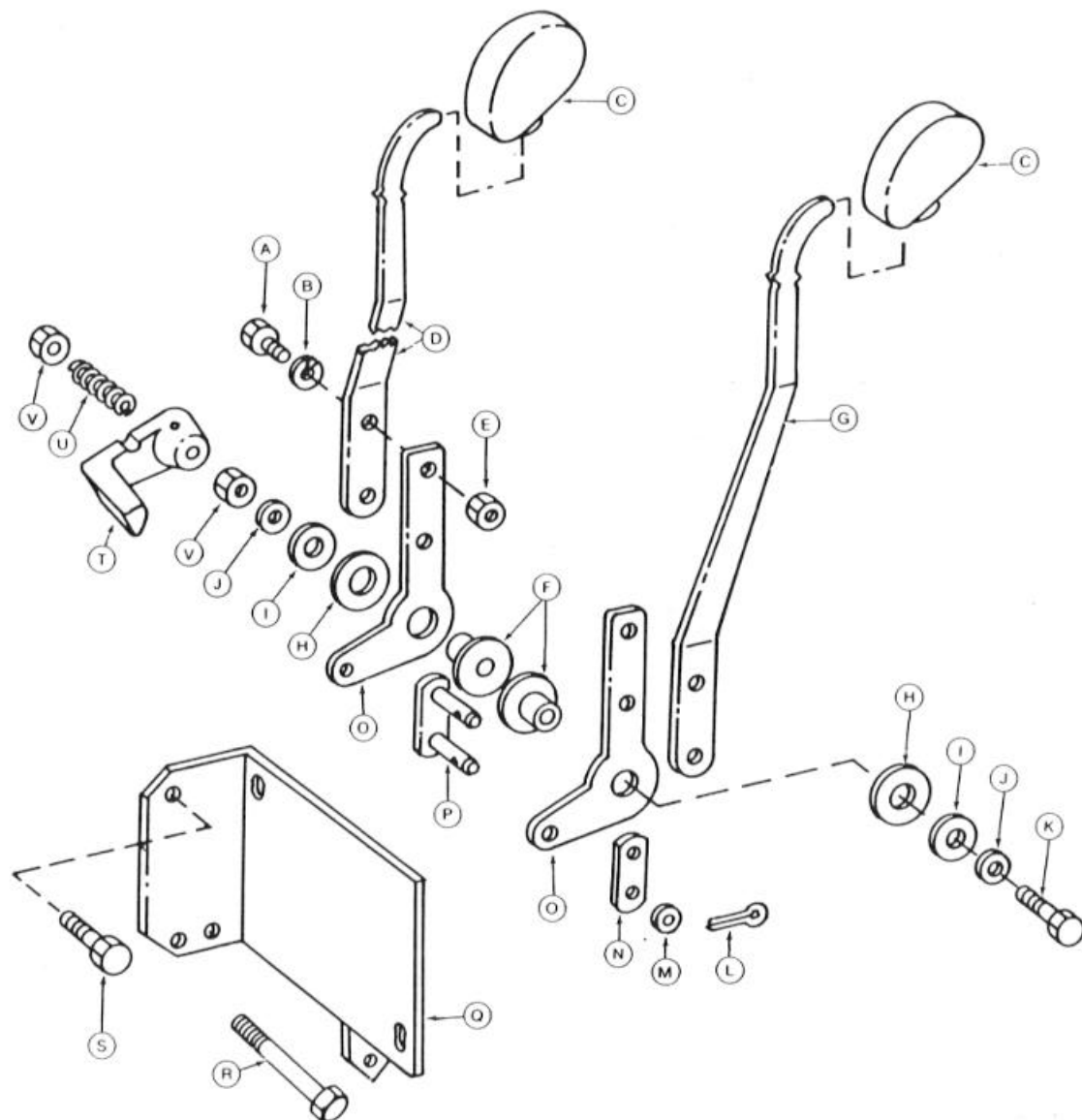

- A - 19H2127 Cap Screw, 5/16 x 7/8" (4 used)
- B - 12H303 Lock Washer, 5/16" (4 used)
- C - R52691 Knob (2 used)
- D - R70355 Lever, Outer
- E - 14H785 Nut, 5/16" (4 used)
- F - M82224 Flange Bearing (2 used)
- G - R70354 Lever, Inner
- H - 24H1395 Washer, 25/32 x 1-7/16 x .060" (2 used)
- I - T18786 Spring Washer (2 used)
- J - 24H1226 Washer, 1/2 x 1-1/4 x .075" (2 used)

- K - 19H2982 Cap Screw, 1/2 x 4"
- L - 11H230 Cotter Pin, 1/16" x 3/8" (4 used)
- M - 24H1283 Washer, 7/32 x 1/2 x .048" (4 used)
- N - R67660 Link (2 used)
- O - R67658 Bellcrank (2 used)
- P - AR88091 Link with Pins (2 used)
- Q - AR92370 Bracket
- R - 19M7296 Cap Screw, M8 x 100
- S - 19M7407 Cap Screw, M8 x 25
- T - R58511 Arm
- U - F1463R Spring
- V - U13185 Lock Nut, 1/2" (2 used)

SCV Bracket and Levers

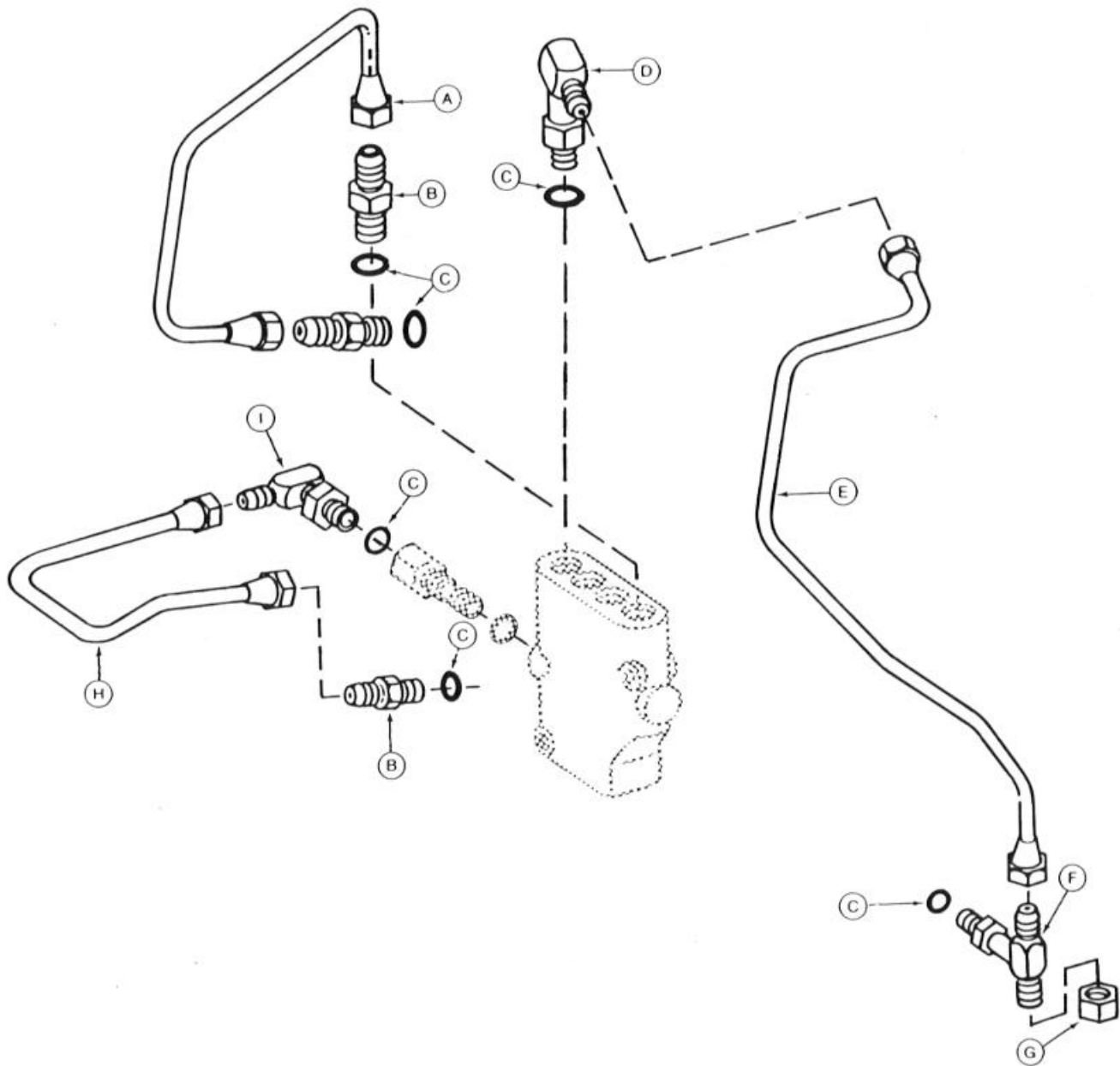

- A - AR92072 Oil Line, Pressure
- B - R27237 Connector (3 used)
- C - R26375 O-Ring (6 used)
- D - AR26799 90° Elbow
- E - AR92071 Oil Line, Return
- F - AT20894 Adjustable Tee
- G - R31736 Cap
- H - AR92070 Oil Pipe, Pressure Beyond
- I - AT32332 90° Elbow

#### Control Valve Lines

B. Subassemble Selective Control Valve:

NOTE: Refer to fitting diagrams on Page 27 , to check the appropriate part sizes of the fittings and O-rings.

1. Install R27237 connector and R26375 O-ring in the top of the selective control valve. Tighten connector.

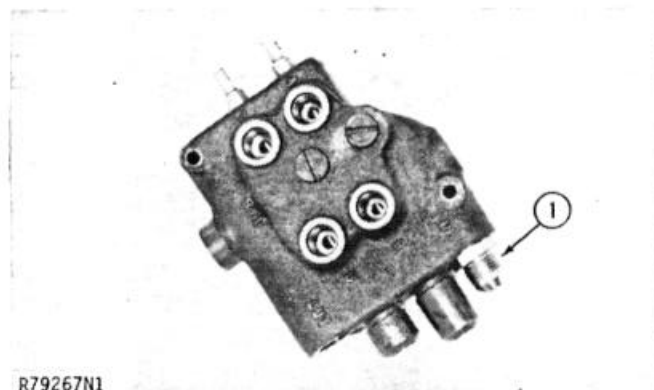

2. Install AR27699 elbow and R26375 O-ring in the top of the selective control valve. Do Not tighten elbow.

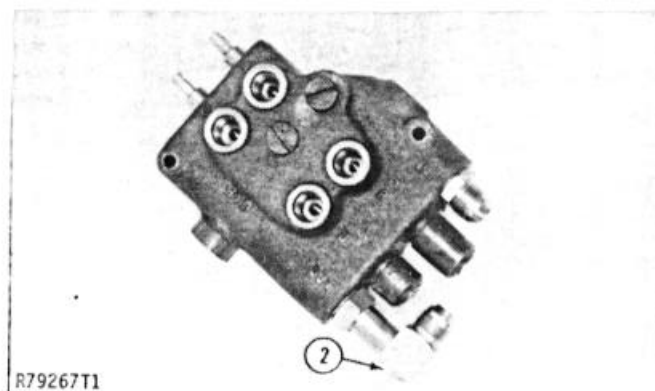

3. Install AR26763 90° elbow and R26375 O-ring in the side of the selective control valve. Do Not tighten elbow.

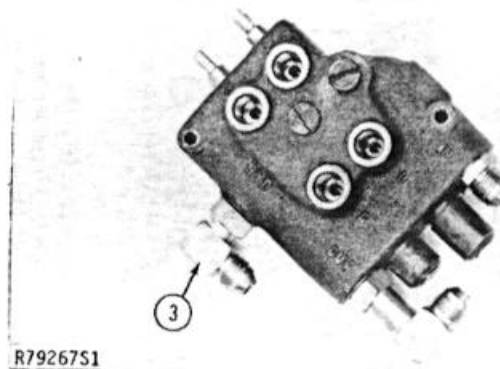

4. Install quik-coupler receptacle (A) and dust plug (B) to the connector (C).

NOTE: Use a joint sealing compound on the quik-coupler connector threads.

A - Receptacle  
B - Dust Plug  
C - Connector  
D - O-Ring

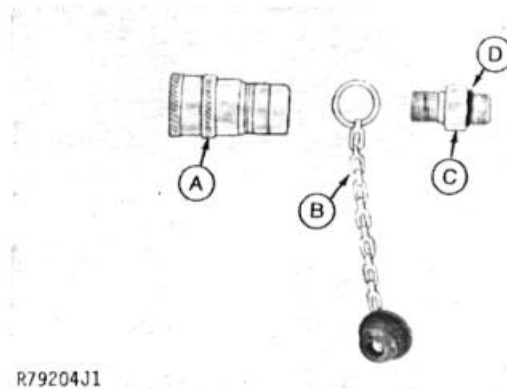

R79204J1

5. Install quik-coupler receptacle (A) and dust plug (B) to the special connector (C).

NOTE: Use a joint sealing compound on the quik-coupler special connector threads.

A - Receptacle  
B - Dust Plug  
C - Special Connector  
D - O-Ring

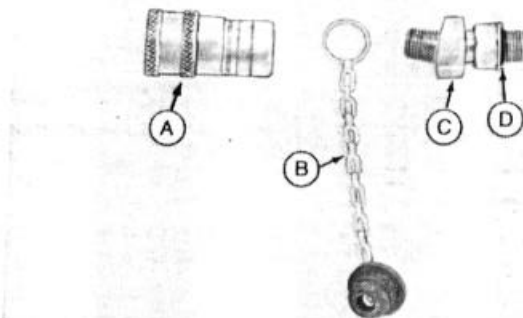

R79204I1

6. Install the SCV special receptacle connectors and R26448 O-rings to the selective control valves.

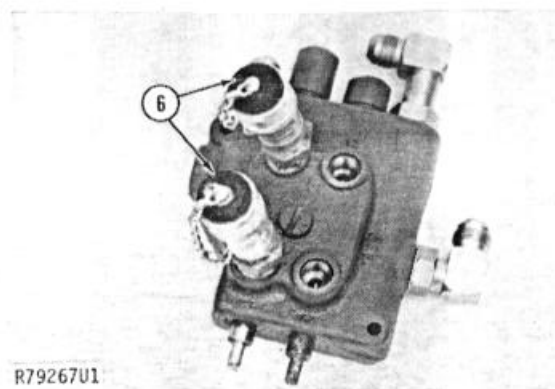

R79267U1

7. Install the SCV receptacle connectors and R26448 O-rings to the selective control valves.

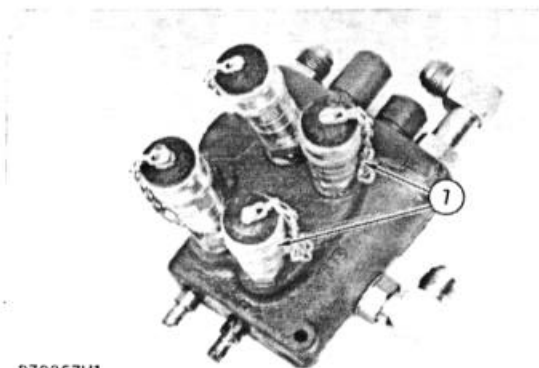

R79267W1

C. Subassembly SCV Bracket:

1. Install bearing (B) to Bellcrank (A).

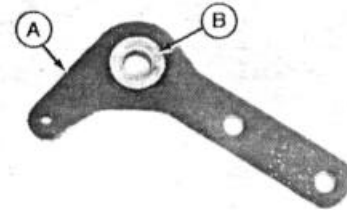

R79204A1

2. Install the bellcrank (E) to the SCV bracket as shown above. Use the following to mount the bellcrank:

- 1 - Cap Screw
- 2 - Spring Washers
- 4 - Washers
- 1 - Lock Nut

- A - Cap Screw, 1/2 x 4"
- B - Washer, 1/2 x 1-1/4 x .075" (2 used)
- C - Spring Washer (2 used)
- D - Washer, 25/32 x 1-7/16 x .060" (2 used)
- E - Bellcranks (2 used)
- F - Flange Bearing (2 used)
- G - Bracket
- H - Lock Nut

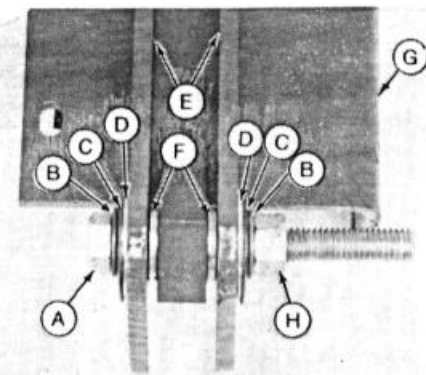

R79267C1

3. Install SCV lockout arm (B) to the SCV bracket cap screw using the following:

- 1 - Spring
- 1 - Lock Nut

- A - SCV Bracket
- B - Lockout Arm
- C - Spring
- D - Lock Nut

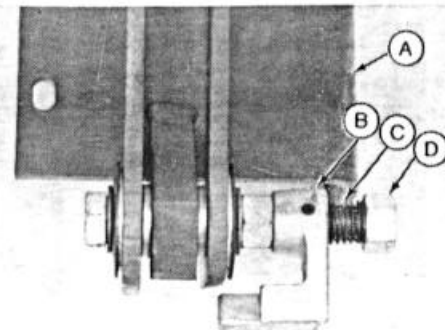

R79267B1

4. Mount the selective control valve (A) to the bracket (C) using the following:

2 - Cap Screw, 1/4 x 2"  
2 - Washers, 21/64 x 5/8 x .048"  
2 - Lock Washers, 1/4"  
2 - Nuts, 1/4"

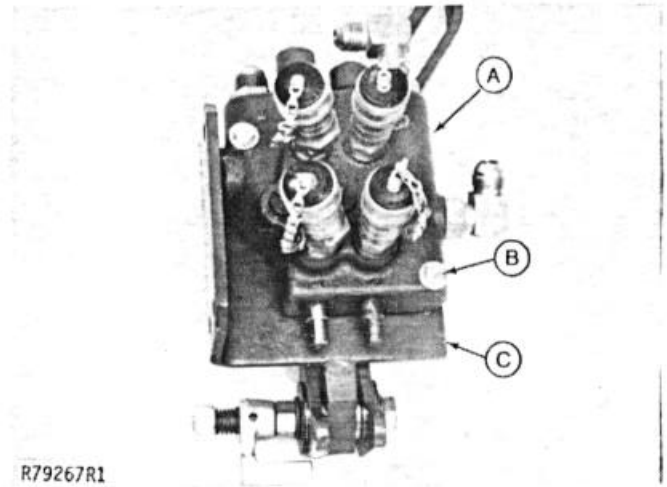

5. Mount the two SCV levers (A) to the bellcrank levers (B) using the following:

4 - Cap Screw, 5/16 x 7/8"  
4 - Lock Washers, 5/16"  
4 - Nuts, 5/16"

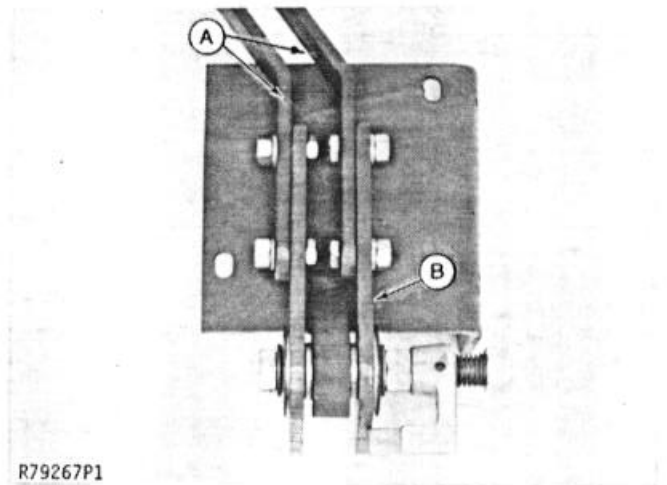

6. Attach the bellcranks (A) to the SCV valves using the following:

2 - Links  
2 - Link Assemblies  
4 - Washers  
4 - Cotter Pins

A - Bellcranks  
B - Link Assembly (2 used)  
C - Link (2 used)  
D - Washer, 7/32 x 1/2 x .048" (4 used)  
E - Cotter Pin, 1/16 x 3/8" (4 used)

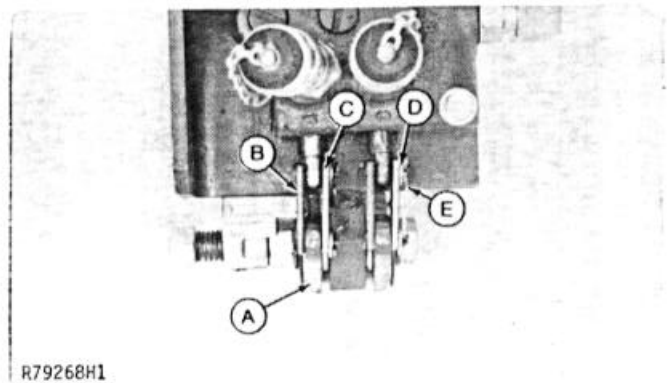



7. Install SCV lever knobs to the levers as shown.

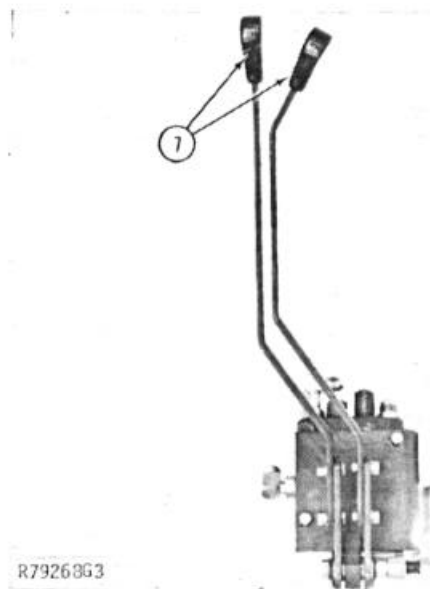

D. Adjust the Selective Control Valve:

1. Adjust the selective control valve levers per the following:
  - a. Mount the assembled SCV in a vise so the levers and mechanism have free movement.
  - b. With spring washers centered on cap screw, tighten locking nut (A).
  - c. Loosen lock nut (A) until levers are tight, but will return to the neutral position when you release them.

A - Lock Nut  
B - SCV Lever (2 used)  
C - Float Lockout Arm  
D - SCV Mounting Screw Nut (2 used)

2. Adjust the float lockout mechanism per the following:
  - a. Shift lever (B) forward until you feel slight resistance, but not into first detent.

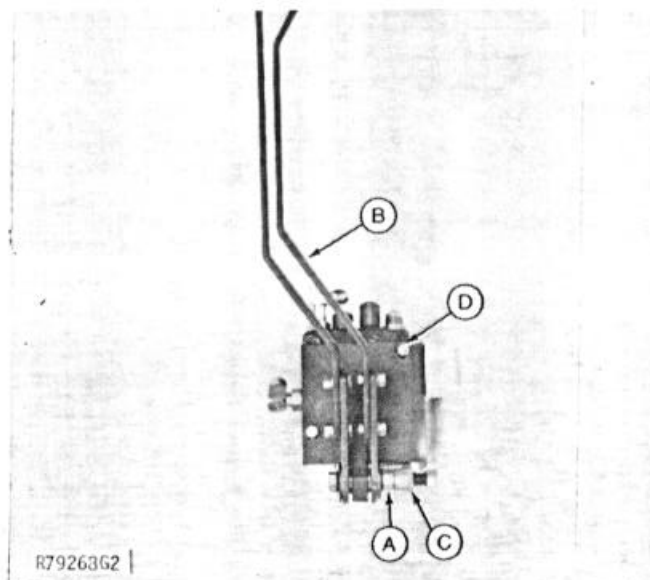

- b. While holding lever in this position, rotate lockout arm (C) until tang on arm engages between bellcrank and lower edge of mounting bracket.
- c. If the tang on arm engages and lever will not move forward out of first detent, no further adjustment is needed.
- d. If tang on arm does not engage or if lever can be moved forward beyond the first detent proceed with the following.
- e. Loosen nuts (D) just enough to allow valve assembly to slide up and down in slotted holes.
- f. Relocate valve assembly until the location of tang on arm (C) prevents lever (B) from going beyond first detent.
- g. Tighten nuts (D).
- h. Repeat steps 2a and 2b above.

E. Install Transmission Case and Junction Block Fittings:

- 1. Remove transmission case plug from the LH side of case.

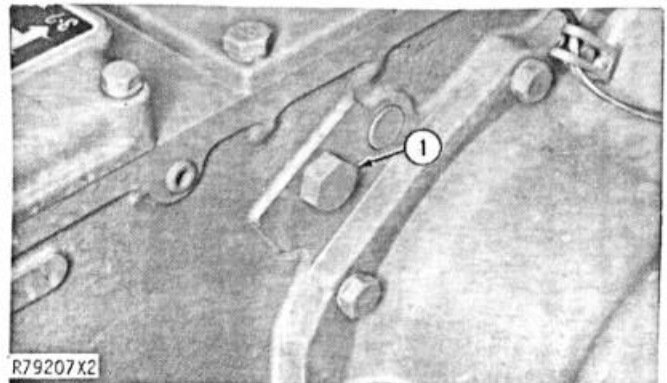

2. Install AT20894 Tee and R26375 O-ring into the transmission case port.

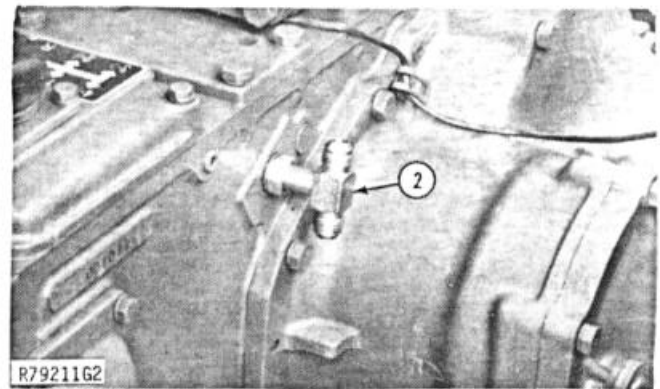

3. Install R31716 cap on the transmission case elbow.

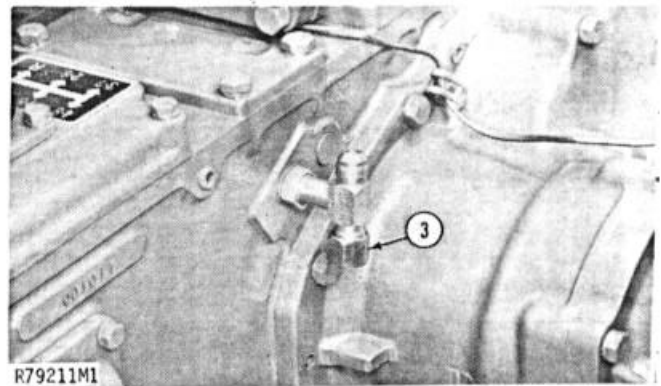

4. Remove hex plug from the lower port of the junction block.

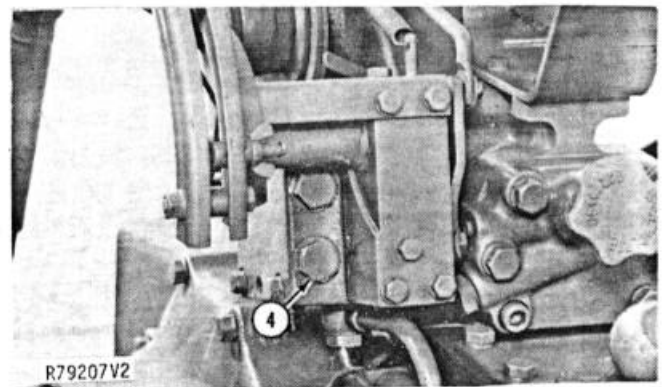

5. Install the 15H275 pipe plug (A) in the lower port of the junction block.
6. Remove the hex plug from the upper port of the junction block.

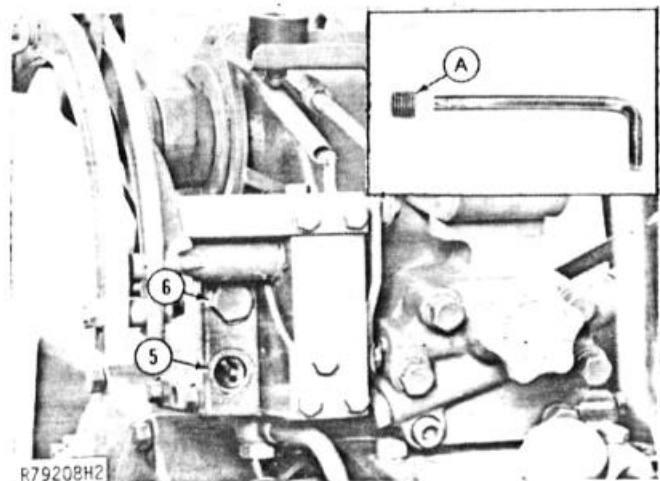

7. Install two R27237 connectors and R26375 O-rings in the junction block.

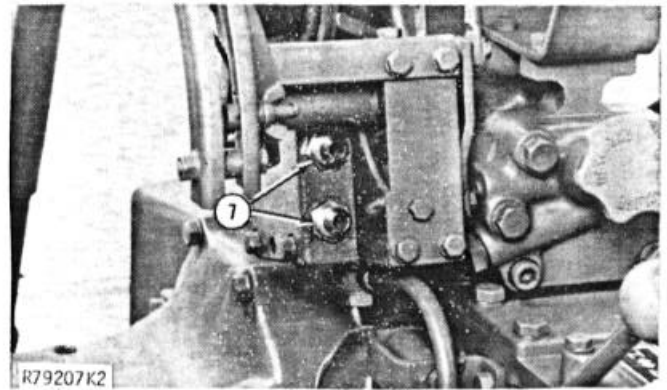

F. Install Valve and Hydraulic Lines:

1. Install selective control valve bracket using the following:

1 - Cap Screw M8 x 25 mm  
Top Hole

1 - Cap Screw M8 x 100 mm  
Lower Hole

IMPORTANT: Before installing each hydraulic line be sure plastic cap plugs are removed from ends of lines.

2. Install AR92070 pressure beyond line from the SCV pressure beyond connector to the junction block upper connector.

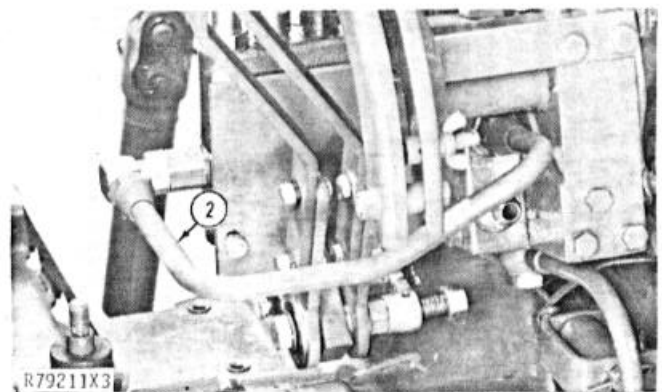
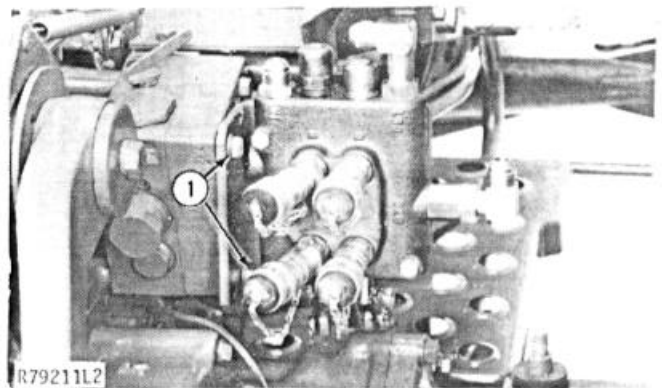



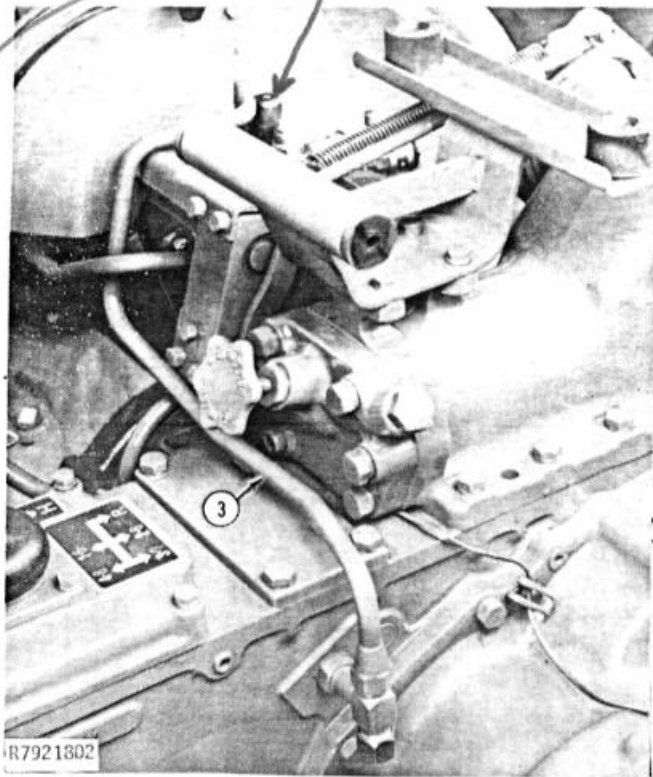



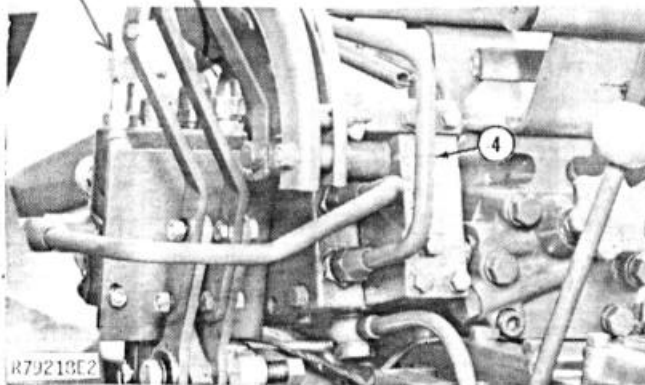

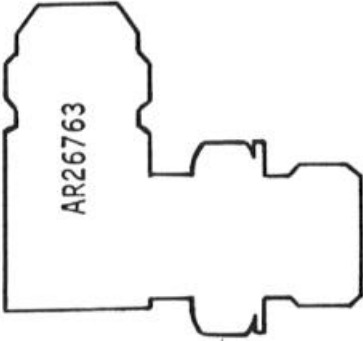
3. Install AR92071 SCV return line to the tee on the left hand side of the transmission case.

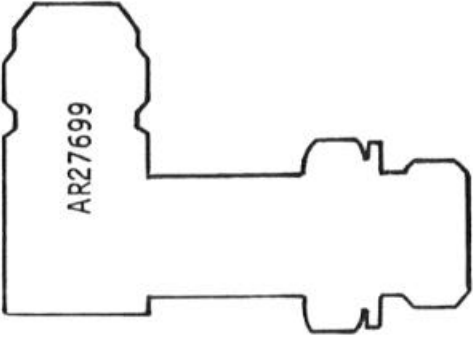

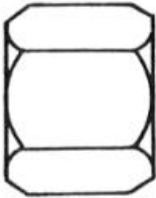
4. Install AR92072 from the top SCV pressure connector to the lower connector in the junction block.

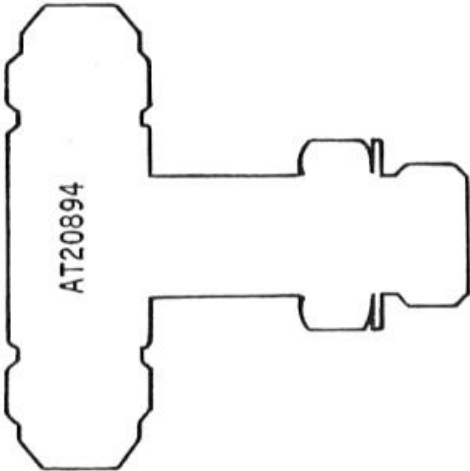

 <p>AR26763</p>  <p>R26375</p>	 <p>R26448</p>
 <p>AR27699</p>  <p>R26375</p>	 <p>R31736</p>
 <p>R27237</p>  <p>R26375</p>	 <p>AT20894</p>  <p>R26375</p>