



JOHN DEERE

Product Services Information

INSTALLATION INSTRUCTIONS

(Includes English, French, German, Spanish and Italian)



JOHN DEERE

AUTO CONNECT MID MOWER DRIVE

Parts in Kit

Qty.	Description
1	Driveshaft Assembly
4	Bracket, Auto Connect Female Coupler
6	Bolt, M8x30
6	Locknut, M8
1	Woodruff Key
1	Coupler, Auto Connect Male
2	Set Screw

NOTE: Retain these installation instructions with the machine operator's manual.

Parking Safely

1. Stop machine on a level surface, not on a slope.
2. Disengage PTO and stop attachments.
3. Lower attachments to the ground.
4. Lock park brake.
5. Stop engine.
6. Remove key.
7. Wait for engine and all moving parts to stop before you leave the operator's station.
8. Close fuel shut off valve before servicing the fuel system, if your machine is equipped.
9. Disconnect the battery ground cable before making repairs to electrical system or doing any welding.

Install Kit

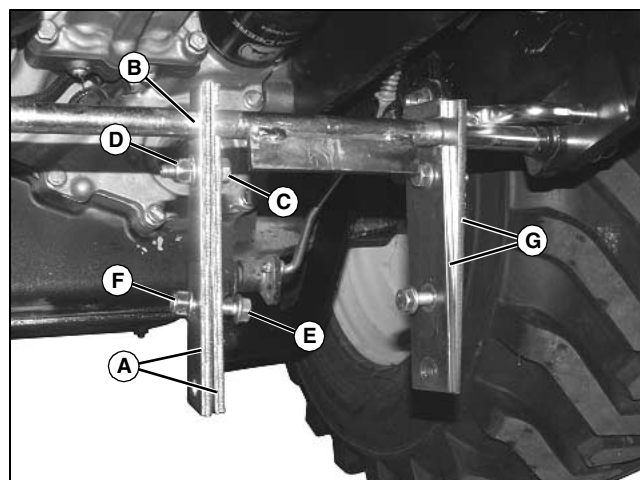

MX46397

1. Position two brackets (A) on the mower deck lift arm tie rod, with the notch in each bracket (B) 180° apart.
2. Install one M8x30 bolt (C) through the holes in the brackets closest to the tie rod. Install and snug a M8 locknut (D), but do not tighten completely.
3. Install a second M8x30 bolt (E) through the center holes in the brackets. Start a M8 locknut (F) on the bolt, but do not tighten at all.
4. Repeat steps to install the second set of brackets (G) on the opposite side of the tie rod tab.

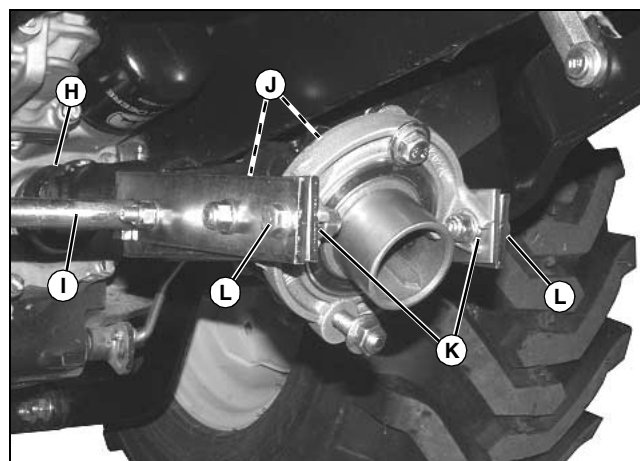

MX46399

5. Position the driveshaft assembly on top of the mower deck lift arm tie rod (H) and connect the rear drive shaft yoke (I) to the transmission mid PTO shaft. Ensure that the yoke quick coupler positively engages the detent in the PTO shaft.
6. Engage the rear slots (J) in the auto connect coupler

housing between the brackets and the center bolt on the left and right sides.

7. Align the remaining holes in the brackets with the front slots (K) in the auto connect coupler housing. Install a M8x30 bolt (L) and M8 locknut in each side.

8. Tighten all hardware securely. Tighten all M8 hardware to 30 N•m (22 lb-ft).

9. Set mower lift to install height setting as shown in operator's manual.

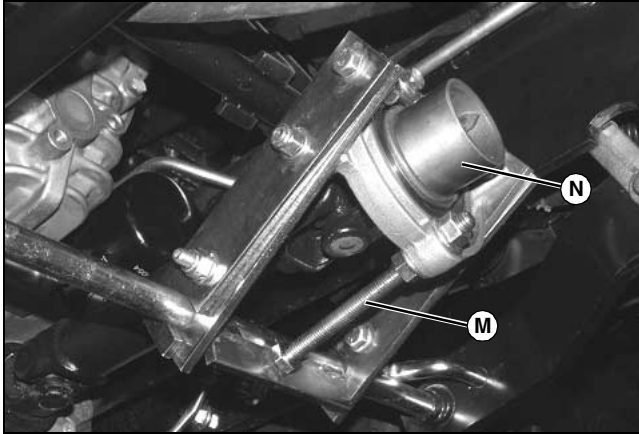

MX46400

10. Adjust the stop bolt (M) as required to level the auto connect female PTO coupler (N). Do not tighten M10 nuts on stop bolt at this time.

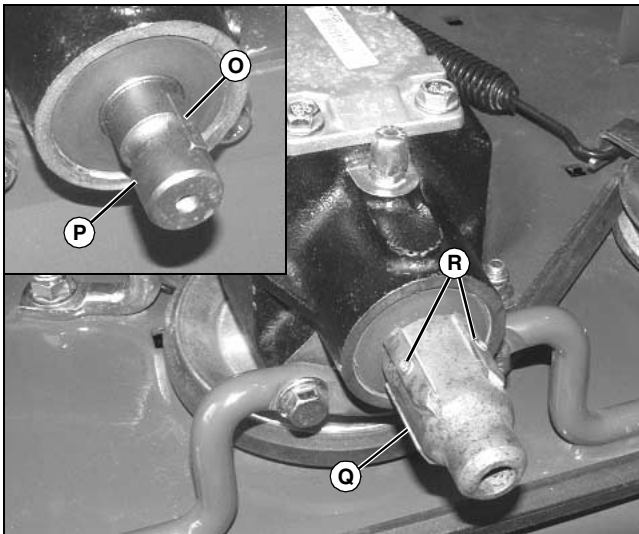

MX46401

11. Install the woodruff key (O) in the mower deck input shaft (P).

NOTE: Male coupler is a precision fit to the shaft and may require a driving force with rubber mallet to seat the coupler completely.

12. Slide the male auto connect PTO coupler (Q) on the mower deck input shaft and secure with two M6 set screws (R). Tighten M6 set screws to 6.8 N•m (60 lb-in.).

13. Attach mid-mower as shown in operator's manual, making certain male and female couplers engage.

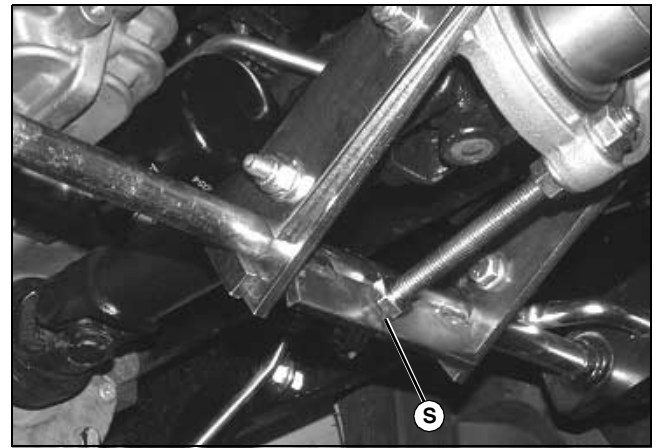

MX46400

14. Confirm that the final adjustment of stop bolt has a 1 mm (1/32 in.) gap (S) between bolt head and stop bar. Tighten all M10 stop bolt nuts to 60 N•m (44 lb-ft) to secure position.

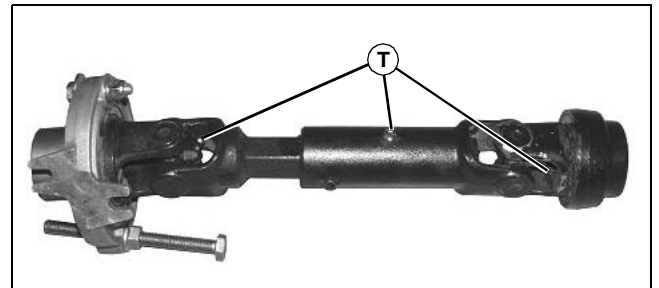

MX46398

Picture Note: Driveshaft shown removed for better view.

15. Lubricate three grease fittings (T) on the driveshaft.