

Mount System

- NOTES:
- 1. Tractor brackets get welded to lower ROPS plates.
 - 2. Mount requires removal of ROPS cross brace to make room for Backhoe seat.
 - 3. Spacing of tractor plates should be 27" inside to inside.

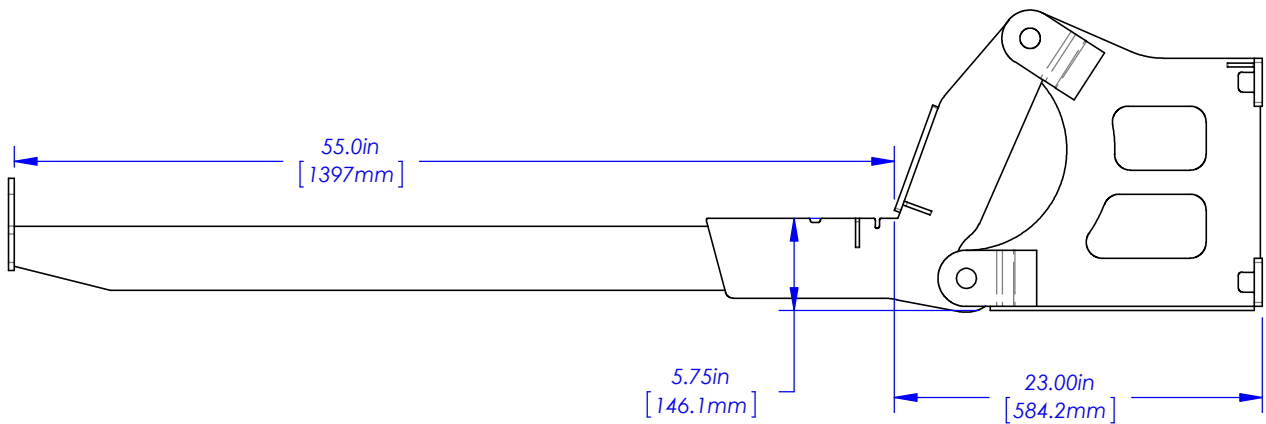
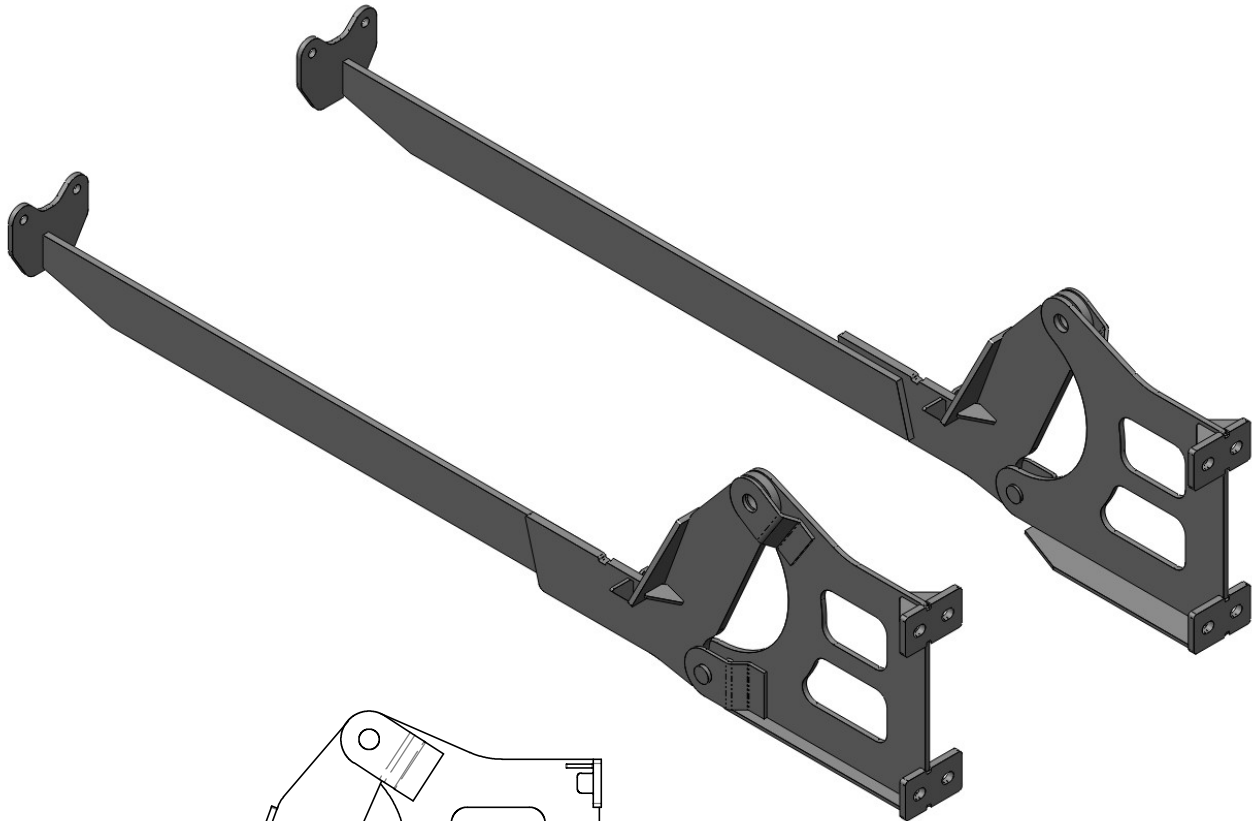

Way Out Engineering LLC
Chris@wayouteng.com 505-217-1928

Mount System

PROPRIETARY AND CONFIDENTIAL This document contains proprietary information which shall not be used for any purpose nor reproduced or transmitted by any method in any form to any party not explicitly authorized by a representative of the company whose logo appears above.	DO NOT SCALE DRAWING UNDIMENSIONED FEATURES ARE CONSIDERED NOMINAL AT 3D MODEL SURFACES WITH TOLERANCE ±0.50mm[0.020"]	CONFORMS TO ASME Y 14.5M 1994 LINEAR mm[in] None±1.00 [X ±.040"] X ±0.50 [XX ±.020"] XX ±0.25 [XXX±.010"] ANGLE (deg.) None± 2.0° X ± 1.0° XX ± 0.5°	DRAWN BY: Chris Hinds	MATERIAL: See Components	Weight: 183.7563 kgs 405.113 lbs SHEET 1/1
			APPROVED:	FINISH: See Components	
			APPL/ASSY:		