



CAB DEPOT

1-800-225-7290

*Designers &
Manufacturers of
Quality Cabs,
Enclosures and
Enclosure Kits*

MOUNTING INSTRUCTIONS

200- 1142

John Deere 3032E/3038E



With

305 Loader INDY CAB & HEATER

Toll Free: 1.800.225.7290

Tel: 613.534.2230

Fax: 613.534.2182

Check out our new website...

www.cabdepot.com

Limited Warranty

Sims Cab Depot warrants to the original purchaser (the "Claimant"), that Sims Cab Depot products will be free from defective materials or workmanship, under normal use and service, for a period of (1) full year (or 1500 hours, whichever is less) from the original invoice date.

Sims Cab Depot's liability under this Limited Warranty is limited to the repair or (at the discretion of Sims Cab Depot) the replacement of those components of its products, which were manufactured by Sims Cab Depot that are defective in materials or workmanship. Sims Cab Depot shall have no liability under this Limited Warranty unless Sims Cab Depot is notified of the defect during the stated Warranty Period.

All returns require a Returned Material Authorization Number (RMA#). Warranty claims must be submitted to Sims Cab Depot at 1-613-534-2280 or 1-800-225-7290 prior to written authorization. All warranty work not pre-authorized by Sims Cab Depot will not be covered by this warranty agreement. Claimant must arrange shipping of the returned and repaired or replaced product or component from Sims Cab Depot plant in Long Sault, Ontario at the Claimant's own risk and expense. Sims Cab Depot must receive all returns within (30) days of issuance of a RMA#.

Limitations and Exclusions: Sims Cab Depot has no responsibility to a Claimant under this Limited Warranty or on any other basis for any of the following:

- a) defects caused, in whole or in part, by accident or misuse, negligence or failure to maintain the product or component ;
- b) products or components sold to a customer on an "as is" basis;
- c) wiper blades, light bulbs, fuses, clear vinyl or other consumables;
- d) glass where the point of failure has not been preserved intact and delivered to Sims Cab Depot for analysis of the cause of the failure;
- e) products or components which have been modified after shipping from Sims Cab Depot to its customer;
- f) transportation charges for returned, repaired or replacement items;
- g) defects that are subject of an Sims Cab Depot initiated recall where the Claimant fails to comply with the terms of the recall notice that comes to the attention of the Claimant;
- h) components of Sims Cab Depot products that are manufactured by third parties (Sims Cab Depot's only obligation in relation to such components shall be to accord to the Claimant the benefit of any transferable warranty accorded to Sims Cab Depot by third party manufacturer);
- i) defects in workmanship or materials in products or components that are repaired or replaced by Sims Cab Depot unless Sims Cab Depot is notified of the new defect within the Warranty Period that applied to the original product or component that has been repaired or replaced;
- j) defects that result, in whole or in part, from inadequate engineering or specifications provided to Sims Cab Depot by its customer;
- k) any actual or alleged deficiency in technical or engineering services or advice provided by Sims Cab Depot to its customer whether provided for valuable consideration or otherwise;
- l) consequential damages, or any other damages whether foreseeable or not, resulting from the defect or any delay in remedying the defect; and
- m) any breach or alleged breach of any implied warranty of merchantability or fitness for particular purpose of use;
- n) defects or part failure due to misuse or failure to follow recommended cab installation procedures;
- o) travel expenses, including mileage.

This Limited Warranty expresses the entire obligation of Sims Cab Depot, its officers, directors, agents and employees, to its customer or any Claimant in respect of any defect in workmanship, or materials of any product or component sold or manufactured by Sims Cab Depot whether on grounds of breach of contract, negligence or other tortious liability, breach of express or implied warranty or other basis in law of any jurisdiction.

Acceptance by a customer of delivery of products of Sims Cab Depot, constitutes acceptance of this Limited Warranty in lieu of all other warranties express or implied including without limitation all implied warranties of merchantability or fitness for particular purpose or use and constitutes acceptance by customer of the exclusions and limitations of the liability of Sims Cab Depot set out above.

*Labor rate fixed at a maximum of \$40.00 per hour (U.S.) and \$47.00 per hour (CDN) based on Sims Cab Depot's determination of applicable hours.

WARNING! This enclosure is NOT a Roll Over Protective Structure (ROPS). Where required by regulation, standard or Original Equipment Manufacturer specification, a ROPS must be used in conjunction with this enclosure. Failure to comply could result in injury or death. This enclosure is for use as reasonable weather protection only and not for protection against roll over, falling objects, collision, harmful chemicals or other hazards. ONLY qualified, experienced operators should operate this equipment!

Basic Rules or Guide Lines Before Installing the Cab

- 1. Read the Mounting Instructions completely and thoroughly before starting the installation.**
- 2. Cab installation time will vary with installer experience, equipment, tractor model variations, tractor attachments, optional accessories**
- 3. Disconnect the Negative terminal on the battery to reduce the risk of electrical shock.**
- 4. Layout all cab components that are included in the kit and identify them with the steps in the Mounting Instructions.**
- 5. Identify all hardware included and group with its specific cab components as called out in the Mounting Instructions before beginning.**
- 6. Make sure all hose clamps that are required for the installation of a Heater Kit are present before cutting any of the tractor coolant lines.**
- 7. When installing the optional hot water heater kit, if coolant pressure or volume is insufficient, an optional electric auxiliary pump can be purchased to assist in achieving desired coolant flow – Sims P/N 1701-1023S**
- 8. Identify and store all unused item's that were included in the kit, they could be required for accessories for the tractor.**
- 9. All Nut and Bolt combinations should use Flat Washers under the heads of the bolt and nut.**
- 10. All Nut and Bolt combinations require a locking mechanism due to vibration. (Locking Nuts or Lock Washers are recommended in most applications).**
- 11. All Nuts and Bolts should be left loose until the cab is completely assembled to allow for final adjustments.**
- 12. If any original tractor equipment or accessories had to be removed (example: grab handles on fenders), keep all original hardware. It may be required later in the installation.**
- 13. Identify all steps that require the use of a lift/hoist or second person before beginning the installation.**
- 14. Be sure to read and understand all Warning Decals included with your kit.**
- 15. Following the initial cab installation, periodically check and re-tighten all fasteners on the cab.**
- 16. Note that some installation instructions included with your cab may refer to optional accessories not supplied with the basic cab.**

Some Basic Tools Recommended for this Installation Procedure

- Imperial Socket and Wrench Set**
- Metric Socket and Wrench Set**
- Standard Philips Screw Driver**
- Standard Slot Screw Driver**
- Wire Cutters & Strippers**

Tractor Preparation

- Remove the slow moving vehicle sign and bracket.
- Remove flasher lights from ROPS

Cab Installation

1. Install the front mounts to the outside of the loader tower mounts, through the rearmost bolt holes. Secure using the original bolts that were there. If there is no loader on the tractor, secure the front mounts to the same holes mentioned above, but use the Mount Spacer Kit (10-3344S) to space the front mounts away from the tractor, into the correct position. Use the hardware provided in the Mount Spacer Kit, if no loader is on the tractor.

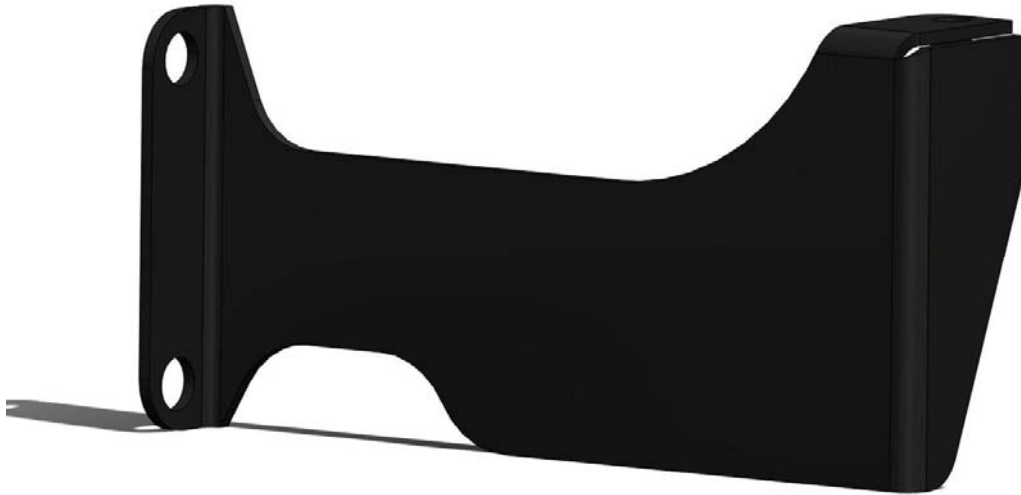

2. Place the Roof upside down on a table or other non-scratch surface.

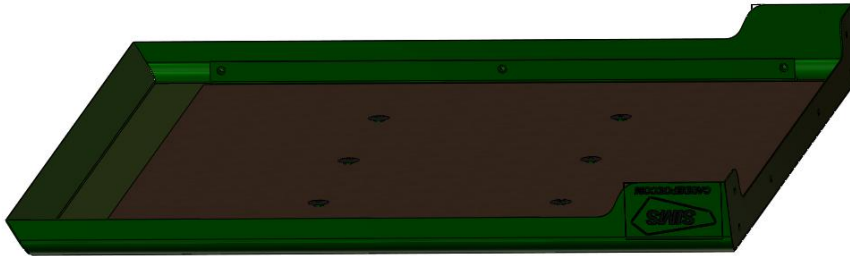

3. Install the Left and Right Side Panels to the Roof using:

- Four 5/16-18 x 2" Hex Bolts
- Two 5/16-18 x 3/4" Hex Bolts
- Four 5/16-18 x 3/4" Carriage Bolts
- Ten 5/16" Flat Washers
- Six 5/16" Spring Lock Washers
- Four 5/16-18 Nylon Lock Nuts

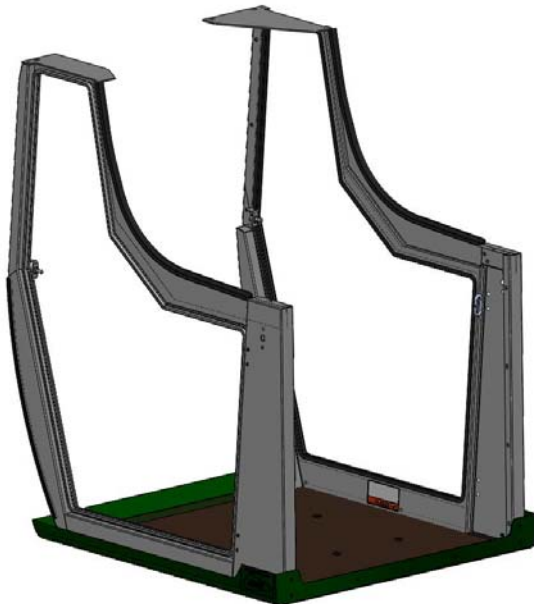

4. Attach the Rear Panel to the Roof and Side Panels using:

- Eight 5/16-18 x $\frac{3}{4}$ " Hex Bolts
- Two 5/16-18 x $\frac{3}{4}$ " Carriage Bolts
- Eighteen 5/16" Flat Washers
- Ten 5/16-18 Nylon Lock Nuts

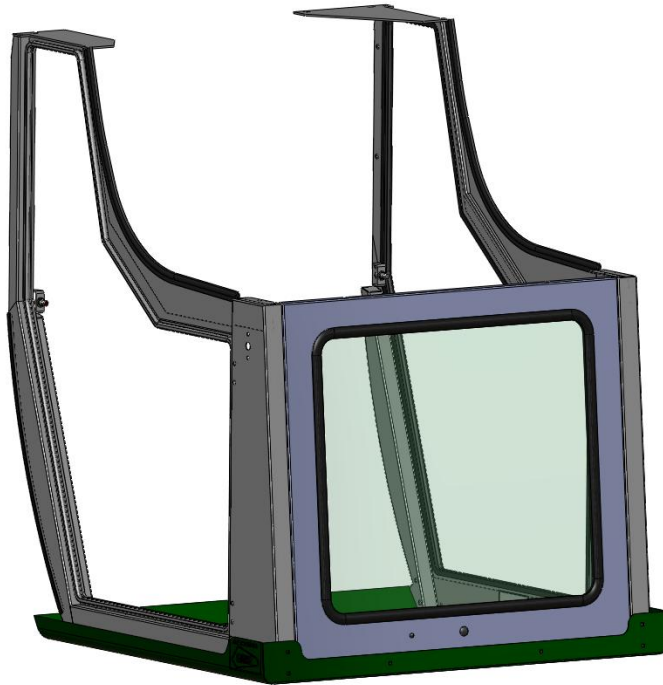

5. Attach the Lower Rear Panel to the Rear Panel and Side Panels using:

- Six 5/16-18 x $\frac{3}{4}$ " Hex Bolts
- Twelve 5/16" Flat Washers
- Six 5/16" Nylon Lock Nuts

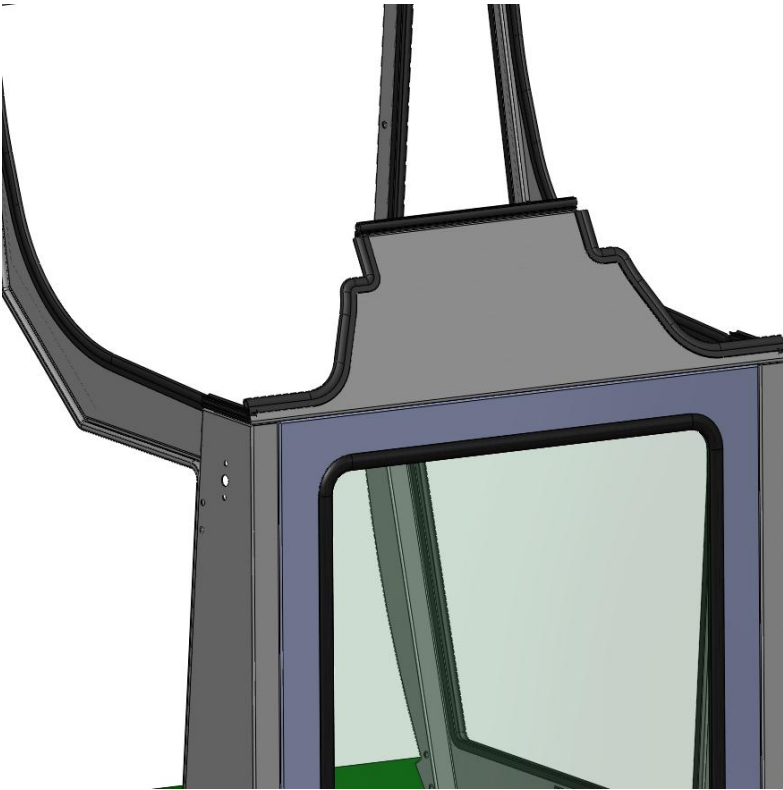

6. Install the Windshield to the Front Header. It is important to do this step before attaching the Front Header to the rest of the cab. Use:

- Four 1/4-20 x 3/4" Screws

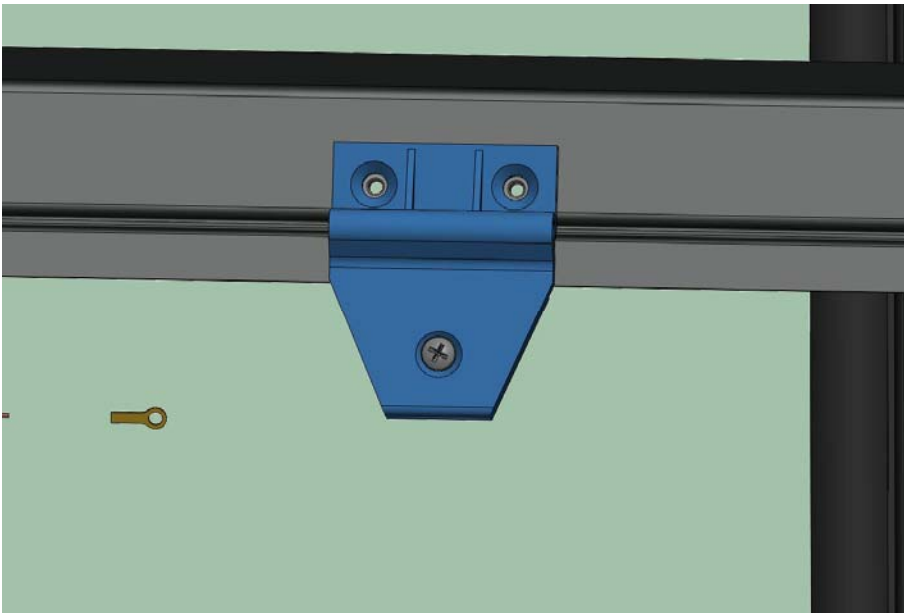

7. Install the Front Header to the Side Frames using:

- Four 5/16-18 x 3/4" Hex Bolts
- Four 5/16" Flat Washers
- Four 5/16" Spring Lock Washers



8. Attach the Left and Right Cowl Panels to the Side Frames using:

- Six 5/16-18 x $\frac{3}{4}$ " Hex Bolts
- Six 5/16" Flat Washers
- Six 5/16 Spring Lock Washers

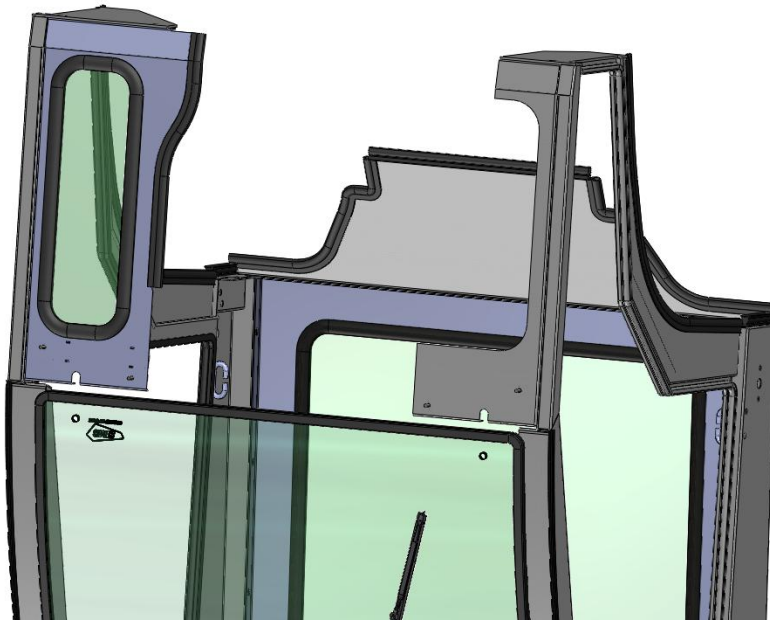

9. Install the Centre Cowl Panel to the Left and Right Cowl Panels using the four $\frac{1}{4}$ -20 threaded knobs provided.

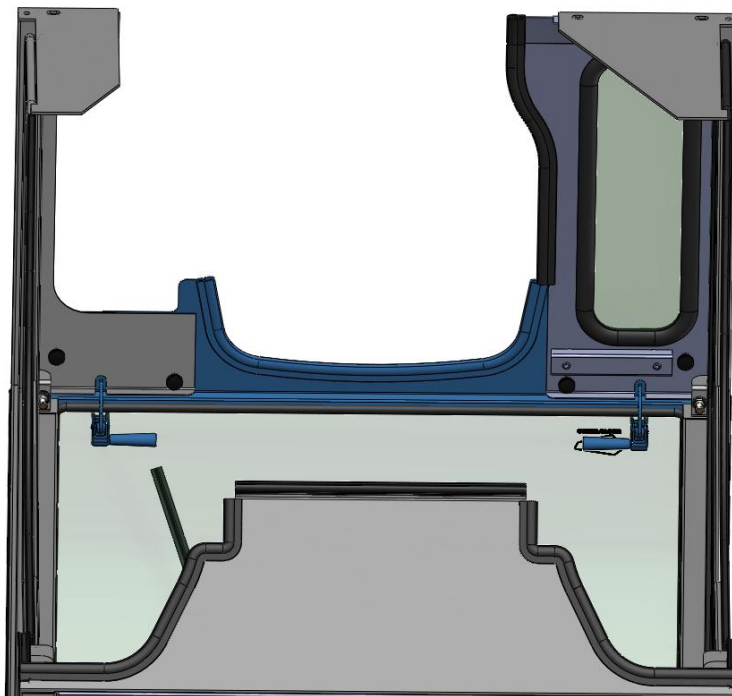

10. Install the plastic windshield handles to the Windshield and Centre Cowl Panel using the 3/16" pins provided, as shown in the picture below:

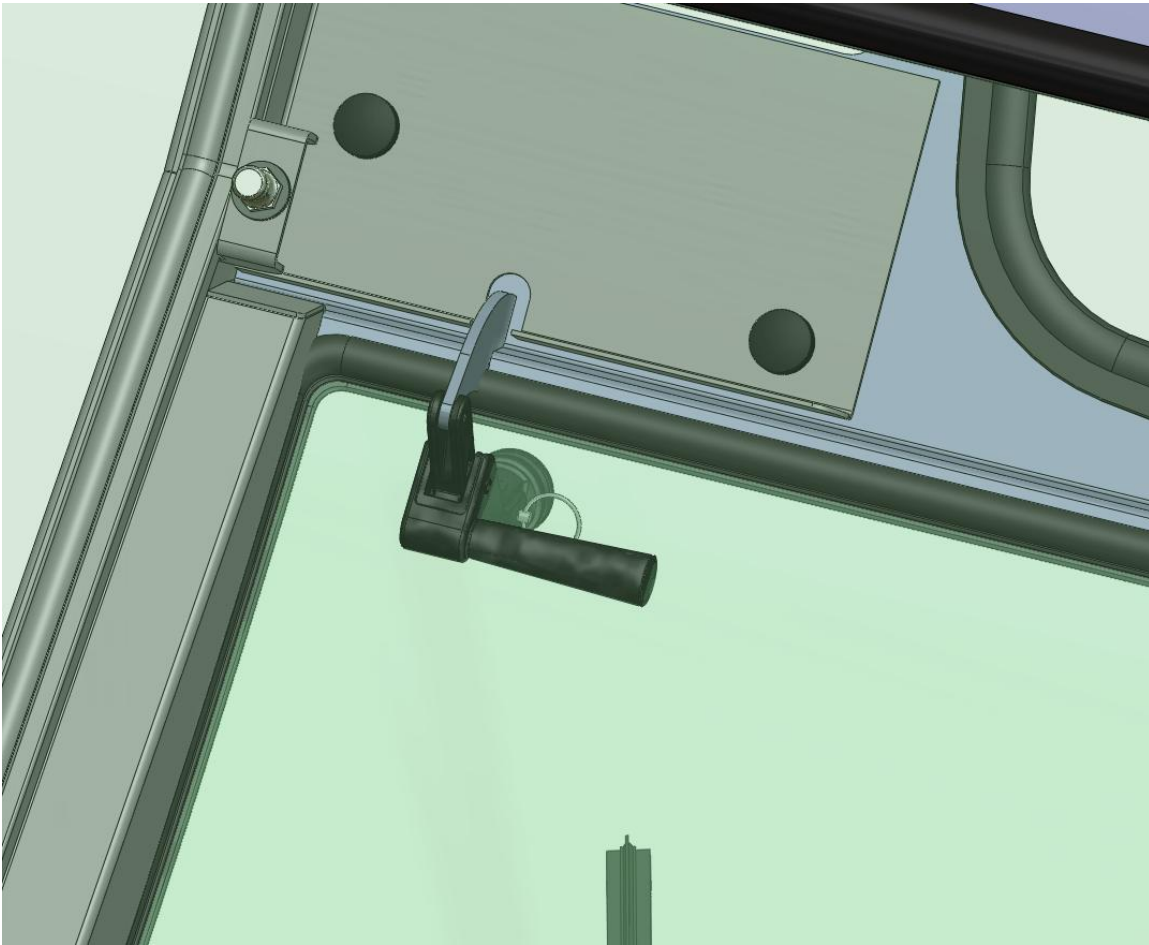

11. Using a hoist or other safe lifting device, lower the cab onto the tractor, attaching it to the Front Mounts. Continue Holding the Cab Level, with the Rubber sealing against the Fenders with the Hoist until the Rear Mounts are installed. Use:

- Two 3/8-16 x 1" Hex Bolts
- Two 3/8 Flat Washers
- Two 3/8 Spring Lock Washers

12. Attach the Rear Mounts to the Side Panels and clamp the Against the ROPS using:

- Four 5/16-18 x 3/4" Hex Bolts
- Four 5/16 Flat Washers
- Four 5/16 Spring Lock Washers
- Eight 3/8-16 x 4.5" Hex Bolts
- Sixteen 3/8 Flat Washers
- Eight 3/8-16 Nylon Lock Nuts

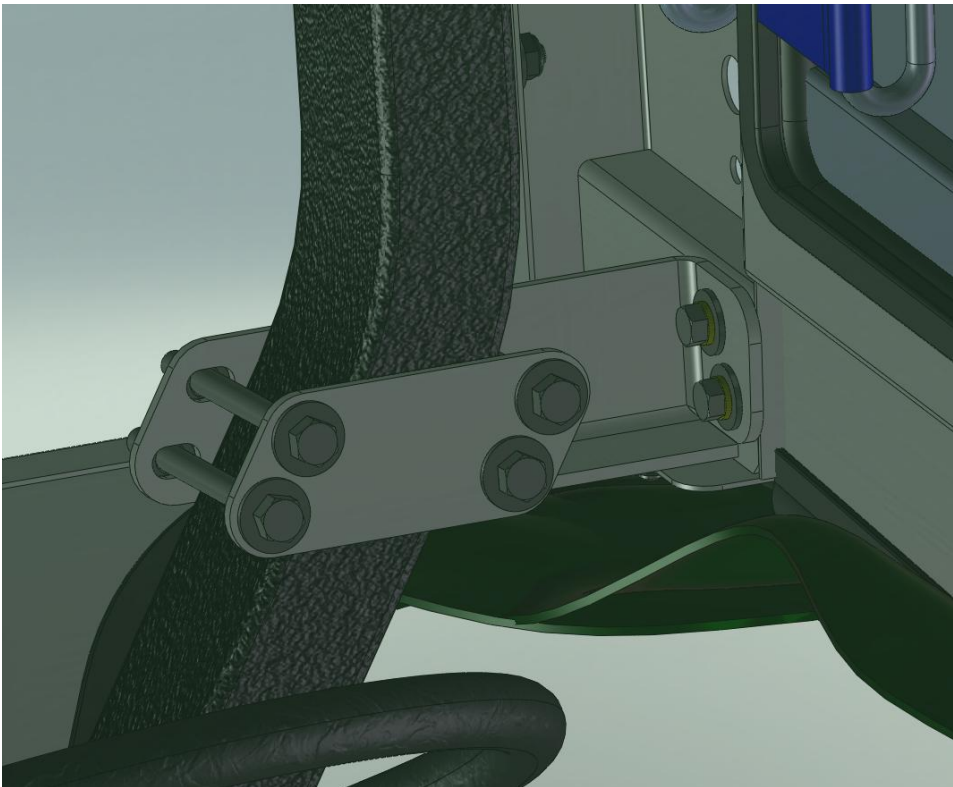

13. Install the wiper motor power wire (with fuse) to a 12v power supply that is live only when the ignition is in the on position. Install the ground wire by connecting it to one of the wiper motor casing screws and the other end to one of the front header using the self tapping screw provided. Operate the wiper motor by switching to the "on" position, note the sweep of the shaft and then install the arm and blade to correspond with the observed sweep.

14. Install the door hinge half, quantity 2, to the cab using (per side):

- Four 5/16"x3/4 Carriage Bolts
- Four 5/16 Flat Washers
- Four 5/16 Nylon Lock Nuts

(Leave the hardware loose at this time)

15. Install the door hinge half, quantity 2, to the door using:

- Four 5/16"x3/4 carriage bolts
- Four 5/16" flat washers
- Four 5/16" nylon lock nuts

(Leave the hardware loose at this time)

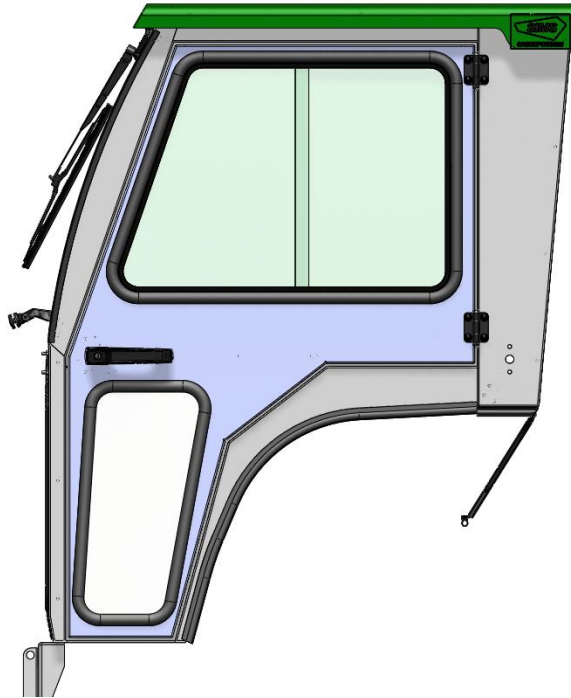

16. Install the door to the cab using:

- Two 5/16"x3-1/4 hex bolts
- Two 5/16" nylon lock nuts

17. Install the Flasher Lights that were removed from the ROPS before cab installation to the existing holes in the side of the cab.

Latch the door closed and tighten all hardware including the striker pin

Optional Heater Mounting Instructions

1. Drain coolant from engine
2. Remove top of thermostat housing
3. Remove thermostat
4. Install street elbow into collar
5. Install collar with gaskets and shut off valve
6. Re-install thermostat and housing using:
 - Two m8 – 1.25 x 60 mm bolts
 - Lock washers (torque to man. spec)
7. Cut lower rad hose and install T adaptor with 3/8 npt hose adaptor
8. Secure rad hoses to T adaptor using hose clamps
9. Insert heater hoses onto fittings and secure with hose clamps
10. Route heater hoses in a safe manner to the L.H. side of engine compartment
11. Pass heater hoses through cowl grommets.
12. Install Heater Bracket to the LH Cowl using:
 - Two 5/16-18 x 3/4" Hex Bolts
 - Two 5/16 Spring Lock Washers
 - Two 5/16 Flat Washers
13. Install heater to bracket using:
 - Four 1/4-20 x 3/4" Hex Bolts
 - Eight 1/4 Flat Washers
 - Four 1/4-20 Nylon Lock Nuts
14. Slip hoses onto heater and secure using hose clamps
15. Connect the orange heater wire to terminal "H" on the switch. Connect the red heater wire to terminal "L" on the switch.
16. Connect the power wire with 20 amp fuse to terminal " B " on the switch
17. Install switch to Switch Bracket
18. Refill engine with coolant

If "NO" port can be used on "Draw" side of water pump use "T" adaptor

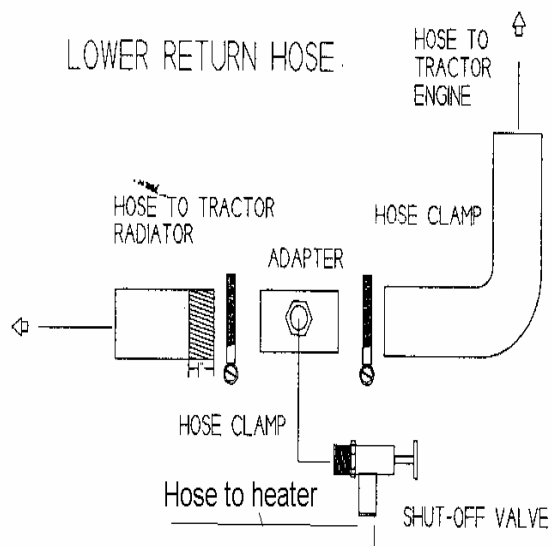

If "NO" port exist in thermostat housing install thermostat adaptor

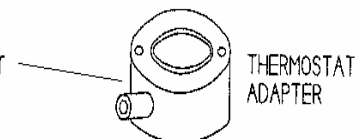

If port exist in thermostat housing install hose fitting with reducer if necessary

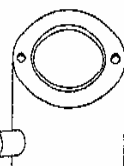
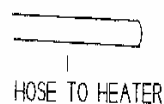

TRACTOR ENGINE

