

Op. 10 402**THERMOSTAT****Removal**

1. Remove the radiator cap.
2. Open the radiator drain tap, 1, and collect the coolant in a clean container.

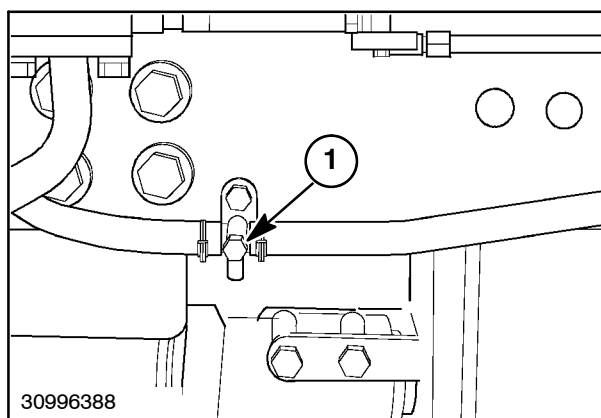

218

3. Remove the radiator hose, 6, and bypass hose, 7, from the thermostat housing, 2.
4. Remove the retaining bolts, 8, and remove the thermostat cover, 5, gasket, 4, thermostat, 3, and gasket, 1.

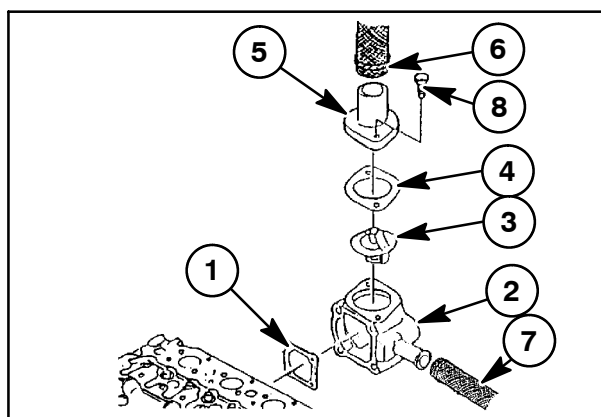

219

Inspection and Repair

1. Place the thermostat, 3, in a container filled with a 50/50 mixture of antifreeze and water. Insulate the thermostat from the bottom of the container.
2. Place a high temperature thermometer, 1, in the coolant mixture and heat the container.
3. Use a 0.08 mm (0.003") feeler gauge, 2, to determine when the thermostat begins to open.
4. Note the coolant temperature at which the thermostat starts to open and when it is fully opened.
5. Replace the thermostat if it fails to open at the specified temperature.

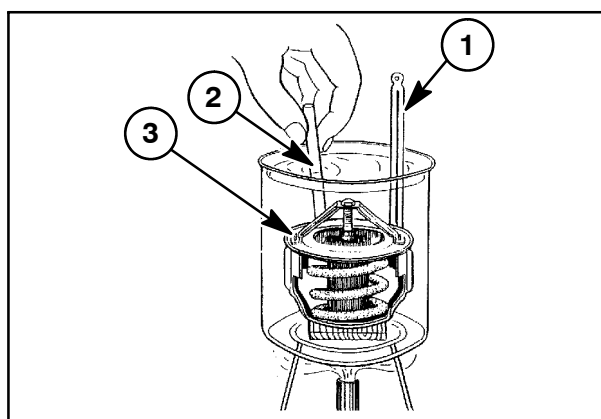

220

Thermostat opening temperature:

Start to open: 80-84°C (176-183°F) - All models

Fully open: 95°C (203°F)

6. Thoroughly clean the gasket mating surfaces before installing thermostat.

Installation

1. Attach gasket, 1, and thermostat housing, 2, to the engine block.
2. Place the thermostat, 3, in position in the thermostat housing, 2.
3. Install the gasket, 4, and thermostat cover, 5, and tighten the retaining bolts, 8.
4. Install the radiator hose, 6, and bypass hose, 7, on the thermostat housing, 2, and tighten the hose clamps.
5. Close the radiator drain and refill the radiator with 50/50 mixture of antifreeze and pure water.
6. Install the radiator cap and start the engine and run for a few minutes to check for any leakage.

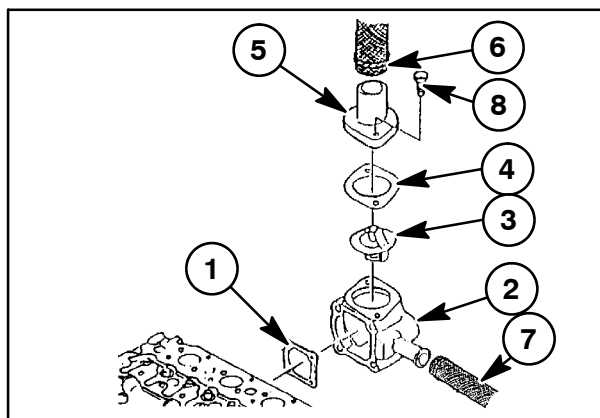

221

CAB HEATER**Installation**

NOTE: If a cab heater is to be installed, use the following steps to correctly locate the installation points for connection to the tractor's cooling system.

1. Loosen the radiator drain petcock, and drain the coolant into a suitable container.
2. Remove the plug, 1, from the thermostat housing, 2, and install the heater inlet (IN) fittings into the thermostat housing.

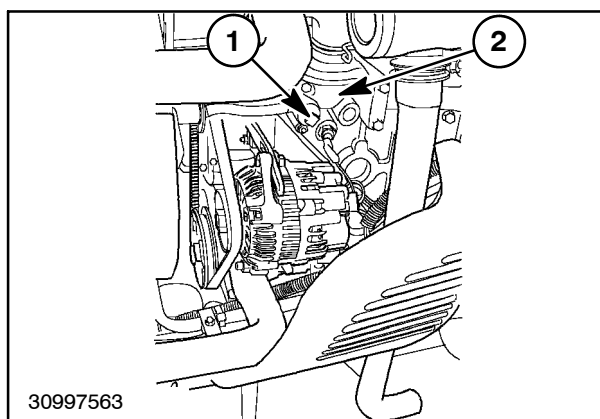

222

3. Remove the plug, 1, from the top of the water pump, 2, and install the heater return (OUT) fittings.
4. Follow the instructions provided with the heater kit, for further installation instructions.

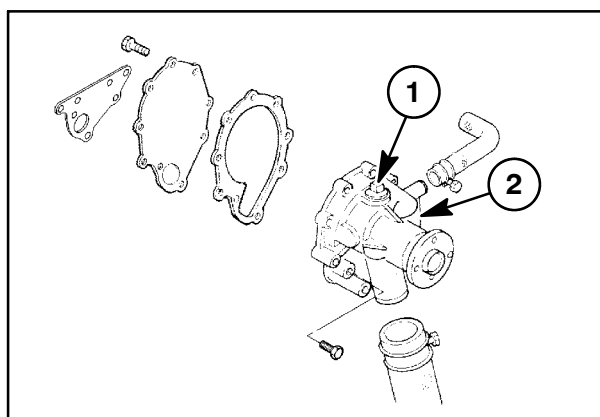

223