

FUEL LEVEL SENDING UNIT**Op. 55 410****Description**

The fuel level sending unit, 1, is mounted on top of the fuel tank and extends into the tank. The sending unit utilizes a float that raises and lowers with the fuel level inside the tank. The float regulates a variable resistance to ground, which translates into movement of the fuel gauge on the instrument panel. As the float lowers (fuel being consumed) inside the tank, the ground resistance increases, indicating less fuel on the fuel gauge.

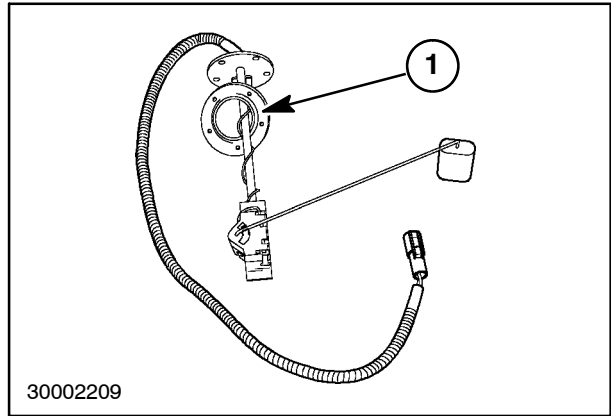

96

Removal

1. Raise the tractor engine cover.
2. Disconnect the negative (-) battery cable from the battery.
3. Disconnect the fuel level sending unit from the wiring harness.
4. Remove the two screws, 1, to remove the fuel level sending unit cover, 2.

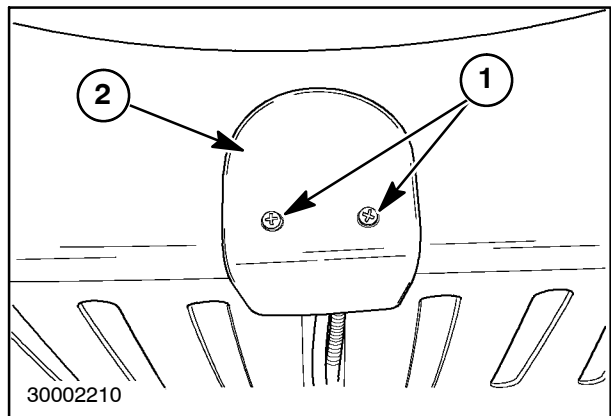

97

5. Remove the five (5) retaining screws, 1, that secure the sending unit, 2, to the fuel tank.

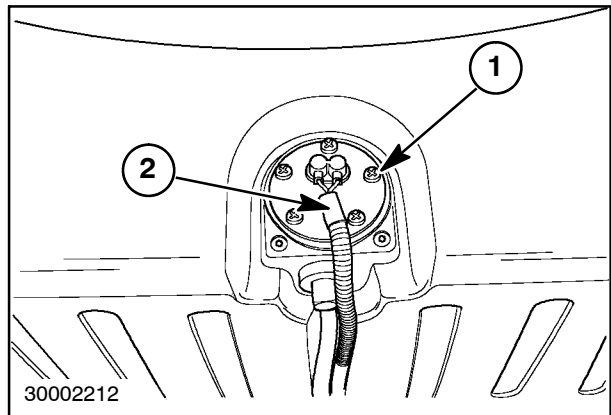

98

6. Carefully remove the sending unit, 1, from the fuel tank.
7. Remove and discard the sealing gasket, 2, from the sending unit, 1.

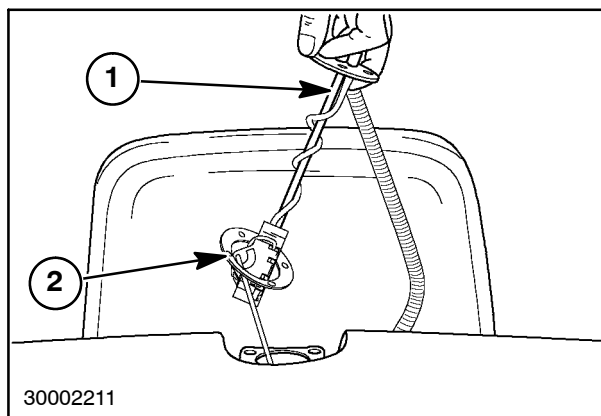

99

Fuel Level Sending Unit Testing

1. Using an ohmmeter, touch one test probe to terminal "A" of the sending unit, touch the other test probe to terminal "B" of the sending unit. Observe the reading on the ohmmeter.
2. With the sending unit float in the down position (tank empty), the ohmmeter should indicate between 245-249 ohms. If the ohmmeter reading is not within these specifications, the sending unit is defective and needs replaced.

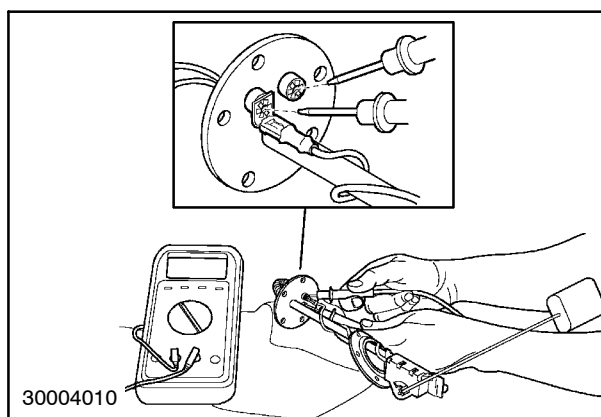

100

3. With the sender in the up position (tank full), the ohmmeter should indicate between 32-34 ohms. If the ohmmeter reading is not within these specifications, the sending unit is defective and needs replaced.

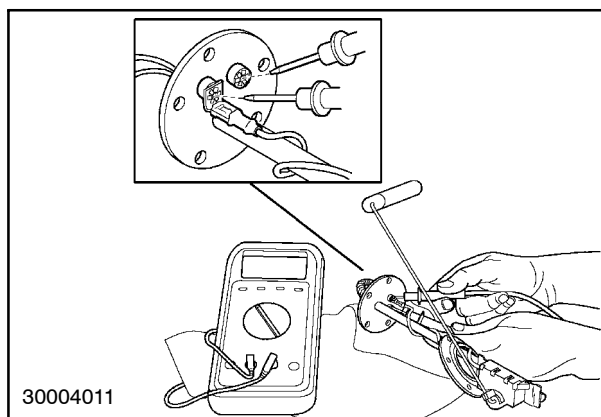

101

Installation

1. Install a new sealing gasket, 2, between the sending unit, 1, and the fuel tank.
2. Carefully place the sending unit, 1, into the fuel tank.

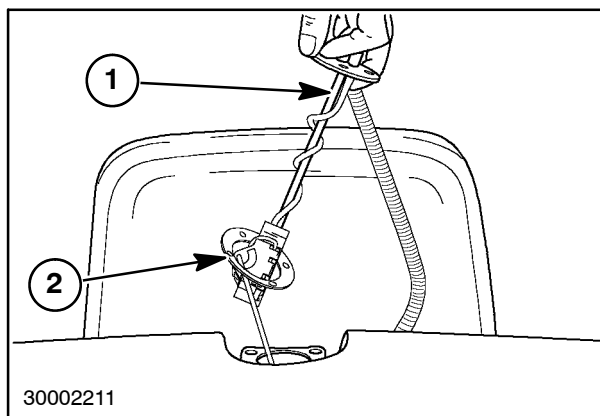

102

3. Secure the sending unit, 2, to the fuel tank using the five (5) retaining screws, 1.

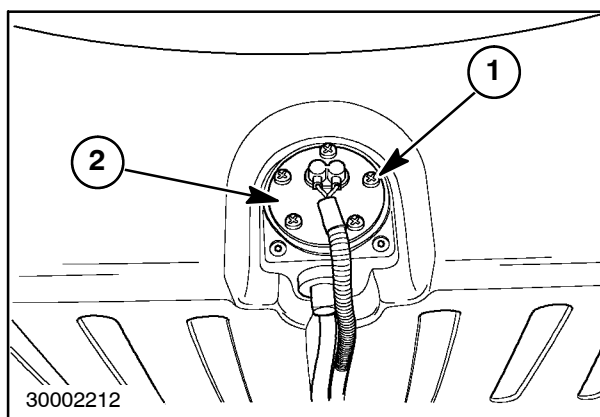

103

4. Install the fuel level sending unit cover, 2, using the two screws, 1.
5. Connect the fuel level sending unit to the wiring harness.
6. Connect the negative (-) battery cable to the battery.
7. Lower and secure the tractor engine cover.

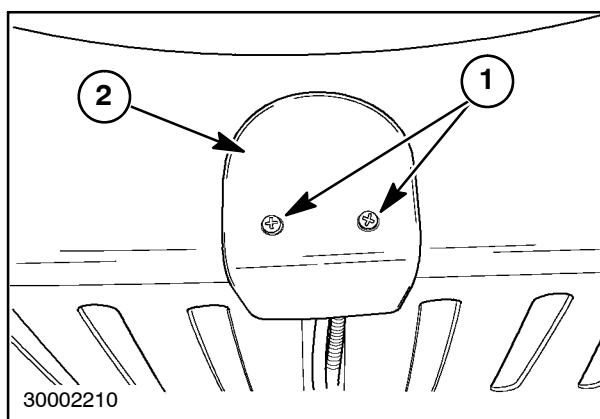

104