

### 3. INSTALLATION INSTRUCTION (1 → 2)

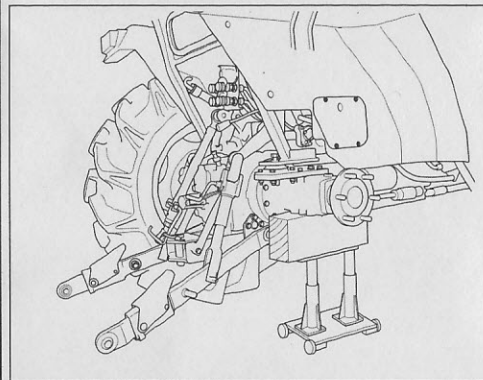

1. Remove the RH rear tire.

#### **⚠ WARNING**

- \* **Support the rear axle securely with the jack and support safety stand.**
- \* **Support the rest 3 wheels with chocks.**

**(When reassembling)**

- Wheel Bolts Tightening torque: 196 ~ 226 N·m (20 ~ 23 kgf·m, 145 ~ 165 lbf·ft)

2. Remove the service window from the RH fender

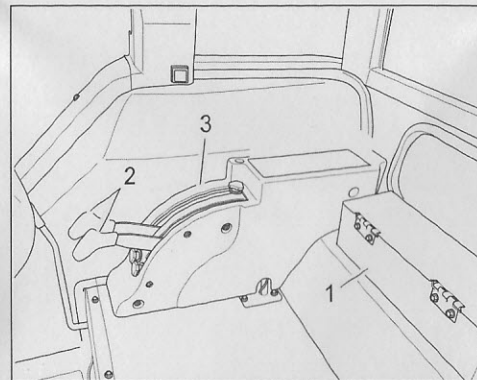

3. Remove the seat or fold it to forward.

4. Remove the tool box (1), hyd. lift control lever grips (2) and lever guide (3).

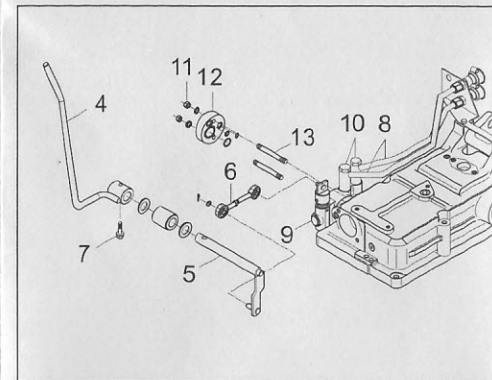

5. Remove existing control lever (4) from the shaft (5) by removing rod (6) and lock bolt (7).

6. Disconnect the pipes (8) from the valve (9) with removing eye bolts (10).

Do not remove the pipes (8) from the tractor.

7. Loosen the nuts (11) and remove the valve cover (12) from the studs (13).

8. Slide the valve (9) out from the studs (13).

9. Remove the studs (13).