

ASSEMBLY

Step 4: (Figure 10a & 10b)

- **If you do not own the front loader,** Place the mid support installation plates (item 1), the spacer (item 2) and the valve support (item 6) as shown on figure 10a and attach to each side of the tractor using M16 x 1.5 x 55mm lg hex. bolts (item 3), 16mm lockwashers (item 4) and Ø 11/16" int. flat washers (item 5). For now do not tighten the M16 x 1.5 x 55mm lg hex bolts (item 3).
- **If you own the front loader,** Place the mid support installation plates (item 1) as shown on figure 10b and attach to each side of the tractor using M16 x 1.5 x 55mm lg hex. bolts (item 2), 16mm lockwashers (item 3) and Ø 11/16" int. flat washers (item 4). For now do not tighten the M16 x 1.5 x 55mm lg hex bolts (item 2).

Figure 10a

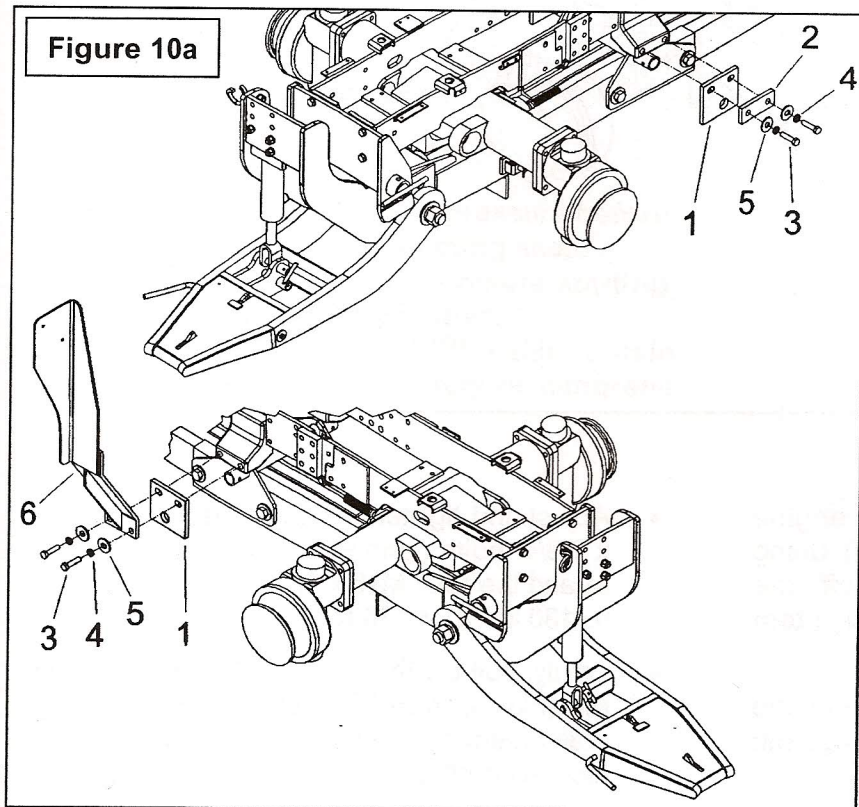

NOTE: Position the round hole of the installation plates (Fig. 10a and 10b, item 1) towards the rear of the tractor.

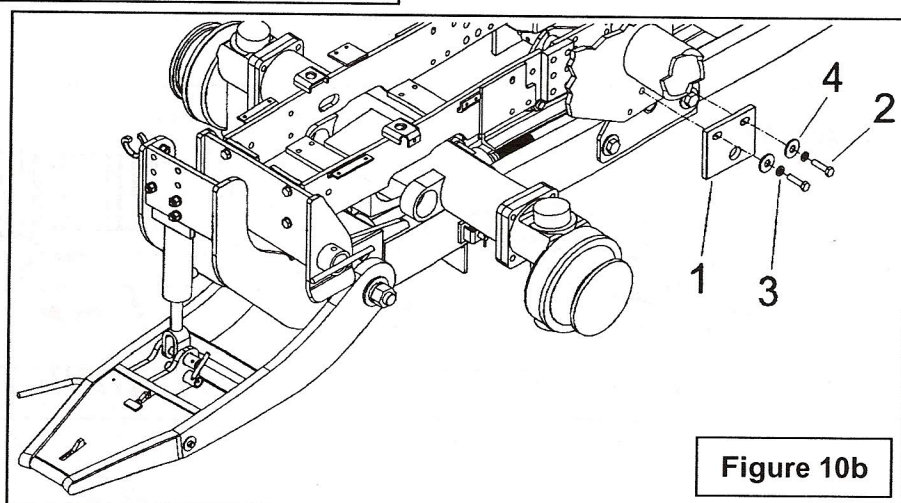

Figure 10b