

BLADE ARM ASSEMBLY

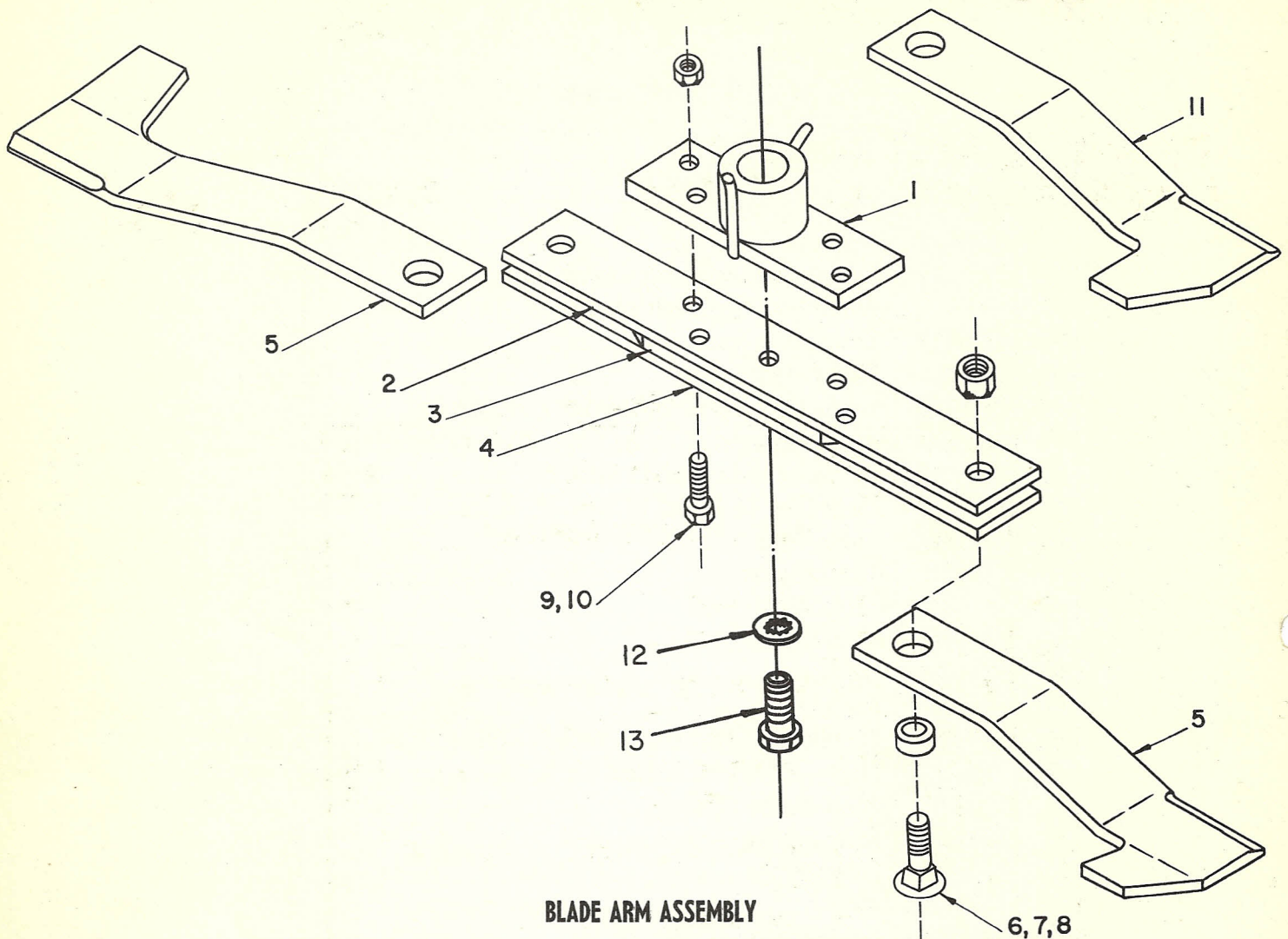

Ref. No.	Part Number	PART NAME	No. Req'd.
1	08-08-003	Adaptor Hub	1
2	17-03-011	Upper Blade Arm	1
3	17-03-012	Center Blade Arm	1
4	17-03-013	Lower Blade Arm	1
5	03-50-026	Blade, Suction	2
6	03-50-017	Pivot Bolt	2
7	03-50-002	Wear Bushing	2
8	0933-2800	Stover Lock Nut, NF HT Steel, $\frac{7}{8}$	2
9	0115-2024	Hex Hd Capscrew, NC 2A Thd, SAE 5, $\frac{5}{8}$ x $2\frac{1}{2}$	4
10	0911-2000	Stover Lock Nut, NC LC Steel, $\frac{5}{8}$	4
11	03-50-005	Blade, Flat	Opt
12	08-50-004	$\frac{3}{4}$ " L.H. Shakeproof Lockwasher	1
13	0145-2424	Hex Hd Capscrew, N.F. 2A Thd, L.H., SAE 5, $\frac{3}{4}$ x $2\frac{1}{2}$	1