

## (2) Separating Power Steering Cylinder

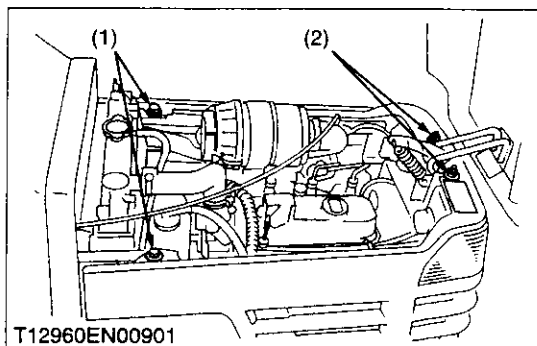

### Under Cover

1. Remove the under cover mounting bolts (1), loosen the mounting nuts (2) and pull forward to remove the under cover (3).

### (When reassembling)

Tightening torque	Under cover mounting bolt and nut	7.8 to 8.8 N·m 0.8 to 0.9 kgf·m 5.8 to 6.5 ft·lbs
-------------------	-----------------------------------	---

(1) Under Cover Mounting Bolt

(3) Under Cover

(2) Under Cover Mounting Nut

W1012337

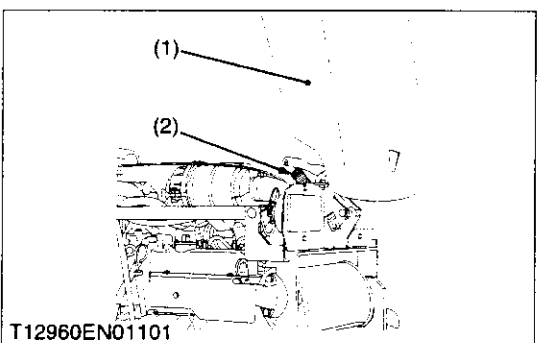
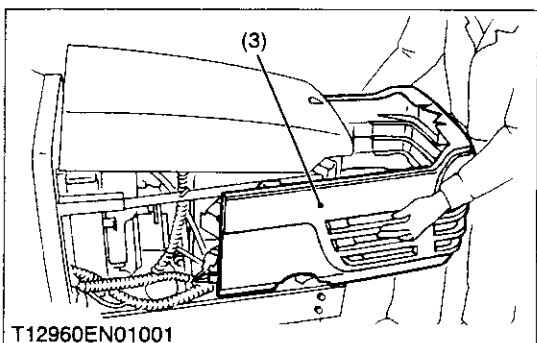

### Bonnet

1. Remove the spring (2).
2. Remove the bonnet mounting bolt and nut, and remove the bonnet (1).

(1) Bonnet

(2) Spring

W1012573

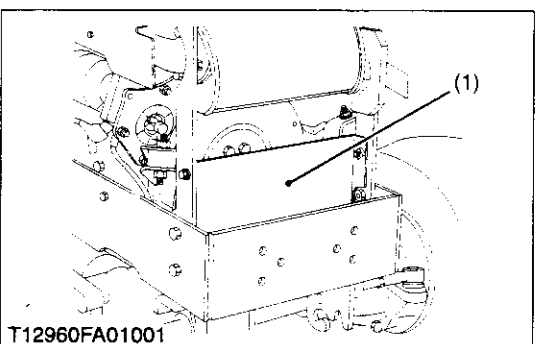

### Power Steering Cylinder

1. Remove the flywheel cover (1).
2. Disconnect the power steering cylinder hoses (3), (4).
3. Remove the cotter pin and remove the slotted nut for tie-rod (2).
4. Remove the power steering cylinder mounting screws and remove the power steering cylinder with tie-rod.

### (When reassembling)

#### ■ NOTE

- Tighten the slotted nut to 17.7 N·m (1.8 kgf·m, 13 ft·lbs). If the slot and pin hole do not meet, tighten the nut until they do meet, and install cotter pin.
- Be sure to split the cotter pin like an anchor.

Tightening torque	Power steering cylinder hose	28.4 to 30.0 N·m 2.9 to 3.1 kgf·m 20.9 to 22.1 ft·lbs
	Tie-rod slotted nut	17.7 to 34.3 N·m 1.8 to 3.5 kgf·m 13.0 to 25.3 ft·lbs

(1) Flywheel Cover

(3) Cylinder Hose RH

(2) Tie-rod

(4) Cylinder Hose LH

W1012658

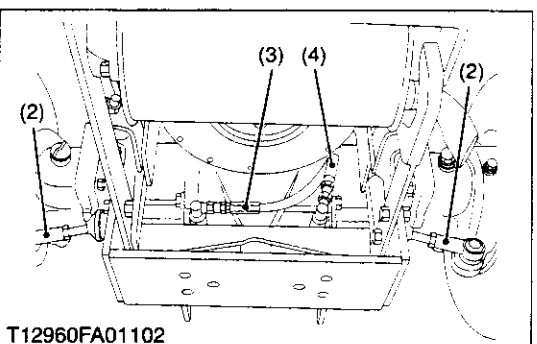

### (3) Disassembling Power Steering Cylinder

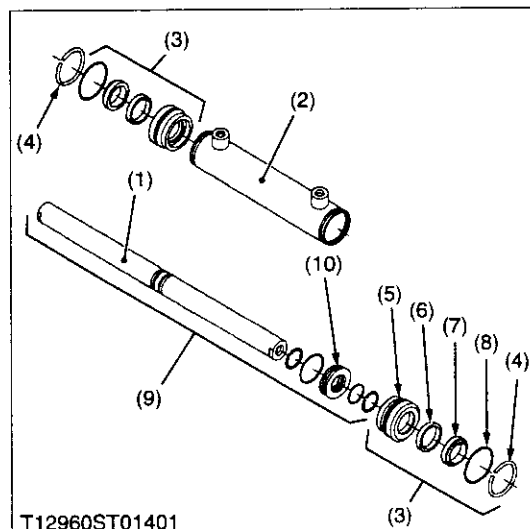
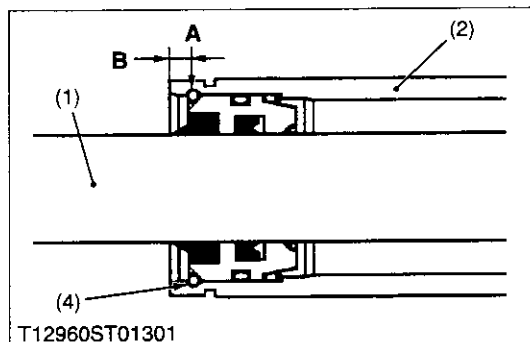
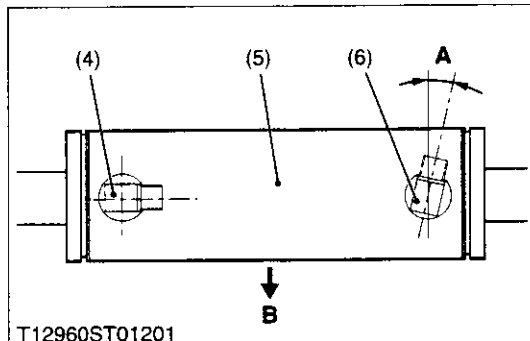
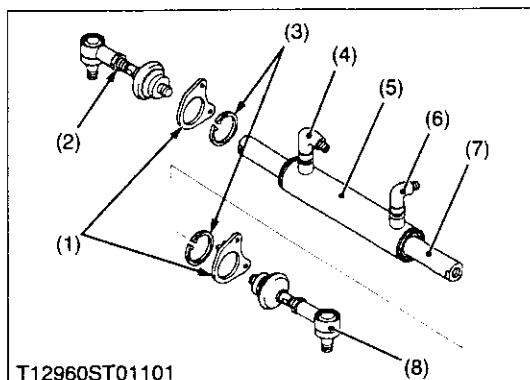

#### Adaptor and Tie-rod

1. Remove the cylinder hose adaptors (4), (6).
2. Remove the tie-rods (2), (8) from piston rod (7).
3. Remove the cylinder holder (1) and internal snap ring (3).

#### (When reassembling)

- Be sure to install the hose adaptors (4), (6) as shown figure left.
- After reassembling the tie-rod, be sure to adjust the toe-in. (Refer to 3-S4.)

Tightening torque	Tie-rod screw	74 to 84 N·m 7.5 to 8.6 kgf·m 54.6 to 61.9 ft·lbs
-------------------	---------------	---

- (1) Cylinder Holder  
(2) Tie-rod RH  
(3) Internal Snap Ring  
(4) Hose Adaptor RH  
(5) Cylinder  
(6) Hose Adaptor LH

- (7) Piston Rod  
(8) Tie-rod LH

A : 0.26 rad. (15 °)  
B : Front

W1012941

#### Steering Cylinder

1. Carefully clamp the cylinder in a vise.
2. Push one of the guide assembly (3) to inside of cylinder (2).
3. Drill a hole (2.5 mm dia., 0.1 in. dia.) on the cylinder tube (2) just over the snap ring (4) as shown figure left.
4. Take a little screwdriver and lift off the snap ring (4) from its groove. Simultaneous support this action by pushing from the outside of the cylinder tube with another little screwdriver or another tool.
5. Push out the piston rod assembly (9) and take off the guide assembly (3).

#### (When reassembling)

##### ■ NOTE

- **Seals must be exchanged after disassembling.**
- Apply transmission fluid to the exchanged seals.
- Enter the piston rod and block the guide assemblies with the snap rings.

- (1) Piston Rod  
(2) Cylinder Tube  
(3) Guide Assembly  
(4) Snap Ring  
(5) Guide  
(6) Seal Ring  
(7) Wiper Ring

- (8) O-ring  
(9) Piston Rod Assembly  
(10) Center Piston

A : Drill a Hole  
B : 5.25 mm (0.267 in.)

W1013441