

16. **Alternator**—provides current flow to the battery; left side of engine.
17. **Engine Oil Pressure Sending Unit**—located in front of the cylinder head; provides warning of low engine oil pressure.
18. **Engine Coolant Temperature Sending Unit**—located in the thermostat housing on the front left side of the engine; warns when engine operating temperature reaches a high level.
19. **Fuel Level Sending Unit**—located inside the fuel tank; sends a signal indicating fuel level to the instrument panel.
20. **Fuel Shutoff Solenoid**—located on the right side of the engine; shuts off fuel flow to the injection pump to stop the engine.
21. **Glow Plugs (3)**—located on the right side of the cylinder head, adjacent to the fuel injectors; aid in engine startup by warming the air in the combustion chamber.
22. **Parking Brake Switch** (30 Series and TC Deluxe)—located under the right platform; actuates with the parking brake mechanism; warns the operator that the parking brake is engaged.
23. **Brake Release Switch** (H.S.T.)—standard on the 30 Series and TC Deluxe; optional on the 25 Series; located under the right platform near the brake pedal pivot shaft; releases the H.S.T. speed control when the brakes are applied.
24. **H.S.T. Speed Control Switch**—located on the left side of the dash; controls current to the speed control magnet.
25. **H.S.T. Control Magnet**—located on the left side of the steering column; locks the H.S.T. linkage in place to set constant transmission speed.
26. **Optional Rear Work Light (50 Watt Halogen)**—located on the right side of the roll bar; power leads for the light are provided by the right fender wiring harness.

WIRING HARNESSES

- A. Hood
- B. Main
- C. Rear
- D. Right Fender/Left Fender
- E. Speed Control

GROUND S

- F. Left side behind rear tire on HPL housing
- G. Right side front frame
- H. Left side of engine
- J. Block

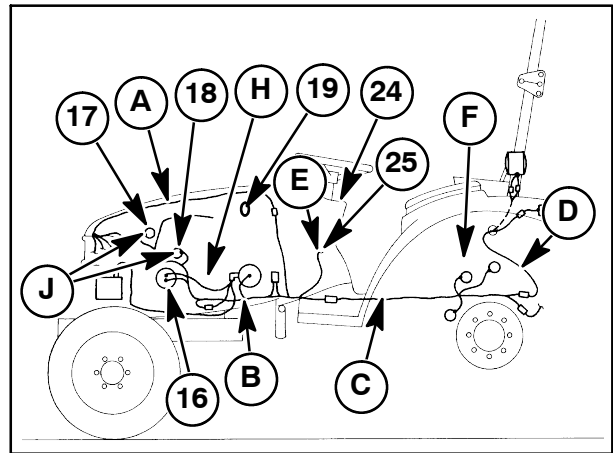

Figure 3-3

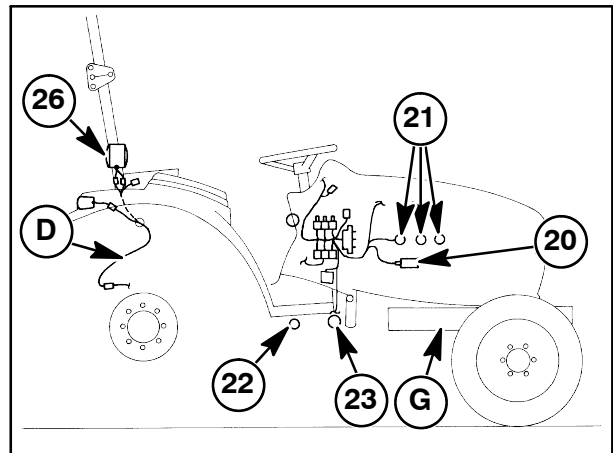

Figure 3-4