

## Mount Backhoe to Tractor

### DANGER

■ This mounting kit is designed to provide secure mounting and adequate operator clearance for most operators when properly installed. Check clearance dimensions shown below to be sure you have installed seat bracket correctly. In some cases it may be necessary to adjust the seat to the lowest position and/or as far forward as possible in order to achieve the ideal 40-inch clearance. For 36.5-inch radius operation, taller operators may need to wear a hardhat for greater comfort and safety.

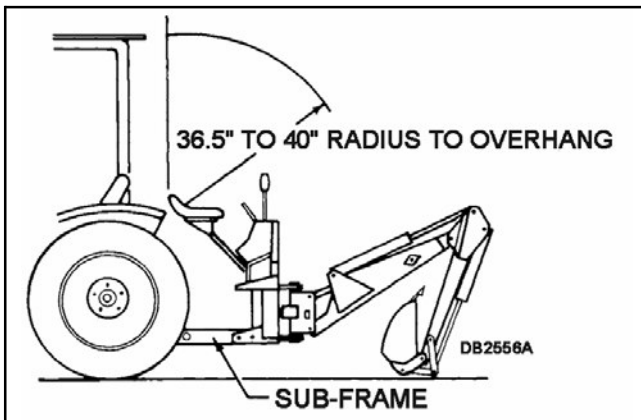

1. Remove the backhoe seat assembly.
2. Back tractor up to backhoe and center mount between the tractor rear tires. Position tractor so that the hydraulic system can be connected. Shut off tractor, set brake, remove key.
3. Attach backhoe hydraulic system. See page 17
4. With the tractor transmission in neutral, start the engine and run at low idle. Hydraulic power is provided when the tractor is started.

**NOTE:** Very little engine power is required to operate the hydraulic system in this mode. Should the engine pull down excessively, check the plumbing hook-up for reversed lines or a control lever stuck in an operating position.

**NOTE:** You will use the backhoe hydraulics to maneuver the backhoe brackets into position. Use care in this procedure to avoid being trapped between tractor and backhoe or between backhoe parts.

*(Continued on next page)*

## Mount Backhoe to Tractor (Continued)

### Refer to Figure 33.

5. Using the backhoe hydraulics, position the backhoe brackets at a slight angle, approximately 5- to 10-degrees.
6. Raise backhoe up by lowering stabilizers and boom section until backhoe mounting pins on backhoe brackets are slightly lower than tractor bracket hooks.
7. Slowly move tractor back until backhoe brackets are positioned below the tractor bracket hooks. Set tractor brake.
8. Raise backhoe bracket bottom mounting pins into tractor bracket bottom hooks.
9. Rotate backhoe bracket upper mounting slots over tractor bracket mounting holes and align holes.
10. Install cap screws (13 or 27) and slotted hex nuts (14). Tighten with 1-1/2-inch open end wrench provided with kit. Return wrench to storage position (see Figure 33).
11. Secure cap screws into position with klik pin (15).
12. Raise stabilizers until entire weight of backhoe hangs on the tractor brackets.
13. Shut off tractor and remove key.
14. Tighten all hardware with backhoe secured to the tractor. This will ensure proper alignment and fit-up for future installation. See torque specifications.
 

1/2 NC x 1-3/4 . . . . .	85 lbs-ft (115 N-m)
3/4 NC x 2 . . . . .	297 lbs-ft (403 N-m)
15. Reinstall seat.
16. Start tractor and put backhoe into transport position (see Backhoe Operator's Manual).

**NOTE:** Install swing lock before transporting.

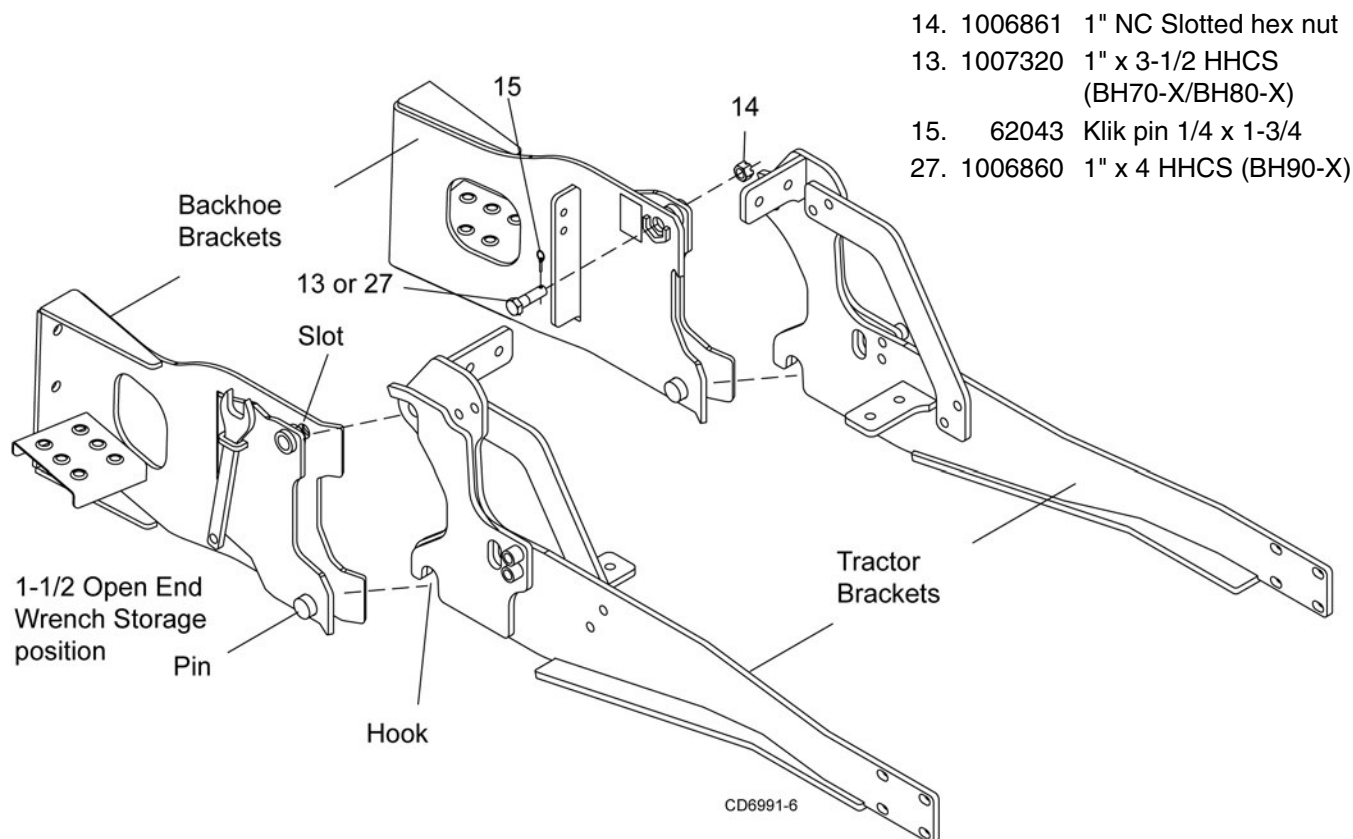

**Figure 33.** Backhoe to Tractor Installation - BH70-X/BH80-X Backhoe Brackets Shown

## Remove Backhoe from Tractor

### DANGER

■ The only time the backhoe may be operated from a position other than the operator seat is during backhoe attachment and removal. Operator must:

- Read Mounting Kit Manual instructions on attaching and removing backhoe and use extreme care.
- Always stand between rear tire and backhoe stabilizer arms or along side of tractor to avoid being trapped should the boom swing control be accidentally activated.

### WARNING

■ Remove seat and upper support assembly before installing or removing backhoe from power unit. Failure to comply may result in equipment failure and/or personal injury.

1. Position tractor on a hard, level surface and center the backhoe boom.
2. Lower stabilizers and take backhoe weight off tractor.
3. Lower boom and dipper to form a 90-degree angle and rest bucket on the ground.
4. Remove the seat assembly.
5. Remove klik pins from bolt and nut assemblies.
6. Use 1-1/2" open end wrench supplied with the mounting kit to remove hex nuts. Return wrench to storage position (see Figure 33).
7. Use the boom to relieve excess pressure on 1" bolts and remove bolts.
8. Tilt backhoe main frame to separate slots on the backhoe brackets from the tractor brackets.
9. Raise stabilizers until backhoe brackets slide out of hooks on the bottom of the tractor brackets.
10. Move tractor forward to clear backhoe brackets.

11. Lower backhoe until backhoe main frame is firmly on the ground. Retract boom and dipper and place bucket cutting edge flat on the ground. See Figure 34. Connect transport lock and insert swing lock pin.

**NOTE:** It may be necessary to place backhoe main frame on 6" blocks if backhoe hose lengths are not long enough to achieve proper clearance when separating backhoe from tractor.

12. Turn off engine, set brakes, and remove key.
13. Disconnect hydraulic hoses. See page 21 for storage.
13. Reinstall seat assembly.

**NOTE:** For instructions on extended storage, see Backhoe Operator's Manual.

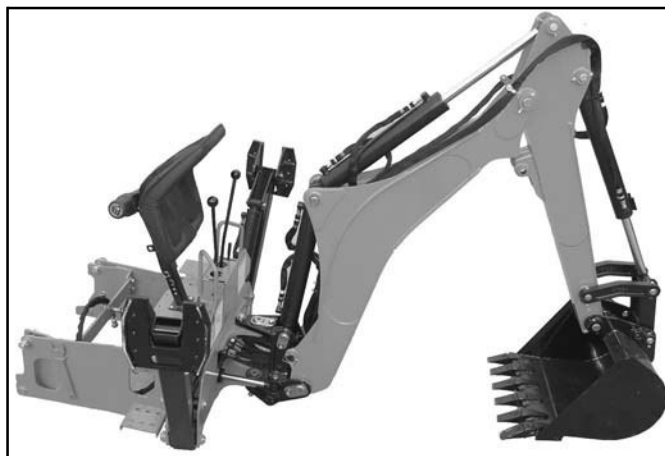

Figure 34. Backhoe Storage Position BH70-X Shown