



**YANMAR TRACTOR (U.S.A.), INC.**

# **YLS SERIES LOG SPLITTERS**

**OWNER'S MANUAL**



**YANMAR TRACTOR (U.S.A.), INC.**



**ATTENTION!**

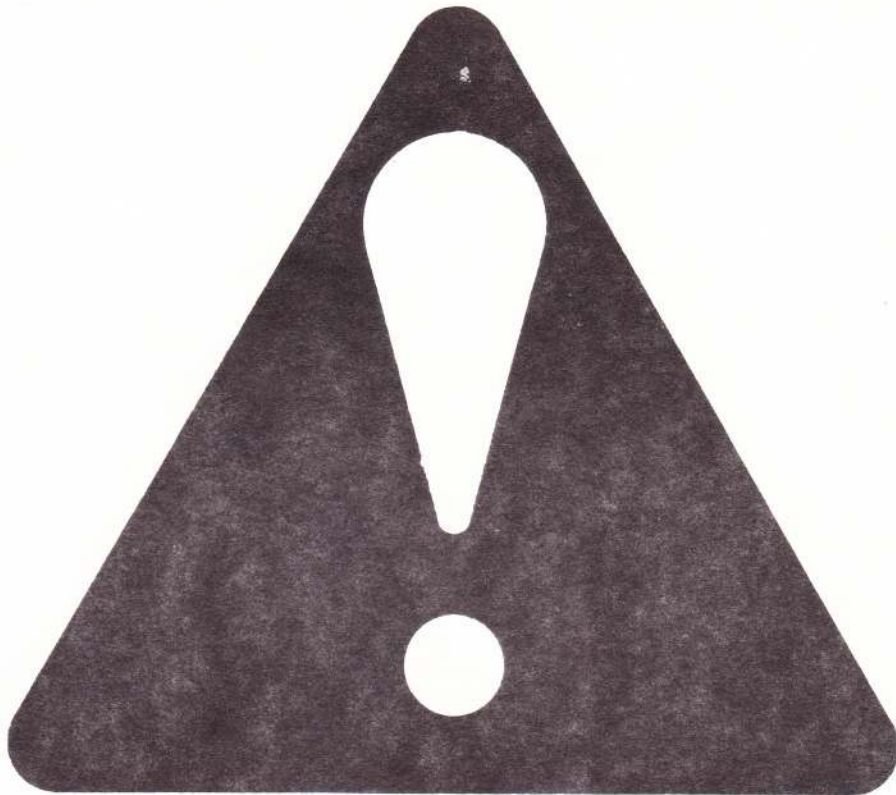

**THIS SYMBOL MEANS:**

**BECOME ALERT!**

**YOUR SAFETY IS INVOLVED!**

# INDEX

Introduction.....	Page 3
Safety Precautions.....	Pages 4-5
Packing Lists	
YLS-26.....	Page 6
YLS-21.....	Page 7
Assembly Instructions.....	Pages 8-18
Use of Remote Hydraulic Couplers.....	Page 19
Operation Instructions.....	Page 19
Maintenance.....	Page 20
Parts Lists	
YLS-26 Parts List.....	Page 21
YLS-21 Parts List.....	Page 23

# INTRODUCTION

Welcome to our Family of modern Yanmar equipment. We sincerely believe that you have purchased the finest log splitter available. We have incorporated many features that you, the customer, have requested. We ask that you maintain and operate this machine wisely. We are confident that with correct adjustments and reasonable care, your log splitter will serve you well.

This manual is made available for you as a handy reference and contains instructions for installing and operating, along with a complete parts list.

READ THIS BOOK CAREFULLY TO BECOME COMPLETELY FAMILIAR WITH YOUR MACHINE

This manual contains important information on your new YLS log splitter.

Your local dealer and his staff are prepared to assist you so that you will obtain the ultimate in service and satisfaction from your log splitter.

It is the policy of the Company to make continuous improvements in their products, and the Company reserves the right to make any changes without incurring obligation to add them to any log splitter already sold.

---

---

**Purchase date** \_\_\_\_\_  
**Dealer's name** \_\_\_\_\_  
**Dealer's address** \_\_\_\_\_  
**Dealer's city** \_\_\_\_\_ **state** \_\_\_\_\_ **zip** \_\_\_\_\_  
**Dealer's salesman** \_\_\_\_\_  
**Dealer's telephone** \_\_\_\_\_

Please make note of the Yanmar Tractor product model and serial numbers for your reference when obtaining parts or service.

Model # **YLS Series** \_\_\_\_\_ Serial # \_\_\_\_\_



# WORK SAFELY - FOLLOW THESE RULES



**This symbol is used to call your attention to instructions concerning your personal safety. Be sure to observe and follow these instructions.**

**KNOW YOUR CONTROLS!** Read this manual and the manual supplied with the tractor thoroughly to acquaint yourself with the controls.

A Careful Operator is the Best Insurance Against an Accident.

Equipment, if not used properly, can be dangerous. The operator, therefore, should develop safe working habits and also be aware of hazardous conditions. In this way, he will protect himself, other personnel, and the equipment. Safe operation is the responsibility of the operator.

Check oil engine levels, and perform any other necessary services before starting the engine.

To prevent upsets, be careful when operating on a hillside.

Clean the engine thoroughly and drain the fuel before storing to reduce the fire hazard.

Be courteous. Have consideration for other traffic using the road.

Do not allow anyone to move the hydraulic control levers, or other controls, while the unit is being greased or worked on.

Before starting engine, make sure helpers or observers stand clear of equipment.

When fueling an engine, keep any type of open flame away. **DO NOT SMOKE!** Wait for the engine to cool before refueling it.

Know all the controls and what they do.

Use warning devices (i.e. flags, S.M.V. emblem, lights, etc.) which are approved for use by your local government agencies when moving equipment on public roads. Keep these devices clean and in good working condition.

Check and straighten twisted hoses. Do not attempt to repair or tighten hoses when under pressure or with the engine running. Relieve hydraulic pressure before disconnecting oil lines.

Hydraulic fluid escaping under pressure can have enough force to penetrate the skin. Hydraulic fluid may also infect a minor cut or opening in the skin. If injured by escaping fluid. **SEE A DOCTOR AT ONCE.** Serious infection or reaction can result if medical treatment is not given immediately. Make sure all connections are tight and that hoses and lines are in good condition before applying pressure to the system. Relieve all pressure before disconnecting the lines or performing other work on the hydraulic system. To find a leak under pressure, use a small piece of cardboard or wood. Never use hands.

Do not disconnect hydraulic lines with engine running.

To prevent injury during assembly, installation, operation, adjustment or removal of the log splitter, it is recommended that gloves, safety glasses, and safety toe shoes be worn.

Keep your work area clear of obstacles at all times.

Choose a level area for your work site.

Keep children away from log splitter at all times.

Do not wear loose clothing while operating or working near the log splitter.

Keep hair and clothing away from all moving parts of the log splitter.

## WORK SAFELY - FOLLOW THESE RULES

When placing logs in the log splitter, grasp them in such a manner so as to avoid placing hands between the push head and the splitting wedge.

During splitting, keep hands off the log.

Use extreme caution when splitting crooked, knotty wood.

Only the operator should be near the log splitter during splitting. If a helper is used, he should stand clear of the machine.

Do not attempt any repairs, maintenance, or adjustments of your log splitter while it is in operation. Always turn off power supply to make any repairs or maintenance.

Keep all bolts and nuts tight.

The log splitter can cause personal injury if operated improperly. Never permit an untrained person to operate your log splitter.

Improper use of the tractor and attachments can result in injury. To reduce this possibility, give complete and undivided attention to the job at hand and follow all safety precautions.

Please refer to tractor operation manual for safe operating procedure.

## YLS 26 PACKING LIST

Key No.	Part No.	Description	No. Pieces
A-1	43506	3/16 x 7/8 Clevis Pins	2
A-2	43509	#10 SAE Clevis Pin Washers	2
A-3	43537	5/16 x 1 1/4 Bolt	1
A-4	43538	5/16" Nut	1
A-5	43539	5/16 Split Lockwasher	1
A-6	43540	5/16 U-Washer	1
A-7	43527	3/8 x 1 Bolt	4
A-8	43528	3/8 Nuts	10
A-9	43529	3/8 Internal Lockwasher	10
A-10	43531	3/8 x 3/4 Bolts	6
A-11	43533	Hitch Pins	2
A-12	43534	1/4 x 1 1/4 Clevis Pins	2
A-13	43535	1/16 x 1 Cotter Pin	2
A-14	43545	3/32 x 1 1/4 Cotter Pin	1
A-15	43542	15/16 x 7 1/8 Pivot Pin	1
A-16	43543	3/8 x 2 1/2 Bolt	1
A-17	43544	3/8 Lock Nut	1
A-18	43550	1/2 Pipe to 1/2 Tube Elbow	2
*B-1	43502-26	Main Frame Assembly	1
B-2	43503-26	Cylinder & Valve Assembly	1
B-3	43505	Valve Handle	1
B-4	43536	Kick-off paddle	1
B-5	43526	Side Plates	2
B-6	43530	A-Frame	1
B-7	43532	Cross Shaft Assembly	1
B-8	43541	Swing Wedge	1
B-9	43501	Hydraulic Hoses	2
B-10	43548	Double female coupler for use on tractor with Yanmar loader	1
B-11	43549	1/4" 18 NPTF Allen Pipe Plug	1

\*Separate B-2 cylinder and valve assembly from B-1 main frame assembly and begin assembly.

PACKED BY \_\_\_\_\_



## YLS 21 PACKING LIST

Key No.	Part No.	Description	No. Pieces
A-1	43506	3/16 x 7/8 Clevis Pins	2
A-2	43509	#10 SAE Clevis Pin Washers	2
A-3	43537	5/16 x 1 1/4 Bolt	1
A-4	43538	5/16" Nut	1
A-5	43539	5/16 Split Lockwasher	1
A-6	43540	5/16 U-Washer	1
A-7	43527	3/8 x 1 Bolt	4
A-8	43528	3/8 Nuts	10
A-9	43529	3/8 Internal Lockwasher	10
A-10	43531	3/8 x 3/4 Bolts	6
A-11	43533	Hitch Pins	2
A-12	43534	1/4 x 1 1/4 Clevis Pins	2
A-13	43535	1/16 x 1 Cotter Pin	2
A-14	43545	3/32 x 1 1/4 Cotter Pin	1
A-15	43542	15/16 x 7 1/8 Pivot Pin	1
A-16	43543	3/8 x 2 1/2 Bolt	1
A-17	43544	3/8 Lock Nut	1
A-18	43550	1/2 Pipe to 1/2 Tube Elbow	2
*B-1	43502	Main Frame Assembly	1
B-2	43503	Cylinder & Valve Assembly	1
B-3	43505	Valve Handle	1
B-4	43536	Kick-off paddle	1
B-5	43526	Side Plates	2
B-6	43530	A-Frame	1
B-7	43532	Cross Shaft Assembly	1
B-8	43541	Swing Wedge	1
B-9	43501	Hydraulic Hoses	2
B-10	43548	Double female coupler for use on tractor with Yanmar loader	1
B-11	43549	1/4" 18 NPTF Allen Pipe Plug	1

\*Separate B-2 cylinder and valve assembly from B-1 main frame assembly and begin assembly.

PACKED BY \_\_\_\_\_



## ASSEMBLY INSTRUCTIONS

The Yanmar Log Splitter is shipped to you complete in one box. Open the box, when you are ready to begin the assembly. Choose your work area carefully. Since your log splitter is bulky, you do not want to assemble it in a place where you will have difficulty moving it later. Also, make sure you have sufficient room to work in, and choose a place where the parts will not be disturbed or lost.

Check packing list of parts carefully before starting assembly.



**CAUTION:** Some parts of this log splitter are large and should be handled by two people during assembly. Be careful of the sharp edge of the wedge and the sliding ram.

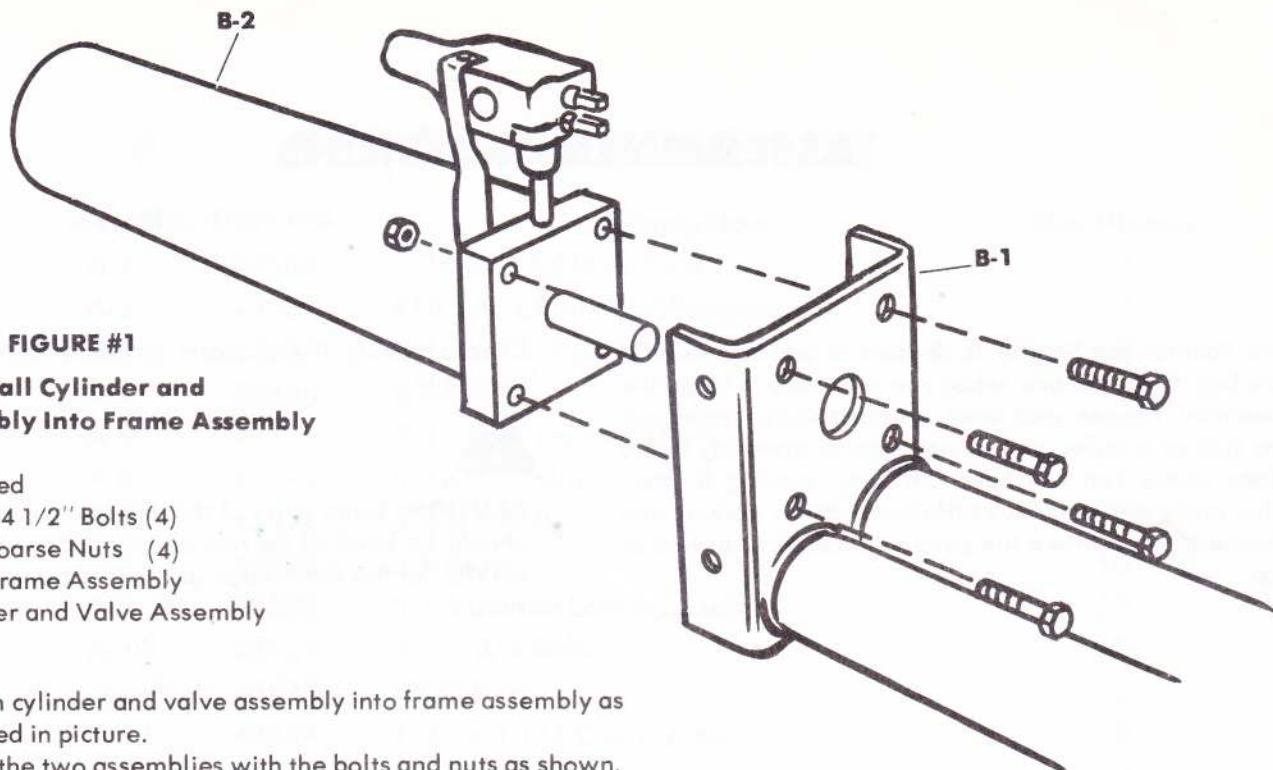

**FIGURE #1**

**Install Cylinder and Valve Assembly Into Frame Assembly**

**Parts Affected**

- B-1 1/2" x 4 1/2" Bolts (4)
- B-1 1/2" Coarse Nuts (4)
- B-1 Main Frame Assembly
- B-2 Cylinder and Valve Assembly

- 1- Position cylinder and valve assembly into frame assembly as projected in picture.
- 2- Secure the two assemblies with the bolts and nuts as shown.
- 3- Tighten the bolts reasonably tight with 6" or 8" wrench.
- 4- Then tighten bolts with 55 - 60 foot pounds of torque.

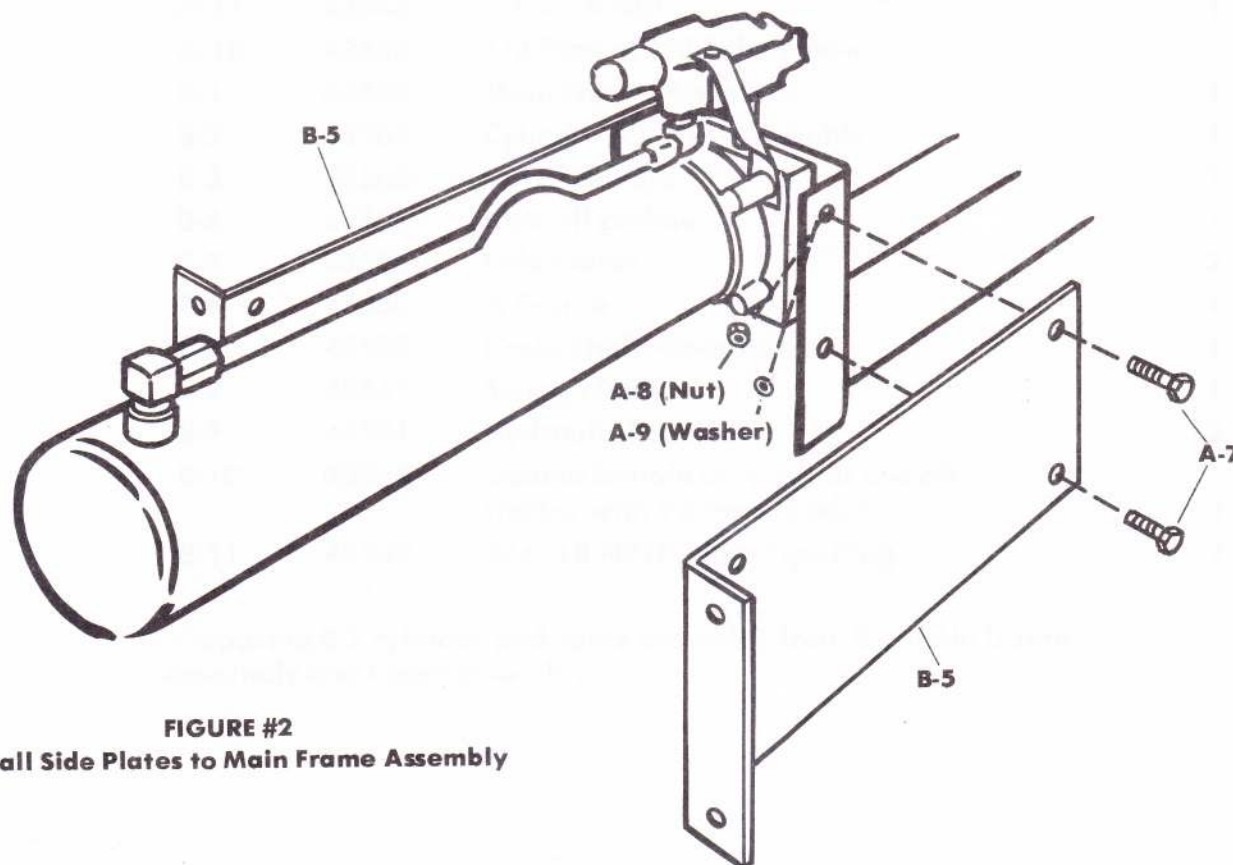

**FIGURE #2**

**Install Side Plates to Main Frame Assembly**

**Parts Affected**

- B-5 Side Plates (2)
- A-7 3/8" x 1" Bolts (4)
- A-8 3/8" Nuts (4)
- A-9 3/8" Lock Washers (4)

**Using Assembly From Figure #1**

- 1- Put side plates into position as shown in picture.
- 2- Match the two holes up in each side plate with holes in main frame assembly.
- 3- Enter bolts into all four holes, place lock washer and then nut on end of bolt. (DRAW FINGER TIGHT)

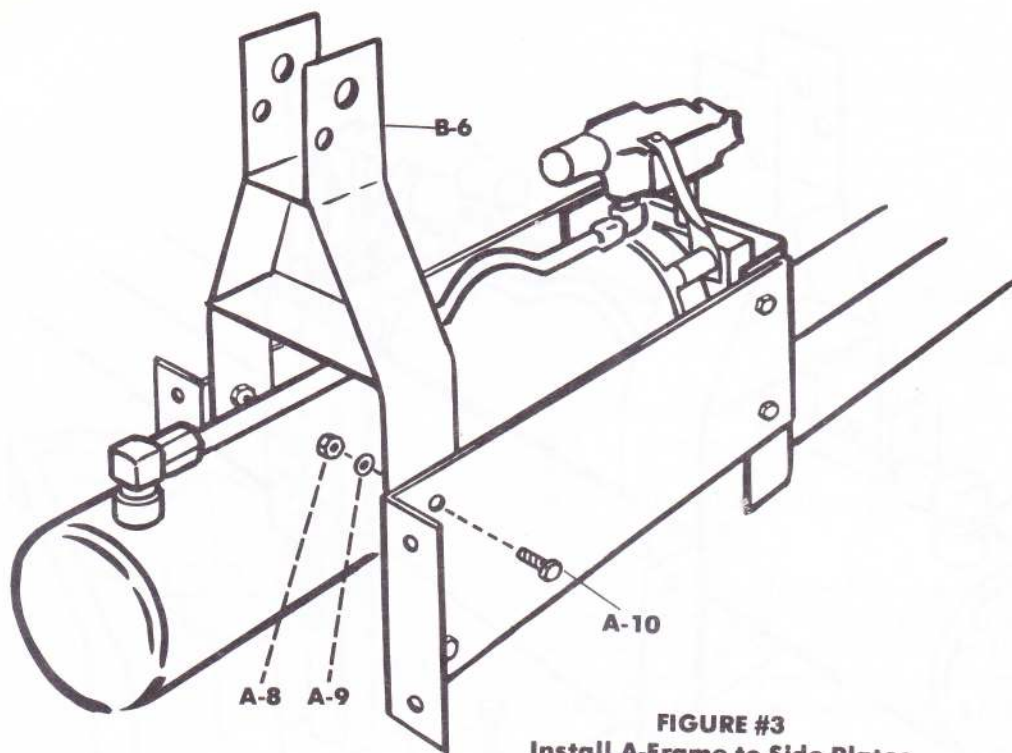

**FIGURE #3**  
**Install A-Frame to Side Plates**

**Parts Affected**

B-6 Top Link Tower or (A-Frame)

A-10 3/8" x 3/4" Bolt (4)

A-8 3/8" Nuts (4)

A-9 3/8" Lock Washer (4)

- 1- Position A-Frame at rear end of side plates.
- 2- Match holes in A-Frame to holes in each side plate.
- 3- Enter bolts into the assembly as shown in picture, place washer and then nuts on other end of bolt. (DRAW FINGER TIGHT)

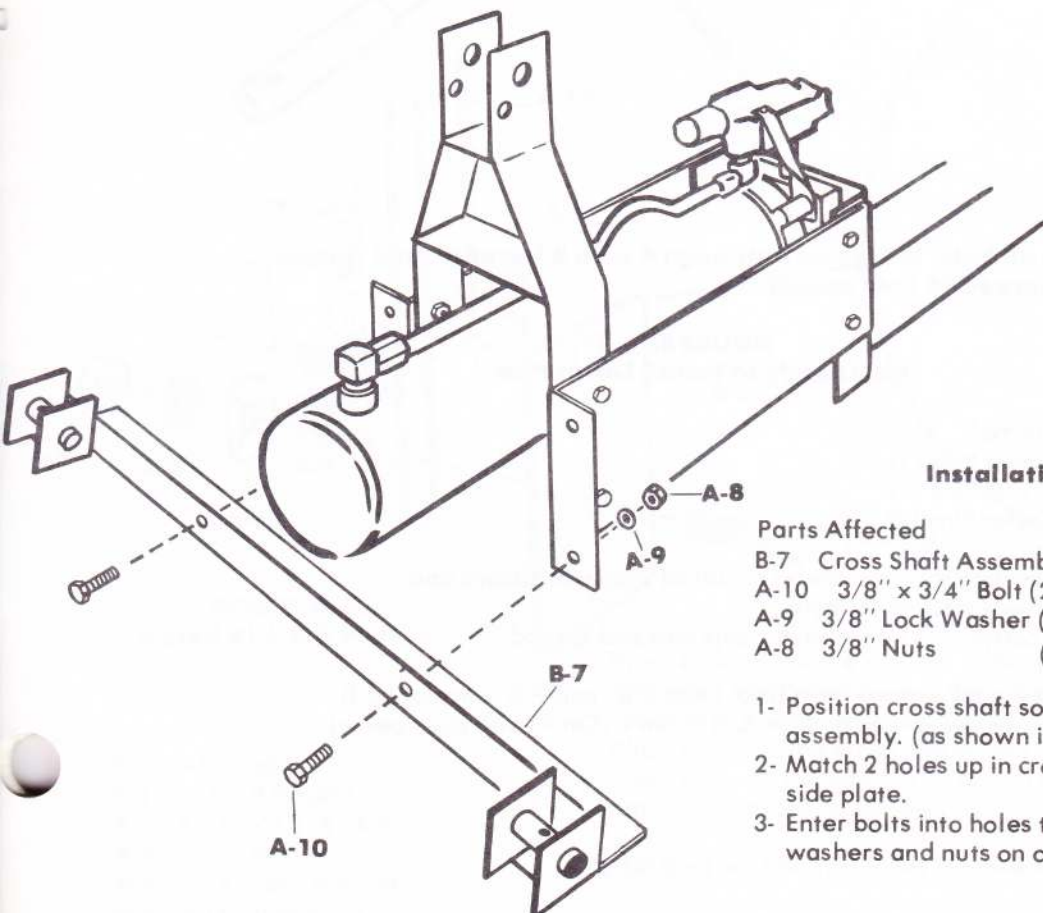

**FIGURE #4**  
**Installation of Cross-Shaft to Side Plates**

**Parts Affected**

B-7 Cross Shaft Assembly

A-10 3/8" x 3/4" Bolt (2)

A-9 3/8" Lock Washer (2)

A-8 3/8" Nuts (2)

- 1- Position cross shaft so the angle points toward main frame assembly. (as shown in picture)
- 2- Match 2 holes up in cross shaft with the lower hole in each side plate.
- 3- Enter bolts into holes through cross shaft first. Place washers and nuts on other end of bolts. (DRAW FINGER TIGHT)



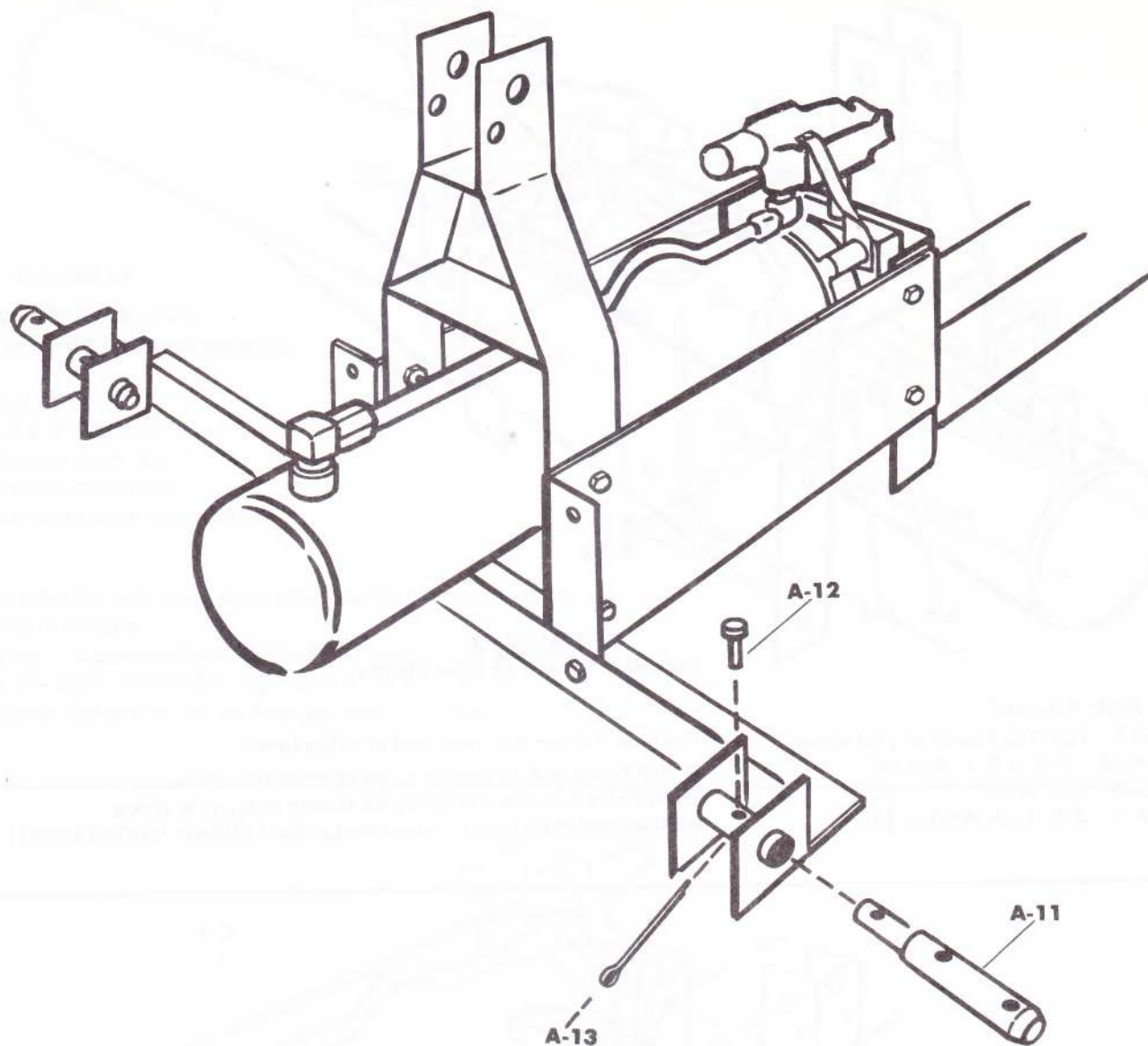

**Tighten all bolts in Figures 2 through 4 with 8" wrench, and torque not to exceed 25 foot pounds.**

**FIGURE #5  
Now Ready to Install Lower Pins**

**Parts Affected**

- A-11 Lower Pins (2)
- A-12 Clevis Pins (2)
- A-13 Cotter Pins (2)

- 1- Slip pins into receiver of cross shaft as shown in picture and drop clevis into center hole.
- 2- Enter cotter pins into hole of clevis pins and spread.

This is designed with multiple hitch sizes 5/8" and 7/8" pins for both wide and narrow spread hitches, Cat 0, Cat I, (Cat II, with pin sleeves)



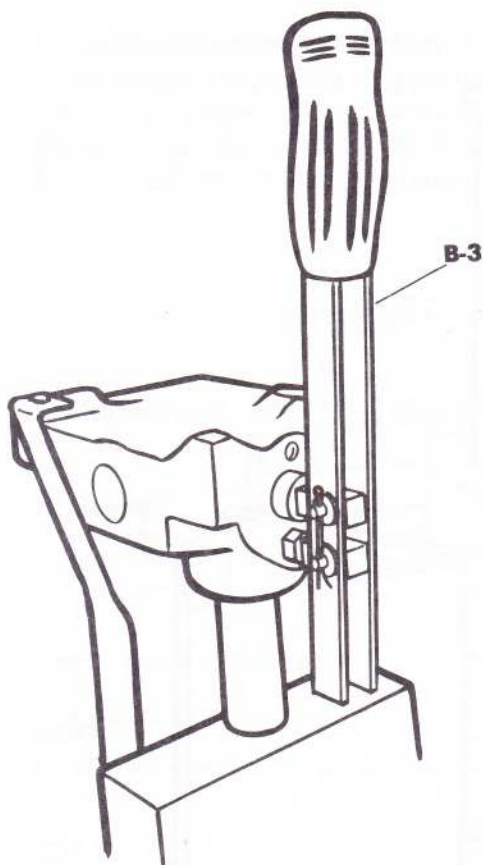

**FIGURE #6A**

**Assembly Handle to Valve**

**Parts Affected**

B-3	Handle	
A-1	Clevis Pins	(2)
A-2	Clevis Pin Washers	(2)
A-14	Cotter Pin	

- 1- Place handle on front of valve and match holes up in handle with the two ends from the valve. (**Fig. 6B**)
- 2- Enter clevis pins through the holes. (**Fig. 6B**)
- 3- Place washer on ends of clevis pins and put cotter pin through both clevis pins as shown in **Fig. 6A & 6B**.

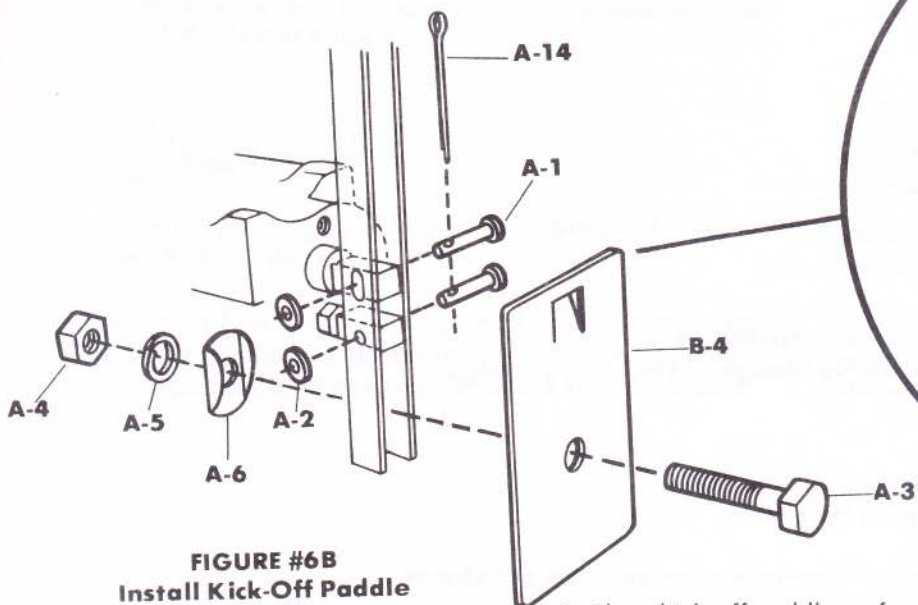

**FIG. 6C**

**Parts Affected**

B-4	Kick-off Paddle	
A-3	5/16" x 1 1/4" Bolt	
A-4	5/16" Nut	
A-5	5/16" Lock Washer	
A-6	5/16" U Washer	

- 1- Place kick-off paddle on front of handle so the tab rests on the upper end coming out of the valve. (**Fig. 6C**)
- 2- Put bolt through hole in paddle.
- 3- Place U washer on other end of bolt and surrounding the handle.
- 4- Place lock washer and nut on end of bolt. Tighten bolt only until lock washer collapses.

**NOTE: Bolt will be too tight if handle won't work freely.**

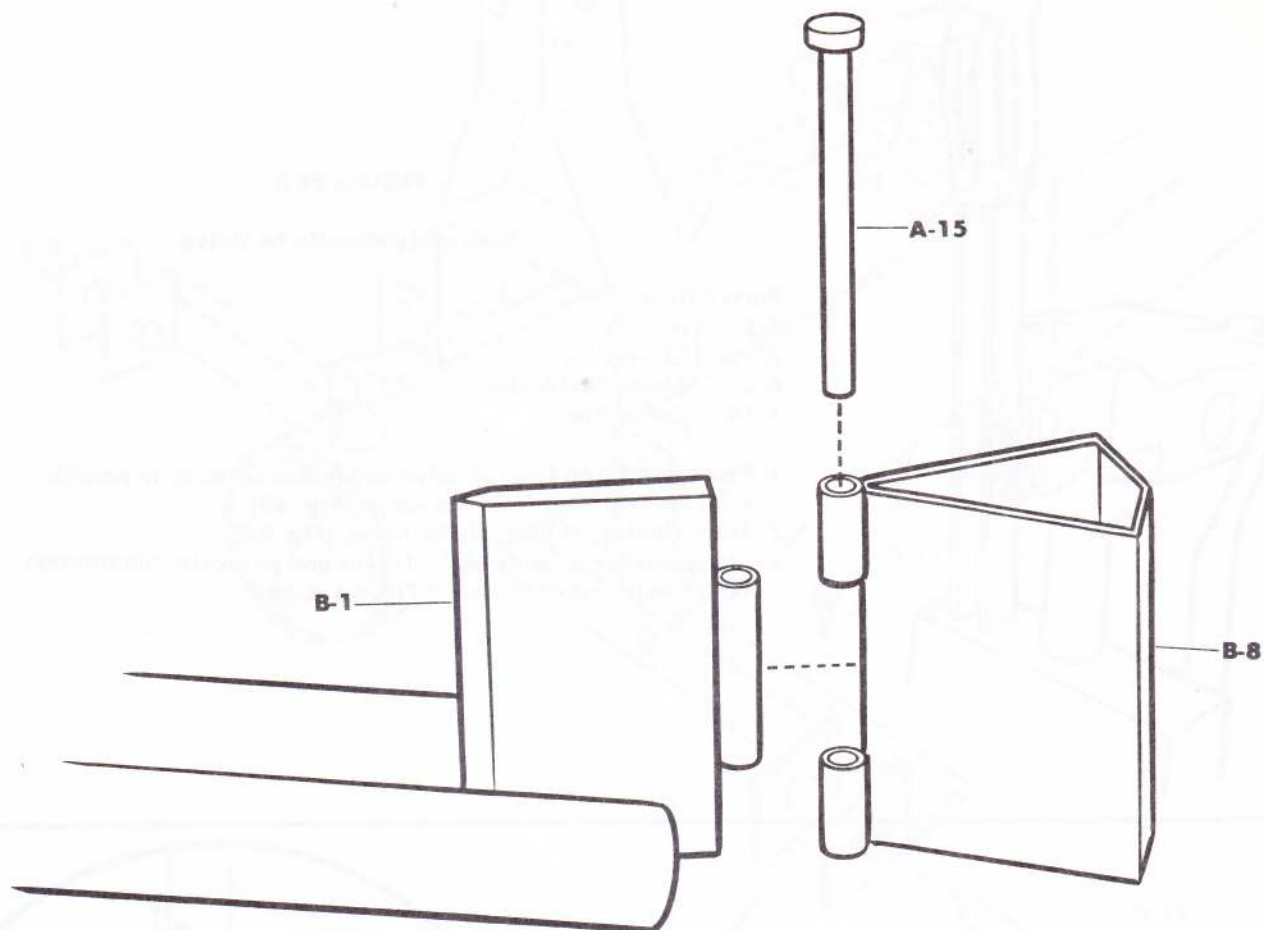

**FIGURE #7**  
**Assemble Swing Wedge to Stationary Wedge**

Parts Affected  
 A-15 Pivot Pin  
 B-8 Swing Wedge  
 B-1 Stationary Wedge on Main Frame

- 1- Line swing wedge up with stationary wedge on the main frame as shown in photo.
- 2- Drop pivot pin into the three slots, once they are lined up.
- 3- Swing wedge will now pivot on stationary wedge.

**Use of double acting cylinder on YLS Log Splitter:**

When using the implement (Log Splitter) which has a double acting cylinder, the control valve of the Log Splitter should be used, by connecting the hydraulic lines to divider block of high pressure hydraulic line.

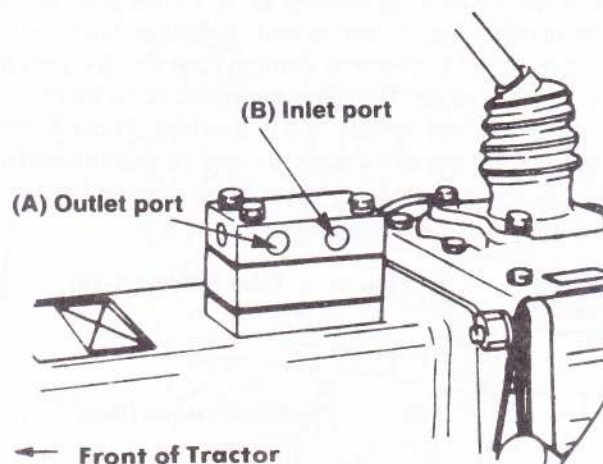
**NOTE:**

(1) Divider block YDB-1 w/(A,B) ports must be ordered from YTI.

**IMPORTANT**

When removing log splitter hydraulic the divider block must be replaced with the original hydraulic plate. Severe damage to hydraulic system may result if this is not done.

**IMPORTANT**

When connecting hydraulic lines to the divider block, see YANMAR dealer.

Volume of oil required to extend cylinder must not lower Transmission-Hydraulic oil level below end of dipstick. Check oil level with cylinder fully extended.

**To Connect Hydraulic Hoses From Log Splitter To Tractor.**

First screw into the "in" & "out" ports of the valve on the log splitter the 1/2" pipe to 1/2" tube elbows Part No. 43550 (A-18). Then connect the elbow end of one of the hydraulic hoses (supplied with log splitter) to "A" (outlet port, pump side) on divider block of tractor and straight end of hose to the 1/2" pipe to 1/2" tube elbow coming from the "IN" port of the log splitter valve. Take 2nd hydraulic hose (supplied with log splitter) and connect the elbow end of hose to "B" (inlet port) on divider block of tractor and the straight end of the hose to the 1/2" pipe to 1/2" tube elbow coming from the "OUT" port on the log splitter valve.

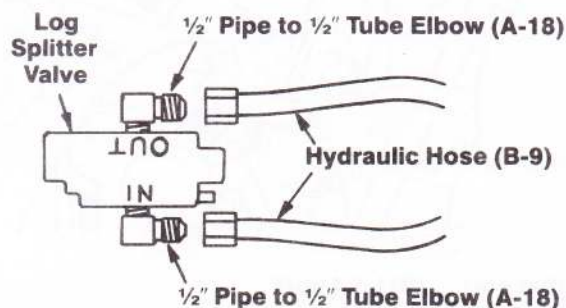
**IMPORTANT**

Tractors with TH Loaders – you must unhook loader hydraulics to hook up log splitter hyd.

**NOTE:** for A & B ports check your Tractor Manual.



**Use of double acting cylinder on YLS Log Splitter:**

When using the implement (Log Splitter) which has a double acting cylinder, the control valve of the Log Splitter should be used, by connecting the hydraulic lines to divider block of high pressure hydraulic line.

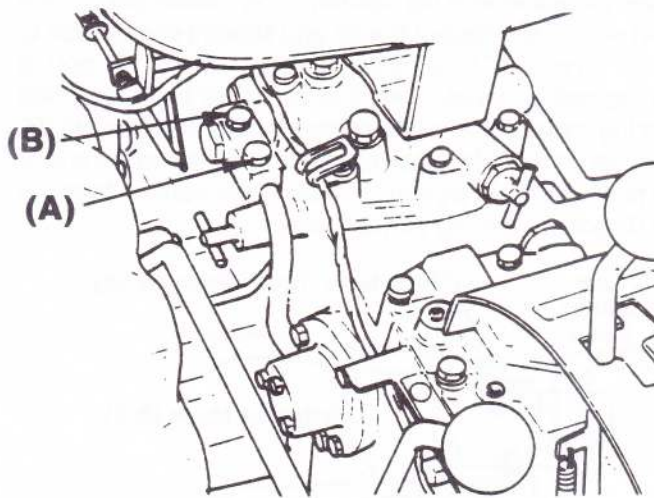

(A) Outlet port (B) Inlet port

When using these ports for implements, must block the connecting passage between outlet port (A: Pump side) and Inlet port (B: Hydraulic lift side) in the hydraulic cylinder head by using the Allen pipe plug ( $\frac{1}{4}$ -18 NPTF), which is supplied with the implement. Key No. B-11.

Install the Allen pipe plug into the inlet port (B: Hydraulic lift side) for position control valve.

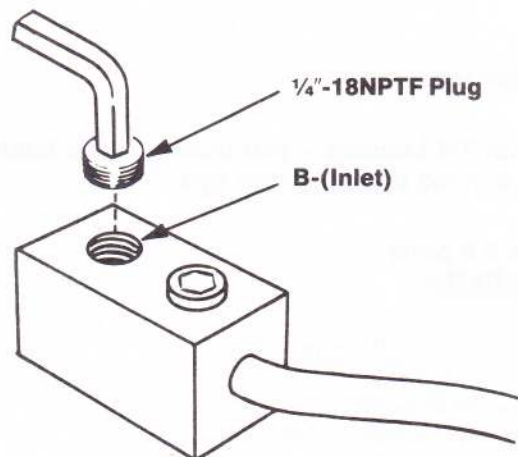

Whenever dismantling the hydraulic lines of implement from the outlet ports, **MUST** remove the headless plug to avoid hydraulic pump breakage.

**To Connect Hydraulic Hoses From Log Splitter To Tractor.**

First screw into the "in" & "out" ports of the valve on the log splitter the  $\frac{1}{2}$ " pipe to  $\frac{1}{2}$ " tube elbows Part No. 43550 (A-18). Then connect the elbow end of one of the hydraulic hoses (supplied with log splitter) to "A" (outlet port, pump side) on divider block of tractor and straight end of hose to the  $\frac{1}{2}$ " pipe to  $\frac{1}{2}$ " tube elbow coming from the "IN" port of the log splitter valve. Take 2nd hydraulic hose (supplied with log splitter) and connect the elbow end of hose to "B" (inlet port) on divider block of tractor and the straight end of the hose to the  $\frac{1}{2}$ " pipe to  $\frac{1}{2}$ " tube elbow coming from the "OUT" port on the log splitter valve.

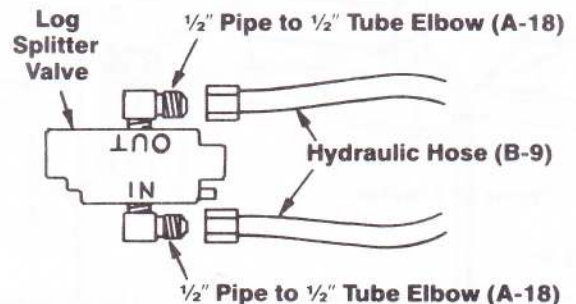
**For Tractors with Loaders**

When connecting the hydraulic hoses from the log splitter to the tractor with a loader on, disconnect the hydraulic hose of the loader from port B (inlet side) on the tractor. Take the two hoses supplied with the log splitter and connect the straight ends of the hoses into the "IN" side and one into the "OUT" side of the valve on the log splitter. Take the other end of the hose coming from the "OUT" side of the log splitter and connect it to port B (inlet side) on the tractor. Take the other end of the hose from the "IN" side of the log splitter and connect it to the end of the loader hose which you took out of port B on tractor. To connect these two male end hydraulic hoses use (B-10) the  $\frac{3}{4}$ " O-Ring boss double female coupler supplied with the log splitter.

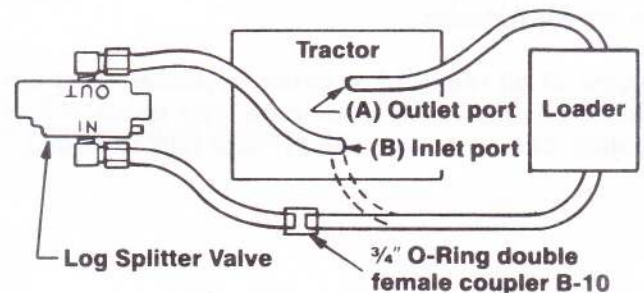

**NOTE:** for A & B ports check your Tractor Manual.



When connecting hydraulic lines to the divider block, see YANMAR dealer.

Volume of oil required to extend cylinder must not lower Transmission-Hydraulic oil level below end of dipstick. Check oil level with cylinder fully extended.



### Use of double acting cylinder on YLS Log Splitter:

When using the implement (Log Splitter) which has a double acting cylinder, the control valve of the Log Splitter should be used, by connecting the hydraulic lines to divider block of high pressure hydraulic line.

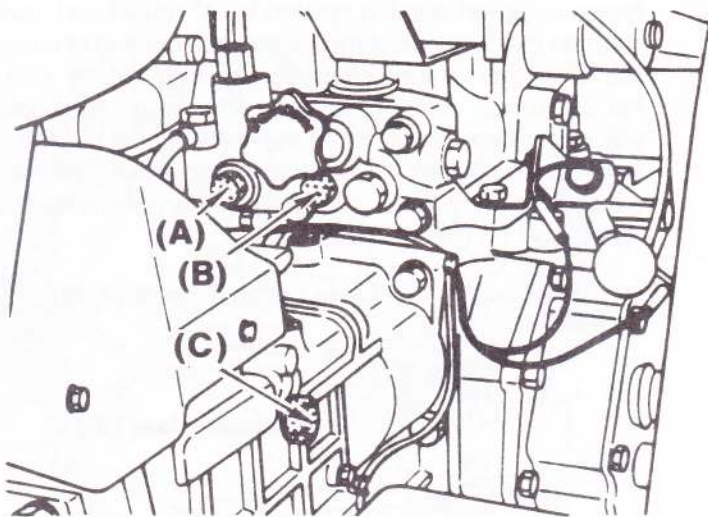

(A) Outlet port (B) Inlet port (C) Return port

When using these ports for implements, must block the connecting passage between outlet port (A: Pump side) and Inlet port (B: Hydraulic lift side) in the hydraulic cylinder head by using the Allen pipe plug ( $\frac{1}{4}$ -18 NPTF), which is supplied with the implement. Key No. B-11.

Install the Allen pipe plug into the outlet port (A: Pump side) for draft control valve.

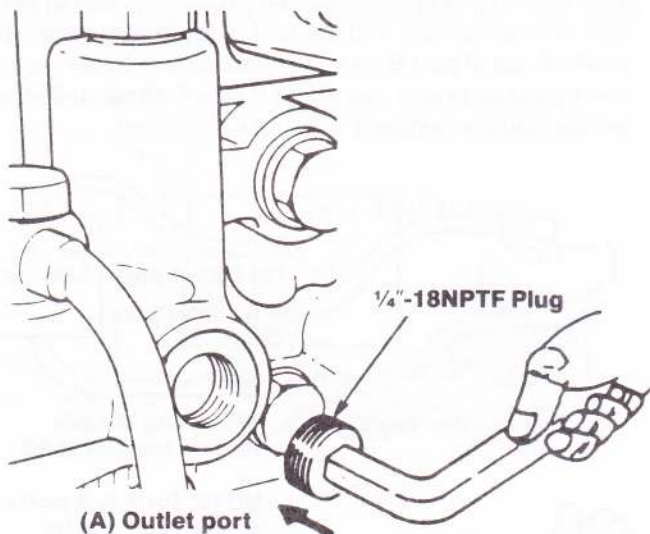

(A) Outlet port



**IMPORTANT**

Whenever dismantling the hydraulic lines of implement from the outlet ports, **MUST** remove the headless plug to avoid hydraulic pump breakage.

### To Connect Hydraulic Hoses From Log Splitter To Tractor.

First screw into the "in" & "out" ports of the valve on the log splitter the  $\frac{1}{2}$ " pipe to  $\frac{1}{2}$ " tube elbows Part No. 43550 (A-18). Then connect the elbow end of one of the hydraulic hoses (supplied with log splitter) to "A" (outlet port, pump side) on divider block of tractor and straight end of hose to the  $\frac{1}{2}$ " pipe to  $\frac{1}{2}$ " tube elbow coming from the "IN" port of the log splitter valve. Take 2nd hydraulic hose (supplied with log splitter) and connect the elbow end of hose to "B" (inlet port) on divider block of tractor and the straight end of the hose to the  $\frac{1}{2}$ " pipe to  $\frac{1}{2}$ " tube elbow coming from the "OUT" port on the log splitter valve.

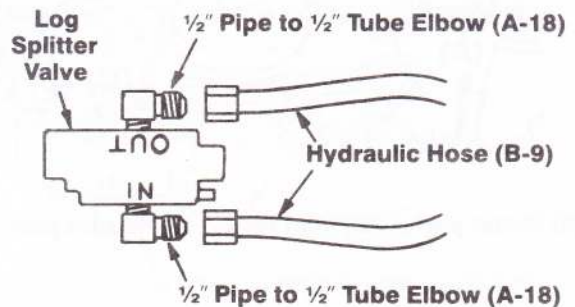

### For Tractors with Loaders

When connecting the hydraulic hoses from the log splitter to the tractor with a loader on, disconnect the hydraulic hose of the loader from port B (inlet side) on the tractor. Take the two hoses supplied with the log splitter and connect the straight ends of the hoses into the "IN" side and one into the "OUT" side of the valve on the log splitter. Take the other end of the hose coming from the "OUT" side of the log splitter and connect it to port B (inlet side) on the tractor. Take the other end of the hose from the "IN" side of the log splitter and connect it to the end of the loader hose which you took out of port B on tractor. To connect these two male end hydraulic hoses use (B-10) the  $\frac{3}{4}$ " O-Ring boss double female coupler supplied with the log splitter.

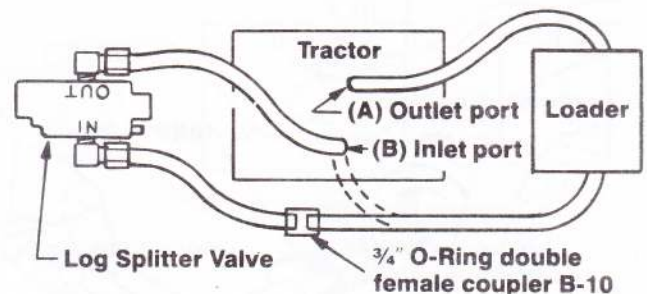

**NOTE:** for A & B ports check your Tractor Manual.



**IMPORTANT**

When connecting hydraulic lines to the divider block, see YANMAR dealer.

Volume of oil required to extend cylinder must not lower Transmission-Hydraulic oil level below end of dipstick. Check oil level with cylinder fully extended.



**Use of double acting cylinder on YLS Log Splitter:**

When using the implement (Log Splitter) which has a double acting cylinder, the control valve of the Log Splitter should be used, by connecting the hydraulic lines to divider block of high pressure hydraulic line.

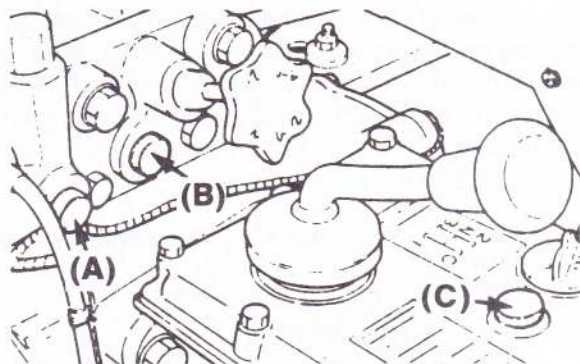

(A) Outlet port (B) Inlet port (C) Return port

When using these ports for implements, must block the connecting passage between outlet port (A: Pump side) and Inlet port (B: Hydraulic lift side) in the hydraulic cylinder head by using the Allen pipe plug (1/4-18 NPTF), which is supplied with the implement. Key No. B-11.

Install the Allen pipe plug into the outlet port (A: Pump side) for draft control valve.

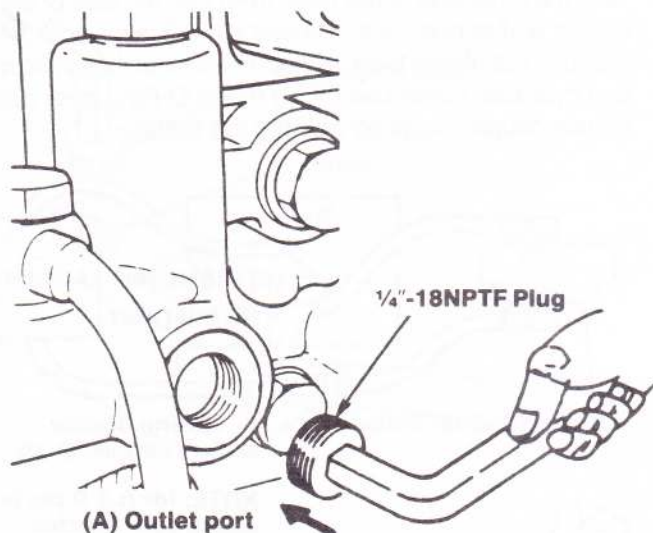

**IMPORTANT**

Whenever dismantling the hydraulic lines of implement from the outlet ports, **MUST** remove the headless plug to avoid hydraulic pump breakage.

**To Connect Hydraulic Hoses From Log Splitter To Tractor.**

First screw into the "in" & "out" ports of the valve on the log splitter the 1/2" pipe to 1/2" tube elbows Part No. 43550 (A-18). Then connect the elbow end of one of the hydraulic hoses (supplied with log splitter) to "A" (outlet port, pump side) on divider block of tractor and straight end of hose to the 1/2" pipe to 1/2" tube elbow coming from the "IN" port of the log splitter valve. Take 2nd hydraulic hose (supplied with log splitter) and connect the elbow end of hose to "B" (inlet port) on divider block of tractor and the straight end of the hose to the 1/2" pipe to 1/2" tube elbow coming from the "OUT" port on the log splitter valve.

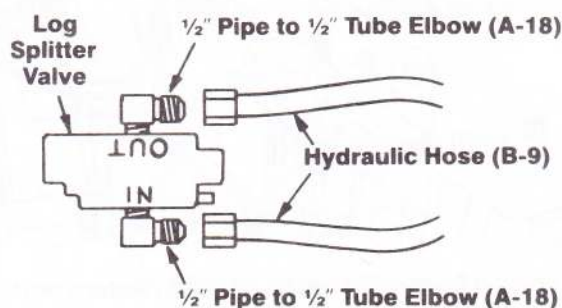
**For Tractors with Loaders**

When connecting the hydraulic hoses from the log splitter to the tractor with a loader on, disconnect the hydraulic hose of the loader from port B (inlet side) on the tractor. Take the two hoses supplied with the log splitter and connect the straight ends of the hoses into the "IN" side and one into the "OUT" side of the valve on the log splitter. Take the other end of the hose coming from the "OUT" side of the log splitter and connect it to port B (inlet side) on the tractor. Take the other end of the hose from the "IN" side of the log splitter and connect it to the end of the loader hose which you took out of port B on tractor. To connect these two male end hydraulic hoses use (B-10) the 3/4 O-Ring boss double female coupler supplied with the log splitter.

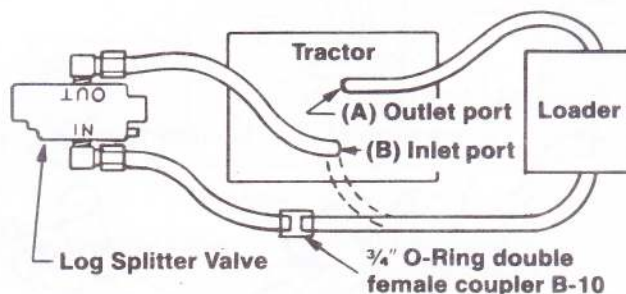

**NOTE:** for A & B ports check your Tractor Manual.



**IMPORTANT**

When connecting hydraulic lines to the divider block, see YANMAR dealer.

Volume of oil required to extend cylinder must not lower Transmission-Hydraulic oil level below end of dipstick. Check oil level with cylinder fully extended.



### Use of double acting cylinder on YLS Log Splitter:

When using the implement (Log Splitter) which has a double acting cylinder, the control valve of the Log Splitter should be used, by connecting the hydraulic lines to divider block of high pressure hydraulic line.

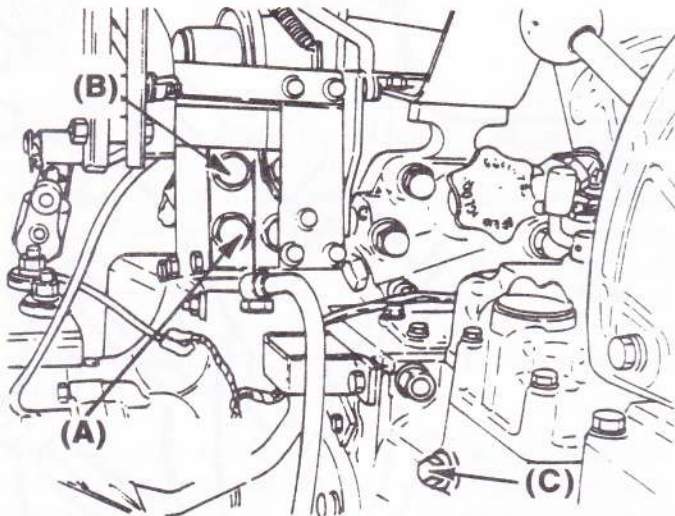

(A) Outlet port (B) Inlet port (C) Return port

When using these ports for implements, must block the connecting passage between outlet port (A: Pump side) and Inlet port (B: Hydraulic lift side) in the hydraulic cylinder head by using the Allen pipe plug ( $\frac{1}{4}$ -18 NPTF), which is supplied with the implement. Key No. B-11.

Install the Allen pipe plug into the outlet port (A: Pump side) for draft control valve.

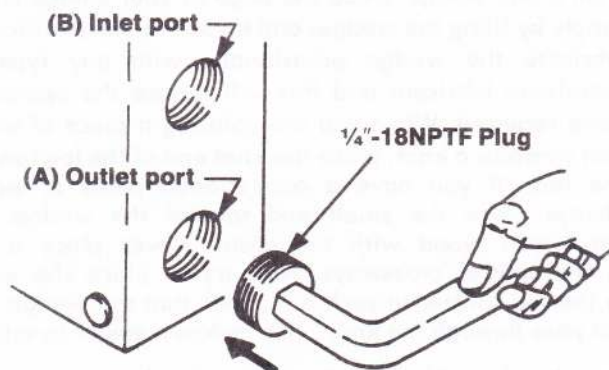

### To Connect Hydraulic Hoses From Log Splitter To Tractor.

First screw into the "in" & "out" ports of the valve on the log splitter the  $\frac{1}{2}$ " pipe to  $\frac{1}{2}$ " tube elbows Part No. 43550 (A-18). Then connect the elbow end of one of the hydraulic hoses (supplied with log splitter) to "A" (outlet port, pump side) on divider block of tractor and straight end of hose to the  $\frac{1}{2}$ " pipe to  $\frac{1}{2}$ " tube elbow coming from the "IN" port of the log splitter valve. Take 2nd hydraulic hose (supplied with log splitter) and connect the elbow end of hose to "B" (inlet port) on divider block of tractor and the straight end of the hose to the  $\frac{1}{2}$ " pipe to  $\frac{1}{2}$ " tube elbow coming from the "OUT" port on the log splitter valve.

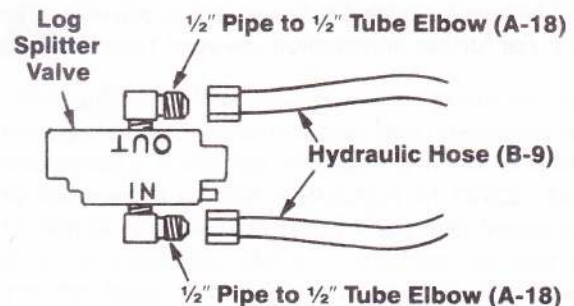

### For Tractors with Loaders

When connecting the hydraulic hoses from the log splitter to the tractor with a loader on, disconnect the hydraulic hose of the loader from port B (inlet side) on the tractor. Take the two hoses supplied with the log splitter and connect the straight ends of the hoses into the "IN" side and one into the "OUT" side of the valve on the log splitter. Take the other end of the hose coming from the "OUT" side of the log splitter and connect it to port B (inlet side) on the tractor. Take the other end of the hose from the "IN" side of the log splitter and connect it to the end of the loader hose which you took out of port B on tractor. To connect these two male end hydraulic hoses use (B-10) the  $\frac{3}{4}$ " O-Ring boss double female coupler supplied with the log splitter.

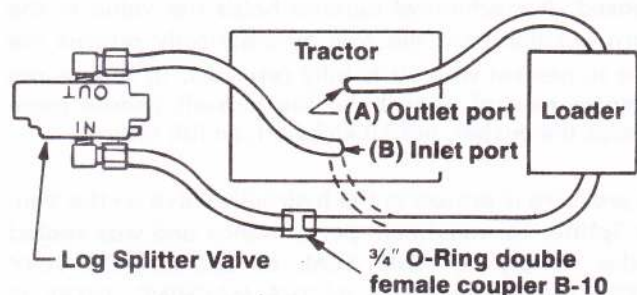

**NOTE:** for A & B ports check your Tractor Manual.



**IMPORTANT**

When connecting hydraulic lines to the divider block, see YANMAR dealer.

Volume of oil required to extend cylinder must not lower Transmission-Hydraulic oil level below end of dipstick. Check oil level with cylinder fully extended.



**IMPORTANT**

Whenever dismantling the hydraulic lines of implement from the outlet ports, **MUST** remove the headless plug to avoid hydraulic pump breakage.



# USE OF REMOTE HYDRAULIC COUPLERS



## IMPORTANT

When connecting hydraulic lines to remote hydraulic couplers, the log splitter valve inlet line is to be connected to the pressurized quick coupler.

NOTE: This is normally the top quick coupler; check individual systems before operating.

For Yanmar tractors with new system hydraulic valves, a HYD K-3 kit may be added to the system to provide remote couplers. For further information see your Yanmar dealer.

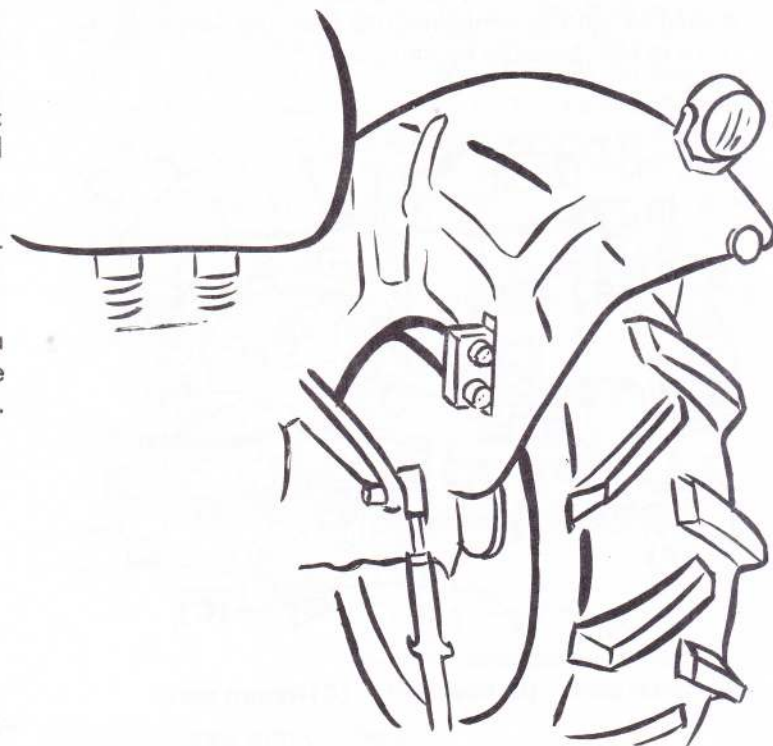

## OPERATION

To operate the splitter, you simply push the handle out to make the cylinder move out to split the wood. Move the handle back and it will automatically stop when the cylinder is fully retracted. NOTE: If you happen to have reverse action on the valve, it will be because of the "in" and "out" lines have been mixed on the valve. The four-way hydraulic valve provides power on both the forward and return stroke for fast, efficient operation. The valve is spring loaded so it will return to the neutral position from the forward position whenever the handle is released. A mechanical detente holds the valve in the return position, and the ram automatically returns the valve to neutral when it is fully returned. (If it does not return to neutral, then bend the kick-off paddle more towards the pusher, until it kicks-off, on full return.)

The pressure is pre-set in the hydraulic valve on the Yanmar Splitter for maximum performance and was sealed at the factory. IF THIS SEAL IS BROKEN OR ANY ALTERATIONS ARE MADE IN THE MACHINE, THERE IS NO FACTORY WARRANTY. If you happen to have a piece of wood that stalls the ram, it simply will by-pass in the splitter valve and will not cause damage to the machine. Usually any piece of wood can be split by taking a different point, angle, or positioning of the wood in the splitter. Your machine is designed to split 21" lengths of wood. The majority of fire place and modern wood stove is cut in 18" lengths. The pusher

lacks 3" of touching the wedge. To get faster splitting in material that does not completely free itself at the end of the cylinder travel, simply return cylinder and drop in another piece of wood ahead of the pusher, push the original piece off of the wedge, and continue splitting. By following this action, you can increase the production of wood split per hour. Difficulty in splitting wood can result from a dull wedge. Keep the edge of your wedge sharp simply by filing the wedge; and if you still have difficulty, lubricate the wedge occasionally with any type of petroleum lubricant and this will reduce the operating force required. When you are splitting a piece of wood that contains a knot, place the knot end of the log toward the ram. If you have a cone-shaped piece of wood, always place the small end toward the wedge. Always split wood with the grain. Never place a log in the splitter crossways. Also try to place the wood in the log splitter in such a manner that the wedge will not pass through the knot. This makes it easier to split.

Keep hands and fingers clear of moving parts.



NOTE: Check your tractor hydraulic oil reservoir. After cycling splitter, you may have to add oil. The cylinder uses approximately one gallon of oil from tractor system. The hitch pins of the splitter will accommodate Class 0&1 hitches. Your splitter is designed to operate at any position on your 3 point linkage.



## MAINTENANCE



Keep the wedge in good condition. This log splitter was computer designed and the wedge was designed to act as much as a shear as it does a splitting wedge; therefore, the sharp edge of the wedge must be maintained. It can be maintained with a common hand file. The special material in the wedge has a tendency to become tougher the more it is used. Certain types of wood have a tendency to dull the wedge quicker than others so your experience will probably vary according to the wood you are splitting.

Whenever your splitter is out of use, be sure that your ram is fully retracted and protective measures have been taken to keep the dirt out of the ports on hydraulic valves and lines. It is also good practice to grease the wedge to prevent rusting when it is not in use.

\*Upon every use of the splitter, check all hardware and hoses in order to be sure that they are secure.

\*Check for defective parts. If they are found, repair or replace them before operating the log splitter.

\*Keep your wedge in good condition.



\*Hydraulic fluid escaping under pressure can have enough force to penetrate the skin. Hydraulic fluid may also infect a minor cut or opening in the skin. If injured by escaping fluid, SEE A DOCTOR AT ONCE. Serious infection or reaction can result if medical treatment is not given immediately. Make sure all connections are tight and that hoses and lines are in good condition before applying pressure to the system. Relieve all pressure before disconnecting the lines or performing other work on the hydraulic system. To find a leak under pressure, use a small piece of cardboard or wood. Never use hands.

## YLS 26 PARTS LIST

Key No.	Part No.	Description	No. Pieces
B-9	43501	Hydraulic Hoses	2
B-1	43502-26	Main Frame Assembly	1
B-2	43503-26	Cylinder and Valve Assembly	1
	Serviceable Details		
	43504	Valve Assembly	
B-3	43505	Handle	1
A-1	43506	Clevis Pin	2
	43507	Pivot End-Top	1
	43508	Pivot End-Bottom	1
A-2	43509	Clevis Pin Washer	2
	43546	Cotter Pin	1
	43510-26	Cylinder Assembly	
	43511	7/8 Bolt to Rod	1
	43512	Piston	1
	43513	Poly-Pac Seal	1 - Serviceable only in seal kit #43547
	43514-26	Hard Chrome Shaft	1
	43515	Head	1
	43516	Head Seal Kit	1 - Serviceable only in seal kit #43547
	43517	Lock Band	1
	43518	Lock Wire	1
	43519	Head Bolt 1/2 x 4	4
	43520	Head Nuts 1/2"	4
	43521	Pipe Nipple	1
	43522	1/2" Pipe-Tube Elbow	1
	43523	Valve Bracket	1
	43524-26	Barrell Assembly	1
	43525	Valve Bracket Bolt & Nut 1/4 x 2 Bolt	1
B-5	43526	Side Plates	2
A-7	43527	3/8 x 1 Bolt	4
A-8	43528	3/8 Nut	10
A-9	43529	3/8 Interlocking Washer	10
B-6	43530	A-Frame	1
A-10	43531	3/8 x 3/4 Bolt	6
B-7	43532	Cross Shaft Assembly	1
A-11	43533	Hitch Pins	2
	43547	4" Seal Kit	1
	43551-26	Steel pressure line on cylinder	1

Key No.	Part No.	Description	No. Pieces
A-12	43534	1/4" Clevis Pin	2
A-13	43535	Cotter Pins	2
B-4	43536	Kick-off Paddle	1
A-3	43537	5/16 x 1 1/4 Bolt	1
A-4	43538	5/16" Nut	1
A-5	43539	5/16 Lock Washer	1
A-6	43540	5/16 U-Washer	1
B-8	43541	Swing Wedge	1
A-15	43542	Pivot Pin	1
A-16	43543	3/8 x 2 1/2 Coller Bolt	1
A-17	43544	3/8" Lock Coller Nut	1
B-10	43548	3/4" O Ring Boss double female coupler for use on tractor with Yanmar Loader	1
B-11	43549	1/4" - 18 NPTF Allen pipe plug to be inserted in inlet port of tractor	1
A-18	43550	1/2" Pipe to 1/2" Tube Elbow	2

## YLS 21 PARTS LIST

Key No.	Part No.	Description	No. Pieces
B-9	43501	Hydraulic Hoses	2
B-1	43502	Main Frame Assembly	1
B-2	43503	Cylinder and Valve Assembly	1
	Serviceable Details		
	43504	Valve Assembly	
B-3	43505	Handle	1
A-1	43506	Clevis Pin	2
	43507	Pivot End-Top	1
	43508	Pivot End-Bottom	1
A-2	43509	Clevis Pin Washer	2
	43546	Cotter Pin	1
	43510	Cylinder Assembly	
	43511	7/8 Bolt to Rod	1
	43512	Piston	1
	43513	Poly-Pac Seal	1 - Serviceable only in seal kit #43547
	43514	Hard Chrome Shaft	1
	43515	Head	1
	43516	Head Seal Kit	1 - Serviceable only in seal kit #43547
	43517	Lock Band	1
	43518	Lock Wire	1
	43519	Head Bolt 1/2 x 4	4
	43520	Head Nuts 1/2"	4
	43521	Pipe Nipple	1
	43522	1/2" Pipe-Tube Elbow	1
	43523	Valve Bracket	1
	43524	Barrell Assembly	1
	43525	Valve Bracket Bolt & Nut 1/4 x 2 Bolt	1
B-5	43526	Side Plates	2
A-7	43527	3/8 x 1 Bolt	4
A-8	43528	3/8 Nut	10
A-9	43529	3/8 Interlocking Washer	10
B-6	43530	A-Frame	1
A-10	43531	3/8 x 3/4 Bolt	6
B-7	43532	Cross Shaft Assembly	1
A-11	43533	Hitch Pins	2
	43547	4" Seal Kit	1
	43551	Steel pressure line on cylinder	1



Key No.	Part No.	Description	No. Pieces
A-12	43534	1/4" Clevis Pin	2
A-13	43535	Cotter Pins	2
B-4	43536	Kick-off Paddle	1
A-3	43537	5/16 x 1 1/4 Bolt	1
A-4	43538	5/16" Nut	1
A-5	43539	5/16 Lock Washer	1
A-6	43540	5/16 U-Washer	1
B-8	43541	Swing Wedge	1
A-15	43542	Pivot Pin	1
A-16	43543	3/8 x 2 1/2 Coller Bolt	1
A-17	43544	3/8" Lock Coller Nut	1
B-10	43548	3/4" O Ring Boss double female coupler for use on tractor with Yanmar Loader	1
B-11	43549	1/4" - 18 NPTF Allen pipe plug to be inserted in inlet port of tractor	1
A-18	43550	1/2" Pipe to 1/2" Tube Elbow	2

## *Yanmar Tractor Implements Limited Warranty*

YANMAR TRACTOR (U.S.A.), INC., 476 Country Club Drive, Bensenville, Illinois 60106, warrants that each new Implement product for Yanmar diesel tractors ("Product") will be free from defects in material and workmanship for a period of 12 months from the date of sale to the original purchaser at retail, or 6 months from the first date of rental.

Equipment covered by this warranty will be repaired or replaced at Y.T.I. option. In the event of a malfunction or failure, return the Yanmar Product, transportation prepaid, to an authorized Yanmar Product dealer with an explanation of the malfunction or defect. The location of the dealer nearest you can be obtained by contacting Yanmar Tractor (U.S.A.), Inc., at the above address. At the time of the request for warranty service, the purchaser must present documentation showing the date of purchase or first date of rental (for example, a bill of sale or equipment lease). Upon confirmation that the malfunction or failure is a result of a defect covered by this warranty, your dealer will repair your Product and return ship it to you freight collect.

This warranty does not cover engines, batteries, tires, chassis components or other trade accessories attached to your Product. This warranty shall only cover defects arising under normal usage. Yanmar Tractor (U.S.A.), Inc. assumes no responsibility from misuse, abuse, neglect, alteration, modification, mishandling, accident failure to follow operating instructions, or failures or defects resulting from repairs by other than authorized dealers.

ANY IMPLIED WARRANTY GRANTED UNDER STATE LAW INCLUDING WARRANTIES OR MERCHANTABILITY AND FITNESS FOR A PARTICULAR PURPOSE, ARE LIMITED IN DURATION TO THE EXPRESS WARRANTY GRANTED HEREUNDER. YANMAR TRACTOR (U.S.A.), INC. IN NO EVENT SHALL BE LIABLE FOR DIRECT, INDIRECT, INCIDENTAL, OR CONSEQUENTIAL DAMAGES INCLUDING, BUT NOT LIMITED TO, LOSS OF CROPS, OR ANY EXPENSES OR LOSSES INCURRED FOR LABOR, SUPPLIES, SUBSTITUTE MACHINERY, RENTAL OR ANY OTHER LIKE EXPENSES. SOME STATES DO NOT ALLOW THE EXCLUSION OR LIMITATIONS OF INCIDENTAL OR CONSEQUENTIAL DAMAGES, SO THE ABOVE LIMITATIONS AND EXCLUSIONS MAY NOT APPLY TO YOU.

This warranty gives you specific legal rights and you may also have other rights which vary from state to state.

For further information concerning this warranty, contact Yanmar Tractor (U.S.A.), Inc., at 476 Country Club Drive, Bensenville, Illinois 60106. Telephone (321) 860-5370.

Printed in U.S.A.